

EROSION CONTROL & MAINTENANCE PLAN NOTES

1. RETAIN FLOATABLE WIND BLOWN MATERIALS ON SITE BY STORING ALL TRASH AND BUILDING MATERIAL WASTE IN ENCLOSURES UNTIL PROPER DISPOSAL AT OFF-SITE FACILITIES. CHECK ADJACENT AREAS DAILY AND PICK UP CONSTRUCTION WASTE MATERIALS AND DEBRIS THAT HAVE BLOWN OR WASHED OFF SITE.
2. PERMANENTLY STABILIZE ALL SURFACE AREA WITHIN AND ADJACENT TO THIS SITE THAT IS DISTURBED BY VEHICLES, GRADING AND OTHER CONSTRUCTION. FOR THE PROPOSED FACILITY, STABILIZATION IS OBTAINED WHEN THE DISTURBED SURFACE IS COVERED WITH STRUCTURES, PAVING AND/OR PERENNIAL VEGETATION HAVING A UNIFORM COVERAGE DENSITY OF AT LEAST 10%. STABILIZATION OF ALL DISTURBED AREAS IS REQUIRED BEFORE TERMINATING MAINTENANCE AND REMOVAL OF EROSION CONTROL MEASURES.
3. IF THE ENTIRE SITE WILL NOT BE PERMANENTLY STABILIZED BY DECEMBER 1, THE RESPONSIBLE LAND DISTURBER SHALL CONTACT THE EROSION AND SEDIMENT CONTROL STAFF TO SCHEDULE A PRE-WINTER MEETING TO OCCUR BEFORE OCTOBER 1.
4. CONTRACTORS SHALL INSPECT EROSION CONTROL MEASURES AT LEAST ONCE EVERY 14 DAYS AFTER A STORM EVENT OF 1/2 INCH OR GREATER. DAMAGED MEASURES THAT PROVE TO BE INEFFECTIVE SHALL BE REPLACED WITH MORE EFFECTIVE MEASURES OR ADDITIONAL MEASURES WITHIN SEVEN DAYS OF FAILURE OF A CONTROL MEASURE. MEASURES INSTALLED TO PREVENT DISCHARGE OF POLLUTANTS FROM THE CONSTRUCTION SITE.
5. INSTALLATION OF ADDITIONAL EROSION CONTROL MEASURES MAY BE REQUIRED BY THE CITY ENGINEER. CONTRACTOR TO VERIFY REQUIREMENTS PRIOR TO BEGINNING ANY WORK ON PROJECT SITE.
6. CARE SHALL BE TAKEN TO MINIMIZE THE ENCROACHMENT OF SEDIMENT INTO ADJACENT PUBLIC UTILITIES, PUBLIC STREETS, AND OTHER PRIVATE PROPERTY UNTIL IMPERVIOUS MATERIAL (ROAD/PARKING AREA SURFACE) IS APPLIED OR UNTIL PROPOSED LANDSCAPE HAS BEEN ESTABLISHED. REFER TO SITE DETAILS FOR SILT FENCE CONSTRUCTION.
7. ALL GRASS SLOPES WHICH EXCEED 3:1 (H:V) SHALL UTILIZE CONTEMPORARY CONSTRUCTION OF PERMANENT TURF REINFORCEMENT MATS C35 OR APPROVED EQUAL. MATS SHALL BE INSTALLED PER MANUFACTURER'S SPECIFICATIONS AND STANDARDS. CONTRACTOR SHALL COORDINATE INSTALLATION INSPECTION WITH MANUFACTURER.

STAGE OF CONSTRUCTION NOTES

- THE FOLLOWING CONSTRUCTION SEQUENCE IS RECOMMENDED:
- PHASE I**
1. CONTRACTOR TO OBTAIN ALL NECESSARY PERMITS.
 2. PRIOR TO ANY EARTH DISTURBANCE, CONTRACTOR TO CONTACT THE COUNTY AND SCHEDULE A PRE-CONSTRUCTION MEETING.
 3. CONTRACTOR SHALL CONTACT JURISDICTION AT LEAST 48 HOURS PRIOR TO COMMENCING CONSTRUCTION.
 4. CONTRACTOR SHALL STAKE AND FLAG LIMITS OF CLEARING.
 5. INSTALL STABILIZED CONSTRUCTION ENTRANCE/EXIT AND 15" TEMPORARY CURB (AS SHOWN).
 6. INSTALL EROSION CONTROL BARRIERS (SILT FENCE & SAFETY FENCE) (AS SHOWN).
 7. INSTALL INLET PROTECTION & TREE PROTECTION (AS SHOWN).
 8. INSTALL CHECK DAM (AS SHOWN).
 9. CONTRACTOR TO OBTAIN APPROVAL OF PHASE I MEASURES PRIOR TO PROCEEDING.
- PHASE II - IMPORTANT: GC TO COMPLETE ALL STEPS IDENTIFIED IN PHASE I PRIOR TO BEGINNING WORK IN PHASE II.**
1. ONCE ALL EAS MEASURES ARE IN PLACE, CONTRACTOR SHALL BEGIN TO GRADE THE SITE, PREPARING SUBGRADES AND MAKING ANY NECESSARY SOIL IMPROVEMENTS.
 2. ONCE SITE HAS BEEN GRADED TO SUBGRADE ELEVATIONS, CONTRACTOR TO START CONSTRUCTION OF BUILDING PAD AND STRUCTURES.
 3. TEMPORARILY STABILIZE THROUGHOUT CONSTRUCTION AND IMMEDIATELY FOLLOWING THE COMPLETION OF THE MOST RECENT LAND DISTURBING/GRADING ACTIVITY. ANY DISTURBED AREAS, INCLUDING MATERIAL STOCKPILES THAT ARE SCHEDULED OR LIKELY TO REMAIN INACTIVE FOR 7 DAYS OR MORE.
 4. AREAS TO BE VEGETATED SHALL BE PERMANENTLY STABILIZED IMMEDIATELY, AS THEY ARE BROUGHT TO FINAL GRADE.
 5. INSTALL UTILITIES, UNDERDRAINS, CURBS AND GUTTERS. CONTRACTOR TO INSTALL INLET PROTECTION AS UTILITIES, UNDERDRAINS, CURBS AND GUTTERS ARE INSTALLED.
 6. PREPARE SITE FOR PAVING.
 7. PAVE SITE IN NECESSARY AREAS.
 8. INSTALL LANDSCAPE PLANTINGS IN ACCORDANCE WITH THE LANDSCAPE PLAN.
 9. COMPLETE GRADING AND INSTALLATION OF PERMANENT STABILIZATION OVER ALL AREAS, IF NECESSARY.
 10. OBTAIN CONCURRENCE FROM THE COUNTY INSPECTOR THAT THE SITE HAS BEEN FULLY STABILIZED AND ALL CONSTRUCTION HAS BEEN COMPLETED, THEN:
 - A. WITHIN 30 DAYS REMOVE ALL REMAINING TEMPORARY EROSION AND SEDIMENT CONTROL MEASURES.
 - B. REMOVE ALL TEMPORARY CONSTRUCTION EQUIPMENT, CONSTRUCTION MATERIALS AND DEBRIS FROM THE SITE.
 - C. STABILIZE ANY AREAS DISTURBED BY THE REMOVAL OF TEMPORARY MEASURES.
- NOTE: THE CONTRACTOR SHALL REFER TO THE GEOTECHNICAL REPORT FOR

CONSTRUCTION EGRESS NOTES

1. CONSTRUCTION EGRESS SHALL BE 25' MINIMUM WIDTH AND 30' MINIMUM LENGTH AND 6" MIN THICKNESS OF STONE (1.5"-3.5") COARSE AGGREGATE WITH GEOTEXTILE UNDERLINER. REFER TO CITY OR STATE FOR ANY ADDITIONAL REQUIREMENTS.
2. THE EXIT SHALL BE MAINTAINED IN A CONDITION WHICH WILL PREVENT TRACKING OR FLOW OF MUD ONTO PUBLIC RIGHT-OF-WAY. THIS MAY REQUIRE PERIODIC TOP DRESSING WITH 1.5-5.5 INCH STONE, AS CONDITIONS DEMAND, AND REPAIR AND/OR CLEAN OUT OF ANY STRUCTURE USED TO TRAP SEDIMENT. ALL MATERIALS SPILLED, DROPPED, WASHED, OR TRACKED FROM VEHICLES OR SITE ONTO ROADWAYS OR INTO STORM DRAINS MUST BE REMOVED IMMEDIATELY.
3. WHEELS MUST BE CLEANED TO REMOVE MUD PRIOR TO ENTRANCE ONTO PUBLIC RIGHT-OF-WAY. WHEN WASHING IS REQUIRED, IT SHALL BE DONE ON AN AREA WITH CRUSHED STONE WHICH DRAINS INTO AN APPROVED SEDIMENT TRAP OR SEDIMENT BASIN LOCATED PER COUNTY OR STATE REQUIREMENTS.

PLAN REFERENCES

- REFER TO EROSION CONTROL DETAILS FOR ADDITIONAL EROSION NOTES & DETAILS
- THIS PLAN TO BE UTILIZED FOR EROSION PURPOSES ONLY

COMM #	4251
DATE:	11-2-18
REVISION DATE:	03-25-19
	06-24-19
	09-11-19



PROJECT NO.: V183201 SCALE: 1"=40'
DRAWN BY / CHECKED BY: DSH/JQR CAD I.D.: SSO

CRAIG A. SCHNEIDER, AIA
ARCHITECT
1736 EAST SHARLINE, SUITE 417
SPRINGFIELD, MISSOURI 65804
417.862.0558
417.862.3265
FAX: 417.862.3265
E-MAIL: architect@csrtrichneider.com

PROJECT:
NEW O'REILLY AUTO PARTS STORE
290 DEACON ROAD
FREDERICKSBURG, VA #4
EROSION CONTROL PLAN

O'Reilly AUTO PARTS
CORPORATE OFFICES
233 SOUTH PATTERSON
SPRINGFIELD, MISSOURI 65802
(417) 862-2674 TELEPHONE

COMM # 4251
DATE: 11-2-18
REVISION DATE: 03-25-19
06-24-19
09-11-19

C3.1

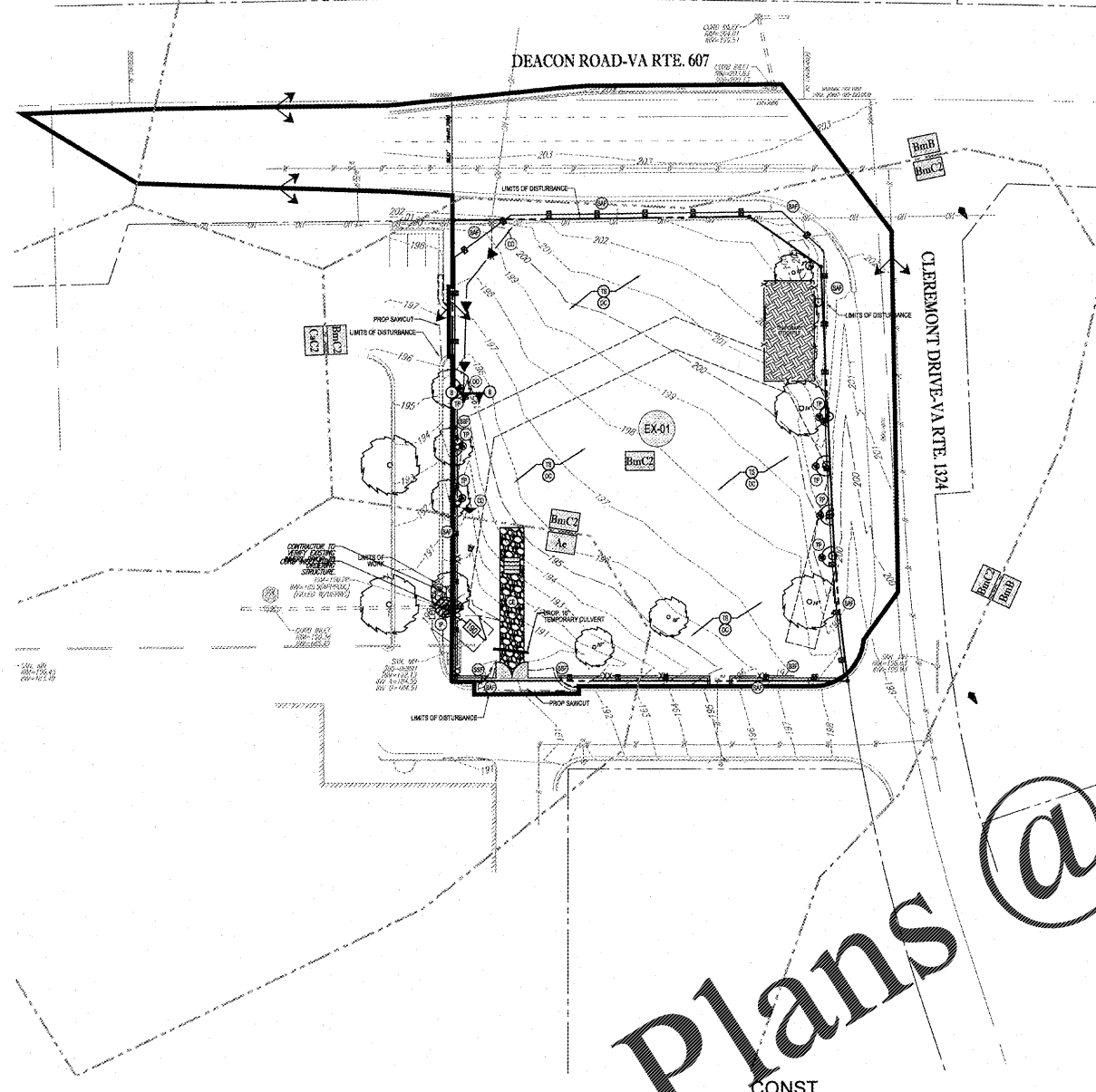

1 E&S CONTROL PLAN - PHASE I
C3.1 SCALE: 1" = 40'

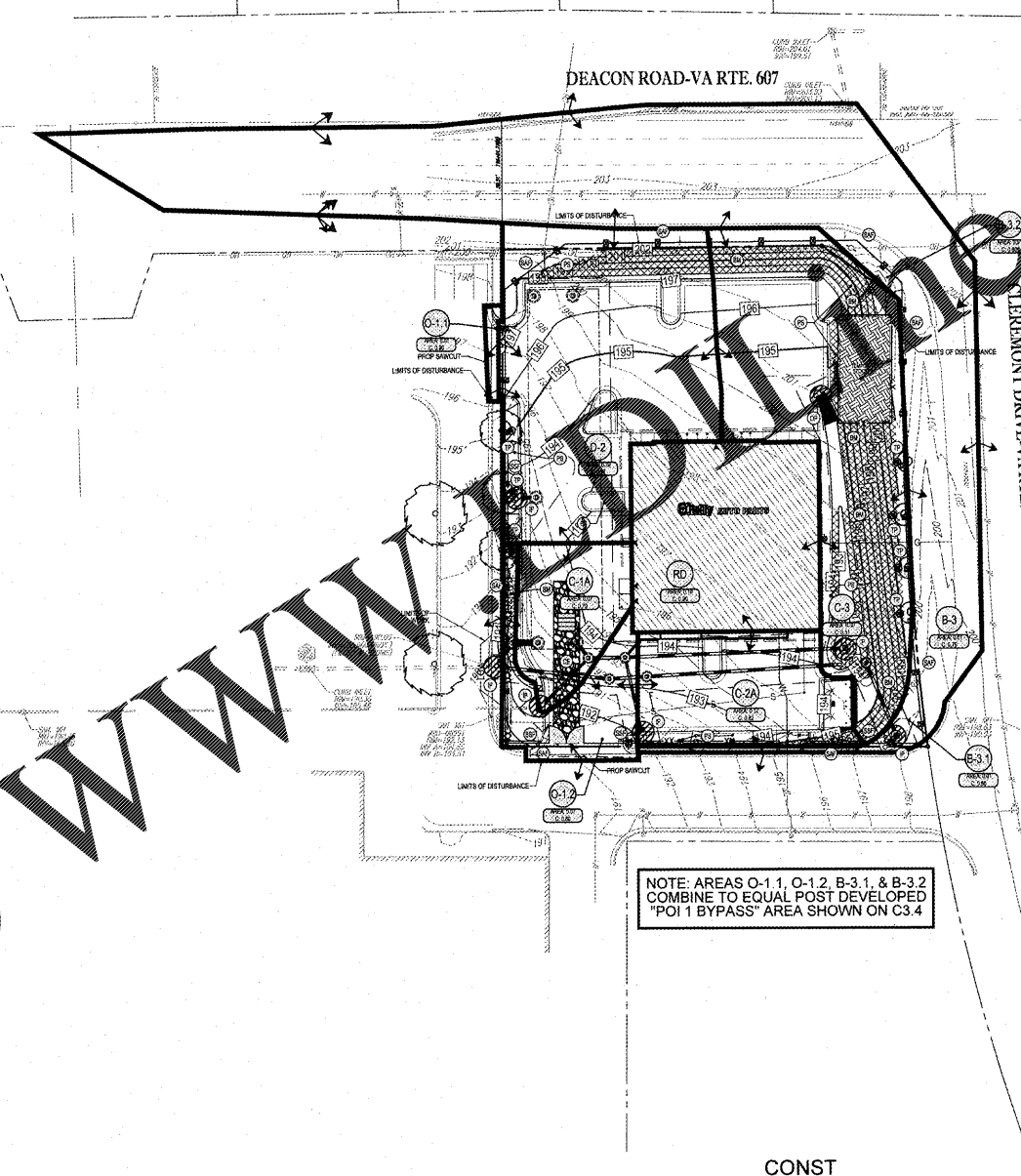

2 E&S CONTROL PLAN - PHASE II
C3.1 SCALE: 1" = 40'

NOTE: AREAS O-1.1, O-1.2, B-3.1, & B-3.2 COMBINE TO EQUAL POST DEVELOPED "POI 1 BYPASS" AREA SHOWN ON C3.4

VIRGINIA UNIFORM CODING SYSTEM FOR EROSION AND SEDIMENT CONTROL PRACTICES

NO.	TITLE	KEY	SYMBOL	NO.	TITLE	KEY	SYMBOL
3.01	SAFETY FENCE	SAF		3.20	ROCK CHECK DAMS	CD	
3.02	TEMPORARY STONE CONSTRUCTION ENTRANCE	CE		3.31	TEMPORARY SEEDING	TS	
3.03	SILT FENCE	SF		3.32	PERMANENT SEEDING	PS	
	SILT FENCE	SSF		3.36	SOIL STABILIZATION BLANKETS AND MATTING	BM	
3.07	STORM DRAIN INLET PROTECTION	IP		3.38	TREE PRESERVATION AND PROTECTION	TP	
3.18	OUTLET PROTECTION	OP		3.38	DUST CONTROL	DC	

SOILS LEGEND

XxX	SOILS TYPE
-----	------------

SOILS TABLE

SYMBOL	SOIL NAME	SLOPES
Ae	ALLUVIAL LAND, WET	6 - 10%
BmB	BOURNE FINE SANDY LOAM	2 - 6%
BmC2	BOURNE FINE SANDY LOAM	6 - 10%
Cac2	CAROLINE FINE SANDY LOAM	6 - 10%



Order Plans @

WWW.DIG

RECEIVED
SEP 18 2018
1736 EAST SHARLINE, SUITE 417
SPRINGFIELD, MO