

PARTIAL MEZZANINE LEVEL FINISH PLAN
 A-711 SCALE: 1/8" = 1'-0"

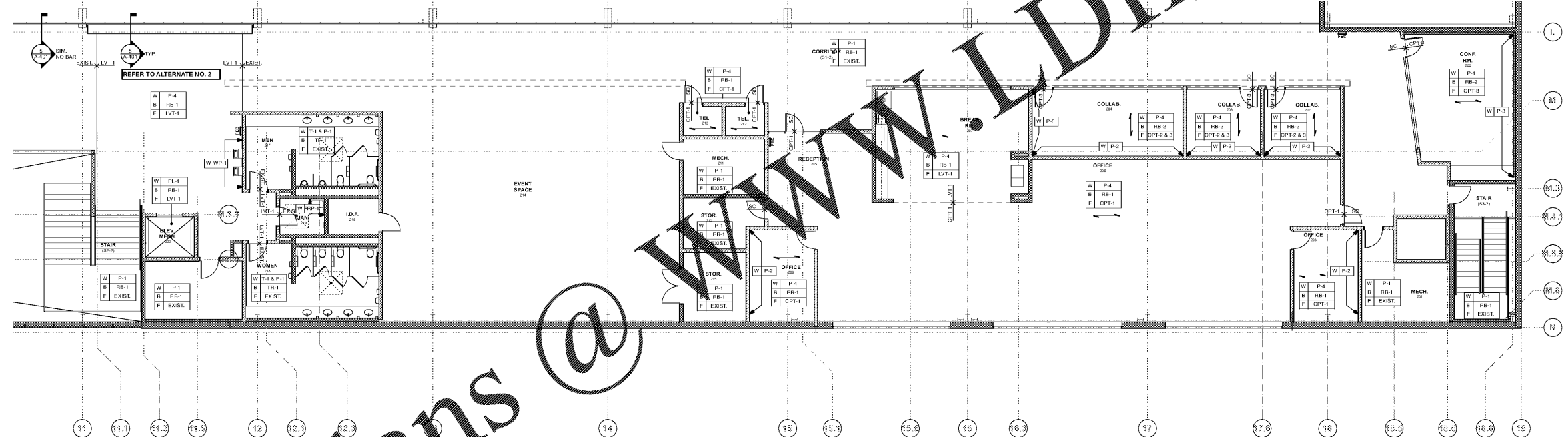

PARTIAL MEZZANINE LEVEL FINISH PLAN
 2 A-711 SCALE: 1/8" = 1'-0"

| FINISH SCHEDULE | | | | FINISH SCHEDULE | | | |
|--------------------------|-------------------------|--|--|------------------------|-------------------------------------|--|---|
| TAG | MANUFACTURER | PRODUCT INFO | NOTES | TAG | MANUFACTURER | PRODUCT INFO | NOTES |
| TRANSITIONS | | | | | | | |
| TR-1 | SCHLITZ | DILEX ANKA - ANODIZED ALUMINUM | COVE BASE @ RESTROOMS | LV1-1 | TANBUS CENTIVA | HERITAGE PLANK ENP - SMOKED OAK 3350 | @ BREAK ROOM & ELEVATOR LOBBY |
| TR-2 | SCHLITZ | RENO-U | FROM CPT OR LVT TO EXISTING SC | CARPET | | | |
| TR-3 | TARKETT | SUM LINE TRANSITION SLTXX-C-29 MOON ROCK | TRANSITION BETWEEN CPT AND LVT | CPT-1 | SHAW | ACHROMATIC CHARCOAL - 18703P | GENERAL |
| TR-4 | SCHLITZ | INDEC | OUTSIDE CORNERS @ RESTROOM TILE | CPT-2 | MCHAWK | COLORBEAT - 553 TANGO - 247024 | ACCENT @ COLLAB. ROOMS - BRICKASHLAR |
| PLASTIC LAMINATES | | | | | | | |
| PL-1 | FORMICA | GRAPHITE TMLL - INFINITI FINISH | ELEVATOR CABIN | CPT-3 | MCHAWK | DEHM - HEM GT179 - 585 BODOTDIF - 247024 | GEN. @ COLLAB. RMS & CONF. RM - BRICKASH |
| PL-2 | NEUMAR | CARABILLO W230355 | VERTICAL | PAINT | | | |
| SOLID SURFACE | | | | | | | |
| SS-1 | CEASARSTONE | QUARTZ - OCEAN FOAM 5141 | COUNTERTOPS | P-1 | SHERWIN WILLIAMS | COLOR TO MATCH PPG - 1391-3 THIN ICE | GENERAL COLOR, EPOXY FINISH @ BATHROOMS & WATER FOUNTAINS |
| TILE | | | | | | | |
| T-1 | DALTILE | FABRIQUE - NOIR LINEN 12'X24" - EPOXY GROUT, TBD | WALLS @ RESTROOMS 7'-0" AFF (INCLUDING T-2); PAINT AS NOTED ABOVE TILE | P-2 | SHERWIN WILLIAMS | SW 7017 DORIAN GRAY | ACCENT WALL @ OFFICES |
| T-2 | DALTILE | FABRIQUE - NOIR LINEN - 3'X12" BULLNOSE | TOP OF T-1 @ RESTROOM WALLS | P-3 | SHERWIN WILLIAMS | SW 6871 POSITIVE RED | ACCENT COLOR |
| RUBBER BASE | | | | | | | |
| RB-1 | TARKETT | 4" COVE BASE - 29 MOON ROCK | GENERAL | P-4 | SHERWIN WILLIAMS | SW 7005 TOQUE WHITE | GENERAL COLOR @ OFFICES |
| RB-2 | TARKETT | 4" COVE BASE - 52 BLUE LAGOON | @ COLLAB. ROOMS AND CONFERENCE ROOM | P-5 | SHERWIN WILLIAMS | SW 6510 LOYAL BLUE | ACCENT COLOR |
| WALL PROTECTION | | | | | | | |
| WRP-1 | REFER TO SPECIFICATIONS | | UP TO 4'-0" AFF | SEALED CONCRETE | | | |
| WP-1 | KOROSEAL | 4X8 STANDARD KOROSAFD SHEET - BRUSHED ALUM. | BEHIND WATER FOUNTAINS | EXIST / SC | EXISTING CONCRETE SLAB TO BE SEALED | | |

FINISH PLAN LEGEND

NOTE: CHANGES IN FLOORING MATERIAL PROVIDE APPROVED TRANSITION STRIP

DIRECTION OF FLOOR PATTERN INSTALLATION

GENERAL NOTES

- PAIN ALL WALLS SATIN FINISH, U.N.O.
- ALL FLAT, SATIN, AND SEMI-GLOSS PAINTS TO BE SHERWIN WILLIAMS PRIMAAR 200.
- INSTALL FINISH MATERIALS PER MANUFACTURER'S SPECIFICATIONS AND REQUIREMENTS, U.N.O.
- DO NOT USE A TILE LESS THAN A THIRD OF ITS ORIGINAL SIZE.
- TYPICAL TRANSITION $\text{---} \times \text{---}$ TO BE TR-2. REFERENCE FINISH LEGEND FOR MORE INFORMATION.
- TYPICAL TRANSITION $\text{---} \times \text{---}$ TO BE TR-2. REFERENCE FINISH LEGEND FOR MORE INFORMATION.
- TYPICAL TRANSITION $\text{---} \times \text{---}$ TO BE TR-3. REFERENCE FINISH LEGEND FOR MORE INFORMATION.

FINISH PLAN LEGEND

ACCENT FINISH DESIGNATION

FLAME SPREAD AND SMOKE DEVELOPMENT: PER 2012 NFPA 101, CH 38.3.3

INTERIOR WALL AND CEILING FINISH: EXITS & EXIT ACCESS CORRIDORS - CLASS A OR B

OTHER SPACES - CLASS A, B, OR C

FLOOR FINISH: EXIT ENCLOSURES - CLASS I OR II

REFERENCE TABLE A.10.2.2

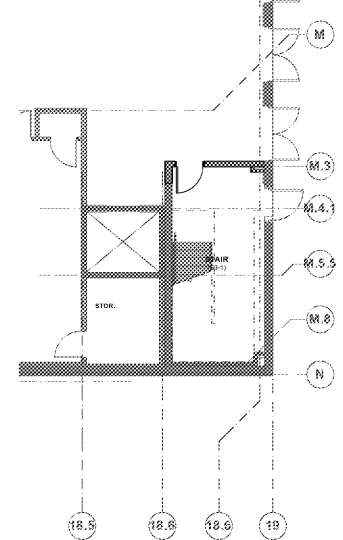

PARTIAL FIRST LEVEL FINISH PLAN
 1 A-711 SCALE: 1/8" = 1'-0"

PARTIAL FIRST LEVEL FINISH PLAN
 A-711 SCALE: 1/8" = 1'-0"

Order Plans @

WWW.DIline.com