

Order plans @

WWW.IDLine.com

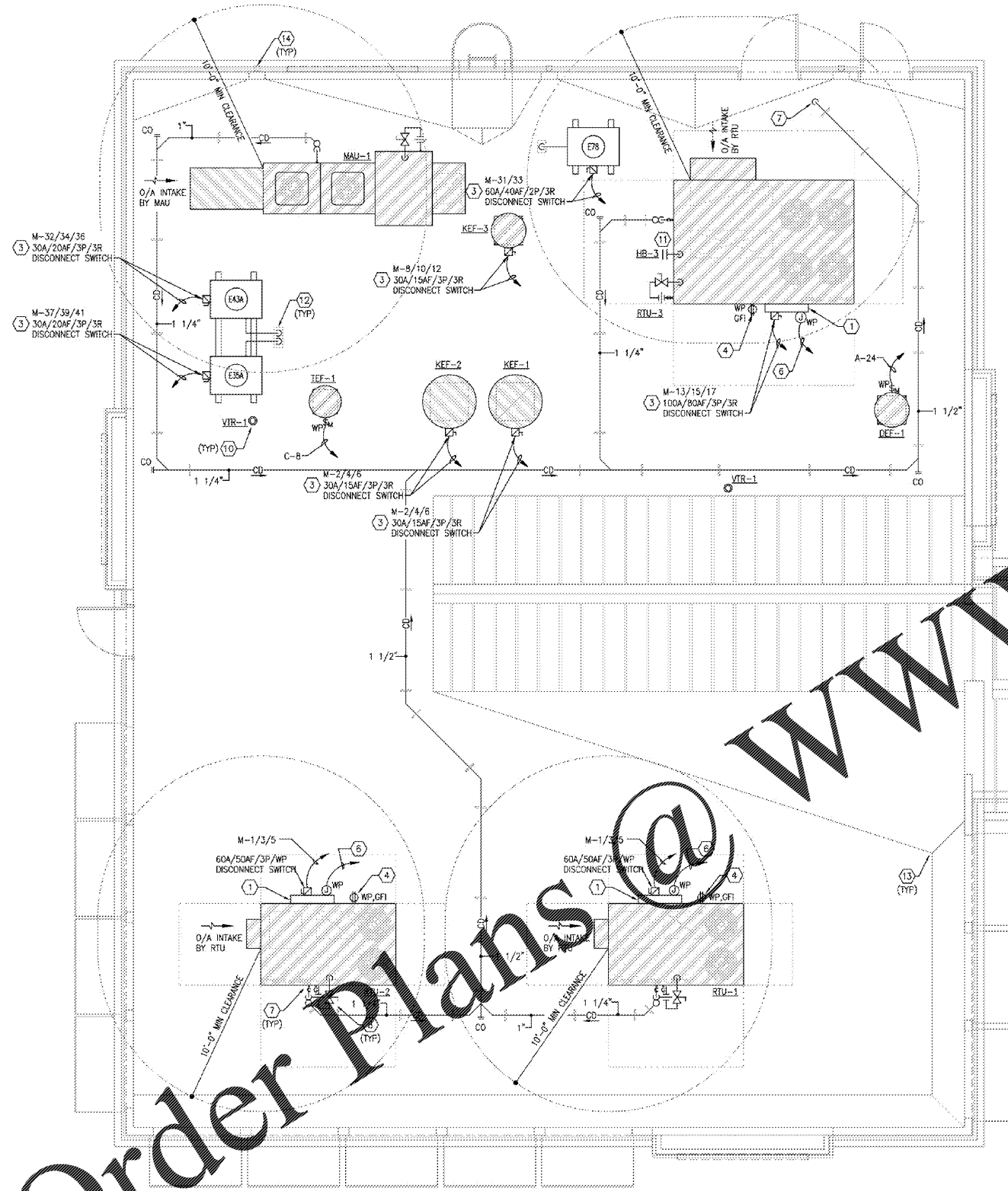

LOBBY AND ENTRY LOBBY HAVE  
MOVED TO BEST ELEVATION, REFER  
TO SHEET A10 FOR UPDATED LAYOUT

GENERAL NOTES

1. ALL OUTDOOR AIR INTAKES BY MECHANICAL EQUIPMENT SHALL HAVE A MINIMUM 10'-0" HORIZONTAL CLEARANCE FROM THE DISCHARGE OF ANY EXHAUST FAN, COMBUSTION EXHAUST OR PLUMBING VENT.
2. PROVIDE VIBRATION ISOLATION DEVICES AND FLEXIBLE DUCT/ PIPING CONNECTIONS TO ALL MOVING MACHINERY NOT INTERNALLY ISOLATED.
3. ELECTRICAL CONTRACTOR IS RESPONSIBLE FOR ALL ELECTRICAL WORK SHOWN ON THE MECHANICAL DRAWINGS.

KEYED NOTES

1. FACTORY PROVIDED AC UNIT CONTROL PANEL (VERIFY LOCATION), HACR BREAKER / DISCONNECT SWITCH FURNISHED WITH EQUIPMENT.
2. VIA STARTER IN MECH. CONTROL PANEL, SEE DETAIL 1/E3.2.
3. VERIFY MOUNTING LOCATION PRIOR TO ROUGH-IN.
4. GFI SERVICE RECEPTACLE FURNISHED WITH MECH. EQUIPMENT. CIRCUIT ON M-28.
5. VERIFY LOCATION & NUMBER OF SENSORS WITH OPEN VENTILATION SIGN CIRCUITS THROUGH CONTRACTOR'S CONTROLLED THROUGH PHOTOCELL. SEE DETAIL 1/E3.3. PROVIDE SURFACE MOUNTED 2-BOX AT INTERIOR FACE OF WALL.
6. ELECTRICAL CONTRACTOR SHALL RUN CONTROL WIRING TO ROOF TOP UNITS, SENSORS AND THERMOSTATS. COORDINATE WITH MECHANICAL CONTRACTOR.
7. CONDENSATE DRAIN FROM THE HVAC UNIT SHALL BE ROUTED ON THE ROOF AS SHOWN AT A MINIMUM PITCH OF 1/4" PER FOOT IN THE DIRECTION OF FLOW. REFER TO THE PLUMBING DWG PLAN FOR CONTINUATION. CONDENSATE DRAINAGE PIPING BELOW THE ROOF.
8. GAS PIPING TO THE MECHANICAL UNIT SHALL TURN BACK THROUGH THE ROOF. PROVIDE WEATHER TIGHT SEAL AT PIPE PENETRATION. REFER TO THE WATER AND GAS PLUMBING PLAN FOR CONTINUATION OF PIPING BELOW THE ROOF.
9. ALL PIPING INSTALLED ON THE ROOF SHALL BE SUPPORTED WITH PRE-MANUFACTURED ADJUSTABLE PIPE SUPPORTS AT MAXIMUM 5'-0" ON CENTER AND EVERY CHANGE OF DIRECTION.
10. ROOF MOUNTED VTR, SIZED AS SHOWN. INSTALLED LOCATION SHALL BE A MINIMUM OF 10'-0" FROM ANY OUTDOOR AIR INTAKE. TOP OF VTR STACK SHALL BE EVEN WITH PARAPET WALL. INSTALL COMPLETE WITH COLOR LEAKY CAP AS SCHEDULED.
11. ROUTE 3/4" COLD WATER UP THROUGH THE TOWER FRAMING, AND CONNECT TO HOSE BIBB MOUNTED ON THE SIDE OF THE ROOF CURB MOUNTED AT 12" ABOVE THE FINISHED ROOF FOR CLEARANCE OF THE ROOF FLASHING. REFER TO WATER AND GAS PLUMBING PLAN FOR CONTINUATION OF PIPING BELOW THE ROOF.
12. FIELD FABRICATED ROOF JACK FOR REFRIGERATION PIPING AND POWER CONDUIT(S) SHALL BE PROVIDED BY THE GENERAL CONTRACTOR. REFER TO ARCHITECTURAL DETAILS FOR DIRECTION. THE MC, EC AND GC SHALL COORDINATE FOR A COMPLETE INSTALLATION.
13. GUTTERS AND GUTTER LEADERS ON THE PITCHED ROOFS SHALL BE BY THE GENERAL CONTRACTOR. REFER TO THE ARCHITECTURAL PLANS FOR ADDITIONAL INFORMATION.
14. PARAPET OPENING AND ROOF DRAIN LEADER MOUNTED ON THE EXTERIOR WALL SHALL BE PROVIDED BY THE GENERAL CONTRACTOR. REFER TO THE ARCHITECTURAL DRAWINGS FOR CONTINUATION.

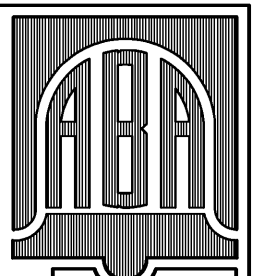

**BELL & ASSOCIATES ARCHITECTS**  
ALAN BELL, DOUG ELKINS  
MARK SMITH, & TROY BELL  
alanbellarchitect.com  
128 GUYTON ROAD  
CAROLTON, GEORGIA 30117  
PHONE (770) 850-8568 FAX (770) 850-6568

REVISIONS BY	

NEW RESTAURANT FOR:  
VILLA RICA, GEORGIA

CONTRACTOR SHALL VERIFY ALL CONDITIONS AND DIMENSIONS BEFORE EXECUTING ANY WORK. THIS DOCUMENT IS THE SOLE PROPERTY OF ALAN BELL ARCHITECT AND SHALL NOT BE COPIED IN WHOLE OR IN PART WITHOUT EXPRESSED WRITTEN CONSENT FROM ALAN BELL ARCHITECT.



DATE: 1/28/2020  
SCALE: AS NOTED  
JOB NO.: 19-015-D01  
SHEET  
**MEP.1**  
OF 1 SHEETS