

LOBBY AND ENTRY LOBBY HAVE MOVED TO WEST ELEVATION. REFER TO SHEET A10 FOR UPDATED LAYOUT

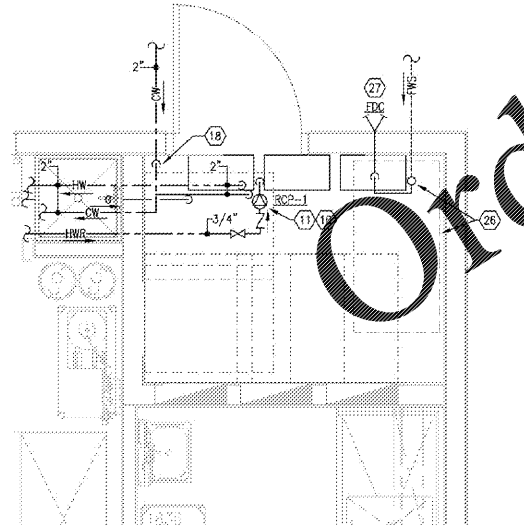
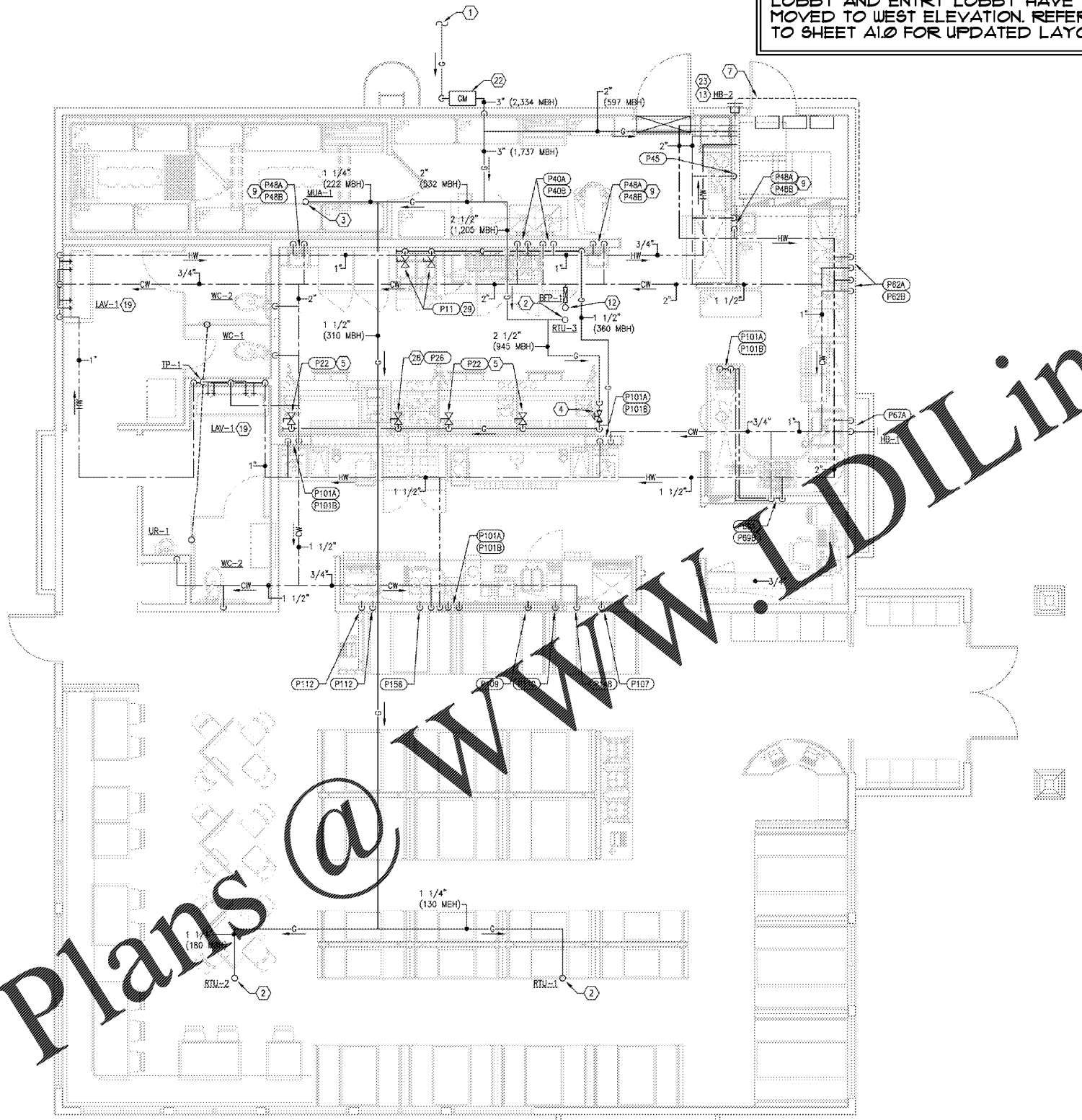

ENLARGED MECHANICAL ROOM PLAN 2
1/2"=1'-0"

PLUMBING WATER AND GAS FLOOR PLAN 1
1/4"=1'-0"

GENERAL NOTES

- A. KEY NOTES WITH ELLIPTICAL SYMBOL AND NUMBER CORRESPOND TO KITCHEN EQUIPMENT SHOWN IN KITCHEN PLAN SHEETS. REFER TO KITCHEN PLANS FOR SUPPLEMENTAL INFORMATION.
- B. ALL EXPOSED PIPING IN PUBLIC AREAS SHALL BE INSTALLED AS TIGHT AS POSSIBLE TO THE WARM SIDE OF THE EXPOSED ROOF STRUCTURE.
- C. THE INSTALLATION OF THE PLUMBING SYSTEMS SHALL BE COORDINATED WITH ALL ELECTRICAL AND MECHANICAL EQUIPMENT, AND STRUCTURAL SLAB AND FRAMING.
- D. REFER TO PLUMBING SHEET P3.1 FOR PLUMBING FIXTURE AND EQUIPMENT SCHEDULES INCLUDING SPECIFICATIONS AND ROUGH-IN SIZES.
- E. REFER TO THE KITCHEN DRAWINGS PREPARED BY THE KITCHEN EQUIP. SUPPLIER FOR ADDITIONAL INFORMATION NOT SHOWN ON THIS SHEET.
- F. PLUMBING CONTRACTOR SHALL COORDINATE WITH THE KITCHEN EQUIPMENT SUPPLIER FOR THE COMPLETE INSTALLATION AND SERVICE CONNECTIONS OF ALL KITCHEN EQUIPMENT.
- G. PLUMBING CONTRACTOR SHALL BE RESPONSIBLE FOR THE COMPLETE INSTALLATION OF ALL WATER LINES TO KITCHEN EQUIPMENT. REFER TO THE KITCHEN DRAWINGS FOR PROPOSED SIZE AND ROUTING. ALL WATER LINES UNDER EQUIPMENT/ MILLWORK SHALL BE INSTALLED SECURELY.
- H. REFER TO ARCHITECTURAL AND MECHANICAL DRAWINGS FOR DETAILS OF COUNTERTOPS, CASEWORK, AND OTHER FIXTURES. SHOW EXACT LOCATION OF OPENINGS FOR PLUMBING ITEMS TO BE INSTALLED. COORDINATE THE COMPLETE INSTALLATION WITH THE GENERAL CONTRACTOR.
- I. PLUMBING CONTRACTOR TO FIELD AND VERIFY ALL WATER LINES PRIOR TO THE INSTALLATION OF THE PLUMBING SYSTEM.
- J. ALL WATER PIPING SYSTEMS SHALL BE SECURELY TIED TO THE STRUCTURE WITH SUPPORTS WORKING TO ELIMINATE MOVEMENT. FINAL CONNECTIONS TO KITCHEN SINKS SHALL BE HARD PIPED.
- K. ALL FIXTURES AND EQUIPMENT SHALL BE INSTALLED WITH WATER SUPPLY STOP VALVES AT ACCESSIBLE LOCATIONS. PROVIDE LINE SIZED BALL VALVES FOR BEVERAGE FIXTURES.
- L. PROVIDE PIPE SUPPORTS AND EXPANSION LOOPS AS REQUIRED.
- M. PLUMBING CONTRACTOR TO ARRANGE AND PAY FOR ALL REQUIRED FEES, PERMITS, AND MISCELLANEOUS COSTS ASSOCIATED WITH THE PLUMBING WORK PER LOCAL PLUMBING CODES.
- N. ALL PENETRATIONS IN FIRE RATED WALL ASSEMBLIES SHALL BE SEALED WITH UL LISTED FIRE STOPPING MATERIAL.

KEYED NOTES

- 1. REFER TO THE CIVIL PLANS FOR PROPOSED LOCATION OF THE GAS METER AND REGULATOR. COORDINATE THE COMPLETE INSTALLATION WITH THE LOCAL GAS UTILITY.
- 2. ROUTE GAS PIPING UP THROUGH THE ROOF TO GAS CONNECTION AT THE ROOFTOP UNIT. REF: TO SHEET MEP1.1 FOR CONTINUATION ON THE ROOF.
- 3. ROUTE GAS PIPING UP THROUGH THE ROOF TO GAS CONNECTION AT THE MAKEUP AIR UNIT. REF: SHEET MEP1.1 FOR CONTINUATION ON THE ROOF.
- 4. MECHANICAL PLUG VALVE SHALL BE FURNISHED WITH EXHAUST HOOD PACKAGE AND INSTALLED BY THE PLUMBING CONTRACTOR. VALVE SHALL BE INSTALLED IN AN ACCESSIBLE LOCATION (ABOVE THE LAY-IN CEILING IF ALLOWED BY LOCAL JURISDICTION).
- 5. 1 1/4" COMPLETE W/ SOC AND UNION (180 MBH) FOR PANCAKE GRIDDLE. FLEXIBLE HOSE CONNECTION WITH QUICK DISCONNECT PROVIDED BY REC AND INSTALLED BY PLUMBING CONTRACTOR.
- 6. 2" DOMESTIC WATER SERVICE. REFER TO THE CIVIL DWG PACKAGE FOR CONNECTION TO SITE UTILITIES.
- 7. REFER TO THE ENLARGED PLAN FOR CONTINUATION OF PIPING AND EQUIPMENT LAYOUT IN THE MECHANICAL ROOM.
- 8. 1/2" CW BELOW FLOOR, FROM TRAP PRIMER TO RECEPTOR.
- 9. ROUTE 1/2" HW & CW TO HAND WASHING FIXTURE. INSTALL SUPPLIES COMPLETE WITH HOT WATER TEMPERING VALVE.
- 10. FIELD COORDINATE THE INSTALLATION OF THE INLINE HOT WATER RECIRCULATION PUMP, EXPANSION TANK AND CHECK VALVE ASSEMBLY.
- 11. TERMINATE THE HOT WATER RETURN TO THE SOFTENED WATER SUPPLY TO THE WATER HEATERS AS SHOWN, AND INSTALL COMPLETE WITH LINE SIZED CHECK VALVE. ROUTE THE 2" SW, 2" HW, AND 2" GAS TO THE WALL MOUNTED WATER HEATERS.
- 12. ROUTE 3/4" COLD WATER UP WITHIN THE ROOF TOWER AND TERMINATE ON THE SIDE OF THE TOWER WITH HOSE BIBB. REFER TO SHEET MEP1.1 FOR CONTINUATION ON THE ROOF TO HR-3.
- 13. COORDINATE LOCATION OF WALL MOUNTED HOSE BIBB(S) WITH TRASH ENCLOSURE LAYOUT.
- 14. COORDINATE INSTALLATION OF ACCESSIBLE LINE SIZED SHUT OFF VALVE TO ICE MAKER. SHUT OFF VALVE SHALL BE RECESSED IN THE WALL AND COVERED WITH ACCESS PANEL.
- 15. ALL WATER PIPING IN THE COOKLINE WALL WITHIN 18" OF THE TYPE 1 EXHAUST HOOD SHALL BE INSTALLED AS RIGID COPPER PIPE. NO PLASTIC TUBING ALLOWED.
- 16. WATER PIPING SHALL BE SUPPORTED FROM AND INSTALLED TIGHT TO THE UNDERSIDE OF THE CHEF'S COUNTER. REFER TO KITCHEN PLANS FOR ROUGH-IN INFORMATION.
- 17. NO PIPING SHALL BE INSTALLED ABOVE THE PROPOSED LOCATION OF INTERIOR ELECTRICAL PANEL(S).
- 18. DOMESTIC WATER SERVICE RISER SHALL BE INSTALLED COMPLETE WITH LINE SIZED SHUT OFF VALVE, VERTICAL DOUBLE CHECK BACKFLOW PREVENTOR (AS APPROVED BY THE UTILITY AND JURISDICTION HAVING AUTHORITY), AND PRESSURE REDUCING VALVE ASSEMBLY WHERE INLET PRESSURE EXCEEDS 75 PSI.
- 19. ROUTE 1/2" WARM WATER FROM UNDERCOUNTER WATER HEATER TO HAND WASHING FIXTURE. INSTALL COMPLETE WITH SUPPLIES AND STOPS, AND MIXING VALVE MXXV-1 FOR REGULATED TEMPERATURE TO THE FAUCET.
- 20. 1 1/4" CAPPED STUB COMPLETE W/ SOC AND UNION FOR FUTURE EQUIPMENT CONNECTION (BY OTHERS). COORDINATE REQUIREMENTS WITH CONSTRUCTION MANAGER PRIOR TO INSTALLATION. REFER TO THE FOOD SERVICE PLANS FOR PROPOSED MOUNTING HEIGHT OF THE GAS PIPING.
- 21. ROUTE 1/2" TEMPERED WATER FROM THE MIXING VALVE BELOW THE HANDWASH SINK, TO THE DIPPER WELLS AS SHOWN.
- 22. THE MAIN GAS DISCONNECT SHALL BE IDENTIFIED BY A CITY APPROVED SIGN WHICH CONSISTS OF A PERMANENT ALL-WEATHER SIGN SECURED TO THE BUILDING IMMEDIATELY ADJACENT TO THE PRIMARY SHUT OFF VALVE AT THE METER ASSEMBLY. THE SIGN SHALL READ: "MAIN GAS DISCONNECT". THE SIGN SHALL CONTAIN WHITE, REFLECTIVE LETTERING ON A RED BACKGROUND. THE SIGN SHALL BE 7 INCHES IN HEIGHT AND 10 INCHES IN WIDTH. LETTERING SHALL BE A MIN. OF ONE-INCH IN HEIGHT.
- 23. COORDINATE INSTALLATION OF WALL MOUNTED HOSE BIBB, WITH INTERIOR WALL FRAMING AND EXTERIOR FINISHES. REFER TO ARCHITECTURAL ELEVATION FOR ADDITIONAL INFORMATION.
- 24. EXTEND HOT WATER PIPING LOOP DOWN IN WALL AS SHOWN. REFER TO THE DETAIL ON SHEET P4.2 FOR ADDITIONAL INFORMATION.
- 25. 6" FIRE WATER SERVICE. REFER TO THE CIVIL DWG PACKAGE FOR CONNECTION TO SITE UTILITIES. REFER TO FIRE SPRINKLER DESIGN PREPARED BY A DULY LICENSED CONTRACTOR, FOR MINIMUM REQUIRED SIZE OF SERVICE.
- 26. PLUMBING CONTRACTOR SHALL ROUGH-IN 6" FIRE SERVICE TO THE MECHANICAL ROOM. THE FIRE RISER ASSEMBLY SHALL BE INSTALLED BY A DULY LICENSED FIRE PROTECTION CONTRACTOR. 4'X2' RISER FOOTPRINT SHOWN FOR AVAILABLE CLEARANCE.
- 27. FIRE WATER LINE TO FIRE DEPARTMENT CONNECTION TO BE INSTALLED BY THE FIRE SPRINKLER CONTRACTOR. REFER TO CIVIL FOR LOCATION AND DETAIL OF FDC INSTALLATION. COORDINATE COMPLETE INSTALLATION WITH THE FIRE SPRINKLER DESIGN.
- 28. 1 1/2" COMPLETE W/ SOC AND UNION (180 MBH) FOR 6 BURNER RANGE. FLEXIBLE HOSE CONNECTION WITH QUICK DISCONNECT PROVIDED BY REC AND INSTALLED BY PLUMBING CONTRACTOR.
- 29. 1 1/4" COMPLETE W/ SOC AND UNION (120 MBH) FOR FRYER. FLEXIBLE HOSE CONNECTION WITH QUICK DISCONNECT PROVIDED BY REC AND INSTALLED BY PLUMBING CONTRACTOR.

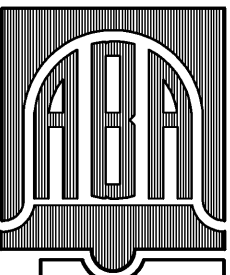

BELL & ASSOCIATES ARCHITECTS
ALAN BELL, DOUG EKINS
MARK SMITH & TROY BELL
alanbellarchitect.com
128 JOYBORN ROAD
CAROLTON, GEORGIA 30137
PHONE: (770) 580-0808 FAX: (770) 580-0808

REVISIONS	BY

NEW RESTAURANT FOR:

VILLA RICA, GEORGIA

CONTRACTOR SHALL VERIFY ALL CONDITIONS AND DIMENSIONS BEFORE EXECUTING ANY WORK. THIS DOCUMENT IS THE SOLE PROPERTY OF ALAN BELL ARCHITECT AND SHALL NOT BE COPIED IN WHOLE OR IN PART WITHOUT EXPRESSED WRITTEN CONSENT FROM ALAN BELL ARCHITECT.



DATE: 1/28/2020
SCALE: AS NOTED
JOB NO.: 19-015-D01
SHEET
P1.2
OF 7 SHEETS