

**GENERAL NOTES**

1. DIMENSIONS ARE TAKEN FROM FINISH FACE OF EXTERIOR WALL OR NOMINAL FINISH FACE OF INTERIOR PARTITION.
2. DIMENSIONAL CONFLICTS BETWEEN PARTITION TYPES AND THE ARCHITECTURAL FLOOR PLAN SHALL BE BROUGHT TO THE ATTENTION OF THE ARCHITECT.
3. CONTRACTOR SHALL COORDINATE MECHANICAL DUCTWORK PRIOR TO FABRICATION OF PARTITION WALLS.
4. SHOULD CONDITIONS OCCUR WHERE A HALL IS UNABLE TO GO STRAIGHT UP TO STRUCTURE DUE TO PIPING, DUCTWORK, ETC., THE PARTITION (GYPSUM BOARD AND FRAMING) MAY JOG HORIZONTALLY ABOVE THE CEILING TO AVOID THE PROBLEM.
5. WHERE STUDS EXTEND TO STRUCTURE AND GYPSUM WALL BOARD AND SOUND ATTENUATION BLANKETS EXTEND JUST ABOVE THE FINISH CEILING, CAP OFF PARTITION FINISHES WITH A RUNNER CHANNEL WHEN CEILING FLENUM IS USED AS A RETURN AIR FLENUM.
6. TILE BACKER BOARD SHALL BE USED IN ALL LOCATIONS TO RECEIVE TILE FINISHES. REFER TO FINISH SCHEDULE AND INTERIOR ELEVATIONS FOR LOCATIONS.
7. LOCATE DOOR OPENINGS 4" FROM NEAREST PERPENDICULAR WALL.
8. INSTALL BLOCKING IN PARTITIONS FOR CASEWORK, WALL MOUNTED EQUIPMENT.
9. AT ALL PARTITIONS THE CONTRACTOR IS TO MAINTAIN THE FIRE-RESISTIVE INTEGRITY.
10. REFER TO UNDERWRITERS LABORATORIES, INC. FIRE RESISTIVE VOLUMES - CURRENT EDITION FOR SPECIFIC CONSTRUCTION REQUIREMENTS OF UL LISTED ASSEMBLIES.
11. REFER TO MECHANICAL, ELECTRICAL, AND PLUMBING DRAWINGS FOR ALL LISTED PENETRATIONS THROUGH FIRE-RATED ASSEMBLIES. CONTRACTOR SHALL BE RESPONSIBLE FOR FINDING APPROPRIATE PROJECT-SPECIFIC UL LISTED ASSEMBLIES FOR PENETRATIONS.
12. ALL PIPE AND CONDUIT PENETRATIONS THRU FIRE RESISTIVE PARTITIONS, FLOORS, ETC., SHALL BE SEALED WITH A RESPECTIVELY FIRE RATED BARRIER PENETRATION SEALING SYSTEM, 3/4" OR UL APPROVED EQUAL.
13. SUBSTITUTE 3/4" MOISTURE RESISTANT GIB ON HALL SIDES OF PARTITION WALLS (4FT HIDE CENTERED ON FIXTURE UP TO 8 FT HIGH A.F.F.)

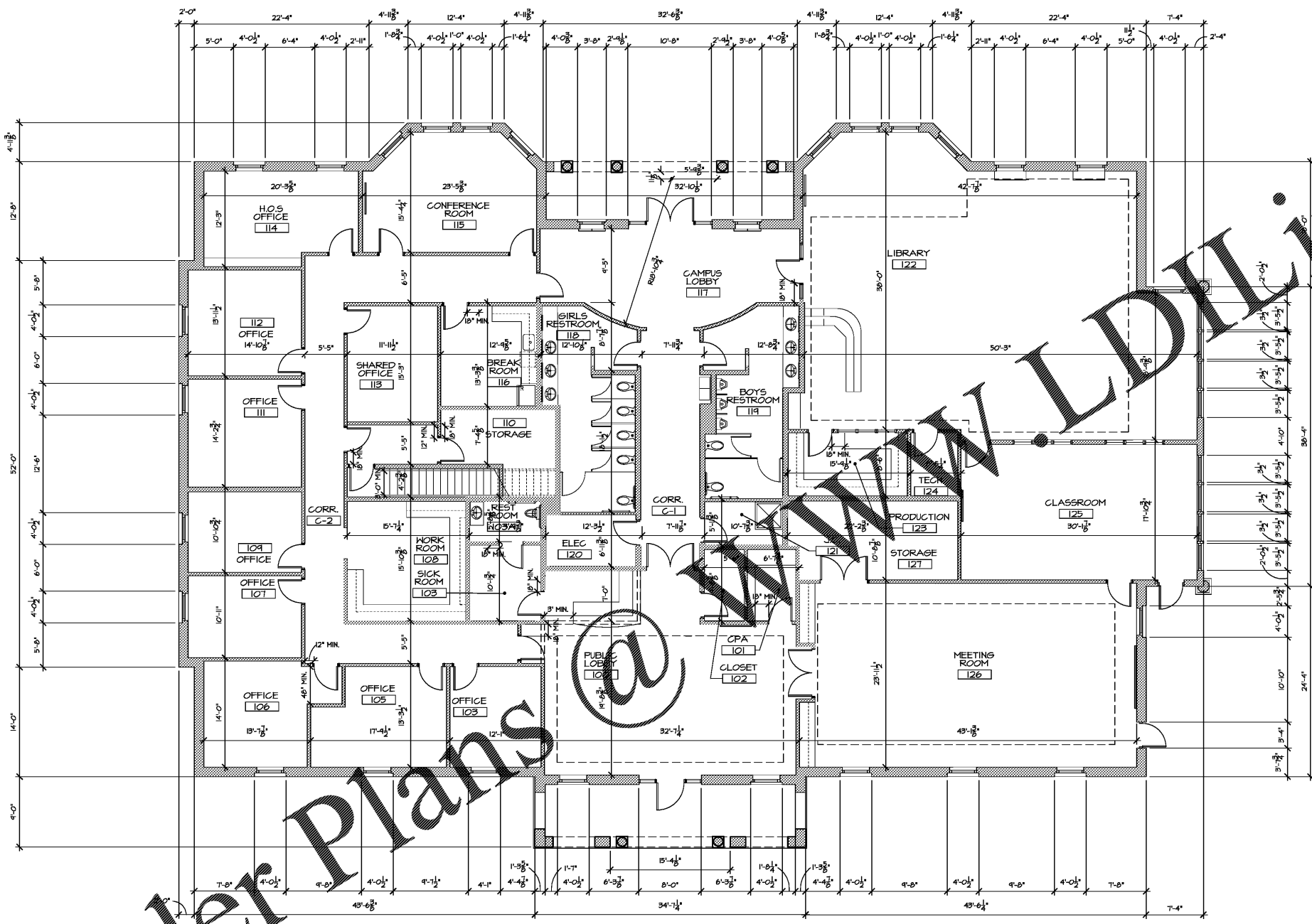

Order Plans

www.LDOnline.com

**FIRST FLOOR PLAN INTERIOR DIMENSIONS**  
SCALE: 1/8" = 1'-0"

1  
A1.2



T E A G U E  
F R E Y A L D E N H O V E N  
F R E Y A L D E N H O V E N  
A R C H I T E C T S & P L A N N E R S , L P C

300 NORTH GREENE STREET  
SUITE 285  
GREENSBORO  
NORTH CAROLINA 27401  
TEL. 336.273.0101  
FAX. 336.273.0141

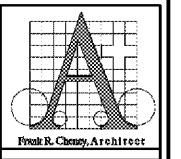

CANTERBURY SCHOOL  
P. DAVID BROWN BUILDING  
5400 OLD LAKE JEANETTE RD  
GREENSBORO, NORTH CAROLINA

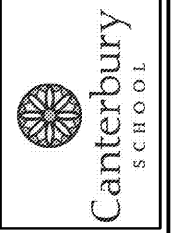

DATE	JAN 30, 2020
PROJECT #	19117
FILE #	19117-A1-2
REVISIONS	

THIS DRAWING IS AN INSTRUMENT OF PROFESSIONAL SERVICE PREPARED BY TET ARCHITECTS & PLANNERS, L.P.C. (TET) AND IS THE PROPERTY OF TET. ALIENATION OF THIS DOCUMENT BY ANY PARTY OTHER THAN TET IS A VIOLATION OF LAW THAT WILL BE PROSECUTED TO ITS FULLEST EXTENT. THIS DRAWING SHALL NOT BE USED FOR ANY WORK OTHER THAN THAT AUTHORIZED BY THE ARCHITECT. IT IS NOT TO BE COPIED OR REPRODUCED IN PART OR WHOLE.

SHEET  
**A1.2**