

GENERAL NOTES

- (A) REFER TO PROJECT MANUAL FOR ADDITIONAL REQUIREMENTS.
- (B) FIXTURES AND EQUIPMENT SHOWN FOR REFERENCE ONLY AND ARE OWNER FURNISHED AND INSTALLED.
- (C) DIMENSIONS TO ROUGH FACE OF ROUGH FRAMING OR FACE OF FIXTURE UNLESS OTHERWISE NOTED.
- (D) PROVIDE SUSPENDED CEILING SEISMIC BRACING WHERE REQUIRED, REFER TO DETAIL 9/A4.2
- (E) ALL FINISH SUBSTITUTION REQUEST REQUIRE OWNER PRIOR APPROVAL.

PROFESSIONAL ARCHITECTURAL
REGISTRATION NO. 010445

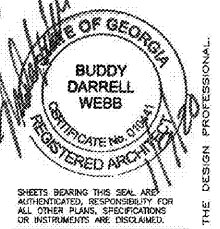

THESE SHEETS BEARING THIS SEAL ARE AUTHENTICATED. RESPONSIBILITY FOR ALL OTHER PLANS, SPECIFICATIONS OR INSTRUMENTS ARE DISCLAIMED.

INTERIOR FINISH TYPES

FLOORS

F-1:
TYPE: POLISHED CONCRETE FINISH
MFG. (REFER TO PROJECT MANUAL - SECTION 03 35 43)
COLOR: NATURAL CONCRETE, CLEAR

F-2:
TYPE: LIQUID DENSIFIER TREATED CONCRETE FINISH
MFG. (REFER TO PROJECT MANUAL - SECTION 03 30 00)
COLOR: NATURAL CONCRETE, CLEAR

BASE

B-1:
TYPE: RESILIENT BASE
MFG: EQUAL TO VPI
SIZE: 4" COVE
COLOR: JET, #01

WALLS

W-2:
TYPE: PAINT
MFG: SHERWIN WILLIAMS
SERIES: SEMI GLOSS LATEX
COLOR: SW6126 "NAVAJO WHITE"

W-3:
TYPE: PAINT
MFG: SHERWIN WILLIAMS
SERIES: SEMI GLOSS LATEX
COLOR: SW6488 "HUNT CLUB"

W-4:
TYPE: SANITARY WALL AND CEILING PANEL SYSTEM
MFG. (REFER PROJECT MANUAL)
COLOR: WHITE

CEILINGS

C-1:
TYPE: ACOUSTICAL TILE CEILING
SIZE: 24" X 48" X 5/8", SQUARE EDGE
MFG: ARMSTRONG SPECIFIED
SERIES: 1729 "FINE FISSURED"
COLOR: WHITE
GRID SERIES: "PRELUDE" 15/16" EXPOSED TEE SYSTEM
GRID COLOR: WHITE

C-2:
TYPE: EXPOSED INSULATION VAPOR BARRIER (WHITE) AND EXPOSED STEEL FRAMING SYSTEM (FACTORY PRIMED)

C-3:
TYPE: PAINT
MFG: SHERWIN WILLIAMS
SERIES: SEMI GLOSS LATEX
COLOR: SW6126 "NAVAJO WHITE"

DOORS AND FRAMES

D-1 (INTERIOR WOOD DOORS):
TYPE: STAIN
SPECIES: CUSTOM GRADE ROTARY SLICED NATURAL BIRCH
FINISH: FACTORY FINISHED
COLOR: EQUAL TO "GRAHAM" #900, MEDIUM BROWN

D-2 (INTERIOR HOLLOW METAL FRAMES):
TYPE: PAINT
MFG: SHERWIN WILLIAMS
SERIES: SEMI GLOSS ENAMEL
COLOR: SW6488 "HUNT CLUB"

D-3 (EXTERIOR DOORS & FRAMES):
TYPE: PAINT
FINISH: REFER TO EXTERIOR FINISH SCHEDULE
COLOR: REFER TO EXTERIOR FINISH SCHEDULE

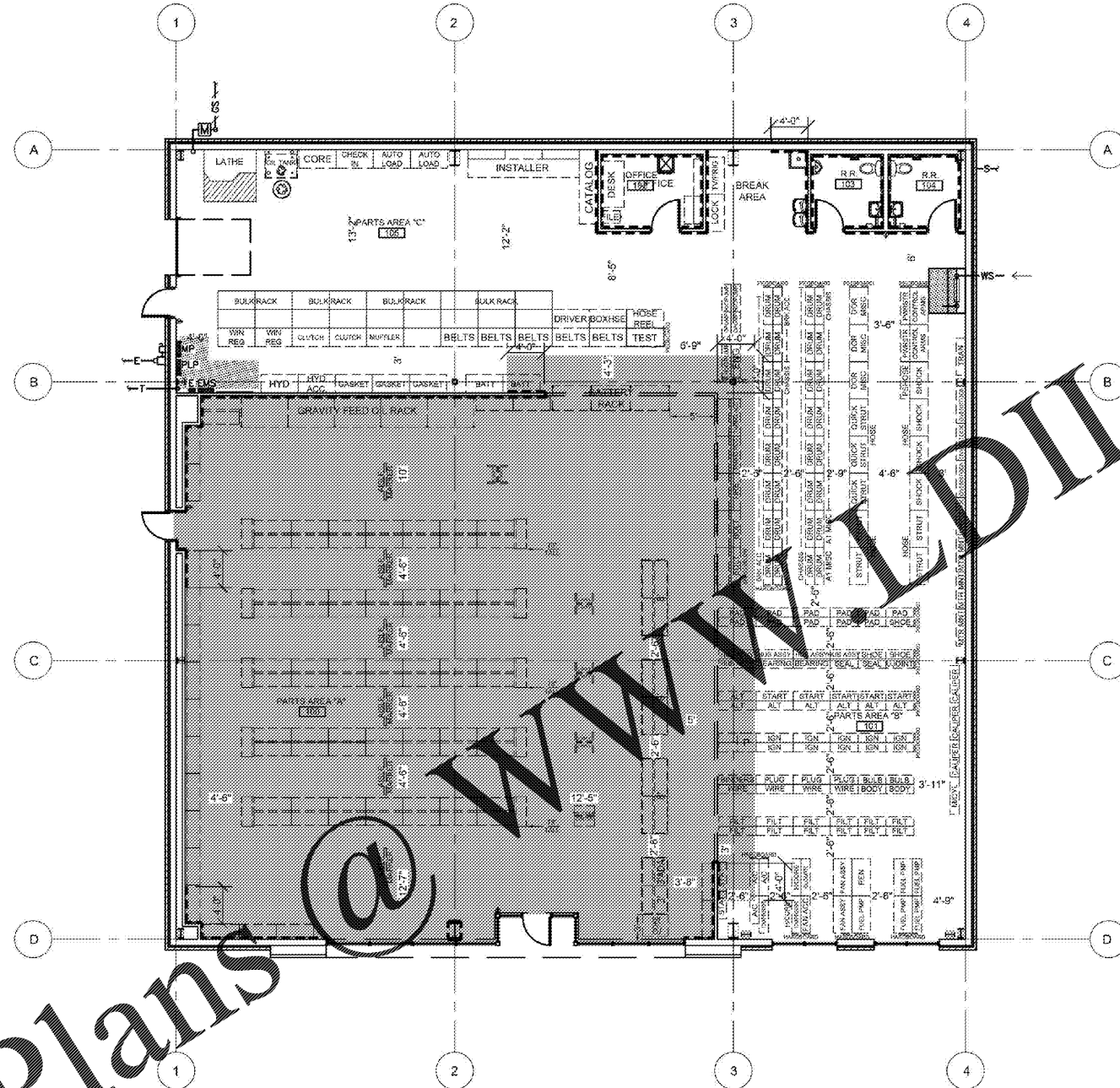

1 FINISH PLAN
A1.2 SCALE: 1/8" = 1'-0"

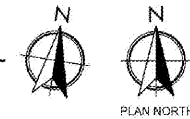

INTERIOR FINISH SCHEDULE

NO.	ROOM OR SPACE	FLOORING		WALLS				CEILING		DOORS		NOTES
		TYPE	BASE	NORTH	EAST	SOUTH	WEST	TYPE	HEIGHT	DOOR	FRAME	
100	PARTS AREA (A)	F-1	B-1	W-2, 3	W-2, 3	W-2, 3	W-2, 3	C-1	11'-6"	D-3	D-3	2, 4, 6
101	PARTS AREA (B)	F-2	N/A	W-2, 3	W-2, 3	W-2	W-2, 3	C-2	VARIABLES	-	-	1, 2, 3, 5
102	OFFICE	F-2	B-1	W-2	W-2	W-2	W-2	C-3	8'-6"	D-1	D-2	2
103	REST ROOM	F-2	B-1	W-4	W-4	W-4	W-4	C-3	8'-6"	D-1	D-2	2
104	REST ROOM	F-2	B-1	W-4	W-4	W-4	W-4	C-3	8'-6"	D-1	D-2	2
105	PARTS AREA (C)	F-2	N/A	W-2, 3	W-2, 3	W-2	W-2	C-2	VARIABLES	D-3	D-3	1, 2, 5

INTERIOR FINISH SCHEDULE NOTES:
 1. PAINT EXTERIOR OF (102) OFFICE, (103) RESTROOM, AND (104) RESTROOM WITH W-3 AND PROVIDE BASE B-1. WHERE MULTIPLE WALL FINISH TYPES INDICATED IN SCHEDULE RELATES TO VARIOUS WALL FINISH TYPES BY ROOM OR SPACE PLAN ORIENTATION ONLY AND IS NOT INTENDED AS WAINSCOT PATTERNING OF FINISHES ON A SINGLE WALL PLANE.
 2. LOCATION OF BASE GRAPHICALLY INDICATED ON DRAWING, REFER SYMBOLS LEGEND.
 3. PROVIDE PIECES OF 2' LENGTH BASE FOR INSTALLATION AT ENDS OF PARTS AREA "B" FIXTURES FACING PARTS AREA "A".
 4. REFER TO ELECTRICAL DRAWINGS FOR GRID LAYOUT.
 5. (WHERE OCCURS) PAINT INTERIOR ISOLATED EXPOSED STRUCTURAL STEEL COLUMNS TO MATCH W-3. (UNLESS OTHERWISE INDICATED) EXPOSED EXTERIOR PERIMETER STRUCTURAL STEEL COLUMNS TO BE FACTORY PRIMED ONLY.
 6. REFER TO 14/A4.1 FOR PARTS AREA "A" TYPICAL PAINT SCHEME LAYOUT AND FINISH TYPE LOCATIONS FOR ROOM INTERIOR PERIMETER WALLS.

SYMBOLS LEGEND

- F-1: POLISHED CONCRETE.
- F-2: LIQUID DENSIFIER TREATED CONCRETE
- B-1: BASE.

Order Plans @ WWW.DIline.com



PROJECT:
NEW O'REILLY AUTO PARTS STORE
6472 GA-42
REX, GEORGIA
INTERIOR FINISH PLAN

Buddy Webb, NCARB, AIA
Architect - Consultant
3057 EAST CAIRO
SPRINGFIELD, MISSOURI 65802
(417) 877-1395 TELEPHONE
(417) 877-8736 FAX

DRAWN BY: _____ CHECKED BY: _____
 AS LG
 DATE: 01/08/20
 REVISION:
 PROJECT NUMBER:
REX
 SHEET NUMBER

A1.2