

## GENERAL NOTES

- (A) REFER TO PROJECT MANUAL FOR ADDITIONAL REQUIREMENTS.
- (B) ALL DIMENSIONS TO ROUGH FACE OF ROUGH FRAMING, CONCRETE, MASONRY OR CENTERLINE OF STRUCTURE, UNLESS OTHERWISE NOTED. COLD FORM METAL STUD INTERIOR PARTITION DIMENSIONS 3/8" UNLESS OTHERWISE INDICATED AND NOT SHOWN FOR CLARITY.
- (C) REFER TO EXTERIOR AND INTERIOR FINISH SCHEDULES FOR ADDITIONAL REQUIREMENTS.
- (D) REFER TO PRE-ENGINEERED METAL BUILDING SHOP DRAWINGS FOR ADDITIONAL REQUIREMENTS. NOTIFY ARCHITECT IF FINAL DESIGN CONDITIONS DEVIATE SUBSTANTIALLY FROM THOSE INDICATED HEREIN.

INDIVIDUAL ARCHITECTURAL REGISTRATION NO. 010441

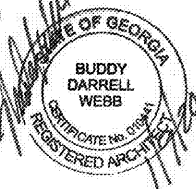

SHEETS BEARING THIS SEAL ARE AUTHENTICATED. RESPONSIBILITY FOR ALL OTHER PLANS, SPECIFICATIONS OR INSTRUMENTS ARE DECLINED.

## KEY NOTES

- (1) UNGRADED STEEL COLUMN, REFER TO PRE-ENGINEERED METAL BUILDING SHOP DRAWINGS. PROVIDE SHEET METAL COVER WITH NO EXPOSED HORIZONTAL SEAMS. FINISH TO MATCH WINDOW FRAMING.
- (2) EXPOSED STEEL COLUMN, REFER TO PRE-ENGINEERED METAL BUILDING SHOP DRAWINGS. (PAINT W-3, REFER INTERIOR FINISH SCHEDULE).
- (3) (NOT USED)
- (4) SURFACE MOUNTED PORTABLE FIRE EXTINGUISHER, REFER TO DETAIL 10/A4.2.
- (5) SHOWROOM CORNER WALL BOX OUT. INSTALL 5/8" FIRE TREATED PLYWOOD BACKING TO BACK SIDE OF STUD INTERIOR FLANGE ON EACH EXPOSED WALL FACE FROM 8'-0" TO 10'-0" A.F.F. FOR INSTALLATION OF SECURITY MIRRORS. REFER TO 4/A4.2 (TYPICAL).
- (6) TACTILE EXIT SIGN AT EXIT DISCHARGE DOOR STATING "EXIT" WITH BRAILLE (GRADE 2 CONTRACTED) LETTERING. SIGN CONSTRUCTION AND LOCATION TO COMPLY WITH ANSI A117.1. MOUNT 48" MINIMUM ABOVE FINISH FLOOR TO BOTTOM OF LOWEST TACTILE CHARACTER AND 60" MAXIMUM ABOVE FINISH FLOOR TO BOTTOM OF HIGHEST TACTILE CHARACTER.
- (7) STEEL COLUMN. PROVIDE 7/8" COLD FORM FURRING (20 GA.) OR FIRE TREATED 2X NAILERS AT 24" O.C. WITH 5/8" TYPE 'X' GYPSUM BOARD. HOLD TIGHT AND PLUMB WITH COLUMN.

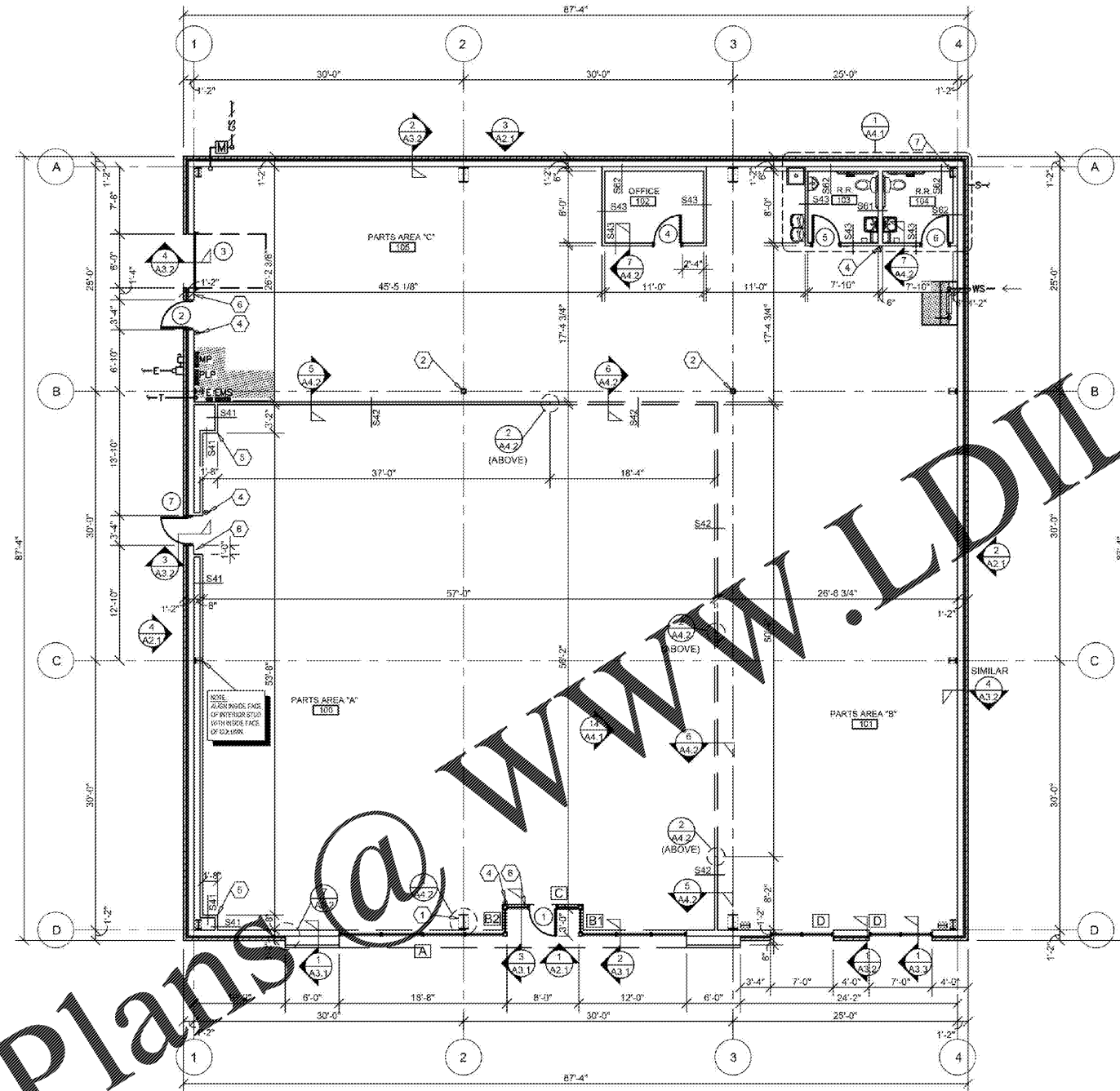

## 1 FLOOR PLAN

A1.1 SCALE: 1/8" = 1'-0"

## INTERIOR WALL TYPES

(SCALE 1/2" = 1'-0")

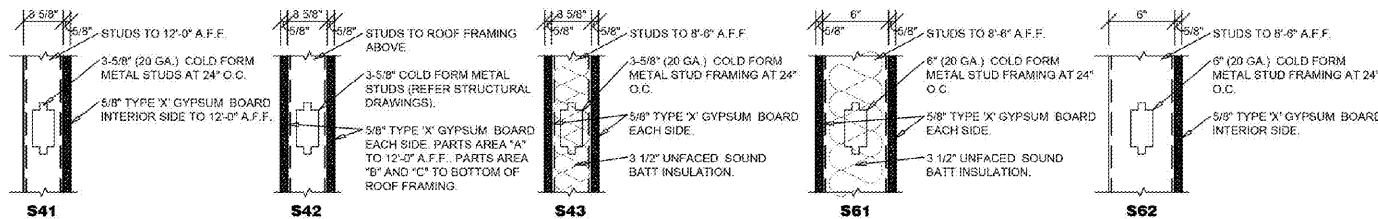

## INTERIOR WALL & CEILING NOTES

1. GENERAL
  - A. REFER TO FINISH SCHEDULES FOR ADDITIONAL WALL FINISH MATERIAL APPLICATIONS.
  - B. REFER TO WALL SECTIONS AND DETAILS FOR ADDITIONAL CONDITIONS.
2. FRAMING:
  - A. PROVIDE FIRE TREATED 2X BLOCKING AS REQUIRED FOR INSTALLATION OF ACCESSORIES PER MANUFACTURER'S RECOMMENDATIONS.
  - B. PROVIDE DIAGONAL WALL BRACING (3" X 16 GA. FLAT STRIP) AT CORNER FACES OF FREE STANDING PARTITION SYSTEMS.
  - C. WHERE WALL FRAMING EXTENDS TO BOTTOM OF ROOF DECK OR STRUCTURE, PROVIDE DEFLECTION CHANNELS AT TOP TRACK FOR 1 1/2" MINIMUM DEFLECTION.
  - D. REFER TO STRUCTURAL DRAWINGS FOR STRUCTURAL STUD REQUIREMENTS.
  - E. REFER TO WINDOW AND DOOR HEAD, JAMB AND SILL DETAILS FOR ADDITIONAL FRAMING REQUIREMENTS.
  - F. PROVIDE HORIZONTAL STUD BRIDGINGS AT 4'-0" O.C. VERTICAL.
3. GYPSUM AND BACKING BOARD:
  - A. EXPANSION/CONTROL JOINTS. INSTALL EXPANSION/CONTROL JOINTS IN CEILINGS EXCEEDING 2500 SQ. FT. IN AREA AND IN PARTITION WALL LENGTHS EXCEEDING 30 FEET. DO NOT EXCEED A DISTANCE OF 50 FEET IN ANY DIRECTION BETWEEN CEILING JOINTS. INSTALL CONTROL JOINTS WHERE FRAMING OR FURRING CHANGES DIRECTION.
  - B. PROVIDE MOISTURE RESISTANT TYPE 'X' GYPSUM BOARD AT ALL WET LOCATIONS (RESTROOMS, WET WALLS, AND JANITOR'S SINK AREAS).
  - C. PROVIDE 'J' MOLDING, REGLETS, OR CORNER BEAD AT GYPSUM BOARD PERIMETER CONDITIONS TRANSITIONING TO DISSIMILAR EXPOSED FINISH MATERIALS.
4. INSULATION:
  - A. INSULATION SHALL HAVE A FLAME SPREAD RATING OF 0-25 AND A SMOKE DEVELOPMENT RATING OF 0-450.
  - B. PROVIDE SEALANT ON BOTH SIDES OF STUD BOTTOM TRACKS AT ACOUSTICAL INSULATED WALL LOCATIONS.
5. FIRE STOPPING:
  - A. PROVIDE FIRE STOPPING AND FIRE SEALANT MATERIALS AS REQUIRED AT ALL FIRE RATED ASSEMBLY TRANSITIONS, PENETRATIONS, AND PERIMETER CONDITIONS. RATING TO BE EQUAL TO RATED ASSEMBLY.

PROJECT:  
NEW O'REILLY AUTO PARTS STORE  
6472 GA-42  
REX, GEORGIA

**FLOOR PLAN**

Buddy Webb, NCARB, AIA  
Architect - Consultant  
3057 EAST CAIRO  
SPRINGFIELD, MISSOURI 65802  
(417) 877-1385 TELEPHONE  
(417) 877-8736 FAX

DRAWN BY: AS  
CHECKED BY: LG  
DATE: 01/08/20  
REVISION:  
PROJECT NUMBER: REX  
SHEET NUMBER:

**A1.1**