

**STRUCTURAL NOTES**

(REFER TO PROJECT MANUAL FOR ADDITIONAL INFORMATION)

- 1. FOOTINGS & FOUNDATION EXCAVATION:**
- A. A GEOTECHNICAL ANALYSIS HAS BEEN PERFORMED ON THIS SITE. SEE PROJECT MANUAL FOR GEOTECHNICAL INFORMATION. APPROPRIATE RECOMMENDATIONS STATED IN THE GEOTECHNICAL REPORT ISSUED BY UNIVERSAL ENGINEERING SCIENCES DATED AUGUST 27, 2019 SHALL BE FOLLOWED.
  - B. THESE FOUNDATIONS HAVE BEEN DESIGNED FOR A SOIL BEARING OF 2500 PSF FOR CONTINUOUS AND ISOLATED FOOTINGS.
  - C. FOUNDATIONS AND SLAB SHOULD BEAR ON ADEQUATE NATURAL SOILS OR ON PROPERLY PLACED AND COMPACTED ENGINEERED FILL. SEE GEOTECHNICAL REPORT FOR SPECIFIC REQUIREMENTS REGARDING EXCAVATION AND PREPARATION OF SUBGRADE. A GEOTECHNICAL ENGINEER SHOULD BE PRESENT TO DIRECT THE REMOVAL OF UNSUITABLE SOILS AND TO DETERMINE THE ADEQUACY OF THE BEARING SURFACE PRIOR TO PLACEMENT OF THE REINFORCEMENT AND CONCRETE.
  - D. FOOTING WIDTHS TO BE AS SHOWN ON PLANS AND DETAILS. BOTTOM OF FOOTING IS TO BE EXCAVATED SQUARE AND TRUE.
  - E. WHERE ANY OPEN TRENCH HAS BEEN EXPOSED TO RAIN, SNOW OR ICE PRIOR TO POURING CONCRETE, ALL REINFORCING IN THAT TRENCH SHALL BE REMOVED AND THE BOTTOM OF THE TRENCH SHALL BE DRAINED OF ALL WATER AND CLEANED OF MUD, SNOW OR ICE. A GEOTECHNICAL ENGINEER OR HIS TECHNICAL REPRESENTATIVE SHALL INSPECT THE BOTTOM OF THE TRENCH AND OBSERVE THE RE-COMPACTING OF SOILS PRIOR TO PLACING REINFORCEMENT AND POURING OF CONCRETE.
  - F. ALL STRIP FOOTINGS SHALL BE CENTERED UNDER WALLS BEING SUPPORTED AND ALL ISOLATED FOOTINGS SHALL BE CENTERED UNDER COLUMNS, UNLESS NOTED OTHERWISE.
  - G. MINIMUM EXTERIOR FOOTING DEPTH SHALL BE AS INDICATED ON THE FOUNDATION PLAN SHEET S2.
  - H. IN THE EVENT THAT ORGANIC SOIL OR UNCOMPACTED FILL IS FOUND BELOW FOOTINGS OR FLOOR SLABS, IT SHALL BE REMOVED AND REPLACED WITH SELECT FILL, PLACED AND COMPACTED AS DESCRIBED IN THE GEOTECHNICAL REPORT.
  - I. STRUCTURAL FILL SHOULD BE PLACED AND COMPACTED AS INDICATED IN THE GEOTECHNICAL REPORT. ADEQUATE DENSITY AND MOISTURE CONTENT TESTS SHOULD BE PERFORMED TO ENSURE COMPLIANCE WITH PROJECT SPECIFICATIONS. SUBGRADE INSPECTION AND FILL TESTING UNDER CONTROLLED CONDITIONS IS CONSIDERED ESSENTIAL IF THE FOOTINGS ARE TO BE FOUNDED IN FILL. A TESTING FREQUENCY OF AT LEAST ONE FIELD DENSITY TEST FOR EACH 2500 SQUARE FEET OF LIFT, BUT NOT LESS THAN 3 TESTS PER LIFT IS RECOMMENDED WITHIN THE BUILDING AREAS.
- 2. CONCRETE:**
- A. ALL READY MIX CONCRETE SHALL BE 4000 psi FOR ALL CONCRETE PLACEMENT. DO NOT ADD WATER TO THE MIX DESIGN AFTER DELIVERY TO THE PROJECT SITE.
  - B. EXPOSED EXTERIOR CONCRETE SHALL BE AIR-ENTRAINED (TOTAL AIR CONTENT = 5%). INTERIOR CONCRETE SHALL NOT BE AIR-ENTRAINED.
  - C. UNLESS NOTED OTHERWISE, CONCRETE COVER OVER STEEL REINFORCEMENT SHALL CONFORM TO THE MINIMUM REQUIREMENT BY ACI 318.
  - D. REINFORCEMENT DETAILING AND PLACEMENT SHALL CONFORM TO ACI 318 AND ACI 315, EXCEPT WHERE OTHERWISE INDICATED.
  - E. HOT OR COLD WEATHER CONCRETE SHALL BE IN ACCORDANCE WITH ACI 308-99 AND ACI 308-1-90, RESPECTIVELY.
  - F. ANY CONCRETE PLACED BY MEANS OF PUMPING SHALL BE DONE IN ACCORDANCE WITH ACI 304.2R (82).
  - G. CEMENT SHALL CONFORM TO ASTM C-150 TYPE I.
  - H. AGGREGATES SHALL CONFORM TO ASTM C-33 FOR NORMAL WEIGHT CONCRETE & ASTM C-330 FOR LIGHTWEIGHT CONCRETE.
  - I. READY MIX CONCRETE SHALL BE MIXED AND DELIVERED IN ACCORDANCE WITH ASTM C-94.
  - J. ADMIXTURES MAY BE USED WITH THE APPROVAL OF THE STRUCTURAL ENGINEER. ADMIXTURES USED TO INCREASE THE WORKABILITY OF THE CONCRETE SHALL NOT BE CONSIDERED TO REDUCE THE CEMENT CONTENT. NO CALCIUM CHLORIDE ADMIXTURES ALLOWED.
- 3. SLABS ON GRADE:**
- A. FLOOR SLABS ARE TO BE PLACED AND FINISHED IN ACCORDANCE WITH ACI 302 (SEE PROJECT MANUAL FOR ADDITIONAL INFORMATION).
  - B. THICKNESS TOLERANCE FOR ALL SLABS IS TO BE PER ACI 117 AND IS TO BE NO MORE THAN +3/8" (THICKER) AND NO MORE THAN -1/8" (THINNER) FROM THE DESIGN THICKNESS.
  - C. CONCRETE USED FOR FLOOR SLABS SHALL INCLUDE SUPERPLASTICIZER. SEE PROJECT MANUAL FOR ADDITIONAL INFORMATION.
- 4. REINFORCING:**
- A. REINFORCING BARS SHALL BE BILLET STEEL, ASTM A 615, GRADE 60. PROVIDE CONTINUOUS BENT BARS AT FOOTING STEPS AND 90 DEGREE BENT TIES AT CORNERS, UNLESS OTHERWISE NOTED. LAP SPLICES OR EMBEDMENT LENGTHS SHALL CONFORM TO CLASS B SPLICE (SEE SPLICE TABLE). ADJACENT BAR SPLICES IN WALLS AND FOOTINGS TO ALTERNATE. ALL FOOTINGS SHALL REQUIRED HOOKED REINFORCING PROJECTED INTO WALLS, PILASTERS OR COLUMNS. THE BAR SPACING AT WALLS AND FOOTINGS SHALL MEET THE FOLLOWING:
  - B. WELDED WIRE FABRIC (WWF) SHALL CONFORM TO THE CURRENT ASTM SPECIFICATION FOR COLD DRAWN STEEL REINFORCEMENT WIRE. USE #3 AND #4 WITH MINIMUM 6".
  - C. REINFORCING DETAILING, BENDING, AND PLACING SHALL CONFORM TO ACI 315.
  - D. MINIMUM CONCRETE COVER: THE MINIMUM CLEAR DISTANCES BETWEEN REINFORCING STEEL AND FACE OF CONCRETE SHALL BE MAINTAINED UNLESS NOTED OTHERWISE:
- |  |    |
|--|----|
| SLABS ON EARTH.....  | 2" |
| CONCRETE BELOW GRADE, FORMED.....                            | 2" |
| CONCRETE BELOW GRADE, UNFORMED AND POURED AGAINST EARTH..... | 3" |
- 5. LUMBER:**
- A. ALL LUMBER SHALL BE FIRE TREATED IN ACCORDANCE WITH PROJECT SPECIFICATIONS. REFER TO ARCHITECTURAL AND PROJECT MANUAL FOR MORE INFORMATION AND SPECIFIC REQUIREMENTS.
  - B. TREATED LUMBER, IN LOCATIONS WHERE TREATED LUMBER IS SHOWN ON DRAWINGS, THE APPROVED PRESERVE TREATED WOODS ARE ACQ-D (CARBONATE) OR CA-B TREATED WOODS WITHOUT AMMONIA CARRIERS. THE CHEMICAL RETENTION LEVELS ARE TO BE NO GREATER THAN 0.45 LB/FT<sup>3</sup> FOR ACQ-D, 0.21 PCF FOR CA-B. ALL METAL CONNECTORS ARE TO HAVE A GALVANIZED COATING OF NO LESS THAN 1.55 OUNCES PER SQUARE FOOT PER ASTM A653. ALL BOLTS, SCREWS NAILS AND OTHER FASTENERS ARE TO BE GALVANIZED PER ASTM A153. WHERE TREATED LUMBER IS SHOWN FOR EXTERIOR INSTALLATIONS WITH NO ROOF COVERINGS TO PREVENT DIRECT EXPOSURE TO RAIN, USE HOT DIP GALVANIZED CONNECTORS PER ASTM A123.
- 6. STRUCTURAL STEEL:**
- A. FABRICATOR QUALIFICATIONS: FABRICATOR MUST PARTICIPATE IN THE AISC QUALITY CONTROL PROGRAM AND BE DESIGNATED AN AISC-CERTIFIED PLANT.
  - B. MATERIALS (UNLESS NOTED OTHERWISE):
- |  |                      |
|--|----------------------|
| STRUCTURAL STEEL.....  | ASTM A992, GRADE 50  |
| PLATES, ANGLES, CHANNELS, AND MISCELLANEOUS STEEL.....       | ASTM A36             |
| ANCHOR RODS.....   | ASTM F1554, GRADE 36 |
| HIGH STRENGTH BOLTS.....                                     | ASTM F3125           |
| WELDING ELECTRODES.....                                      | AWS A5.1 (E70XX)     |
| PIPE.....  | ASTM A53, GRADE B    |
| SQUARE AND RECTANGULAR HOLLOW STRUCTURAL SECTIONS (HSS)..... | ASTM A500, GRADE B   |
- 7. LIGHT GAUGE STEEL:**
- A. LIGHT GAUGE STEEL MEMBERS AND PROTECTIVE COATINGS SHALL COMPLY WITH ACCEPTED INDUSTRY STANDARD PRACTICES AS DETERMINED BY THE AISI AND SPSA.
  - B. PENETRATIONS THROUGH WALLS IN THESE CONSTRUCTION DOCUMENTS IS IN ACCORDANCE WITH ACCEPTED IDENTIFICATION PROCEDURES ESTABLISHED BY THE AISI.
  - C. ALUMINUM FASTENERS THROUGH WALLS SHALL BE LATERALLY BRIDGED AT 48" O.C. (VERTICALLY) USING 2"x20ga STRIP BRACING POSITIVELY ATTACHED TO EACH STUD FLANGE. PROVIDE STRIP BRACING WITHIN THE PLANE OF THE STRIP BRACING AT EACH END OF WALL, ADJACENT TO WALL OPENINGS, AND AT 8" O.C. MAXIMUM.
  - D. LIGHT GAUGE STEEL TRACK THICKNESS SHALL MEET OR EXCEED THICKNESS OF CORRESPONDING STUD GAUGE. SLIP TRACK ASSEMBLIES SHALL ALSO CONFORM TO THE GUIDELINES SET FORTH IN SPSA TECHNICAL NOTE #1 (JAN 2001). SEAT ALL LOAD BEARING STUDS SQUARELY INTO TRACKS WITH NO MORE THAN A 1/4" GAP.
  - E. PERIMETER WALL TRACK FASTENERS TO BE 3/4" WITH 4" EMBEDMENT ANCHORS THAT ARE CAST-IN-PLACE HOOKED OR HEADED BOLTS OR POST-INSTALLED SIMPSON TITEN HD SCREW ANCHORS. PROVIDE ANCHOR ADJACENT TO ALL WALL OPENINGS AND AT THE END OF EACH WALL (MIN 2 ANCHORS PER TRACK RUN).
  - F. INTERMEDIATE TRACK ANCHOR SPACING SHALL BE AT 48" O.C. (NOTE: PROJECTS LOCATED IN SEISMIC DESIGN CATEGORY "A" OR "B" MAY USE POWDER ACTUATED FASTENERS 16" O.C. IN LIEU OF INTERMEDIATE SCREW ANCHORAGE).
  - G. FASTENERS SPECIFIED IN CONSTRUCTION DOCUMENTS (OR APPROVED SUBSTITUTES) SHALL BE INSTALLED IN ACCORDANCE WITH ACCEPTED INDUSTRY STANDARDS AND MANUFACTURERS RECOMMENDATIONS. FASTENER USE CASES SHALL BE LIMITED TO EXPOSURE, LOAD TYPE AND BASE MATERIAL SPECIFIED IN CORRESPONDING CODE REPORT: SIMPSON TITEN HD SCREW ANCHORS: ICC-ES ESR-2713 - CITY OF LOS ANGELES RR25741 SIMPSON STRONG DRIVE FPHSD METAL SCREWS (#10-#12): ICC-ES ESR-3006 - CITY OF LOS ANGELES RR25670 SIMPSON STRONG DRIVE SDS HEAVY DUTY CONNECTOR SCREW: ICC-ES ESR-2236 - CITY OF LOS ANGELES RR25711 HILTI X-U POWDER ACTUATED FASTENERS: ICC-ES ESR-2269 - ICC-ES ESR-1663
- 8. GENERAL:**
- A. CONTRACTOR HAS SOLE RESPONSIBILITY TO COMPLY WITH ALL OSHA REGULATIONS.
  - B. THE STRUCTURAL DESIGN OF THE BUILDING IS BASED UPON THE FULL INTERACTION OF ALL ITS COMPONENT PARTS, WITH NO PROVISION MADE FOR CONDITIONS OCCURRING DURING CONSTRUCTION. THE STRUCTURE IS STABLE ONLY IN ITS COMPLETED FORM. THE CONTRACTOR SHALL PROVIDE ADEQUATE BRACING DURING CONSTRUCTION. TEMPORARY SUPPORTS REQUIRED FOR STABILITY DURING ALL INTERMEDIATE STAGES OF CONSTRUCTION SHALL BE DESIGNED, FURNISHED AND INSTALLED BY THE CONTRACTOR. THE CONTRACTOR IS RESPONSIBLE FOR CONSTRUCTION ANALYSIS AND ERECTION PROCEDURES, INCLUDING DESIGN AND ERECTION OF FALSEWORK, TEMPORARY BRACING, ETC. THE STRUCTURAL ENGINEER ASSUMES NO LIABILITY FOR THE STRUCTURE DURING CONSTRUCTION.
  - C. CORRECTIONS DUE TO UNFORESEEN FIELD CONDITIONS OR DIMENSIONAL DISCREPANCIES ON CONSTRUCTION DOCUMENTS MUST BE BROUGHT TO THE ATTENTION OF THE PROJECT ARCHITECT FOR REVIEW AND AUTHORIZATION PRIOR TO CORRECTIVE MEASURES BEING IMPLEMENTED.
  - D. STRUCTURAL DRAWINGS ARE TO BE USED IN CONJUNCTION WITH ARCHITECTURAL, MECHANICAL, AND ELECTRICAL DRAWINGS.
  - E. NOTES AND DETAILS ON DRAWINGS SHALL TAKE PRECEDENCE OVER THESE GENERAL NOTES.
  - F. ALL SHOP DRAWINGS SHALL BE REVIEWED AND APPROVED BY THE PROJECT ARCHITECT/ENGINEER PRIOR TO SUBMITTING TO THE BUILDING DEPARTMENT FOR REVIEW AND APPROVAL.
- 9. SIMPSON "AT-XP" ADHESIVE SYSTEM INTO CONCRETE (MAPMO UES ER-263):**
- A. CONTRACTOR TO FOLLOW ALL REQUIREMENTS, INSTRUCTIONS, AND RECOMMENDATIONS FOR ADHESIVE APPLICATION.
  - B. SUBSTITUTIONS FOR SIMPSON "AT-XP" ANCHORING ADHESIVE SHALL BE ONLY UPON THE APPROVAL OF THE PROJECT ENGINEER OF RECORD.
- 10. SPECIAL INSPECTIONS REQUIREMENTS:**
- A. OWNER SHALL ENGAGE ONE OR MORE QUALIFIED SPECIAL INSPECTORS AND/OR TESTING AGENCIES TO CONDUCT STRUCTURAL TESTS, CONSTRUCTION MATERIAL TESTING, AND SPECIAL INSPECTIONS SPECIFIED IN THE "STATEMENT OF SPECIAL INSPECTIONS".
  - B. FOR THE SPECIFIC RESPONSIBILITY OF THE OWNER, CONTRACTOR, AND SPECIAL INSPECTOR REFER TO THE PROJECT MANUAL.

**DESIGN CRITERIA**

BUILDING CODE: 2018 INTERNATIONAL BUILDING CODE

- DESIGN LOADS:**
- ROOF DEAD LOAD..... 5.5 psf
  - ROOF COLLATERAL LOAD..... 2.5 psf
  - ADDITIONAL CEILING SYSTEM COLLATERAL AT PARTS AREA "A"..... 2.0 psf
  - ROOF LIVE LOAD..... 20.0 psf
  - SPRINKLER LOADS
    - UNIFORM BRANCH PIPE LOAD..... 0.0 psf
    - LINEAL LOOP/TIE MAIN PIPE LOAD..... 0.0 psf

- SNOW LOAD:**
- P<sub>s</sub> = 5 psf
  - P<sub>f</sub> = 8.5 psf
  - C<sub>e</sub> = 1.0
  - C<sub>t</sub> = 1.0
  - I<sub>s</sub> = 1.0

- WIND CALCULATION METHOD: ENVELOPE**
- V<sub>w</sub> = 106 mph
  - EXPOSURE = C
  - RISK CATEGORY II
  - BUILDING, ENCLOSED GC<sub>p</sub> = -1.0, GB = 0.0

- MAIN FORCE RESISTING SYSTEM:**
- WALL AND ROOFS q = 12.5 psf
  - PARAPETS q = 13.1 psf

- WIND LOADS & CLADDING: All Wind Pressures & Forces in "ASD"**
- Pressure values were used by JS Smith Consulting Engineers, P.C. for design. Components designed by others for this project will require wind pressures derived by that supplier.)
  - WALL AREAS 10 SQUARE FEET OR LESS = 18.0 psf
  - WALL INTERIOR ZONES = 12.0 psf & -13.1 psf
  - WALL END ZONES = 12.0 psf & -14.9 psf
  - PARAPETS AT INTERIOR ZONES = 10.0 psf & -15.8 psf
  - PARAPETS AT END ZONES = 10.0 psf & -18.0 psf
  - ROOF INTERIOR ZONES = 10.0 psf & -16.7 psf
  - ROOF EDGE ZONES = 10.0 psf & -22.2 psf
  - ROOF CORNER ZONES = 10.0 psf & -24.7 psf

- BASE SHEAR:**
- V<sub>x</sub> WIND = 17.1 k
  - SEISMIC = 22.8 k
  - V<sub>y</sub> WIND = 15.7 k
  - SEISMIC = 22.8 k

- SEISMIC DESIGN: EQUIVALENT FORCE PROCEDURE**
- S<sub>s</sub> = 0.169
  - S<sub>1</sub> = 0.082
  - S<sub>0.5</sub> = 0.180
  - S<sub>pi</sub> = 0.131
  - SITE CLASS = D
  - SEISMIC DESIGN CATEGORY = B
  - I<sub>e</sub> = 1.0

- SEISMIC FORCE RESISTING SYSTEM:**
- STEEL NOT DETAILED FOR SEISMIC
  - R = 3.0
  - C<sub>s</sub> = 0.060
  - p = 1.00

BAR SIZE	LAP SPLICES (in.) <sup>2</sup>		EMBED LENGTH (in.)		
	TOP BARS <sup>3</sup> Class B	OTHERS Class B	TOP BARS <sup>3</sup> l <sub>d</sub>	OTHERS l <sub>d</sub>	HOOKS <sup>5</sup> l <sub>gh</sub>
#3	25	19	19	15	8
#4	35	25	25	19	10
#5	41	31	31	24	12
#6	49	37	37	29	15
#7	71	54	54	42	17

1. SPLICE TABLE IS BASED ON THE FOLLOWING:
  - A. CONCRETE f<sub>c</sub> = 4000 psi
  - B. GRADE 60 REBAR
  - C. BAR SPACING NOT LESS THAN 2 BAR DIAMETERS OR 1"
  - D. CONCRETE COVER NOT LESS THAN ONE BAR DIAMETER
2. LAP LENGTHS SHOWN ARE FOR CLASS "B" TENSION SPLICES PER ACI 318-11 CHAPTER 12.
3. TOP BARS ARE DEFINED AS HORIZONTAL REINFORCEMENT PLACED SO THAT MORE THAN 12" OF CONCRETE IS CAST BELOW THE REINFORCEMENT IN THAT MEMBER.
4. STANDARD 90° HOOKS:
  - A. RADIUS = 4 BAR DIAMETERS FOR #3 THRU #8
  - B. LENGTH = 12 BAR DIAMETERS
5. HOOK LENGTH MAY BE REDUCED IN ACCORDANCE WITH ACI 318-11 CHAPTER 12.5

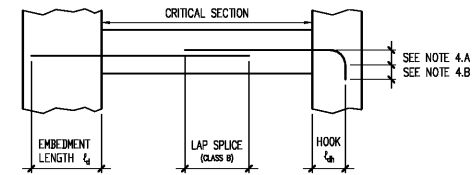

Order Plans @



SHEETS BEARING THIS SEAL ARE AUTHORIZED. RESPONSIBILITY FOR ALL OTHER PLANS, SPECIFICATIONS OR INSTRUMENTS ARE DISCLAIMED.

**O'Reilly AUTO PARTS**  
CORPORATE OFFICES  
233 SOUTH PATTERSON  
SPRINGFIELD, MISSOURI 65802  
(417) 882-2674 TELEPHONE

PROJECT:  
**NEW O'REILLY AUTO PARTS STORE**  
**6472 GA-42**  
**REX, GEORGIA**  
**STRUCTURAL NOTES**

JS Smith Consulting Engineers  
1101 W. 37th St. Ste 104 Jacksonville, Georgia 32210  
Jeffrey S. Smith P.E. 024888  
1801 W. 37th St. Ste 104 Jacksonville, Georgia 32210  
PHONE: 417-824-0444 FAX: 417-824-6430



DRAWN BY: **BTJ** CHECKED BY: **JS**  
DATE: **1/8/20**  
REVISION:

PROJECT NUMBER: **REX**

SHEET NUMBER: **S1.1**

COPYRIGHT 2020 DESIGNS, DRAWINGS AND SPECIFICATIONS ARE INSTRUMENTS OF SERVICE AND ARE THE PROPERTY OF THE DESIGN PROFESSIONAL. REPRODUCTION PROHIBITED WITHOUT THE EXPRESSED WRITTEN CONSENT OF THE DESIGN PROFESSIONAL.