

# FIRE PROTECTION LEGEND

SYMBOL	ABBREV	ITEM	SYMBOL	ABBREV	ITEM
FP		FIRE PROTECTION MAIN	○		REDUCER
○	A	SPRINKLER HEAD - RECESSED PENDANT	○	5	CHECK VALVE
○	A,B	SPRINKLER HEAD - UPRIGHT	□	FS	FLOW SWITCH
○	DP-A	SPRINKLER HEAD - DRY PENDENT	□	TS	TAMPER SWITCH
○		FIRE RISER WITH VALVING	○		TEE - UP
			○		TEE - DOWN
			○		TEE
			○		ELBOW - UP
			○		ELBOW DOWN
			○		ELBOW

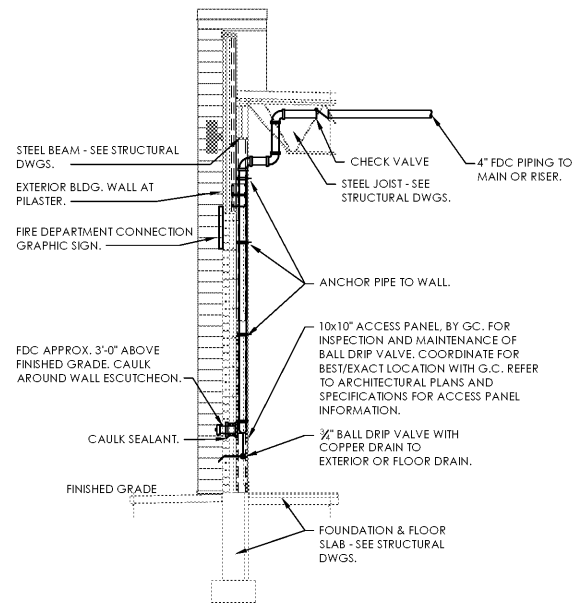

**D2** Fire Department Connection Detail  
SCALE: N.T.S.

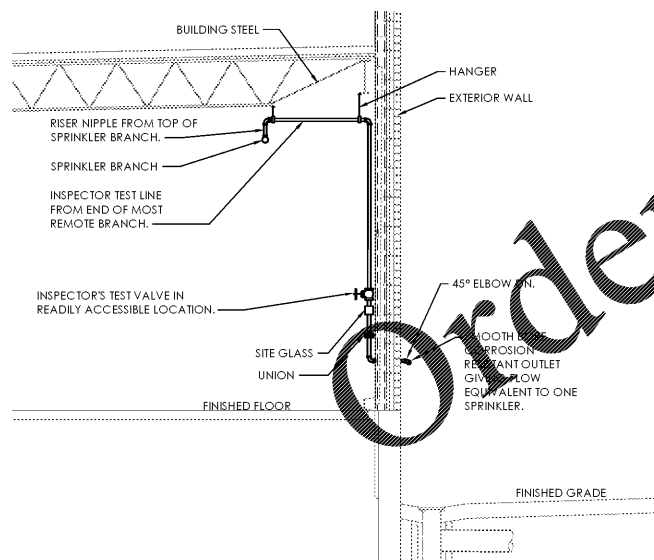

**D1** Inspector's Test Connection Detail  
SCALE: N.T.S.

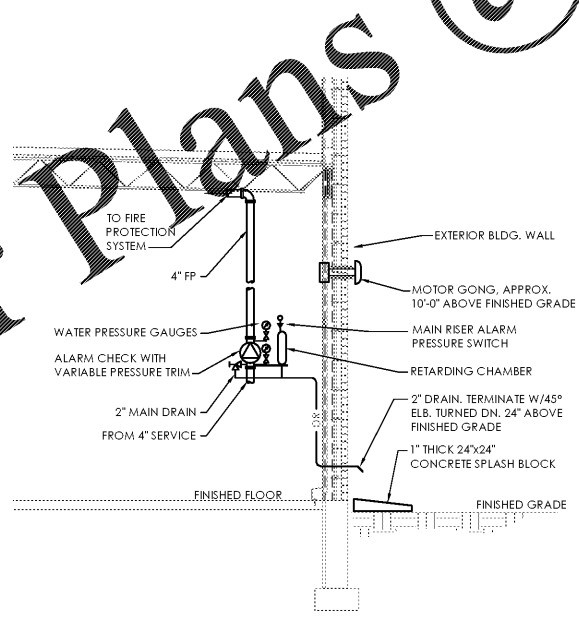

**C1** Fire Protection Alarm Check Detail  
SCALE: N.T.S.

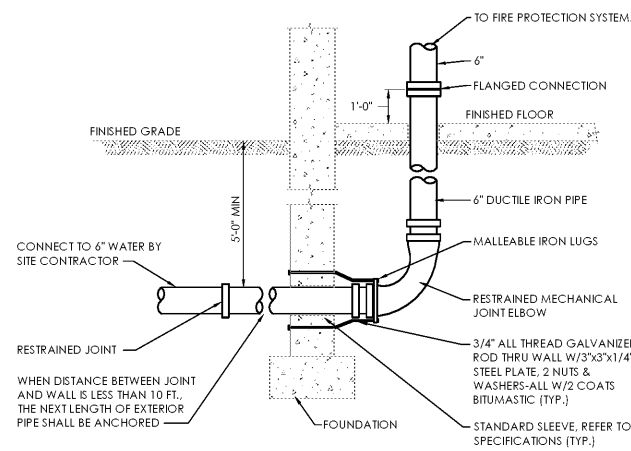

**B1** Fire Service Lead-In Detail  
SCALE: N.T.S.

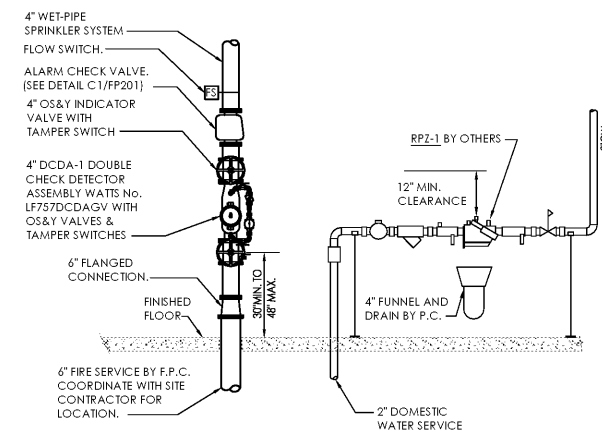

**A1** Fire Protection Riser Detail  
SCALE: N.T.S.

www.LDILine.com

Issued:	Date:
A Client Review Set	05/07/19
B Permit Set	06/12/19
C Client Review Set	02/07/20
D Bid Set	02/10/20
Revisions:	Date:

**DO NOT SCALE PLANS**  
Copying, Printing, Software and other processes required to produce these prints can stretch or shrink the actual paper or layout. Therefore, scaling of this drawing may be inaccurate. Contact ms consultants with any need for additional dimensions or clarifications.

**ms consultants, inc.**  
engineers, architects, planners  
5444 Wade Park Blvd.  
Suite 160  
Raleigh, NC 27607-4299  
phone 919.772.5565  
fax 919.779.2308

DRAWN BY:	MEM
REVIEWED BY:	KFF

Seal

PROFESSIONAL OF RECORD:  
JASON E. CHRISTOFF No. 039391  
EXP. DATE: 12/31/2020

**ALDI Inc.**  
1985 Old Union Church Road  
Salisbury, NC 28146  
(704) 642-0003  
(704) 642-5078 fax

**ALDI Inc. Store #: 154**  
Cornelius, NC  
20101 West Catawba Avenue  
Cornelius, NC 28031  
Mecklenburg County  
Project Name & Location:

Fire Protection Legend and Details  
Drawing Name:

Prototype Rls. 12/10/18	Project No. 40452-07
Type: LHSD-V8ER	FP-201
Scale: As Noted	Drawing No.

PLOTED: 2/10/2020 9:41 AM