

SIDE DOCK AREA SUMMARY		
OCCUPANCY USE	ROOM NAME	SQUARE FOOTAGE
MERCANTILE (M)	SALES / VESTIBULE	12,541
	MEN'S ROOM	107
	WOMEN'S ROOM	107
	HALL	151
SUBTOTAL (MERCANTILE)		12,906
BUSINESS (B)	OFFICE	265
	BREAK ROOM	351
SUBTOTAL (BUSINESS)		616
STORAGE / STOCK (S-1)	BACKROOM	3,288
	COOLER	1,313
	FREEZER	648
	STORAGE	2,328
SUBTOTAL (STORAGE / STOCK)		7,577
SUBTOTAL (OCCUPANCIES)		21,099
EXTERIOR / INTERIOR WALLS / UNOCCUPIED SPACE		1,379
BUILDING SQUARE FOOTAGE		22,478
EXTERIOR CANOPY		1,308
TOTAL SQUARE FOOTAGE (INCLUDING CANOPY)		23,786

SIDE DOCK OPERATIONS DATA	
ITEM	QUANTITY
LINEAR FOOTAGE OF BASE (PRODUCE INCLUDED)	V7.0 PROTOTYPE
ASSUMED PALLET STORAGE	828'-10"
BUILDING DIMENSIONS	119'-4" x 153'-4"
SALES FLOOR DIMENSIONS	74'-5 1/2" x 150'-11 1/2"
LENGTH OF MULTIDECK	120'
COOLER MILK DOORS	4
COOLER GENERAL DOORS	12
FREEZER GENERAL DOORS	16
SPOT MERCHANDISERS	10
CART STORAGE	(144) MODEL 563W

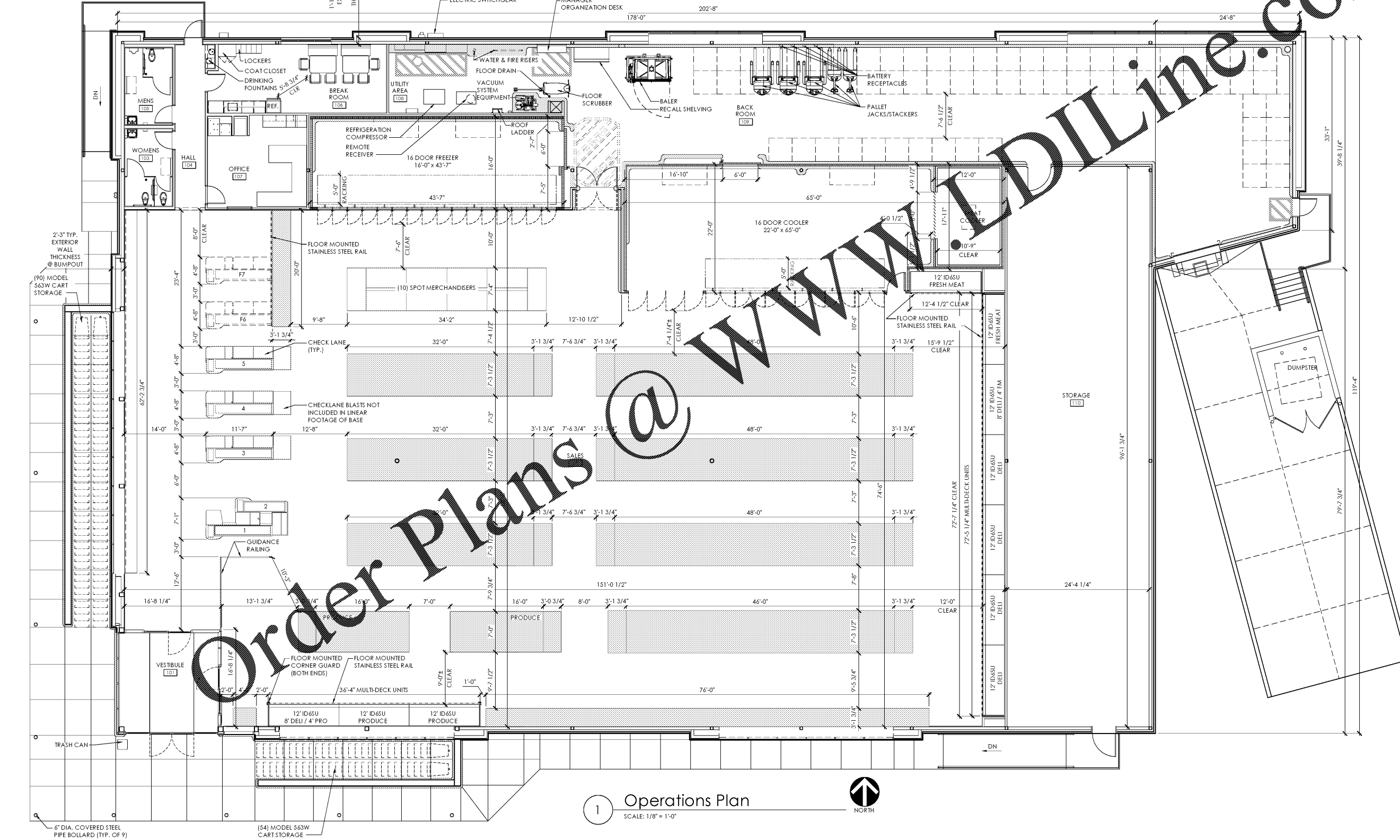

Issued:	Date:
A Client Review Set	05/07/19
B Permit Set	06/12/19
C Client Review Set	02/07/20
D Bid Set	02/10/20
Revisions:	Date:

**DO NOT SCALE PLANS**  
 Copying, Printing, Software and other processes required to produce these prints can stretch or shrink the actual paper or layout. Therefore, scaling of this drawing may be inaccurate. Contact us consultants with any need for additional dimensions or clarifications.

**ms consultants, inc.**  
 engineers, architects, planners  
 5444 Wade Park Blvd.  
 Suite 160  
 Raleigh, NC 27607-4299  
 phone 919.772.5565  
 fax 919.779.2308

DRAWN BY: KKL  
 REVIEWED BY: NAL

Seal  
 PROFESSIONAL OF RECORD:  
 CHARLES M. BUSCH No. 14751  
 EXP. DATE: 06/30/2020

**ALDI Inc.**  
 1985 Old Union Church Road  
 Salisbury, NC 28146  
 (704) 642-2022  
 (704) 642-0078 fax

ALDI Inc. Store #: 154  
 Cornelius, NC  
 20101 West Catawba Avenue  
 Cornelius, NC 28031  
 Mecklenburg County  
 Project Name & Location:

Operations Plan	
Drawing Name:	Prototype Rls. 12/10/18
Type: LHSD-V8ER	Project No. 40452-07
Scale: As Noted	A-131
	Drawing No.

PLOTTED: 2/10/2020 10:46 AM

**1 Operations Plan**  
 SCALE: 1/8" = 1'-0"  
 NORTH