



ColeJenest & Stone

Shaping the Environment
Realizing the Possibilities

Land Planning
Landscape Architecture
Civil Engineering
Urban Design

200 South Tryon Street, Suite 1400
Charlotte, North Carolina 28202
+1 704 376 1555 +1 704 376 7851
url: www.colejeneststone.com

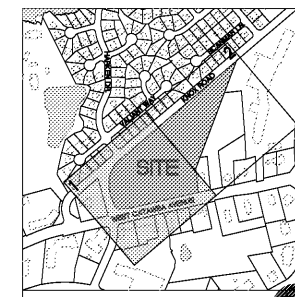

VICINITY MAP
SURVEY DISCLAIMER
ALTA/NSPS LAND TITLE SURVEY ISSUE #1
NOVEMBER 01, 2017. PROJECT SITE AT 2011 WEST CATAWBA AVENUE, GREENWICH, PINELAKE, NORTH CAROLINA. DATE OF SURVEY: 10/11/17
PHONE: 800-949-6475. TITLE: PRIVATE UTILITY PLANS

CHARTER CORNELIUS, LP

75 Holly Hill Lane, Suite 305
Greenwich
Connecticut 06830

ONE NORMAN

20101 West Catawba Avenue
Cornelius
North Carolina 28031

PRIVATE UTILITY PLAN

Project No.
4493

Issued
03/26/19

Revised

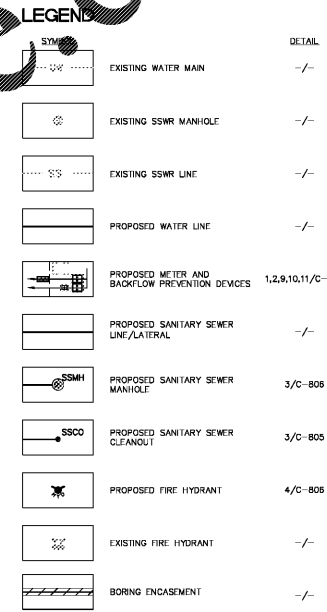

SYMBOL	DESCRIPTION	DETAIL
(Solid line with dashes)	EXISTING WATER MAIN	1/2"
(Dashed line)	EXISTING SSWR MANHOLE	1/2"
(Dashed line with dots)	EXISTING SSWR LINE	1/2"
(Solid line)	PROPOSED WATER LINE	1/2"
(Line with 'M' symbol)	PROPOSED METER AND BACKFLOW PREVENTION DEVICES	1,2,4,10,11/C-808
(Line with 'S' symbol)	PROPOSED SANITARY SEWER LINE/LATERAL	1/2"
(Line with 'SMH' symbol)	PROPOSED SANITARY SEWER MANHOLE	3/C-808
(Line with 'SSCO' symbol)	PROPOSED SANITARY SEWER CLEANOUT	3/C-805
(Star symbol)	PROPOSED FIRE HYDRANT	4/C-808
(Circle with 'H' symbol)	EXISTING FIRE HYDRANT	1/2"
(Line with 'B' symbol)	BORING ENCASMENT	1/2"

NOTICE TO CONTRACTOR

THIS LAND DEVELOPMENT PLAN HAS NOT BEEN REVIEWED OR APPROVED BY CHARLOTTE WATER.
PRIOR TO CONSTRUCTION, PLEASE CONTACT MIKE GARBARK (704-432-5797 mgarbark@charlotte.nc.us) WITH CHARLOTTE WATER REGARDING YOUR DEVELOPMENT.
LAND DEVELOPMENT PLAN REVISIONS DUE TO PLAN COMMENTS BY CHARLOTTE WATER COMMENTS WILL REQUIRE SUBMISSION OF A REVISED CONSTRUCTION PLAN TO THE TOWN/COUNTY FOR REVIEW. ALL ADDITIONAL FEES DUE TO THE PLAN REVISION TO BE PAID BY THE OWNER/DEVELOPER/CONTRACTOR.

SEE SHEET C-501 FOR UTILITY NOTES.



C-500

- CONTRACTOR IS FULLY RESPONSIBLE FOR CONTACTING APPROPRIATE PARTIES AND ASSURING THAT EXISTING UTILITIES ARE LOCATED PRIOR TO CONSTRUCTION.
- CONTRACTOR IS RESPONSIBLE FOR PLACING BARRICADES USING FLAG MEN, ETC. AS NECESSARY TO INSURE SAFETY TO THE PUBLIC.
- ALL PAVEMENT CUTS, CONCRETE OR ASPHALT, ARE TO BE REPLACED ACCORDING TO STANDARDS OF THE NORTH CAROLINA DEPARTMENT OF TRANSPORTATION AND CHARLOTTE-MECKLENBURG UTILITIES SPECIFICATIONS.
- SHORING SHALL BE IN ACCORDANCE WITH OSHA TRENDING STANDARDS, 29 CFR, PART 1926, SUBPART P, OR AS AMENDED.

The drawings, the project manual and the design shown thereon are instruments of ColeJenest & Stone, P.A. The reproduction or unauthorized use of the documents without consent of ColeJenest & Stone, P.A. is prohibited.
ColeJenest & Stone, P.A. 2019

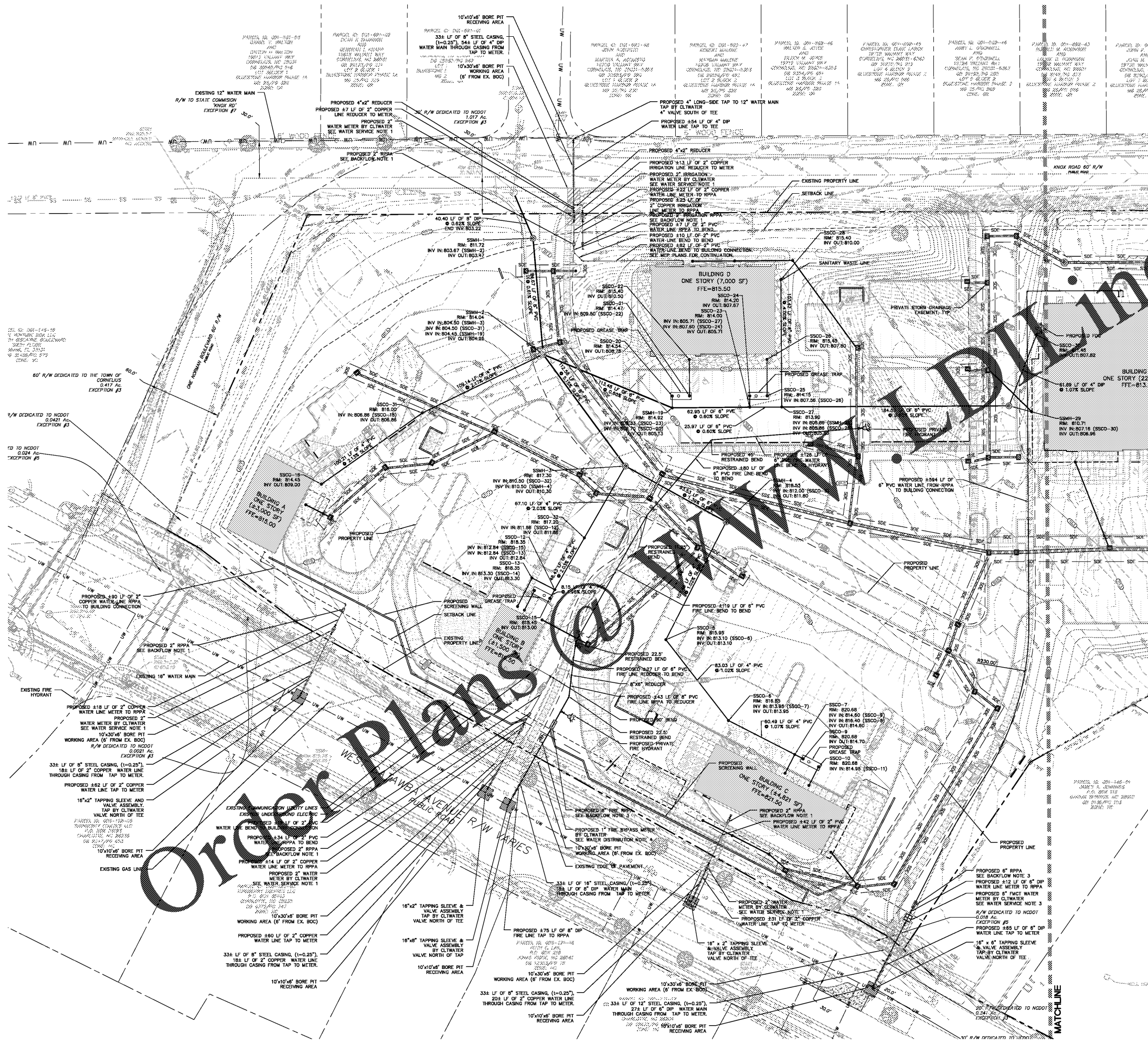

Order Plans @

WWW.DLINE.COM