

VICINITY MAP

SURVEY DISCLAIMER
 ALTA/NSPS LAND TITLE SURVEY ISSUED NOVEMBER 01, 2017. PROVIDED BY ATLAS SURVEYING, LLC. PINEVILLE, NORTH CAROLINA. PHONE: 980-949-8472. WEBSITE: ATLAS-SURVEYING.COM



ColeJenest & Stone

Shaping the Environment
 Realizing the Possibilities

Land Planning
 Landscape Architecture
 Civil Engineering
 Urban Design

200 South Tryon Street, Suite 1400
 Charlotte, North Carolina 28202
 P: 704.376.1555 F: 704.376.1781
 www.colejeneststone.com

CHARTER CORNELIUS, LP

75 Holly Hill Lane, Suite 305
 Greenwich
 Connecticut 06830

ONE NORMAN

20101 West Catawba Avenue
 Cornelius
 North Carolina 28031

DRAINAGE AREA MAP

Project No.
 4493

Issued
 03/26/19

Revised

LEGEND

SYMBOL	DESCRIPTION	DETAIL
	PROPOSED CONTOUR	-/-
	PROPOSED INDEX CONTOUR	-/-
	PROPOSED SPOT ELEVATION	-/-
	PROPOSED HIGH POINT	-/-
	PROPOSED DRAINAGE SWALE	-/-
	PROPOSED STORM DRAINAGE	15/C-805
	PROPOSED CURB INLET	NCDOT STD. 840.02
	PROPOSED DROP INLET	NCDOT STD. 840.14
	PROPOSED MANHOLE	NCDOT STD. 840.52
	PROPOSED GRAVEL AND RIPRAP APRON	3/C-802
	PROPOSED HEAD WALL	NCDOT STD. 838.80
	FLARED END SECTION	4/C-802

THIS SHEET FOR REFERENCE ONLY

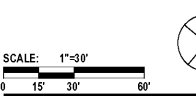
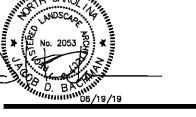

C-402

- CONTRACTOR IS FULLY RESPONSIBLE FOR CONTACTING APPROPRIATE PARTIES AND ASSURING THAT EXISTING UTILITIES ARE LOCATED PRIOR TO CONSTRUCTION.
- CONTRACTOR IS RESPONSIBLE FOR PLACING BARRICADES USING FLAG MEN, ETC. AS NECESSARY TO INSURE SAFETY TO THE PUBLIC.
- ALL PAYMENT CUTS, CONCRETE OR ASPHALT, ARE TO BE REPLACED ACCORDING TO STANDARDS OF THE NORTH CAROLINA DEPARTMENT OF TRANSPORTATION AND CHARLOTTE-MECKLENBURG UTILITIES SPECIFICATIONS.
- SHORING SHALL BE IN ACCORDANCE WITH OSHA TRENDING STANDARDS, 29 CFR, PART 1926, SUBPART P, OR AS AMENDED.

The drawings, the project manual and the design shown thereon are instruments of ColeJenest & Stone, P.A. The reproduction or unauthorized use of the documents without consent of ColeJenest & Stone, P.A. is prohibited.

ColeJenest & Stone, P.A. 2019

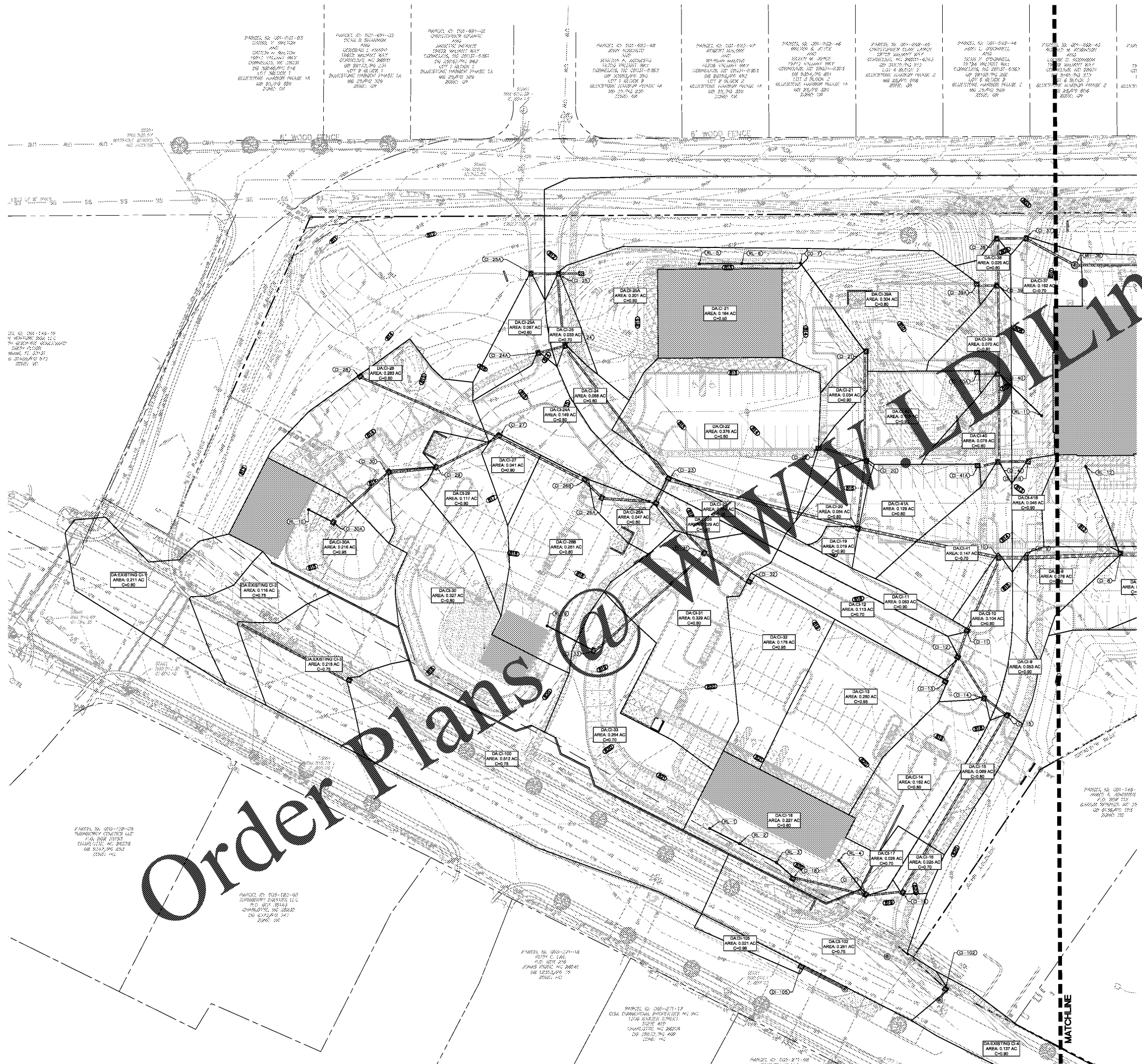

Order Plans @

PARCEL NO. 001-148-15
 N. WOODS DRIVE, LOT 11
 10.46 AC. 0.00 AC. 0.00 AC.
 10.46 AC. 0.00 AC. 0.00 AC.
 10.46 AC. 0.00 AC. 0.00 AC.
 10.46 AC. 0.00 AC. 0.00 AC.

PARCEL NO. 001-148-15
 N. WOODS DRIVE, LOT 11
 10.46 AC. 0.00 AC. 0.00 AC.
 10.46 AC. 0.00 AC. 0.00 AC.
 10.46 AC. 0.00 AC. 0.00 AC.

PARCEL NO. 001-148-15
 N. WOODS DRIVE, LOT 11
 10.46 AC. 0.00 AC. 0.00 AC.
 10.46 AC. 0.00 AC. 0.00 AC.
 10.46 AC. 0.00 AC. 0.00 AC.

PARCEL NO. 001-148-15
 N. WOODS DRIVE, LOT 11
 10.46 AC. 0.00 AC. 0.00 AC.
 10.46 AC. 0.00 AC. 0.00 AC.
 10.46 AC. 0.00 AC. 0.00 AC.

PARCEL NO. 001-148-15
 N. WOODS DRIVE, LOT 11
 10.46 AC. 0.00 AC. 0.00 AC.
 10.46 AC. 0.00 AC. 0.00 AC.
 10.46 AC. 0.00 AC. 0.00 AC.

PARCEL NO. 001-148-15
 N. WOODS DRIVE, LOT 11
 10.46 AC. 0.00 AC. 0.00 AC.
 10.46 AC. 0.00 AC. 0.00 AC.
 10.46 AC. 0.00 AC. 0.00 AC.

PARCEL NO. 001-148-15
 N. WOODS DRIVE, LOT 11
 10.46 AC. 0.00 AC. 0.00 AC.
 10.46 AC. 0.00 AC. 0.00 AC.
 10.46 AC. 0.00 AC. 0.00 AC.