

VICINITY MAP
 NTS
 SURVEY DISCLAIMER
 ALTA/NPS LAND TITLE SURVEY ISSUED NOVEMBER 01, 2017. PROVIDED BY ATLAS PINEVILLE, NORTH CAROLINA 28134. PHONE: 980-949-6472. TITLE: ATLAS PINEVILLE, NC



ColeJenest & Stone
 Shaping the Environment
 Realizing the Possibilities

- Land Planning
- Landscape Architecture
- Civil Engineering
- Urban Design

200 South Tryon Street, Suite 1400
 Charlotte, North Carolina 28202
 P: 704.376.1555 F: 704.376.1781
 www.colejeneststone.com

CHARTER CORNELIUS, LP

75 Holly Hill Lane, Suite 305
 Greenwich
 Connecticut 06830

ONE NORMAN

20101 West Catawba Avenue
 Cornelius
 North Carolina 28031

GRADING AND DRAINAGE PLAN

Project No.
 4493

Issued
 03/28/19

Revised

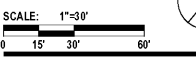
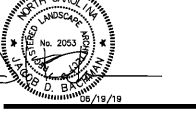

C-400

The drawings, the project manual and the design shown thereon are instruments of ColeJenest & Stone, P.A. The reproduction or unauthorized use of the documents without consent of ColeJenest & Stone, P.A. is prohibited.
 ColeJenest & Stone, P.A. 2019

LEGEND

SYMBOL	DESCRIPTION	DETAIL
(Dashed line)	PROPOSED CONTOUR	-/-
(Dotted line)	PROPOSED INDEX CONTOUR	-/-
(Spot elevation)	PROPOSED SPOT ELEVATION	-/-
(Peak symbol)	PROPOSED HIGH POINT	-/-
(Arrow symbol)	PROPOSED DRAINAGE SWALE	-/-
(Line with 'S')	PROPOSED STORM DRAINAGE	15/C-805
(Line with 'C')	PROPOSED CURB INLET	NCCDT STD. 840.02
(Line with 'D')	PROPOSED DROP INLET	NCCDT STD. 840.14
(Line with 'M')	PROPOSED MANHOLE	NCCDT STD. 840.52
(Line with 'G')	PROPOSED GRAVEL AND RIPRAP APRON	3/C-802
(Line with 'H')	PROPOSED HEAD WALL	NCCDT STD. 838.80
(Line with 'F')	FLARED END SECTION	4/C-802

- CONTRACTOR IS FULLY RESPONSIBLE FOR CONTACTING APPROPRIATE PARTIES AND ASSURING THAT EXISTING UTILITIES ARE LOCATED PRIOR TO CONSTRUCTION.
- CONTRACTOR IS RESPONSIBLE FOR PLACING BARRICADES USING FLAG MEN, ETC. AS NECESSARY TO INSURE SAFETY TO THE PUBLIC.
- ALL PAYMENT CUTS, CONCRETE OR ASPHALT, ARE TO BE REPLACED ACCORDING TO STANDARDS OF THE NORTH CAROLINA DEPARTMENT OF TRANSPORTATION AND CHARLOTTE-MECKLENBURG UTILITIES SPECIFICATIONS.
- SHORING SHALL BE IN ACCORDANCE WITH OSHA TRENCHING STANDARDS, 29 CFR, PART 1926, SUBPART P, OR AS AMENDED.

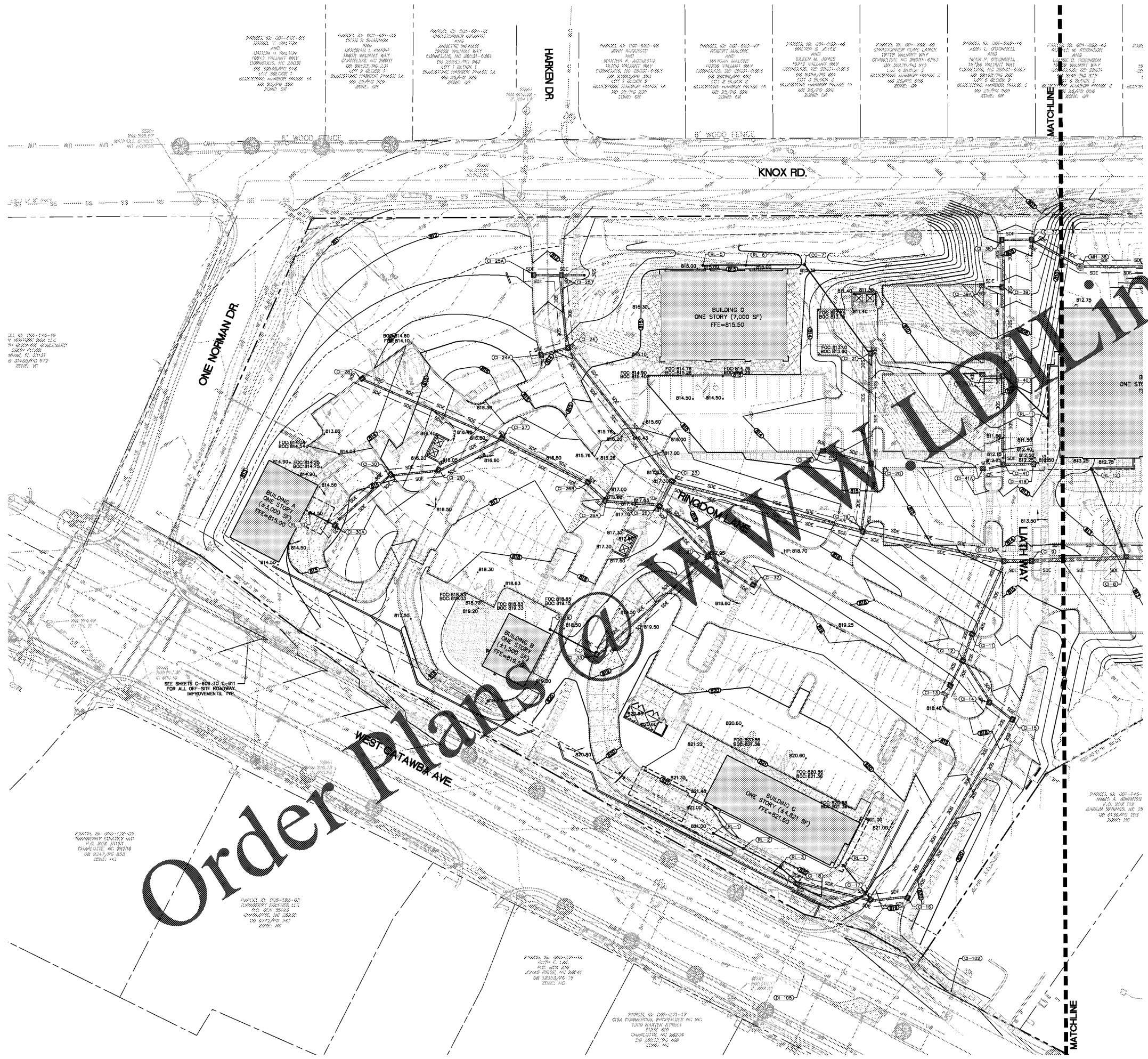

Order Plans

PROJECT NO. 001-138-15
 N. WEST CATAWBA AVE. 111'
 1/4" = 100'-0" (VERTICAL)
 1/8" = 100'-0" (HORIZONTAL)
 03/28/19

SEE SHEETS C-506 TO C-811
 FOR ALL OFF-SITE ROADWAY
 IMPROVEMENTS, TYP.

PROJECT NO. 001-138-15
 N. WEST CATAWBA AVE. 111'
 1/4" = 100'-0" (VERTICAL)
 1/8" = 100'-0" (HORIZONTAL)
 03/28/19

PROJECT NO. 001-138-15
 N. WEST CATAWBA AVE. 111'
 1/4" = 100'-0" (VERTICAL)
 1/8" = 100'-0" (HORIZONTAL)
 03/28/19

PROJECT NO. 001-138-15
 N. WEST CATAWBA AVE. 111'
 1/4" = 100'-0" (VERTICAL)
 1/8" = 100'-0" (HORIZONTAL)
 03/28/19

PROJECT NO. 001-138-15
 N. WEST CATAWBA AVE. 111'
 1/4" = 100'-0" (VERTICAL)
 1/8" = 100'-0" (HORIZONTAL)
 03/28/19

PROJECT NO. 001-138-15
 N. WEST CATAWBA AVE. 111'
 1/4" = 100'-0" (VERTICAL)
 1/8" = 100'-0" (HORIZONTAL)
 03/28/19