

**VICINITY MAP**

**SURVEY DISCLAIMER**  
 ALTA/NSPS LAND TITLE SURVEY ISSUE NOVEMBER 01, 2017. PROVIDED BY ATLAS SURVEYING, INC. 1000 W. PINEVILLE, NORTH CAROLINA 28134. PHONE: 980-949-8475. WEBSITE: WWW.ATLAS-SURVEYING.COM



**ColeJenest & Stone**

Shaping the Environment  
 Realizing the Possibilities

Land Planning  
 Landscape Architecture  
 Civil Engineering  
 Urban Design

100 South Tryon Street, Suite 1400  
 Charlotte, North Carolina 28202  
 P: 704.375.1555 F: 704.375.7951  
 www.colejeneststone.com

**CHARTER CORNELIUS, LP**

75 Holly Hill Lane, Suite 305  
 Greenwich  
 Connecticut 06830

**ONE NORMAN**

20101 West Catawba Avenue  
 Cornelius  
 North Carolina 28031

**EROSION CONTROL PLAN STAGE 3**

Project No.  
 4493

Issued  
 03/28/19

Revised

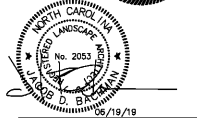

**LEGEND**

SYMBOL	DETAIL
	SEDIMENT BASIN 5/8/C-800
	OUTLET STRUCTURE WITH SKIMMER 6/C-800
	HIGH HAZARD SILT FENCE 10/C-800
	SILT FENCE 9/C-800
	TREE PROTECTION FENCING 2/C-803
	PROPOSED STORM DRAINAGE -/-
	STABILIZED CONSTRUCTION ENTRANCE 3/C-800
	GRAVEL RIP RAP APRON 3/C-802
	LIMITS OF DISTURBANCE -/-
	DIVERSION SWALE 8,12/C-800
	ROCK DITCH CHECK 2/C-800
	DRAINAGE AREA -/-
	FILTER BERM BASIN 4/C-800
	EROSION CONTROL MATTING 3/C-801
	SILT FENCE ROCK OUTLET 11/C-800
	STONE INLET PROTECTION 1/C-800
	CATCH BASIN INLET PROTECTION 1/C-801

NOTE:  
 STONE INLET PROTECTION TO BE REPLACED WITH CATCH BASIN "SILT SACK" INLET PROTECTION ONCE PAVEMENT IS INSTALLED.

SEE SHEET C-301 AND C-808 FOR EROSION CONTROL NOTES

- CONTRACTOR IS FULLY RESPONSIBLE FOR CONTACTING APPROPRIATE PARTIES AND ASSURING THAT EXISTING UTILITIES ARE LOCATED PRIOR TO CONSTRUCTION.
- CONTRACTOR IS RESPONSIBLE FOR PLACING BARRICADES USING FLAG MEN, ETC. AS NECESSARY TO INSURE SAFETY TO THE PUBLIC.
- ALL PAYMENT CURBS, CONCRETE OR ASPHALT, ARE TO BE REPLACED ACCORDING TO STANDARDS OF THE NORTH CAROLINA DEPARTMENT OF TRANSPORTATION AND CHARLOTTE-MECKLENBURG UTILITIES SPECIFICATIONS.
- SHORING SHALL BE IN ACCORDANCE WITH OSHA TRENCHING STANDARDS, 29 CFR, PART 1926, SUBPART P, OR AS AMENDED.

**C-304**

The drawings, the project manual and the design shown thereon are instruments of ColeJenest & Stone, P.A. The reproduction or unauthorized use of the documents without consent of ColeJenest & Stone, P.A. is prohibited.

ColeJenest & Stone, P.A. 2019

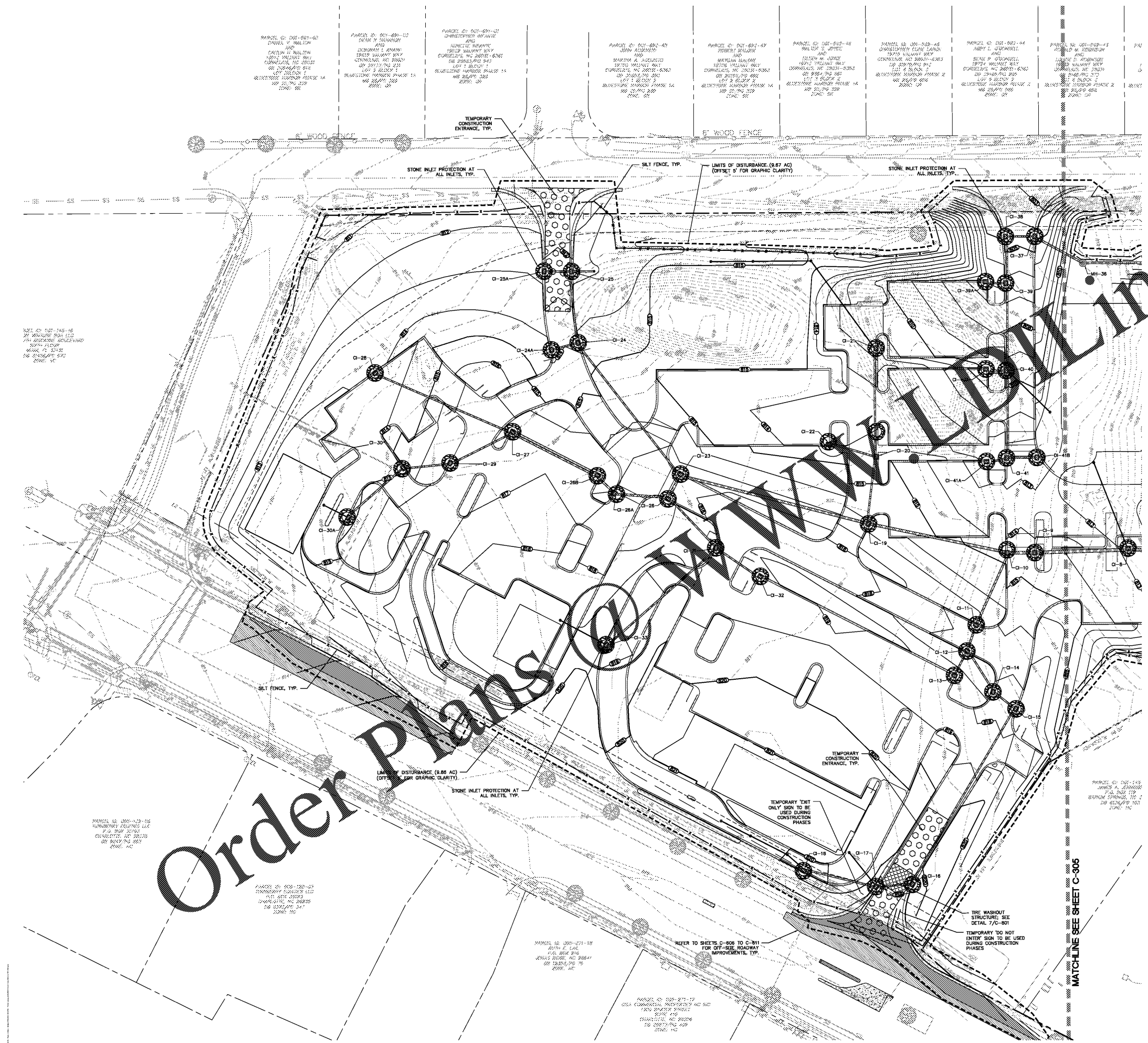

Order Plans Online.com

PARCEL ID: 025-091-02  
 SECTION 17, TOWNSHIP 10N, RANGE 10E, CO. 100, N.C.

PARCEL ID: 025-091-10  
 SECTION 17, TOWNSHIP 10N, RANGE 10E, CO. 100, N.C.

PARCEL ID: 025-091-17  
 SECTION 17, TOWNSHIP 10N, RANGE 10E, CO. 100, N.C.

PARCEL ID: 025-091-47  
 SECTION 17, TOWNSHIP 10N, RANGE 10E, CO. 100, N.C.

PARCEL ID: 025-091-48  
 SECTION 17, TOWNSHIP 10N, RANGE 10E, CO. 100, N.C.

PARCEL ID: 025-091-49  
 SECTION 17, TOWNSHIP 10N, RANGE 10E, CO. 100, N.C.

PARCEL ID: 025-091-50  
 SECTION 17, TOWNSHIP 10N, RANGE 10E, CO. 100, N.C.

PARCEL ID: 025-091-51  
 SECTION 17, TOWNSHIP 10N, RANGE 10E, CO. 100, N.C.

PARCEL ID: 025-091-52  
 SECTION 17, TOWNSHIP 10N, RANGE 10E, CO. 100, N.C.

PARCEL ID: 025-091-53  
 SECTION 17, TOWNSHIP 10N, RANGE 10E, CO. 100, N.C.

PARCEL ID: 025-091-54  
 SECTION 17, TOWNSHIP 10N, RANGE 10E, CO. 100, N.C.

PARCEL ID: 025-091-55  
 SECTION 17, TOWNSHIP 10N, RANGE 10E, CO. 100, N.C.

PARCEL ID: 025-091-56  
 SECTION 17, TOWNSHIP 10N, RANGE 10E, CO. 100, N.C.

PARCEL ID: 025-091-57  
 SECTION 17, TOWNSHIP 10N, RANGE 10E, CO. 100, N.C.

PARCEL ID: 025-091-58  
 SECTION 17, TOWNSHIP 10N, RANGE 10E, CO. 100, N.C.

PARCEL ID: 025-091-59  
 SECTION 17, TOWNSHIP 10N, RANGE 10E, CO. 100, N.C.

PARCEL ID: 025-091-60  
 SECTION 17, TOWNSHIP 10N, RANGE 10E, CO. 100, N.C.

PARCEL ID: 025-091-61  
 SECTION 17, TOWNSHIP 10N, RANGE 10E, CO. 100, N.C.

PARCEL ID: 025-091-62  
 SECTION 17, TOWNSHIP 10N, RANGE 10E, CO. 100, N.C.

PARCEL ID: 025-091-63  
 SECTION 17, TOWNSHIP 10N, RANGE 10E, CO. 100, N.C.

PARCEL ID: 025-091-64  
 SECTION 17, TOWNSHIP 10N, RANGE 10E, CO. 100, N.C.

PARCEL ID: 025-091-65  
 SECTION 17, TOWNSHIP 10N, RANGE 10E, CO. 100, N.C.

PARCEL ID: 025-091-66  
 SECTION 17, TOWNSHIP 10N, RANGE 10E, CO. 100, N.C.

PARCEL ID: 025-091-67  
 SECTION 17, TOWNSHIP 10N, RANGE 10E, CO. 100, N.C.

PARCEL ID: 025-091-68  
 SECTION 17, TOWNSHIP 10N, RANGE 10E, CO. 100, N.C.

PARCEL ID: 025-091-69  
 SECTION 17, TOWNSHIP 10N, RANGE 10E, CO. 100, N.C.

PARCEL ID: 025-091-70  
 SECTION 17, TOWNSHIP 10N, RANGE 10E, CO. 100, N.C.

PARCEL ID: 025-091-71  
 SECTION 17, TOWNSHIP 10N, RANGE 10E, CO. 100, N.C.

PARCEL ID: 025-091-72  
 SECTION 17, TOWNSHIP 10N, RANGE 10E, CO. 100, N.C.

PARCEL ID: 025-091-73  
 SECTION 17, TOWNSHIP 10N, RANGE 10E, CO. 100, N.C.

PARCEL ID: 025-091-74  
 SECTION 17, TOWNSHIP 10N, RANGE 10E, CO. 100, N.C.

PARCEL ID: 025-091-75  
 SECTION 17, TOWNSHIP 10N, RANGE 10E, CO. 100, N.C.

PARCEL ID: 025-091-76  
 SECTION 17, TOWNSHIP 10N, RANGE 10E, CO. 100, N.C.

PARCEL ID: 025-091-77  
 SECTION 17, TOWNSHIP 10N, RANGE 10E, CO. 100, N.C.

PARCEL ID: 025-091-78  
 SECTION 17, TOWNSHIP 10N, RANGE 10E, CO. 100, N.C.

PARCEL ID: 025-091-79  
 SECTION 17, TOWNSHIP 10N, RANGE 10E, CO. 100, N.C.

PARCEL ID: 025-091-80  
 SECTION 17, TOWNSHIP 10N, RANGE 10E, CO. 100, N.C.

PARCEL ID: 025-091-81  
 SECTION 17, TOWNSHIP 10N, RANGE 10E, CO. 100, N.C.

PARCEL ID: 025-091-82  
 SECTION 17, TOWNSHIP 10N, RANGE 10E, CO. 100, N.C.

PARCEL ID: 025-091-83  
 SECTION 17, TOWNSHIP 10N, RANGE 10E, CO. 100, N.C.

PARCEL ID: 025-091-84  
 SECTION 17, TOWNSHIP 10N, RANGE 10E, CO. 100, N.C.

PARCEL ID: 025-091-85  
 SECTION 17, TOWNSHIP 10N, RANGE 10E, CO. 100, N.C.

PARCEL ID: 025-091-86  
 SECTION 17, TOWNSHIP 10N, RANGE 10E, CO. 100, N.C.

PARCEL ID: 025-091-87  
 SECTION 17, TOWNSHIP 10N, RANGE 10E, CO. 100, N.C.

PARCEL ID: 025-091-88  
 SECTION 17, TOWNSHIP 10N, RANGE 10E, CO. 100, N.C.

PARCEL ID: 025-091-89  
 SECTION 17, TOWNSHIP 10N, RANGE 10E, CO. 100, N.C.

PARCEL ID: 025-091-90  
 SECTION 17, TOWNSHIP 10N, RANGE 10E, CO. 100, N.C.

PARCEL ID: 025-091-91  
 SECTION 17, TOWNSHIP 10N, RANGE 10E, CO. 100, N.C.

PARCEL ID: 025-091-92  
 SECTION 17, TOWNSHIP 10N, RANGE 10E, CO. 100, N.C.

PARCEL ID: 025-091-93  
 SECTION 17, TOWNSHIP 10N, RANGE 10E, CO. 100, N.C.

PARCEL ID: 025-091-94  
 SECTION 17, TOWNSHIP 10N, RANGE 10E, CO. 100, N.C.

PARCEL ID: 025-091-95  
 SECTION 17, TOWNSHIP 10N, RANGE 10E, CO. 100, N.C.

PARCEL ID: 025-091-96  
 SECTION 17, TOWNSHIP 10N, RANGE 10E, CO. 100, N.C.

PARCEL ID: 025-091-97  
 SECTION 17, TOWNSHIP 10N, RANGE 10E, CO. 100, N.C.

PARCEL ID: 025-091-98  
 SECTION 17, TOWNSHIP 10N, RANGE 10E, CO. 100, N.C.

PARCEL ID: 025-091-99  
 SECTION 17, TOWNSHIP 10N, RANGE 10E, CO. 100, N.C.

PARCEL ID: 025-091-100  
 SECTION 17, TOWNSHIP 10N, RANGE 10E, CO. 100, N.C.