

VICINITY MAP

SURVEY DISCLAIMER  
 ALTA/NSPS LAND TITLE SURVEY ISSUE NO. 2017-0001, NOVEMBER 01, 2017. PROVIDED BY ATLAS SURVEYING, INC., PINEVILLE, NORTH CAROLINA. ATLAS SURVEYING, INC. PHONE: 980-949-8475; WEBSITE: ATLASURVEYING.COM



**ColeJenest & Stone**

Shaping the Environment  
 Realizing the Possibilities

- Land Planning
- Landscape Architecture
- Civil Engineering
- Urban Design

300 South Tryon Street, Suite 1400  
 Charlotte, North Carolina 28202  
 P: 704.375.1555 F: 704.375.7951  
 www.colejeneststone.com

**CHARTER CORNELIUS, LP**

75 Holly Hill Lane, Suite 305  
 Greenwich  
 Connecticut 06830

**ONE NORMAN**

20101 West Catawba Avenue  
 Cornelius  
 North Carolina 28031

**EROSION CONTROL PLAN  
 STAGE 2**

Project No.  
 4493  
 Issued  
 03/26/19

Revised

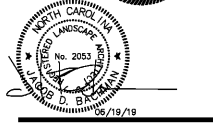

**LEGEND**

SYMBOL	DETAIL
	SEDIMENT BASIN 5/8/C-800
	OUTLET STRUCTURE WITH SKIMMER 6/C-800
	HIGH HAZARD SILT FENCE 10/C-800
	SILT FENCE 9/C-800
	TREE PROTECTION FENCING 2/C-803
	PROPOSED STORM DRAINAGE -/-
	STABILIZED CONSTRUCTION ENTRANCE 3/C-800
	GRAVEL RIP RAP APRON 3/C-802
	LIMITS OF DISTURBANCE -/-
	DIVERSION SWALE 8,12/C-800
	ROCK DITCH CHECK 2/C-800
	DRAINAGE AREA -/-
	FILTER BERM BASIN 4/C-800
	EROSION CONTROL MATTING 3/C-801
	SILT FENCE ROCK OUTLET 11/C-800
	STONE INLET PROTECTION 1/C-800
	CATCH BASIN INLET PROTECTION 1/C-801

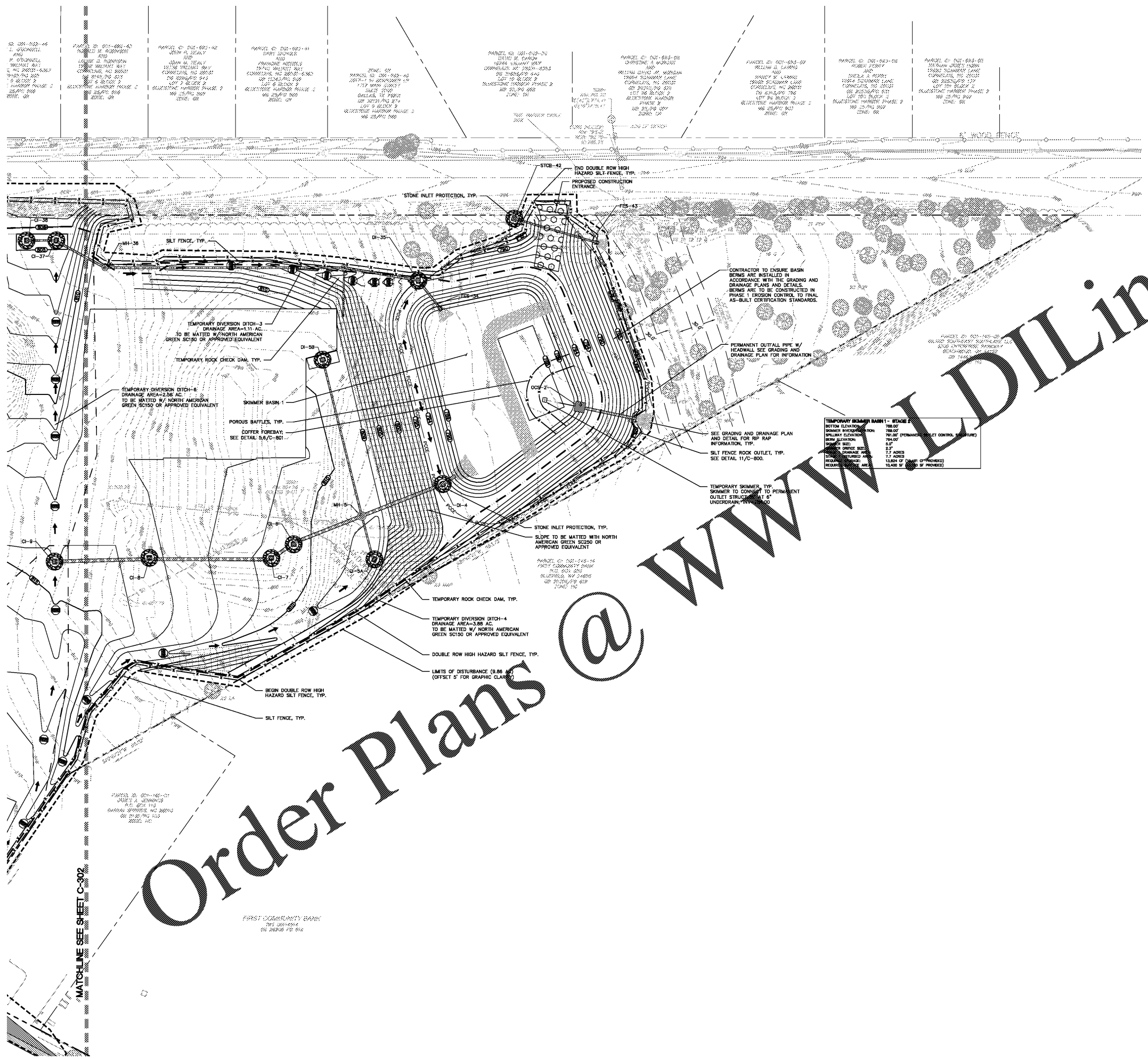

**TEMPORARY SEDIMENT BASIN - STAGE 1**

BOTTOM ELEVATION	788.00'
SKIMMER INLET ELEVATION	788.00'
SPILLWAY ELEVATION	791.00' (PERMANENT OUTLET CONTROL STRUCTURE)
BERM ELEVATION	791.00'
DIAMETER	5.0'
DRAINAGE AREA	7.7 ACRES
PERCENT IMPERVIOUS	7.7 ACRES
WATER STORAGE	13,628 CF (BASED ON PROVIDED)
RESIDUAL W. CAP.	16,482 CF (BASED ON PROVIDED)

MATCHLINE SEE SHEET C-302

**Order Plans @ WWW.DIline.com**

SEE SHEET C-301 AND C-808 FOR EROSION CONTROL NOTES



- CONTRACTOR IS FULLY RESPONSIBLE FOR CONTACTING APPROPRIATE PARTIES AND ASSURING THAT EXISTING UTILITIES ARE LOCATED PRIOR TO CONSTRUCTION.
- CONTRACTOR IS RESPONSIBLE FOR PLACING BARRICADES USING FLAG MEN, ETC. AS NECESSARY TO INSURE SAFETY TO THE PUBLIC.
- ALL PAYMENT CURS, CONCRETE OR ASPHALT, ARE TO BE REPLACED ACCORDING TO STANDARDS OF THE NORTH CAROLINA DEPARTMENT OF TRANSPORTATION AND CHARLOTTE-MECKLENBURG UTILITIES SPECIFICATIONS.
- SHORING SHALL BE IN ACCORDANCE WITH OSHA TRENCHING STANDARDS, 29 CFR, PART 1926, SUBPART P, OR AS AMENDED.

**C-303**

The drawings, the project manual and the design shown thereon are instruments of ColeJenest & Stone, P.A. The reproduction or unauthorized use of the documents without consent of ColeJenest & Stone, P.A. is prohibited.

ColeJenest & Stone, P.A. 2019