

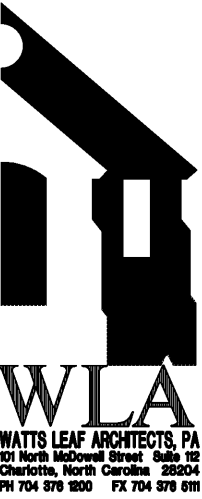

Structural Consulting Group, LLC
 6250 shiloh road - suite 20 - alpharetta, ga 30005
 phone (678) 513-4242 fax (678) 513-4232
 SCG Project No. 191003
 N.C. C.O.A.: P-0573

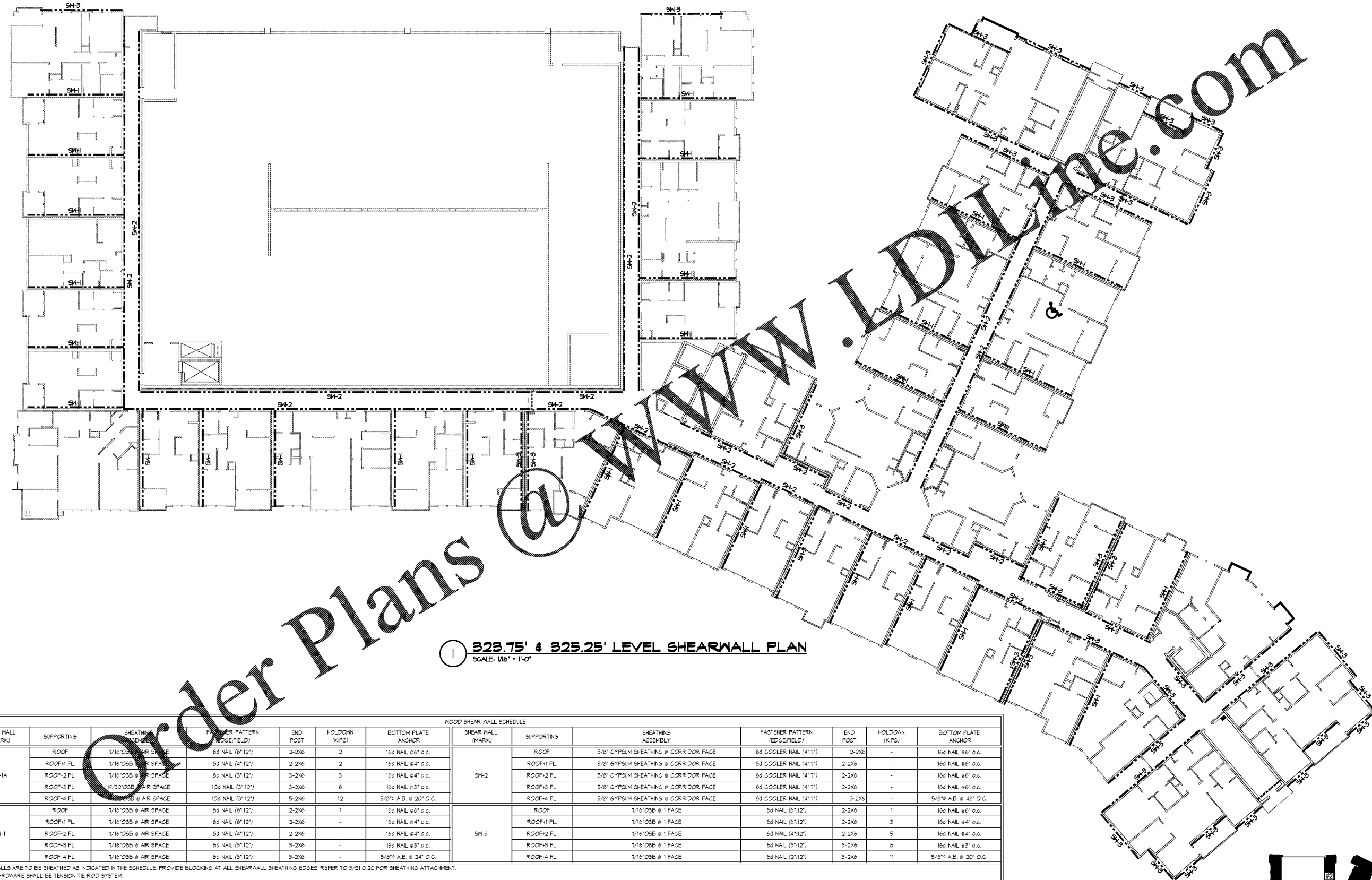

WATTS LEAF ARCHITECTS, PA
 171 North McDowell Street, Suite 102
 Charlotte, North Carolina 28204
 PH 704 376 1800 FX 704 376 6111



323.75' & 325.25' LEVEL SHEARWALL PLAN
 SCALE: 1/16" = 1'-0"

Order Plans @ WLA

WOOD SHEARWALL SCHEDULE													
SHEAR WALL (MARK)	SUPPORTING	SHEATHING ASSEMBLY	FASTENER PATTERN (EDGE/FIELD)	END POST	HOLDOWN (KIPS)	BOTTOM PLATE ANCHOR	SHEAR WALL (MARK)	SUPPORTING	SHEATHING ASSEMBLY	FASTENER PATTERN (EDGE/FIELD)	END POST	HOLDOWN (KIPS)	BOTTOM PLATE ANCHOR
SN-1A	ROOF	1/16" OSB @ AIR SPACE	8d NAIL (6"12")	2-2X6	2	16d NAIL @ 6" O.C.	SN-2	ROOF	5/8" GYPSUM SHEATHING @ CORRIDOR FACE	8d COOLER NAIL (4"7")	2-2X6	-	16d NAIL @ 6" O.C.
	ROOF+1 FL	1/16" OSB @ AIR SPACE	8d NAIL (4"12")	2-2X6	2	16d NAIL @ 4" O.C.		ROOF+1 FL	5/8" GYPSUM SHEATHING @ CORRIDOR FACE	8d COOLER NAIL (4"7")	2-2X6	-	16d NAIL @ 6" O.C.
	ROOF+2 FL	1/16" OSB @ AIR SPACE	8d NAIL (3"12")	3-2X6	3	16d NAIL @ 4" O.C.		ROOF+2 FL	5/8" GYPSUM SHEATHING @ CORRIDOR FACE	8d COOLER NAIL (4"7")	2-2X6	-	16d NAIL @ 6" O.C.
	ROOF+3 FL	1/16" OSB @ AIR SPACE	10d NAIL (3"12")	3-2X6	6	16d NAIL @ 3" O.C.		ROOF+3 FL	5/8" GYPSUM SHEATHING @ CORRIDOR FACE	8d COOLER NAIL (4"7")	2-2X6	-	16d NAIL @ 6" O.C.
	ROOF+4 FL	1/16" OSB @ AIR SPACE	10d NAIL (3"12")	5-2X6	12	5/8" A.B. @ 20" O.C.		ROOF+4 FL	5/8" GYPSUM SHEATHING @ CORRIDOR FACE	8d COOLER NAIL (4"7")	3-2X6	-	5/8" A.B. @ 48" O.C.
SN-1	ROOF	1/16" OSB @ AIR SPACE	8d NAIL (6"12")	2-2X6	1	16d NAIL @ 6" O.C.	SN-3	ROOF	1/16" OSB @ 1 FACE	8d NAIL (6"12")	2-2X6	1	16d NAIL @ 6" O.C.
	ROOF+1 FL	1/16" OSB @ AIR SPACE	8d NAIL (6"12")	2-2X6	-	16d NAIL @ 4" O.C.		ROOF+1 FL	1/16" OSB @ 1 FACE	8d NAIL (6"12")	2-2X6	3	16d NAIL @ 4" O.C.
	ROOF+2 FL	1/16" OSB @ AIR SPACE	8d NAIL (4"12")	2-2X6	-	16d NAIL @ 4" O.C.		ROOF+2 FL	1/16" OSB @ 1 FACE	8d NAIL (4"12")	2-2X6	5	16d NAIL @ 4" O.C.
	ROOF+3 FL	1/16" OSB @ AIR SPACE	8d NAIL (3"12")	3-2X6	-	16d NAIL @ 3" O.C.		ROOF+3 FL	1/16" OSB @ 1 FACE	8d NAIL (3"12")	3-2X6	8	16d NAIL @ 3" O.C.
	ROOF+4 FL	1/16" OSB @ AIR SPACE	8d NAIL (3"12")	3-2X6	-	5/8" A.B. @ 24" O.C.		ROOF+4 FL	1/16" OSB @ 1 FACE	8d NAIL (2"12")	3-2X6	11	5/8" A.B. @ 20" O.C.

* SHEARWALLS ARE TO BE SHEATHED AS INDICATED IN THE SCHEDULE. PROVIDE BLOCKING AT ALL SHEARWALL SHEATHING EDGES. REFER TO 3/51.0.2C FOR SHEATHING ATTACHMENT.
 † UPLIFT HARDWARE SHALL BE TENSION TIE ROD SYSTEM.
 ‡ REFER TO SHEET S1.0.2 FOR ADDITIONAL SHEARWALL REQUIREMENTS.
 § TENSION ROD HOLDOWN SHALL BE WELD TO EMBED PLATE AT PODIUM LEVEL. REFER TO SECTION 11/51.1.4.
 ¶ DRAG LINE SHALL BE BLOCKING WITH CONT. G5-16 STRIP PER 4/51.0.2B OR TRUSS SHALL BE DESIGN FOR ADDITIONAL 225 PLF SHEARLOAD.

CRABTREE NORTH APTS.
 2251 Charles Drive
 Raleigh, North Carolina
 EYC COMPANIES

03FEB20
 PRICING
 SET

PROJECT 1915
 DATE 06NOV19
 DRAWN BY SCG
 CHECKED BY F80

323.75' & 325.25' LEVEL
 SHEARWALL PLAN

S1.0.9

