

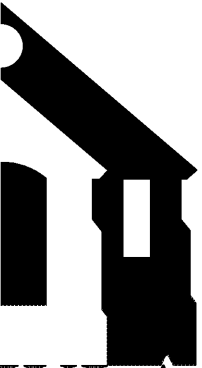

Structural Consulting Group, LLC  
 6250 shiloh road - suite 20 - alpharetta, ga 30005  
 phone (678) 513-4242 fax (678) 513-4232  
 SCG Project No. 191003  
 N.C. C.O.A. : P-0573



**WLA**  
 WATTS LEAF ARCHITECTS, PA  
 171 North McDowell Street, Suite 102  
 Charlotte, North Carolina 28204  
 PH 704 376 1800 FX 704 376 6111

**CRABTREE NORTH APTS.**  
 2251 Charles Drive  
 Raleigh, North Carolina  
 EYC COMPANIES

**03FEB20  
 PRICING  
 SET**

**PROJECT 1915  
 DATE 06NOV19  
 DRAWN BY SCG  
 CHECKED BY F80**

347.13' & 348.63' LEVEL  
 SHEARWALL PLANS

**S1.0.11**

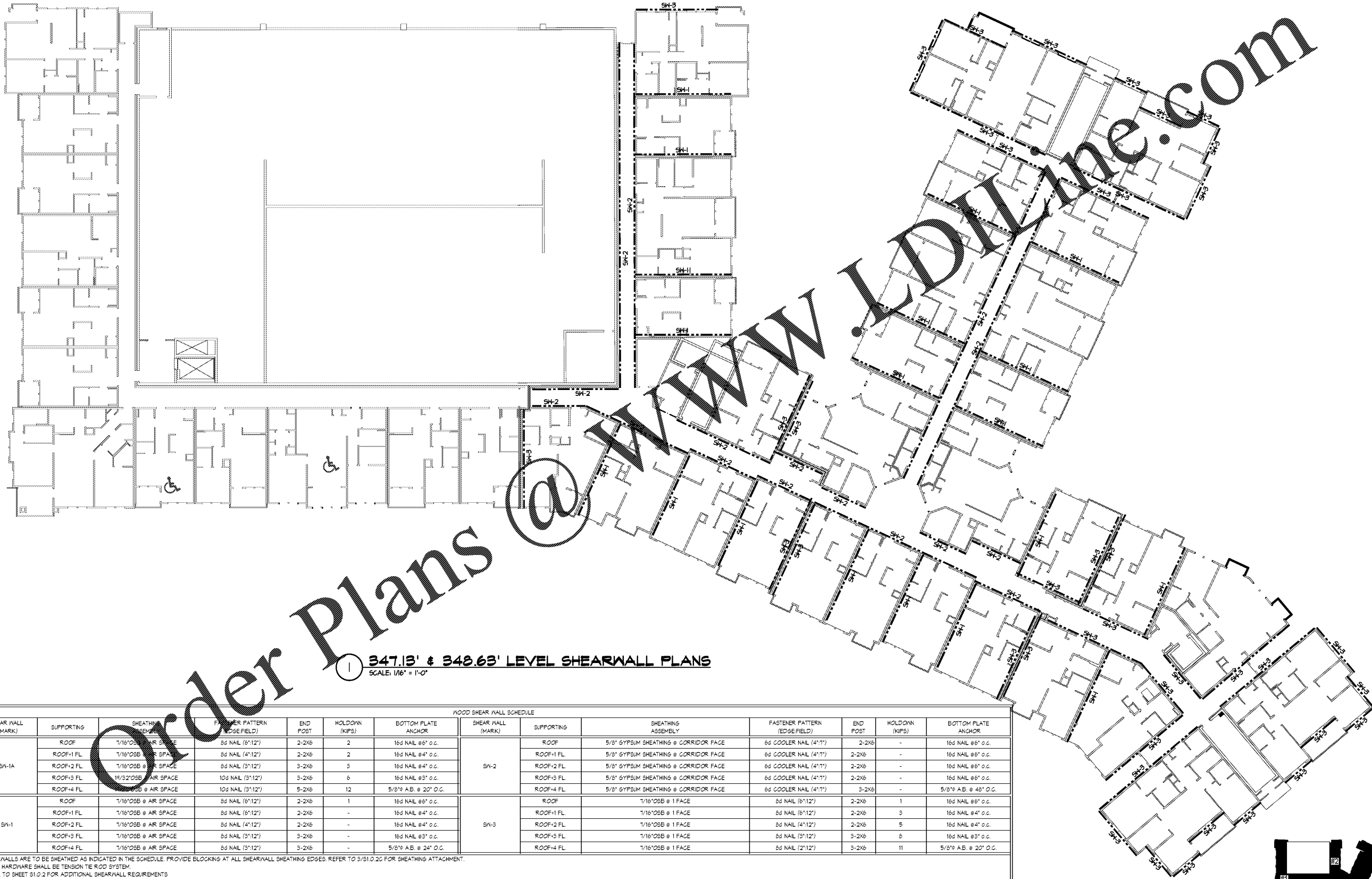
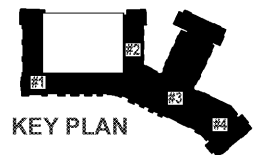

Order Plans @ WWW.LORDNE.COM

**347.13' & 348.63' LEVEL SHEARWALL PLANS**  
 SCALE: 1/8" = 1'-0"

WOOD SHEAR WALL SCHEDULE													
SHEAR WALL (MARK)	SUPPORTING	SHEATHING ASSEMBLY	FASTENER PATTERN (EDGE/FIELD)	END POST	HOLDOWN (KIPS)	BOTTOM PLATE ANCHOR	SHEAR WALL (MARK)	SUPPORTING	SHEATHING ASSEMBLY	FASTENER PATTERN (EDGE/FIELD)	END POST	HOLDOWN (KIPS)	BOTTOM PLATE ANCHOR
SN-1A	ROOF	7/16" OSB @ AIR SPACE	8d NAIL (6"12")	2-2X6	2	16d NAIL @6" O.C.	SN-2	ROOF	5/8" GYPSUM SHEATHING @ CORRIDOR FACE	8d COOLER NAIL (4"7")	2-2X6	-	16d NAIL @6" O.C.
	ROOF+1 FL	7/16" OSB @ AIR SPACE	8d NAIL (4"12")	2-2X6	2	16d NAIL @4" O.C.		ROOF+1 FL	5/8" GYPSUM SHEATHING @ CORRIDOR FACE	8d COOLER NAIL (4"7")	2-2X6	-	16d NAIL @6" O.C.
	ROOF+2 FL	7/16" OSB @ AIR SPACE	8d NAIL (3"12")	3-2X6	3	16d NAIL @4" O.C.		ROOF+2 FL	5/8" GYPSUM SHEATHING @ CORRIDOR FACE	8d COOLER NAIL (4"7")	2-2X6	-	16d NAIL @6" O.C.
	ROOF+3 FL	1 1/2" OSB @ AIR SPACE	10d NAIL (3"12")	3-2X6	6	16d NAIL @3" O.C.		ROOF+3 FL	5/8" GYPSUM SHEATHING @ CORRIDOR FACE	8d COOLER NAIL (4"7")	2-2X6	-	16d NAIL @6" O.C.
ROOF+4 FL	7/16" OSB @ AIR SPACE	10d NAIL (3"12")	5-2X6	12	5/8" A.B. @ 20" O.C.	ROOF+4 FL	5/8" GYPSUM SHEATHING @ CORRIDOR FACE	8d COOLER NAIL (4"7")	3-2X6	-	5/8" A.B. @ 48" O.C.		
SN-1	ROOF	7/16" OSB @ AIR SPACE	8d NAIL (6"12")	2-2X6	1	16d NAIL @6" O.C.	SN-3	ROOF	7/16" OSB @ 1 FACE	8d NAIL (6"12")	2-2X6	1	16d NAIL @6" O.C.
	ROOF+1 FL	7/16" OSB @ AIR SPACE	8d NAIL (6"12")	2-2X6	-	16d NAIL @4" O.C.		ROOF+1 FL	7/16" OSB @ 1 FACE	8d NAIL (6"12")	2-2X6	3	16d NAIL @4" O.C.
	ROOF+2 FL	7/16" OSB @ AIR SPACE	8d NAIL (4"12")	2-2X6	-	16d NAIL @4" O.C.		ROOF+2 FL	7/16" OSB @ 1 FACE	8d NAIL (4"12")	2-2X6	5	16d NAIL @4" O.C.
	ROOF+3 FL	7/16" OSB @ AIR SPACE	8d NAIL (3"12")	3-2X6	-	16d NAIL @3" O.C.		ROOF+3 FL	7/16" OSB @ 1 FACE	8d NAIL (3"12")	3-2X6	8	16d NAIL @3" O.C.
ROOF+4 FL	7/16" OSB @ AIR SPACE	8d NAIL (3"12")	3-2X6	-	5/8" A.B. @ 24" O.C.	ROOF+4 FL	7/16" OSB @ 1 FACE	8d NAIL (2"12")	3-2X6	11	5/8" A.B. @ 20" O.C.		

\* SHEARWALLS ARE TO BE SHEATHED AS INDICATED IN THE SCHEDULE. PROVIDE BLOCKING AT ALL SHEARWALL SHEATHING EDGES. REFER TO 3/51.0.2C FOR SHEATHING ATTACHMENT.  
 † UPLIFT HARDWARE SHALL BE TENSION TIE ROD SYSTEM.  
 ‡ REFER TO SHEET S1.0.2 FOR ADDITIONAL SHEARWALL REQUIREMENTS.  
 § TENSION ROD HOLDOWN SHALL BE WELD TO EMBED PLATE AT PODIUM LEVEL. REFER TO SECTION 11/51.1.4.  
 ¶ DRAG LINE SHALL BE BLOCKING WITH CONT. G5-16 STRAP PER 4/51.0.2B OR TRUSS SHALL BE DESIGN FOR ADDITIONAL 225 PLF SHEARLOAD.