

Order Plans

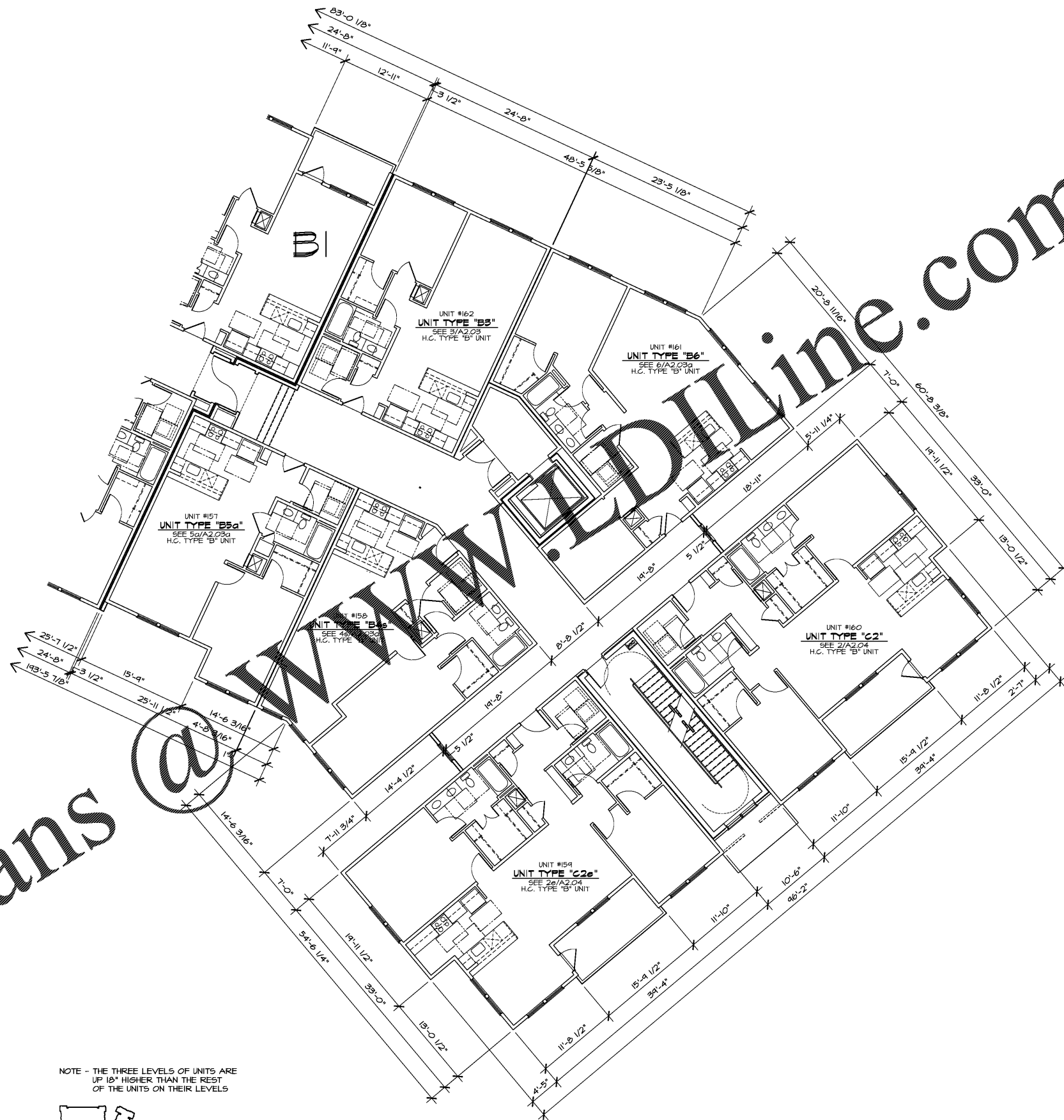

NOTE - THE THREE LEVELS OF UNITS ARE UP 18" HIGHER THAN THE REST OF THE UNITS ON THEIR LEVELS

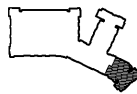

1 THIRD LEVEL PLAN (336.94') - BUILDING #4

A4.29

1/8" = 1'-0"

**GENERAL NOTES**

The Architectural drawings must be used in conjunction with the Civil, Structural, MEP, Fire Protection drawings and specifications. The Contractor is responsible for all coordination between the drawings. Discrepancies should be brought to the attention of the architect.

The Contractor is advised that the available space for routing all electrical, mechanical, plumbing, fire protection and communications piping, conduit, trays and ductwork may be limited in many locations. The Contractor shall coordinate all of the trades work and make adjustments, with the Architect's approval to the routing of these items as required. Any rework resulting from the failure to coordinate will be performed by the Contractor at no additional cost.

All dimensions are from face of stud, u.n.o.

All penetrations of fire rated assemblies shall be fire blocked and sealed per UL approved methods.

All concealed fire rated assemblies shall be provided with signage indicating the type of assembly, and the fire rating if hours in letters no smaller than 2" high. See 101.2.

**FIRE RATINGS LEGEND**

**THREE HOUR RATED ASSEMBLIES:**

- 3 HOUR RATED FIRE HALL: 3FW
- 3 HOUR RATED CONCRETE SLABS: SEE N.C.S.B.C. SECTION 12.10
- 3 HOUR RATED CONCRETE COLUMNS: SEE N.C.S.B.C. SECTION 12.10

**TWO HOUR RATED ASSEMBLIES:**

- 2 HOUR RATED FIRE HALL: 2FW
- 2 HOUR RATED CONCRETE SLABS: SEE N.C.S.B.C. SECTION 12.10
- 2 HOUR RATED CONCRETE COLUMNS: SEE N.C.S.B.C. SECTION 12.10

**ONE HOUR RATED ASSEMBLIES:**

- 1 HOUR RATED FIRE BARRIER: 1FB
- 1 HOUR RATED FIRE PARTITION: 1FP
- 1 HOUR RATED STRUCTURAL AND NON-STRUCTURAL ELEMENTS: 1HR

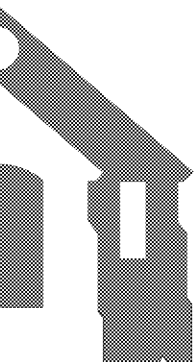

**WLA**  
 WATTS LEAF ARCHITECTS, PA  
 101 North McDowell Street, Suite 112  
 Charlotte, North Carolina 28204  
 PH 704 376 1200 FX 704 376 5111

**CRABTREE NORTH APTS.**

2251 Charles Drive  
 Raleigh, North Carolina  
 EYC COMPANIES

PROJECT 1915  
 DATE 18DEC19  
 DRAWN BY WJP  
 CHECKED BY CMW

THIRD LEVEL PLAN - BUILDING #4

A4.29