

ALL WALLS ON THIS LEVEL OF BUILDING #2 ARE TO BE NOMINALLY 10' TALL EXCEPT FOR:
 1 - ALL WALLS IN UNIT #90 ARE TO BE 12'
 2 - THE WALLS ON THE FRONT SIDE OF UNIT #5 82, 83 (PARTIAL) & 84 ARE TO BE 12'.
 3 - THE DECK WALLS/BEAMS IN UNIT #5 82, 83 & 84 ARE TO BE 8'-7 1/2'.

GENERAL NOTES
 The Architectural drawings must be used in conjunction with the Civil, Structural, MEP, Fire Protection drawings and specifications. The Contractor is responsible for all coordination between the drawings. Discrepancies should be brought to the attention of the architect.
 The Contractor is advised that the available space for routing all electrical, mechanical, plumbing, fire protection and communications piping, conduit, trays and ductwork may be limited in many locations. The Contractor shall coordinate all of the trades work and make adjustments, with the Architect's approval to the routing of these items as required. Any rework resulting from the failure to coordinate will be performed by the Contractor at no additional cost.
 All dimensions are from face of stud, u.o.o.
 All penetrations of fire rated assemblies shall be fire blocked and sealed per UL approved methods.
 All concealed fire rated assemblies shall be provided with signage indicating the type of assembly and the fire rating in hours in letters no smaller than 2" high. See 101.2.

FIRE RATING LEGEND

THREE HOUR RATED ASSEMBLIES:		
3 HOUR RATED FIRE WALL		
3FW	3FW	3FW
3 HOUR RATED CONCRETE SLABS SEE NC 530.2 SECTION 1211(I) SLABS BETWEEN STORAGE LEVEL AND APT. UNITS ABOVE BUILDING #2 ONLY		
3 HOUR RATED CONCRETE COLUMNS SEE NC 530.2 SECTION 1211(I) COLUMNS SUPPORTING 3 HOUR RATED SLABS		
TWO HOUR RATED ASSEMBLIES:		
2 HOUR RATED FIRE WALL		
2FW	2FW	2FW
UL U-210 2-HR FIREWALL SEPARATING TYPE-SA FIRE AREA		
2 HOUR RATED FIRE BARRIER		
2FB	2FB	2FB
URCS - ELEVATOR AND STAIR & MECH. SHAFTS		
2 HOUR RATED CEILINGSS SIA FILE NO. FC 9125		
2 HOUR RATED CONCRETE SLAB SEE NC 530.2 SECTION 1211(I) SLAB BETWEEN GLENDEN AND UNIT 7 UNITS ABOVE BUILDING #2 ONLY		
2 HOUR RATED CONCRETE COLUMN SEE NC 530.2 TABLE 1211(I) COLUMNS SUPPORTING 2 HOUR RATED SLABS		
ONE HOUR RATED ASSEMBLIES:		
1 HOUR RATED FIRE BARRIER		
1FB	1FB	1FB
UL U-305 1-HR FIRE BARRIER ADJACENT TO ENCLOSED BARBERS HALLS		
1 HOUR RATED FIRE PARTITION		
1FP	1FP	1FP
UL U-341 1-HR TENANT SEPARATION WALLS		
UL U-305 1-HR CORRIDOR WALLS - BUILT TO ACHIEVE 5102B RATING PER REGS. LISTED IN UL, INCL. FERRING CHANNELS/CLIPS ON CORRIDOR SIDE OF ASSEMBLY. OSB PANELS TO BE PLACED BETWEEN STUD ENDS AND CLIPS AT BEAR WALL LOCATIONS, COORDINATE WITH THE STRUCTURAL		
1 HOUR RATED STRUCTURAL AND NON-STRUCTURAL ELEMENTS		
1HR	1HR	1HR
UL U-356 1-HR RATED EXTERIOR BEARING WALL		
UL U-305 1-HR RATED UNIT INTERIOR BEARING WALL AND ELEVATOR LOBBIES		
1-HR RATED ROOF/CEILING ASSEMBLY, SEE: AO/11 GYPSUM ASSOCIATION FILE NO. NC 2609		

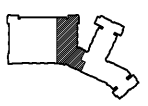

FOURTH LEVEL PLAN (347.13') - BUILDING #2

1/8" = 1'-0"

PROJECT	1915
DATE	02JAN20
DRAWN BY	WJP
CHECKED BY	CMW
FOURTH LEVEL PLAN - BUILDING #2	
A4.20	