

GENERAL NOTES

The Architectural drawings must be used in conjunction with the Civil, Structural, MEP, Fire Protection drawings and specifications. The Contractor is responsible for all coordination between the drawings. Discrepancies should be brought to the attention of the architect.

The Contractor is advised that the available space for routing all electrical, mechanical, plumbing, fire protection and communications piping, conduit, trays and ductwork may be limited in many locations. The Contractor shall coordinate all of the trades work and make adjustments, with the Architect's approval to the routing of these items as required. Any rework resulting from the failure to coordinate will be performed by the Contractor at no additional cost.

All dimensions are from face of stud, u.n.o.

All penetrations of fire rated assemblies shall be fire blocked and sealed per UL approved methods.

All concealed fire rated assemblies shall be provided with signage indicating the type of assembly and the fire rating in hours. In letters no smaller than 2" high. See 101.2.

FIRE RATINGS LEGEND

THREE HOUR RATED ASSEMBLIES:

3 HR RATED FIRE WALL
3FW

3 HR RATED CONCRETE SLABS
SEE N.C.S.B.C. SECTION 1211(J)
SLABS BETWEEN STORAGE LEVEL AND APT. UNITS ABOVE (BUILDING #2 ONLY)

3 HR RATED CONCRETE COLUMNS
SEE N.C.S.B.C. SECTION 1211(J)
COLUMNS SUPPORTING 3 HOUR RATED SLABS

TWO HOUR RATED ASSEMBLIES:

2 HR RATED FIRE WALL
2FW

UL U-210 2-HR FIREWALL SEPARATING TYPE-SA FIRE AREA

2 HR RATED FIRE BARRIER
2FB

URCS - ELEVATOR AND STAIR & MECH. SHAFTS

2 HOUR RATED CEILINGSS
SA FILE NO. FC 5725

2 HOUR RATED CONCRETE SLABS
SEE N.C.S.B.C. SECTION 1211(J)
SLAB BETWEEN GLENNHOUSE AND APT. UNITS ABOVE (BUILDING #4 ONLY)

2 HR RATED CONCRETE COLUMNS
SEE N.C.S.B.C. TABLE 1211(J)
COLUMNS SUPPORTING 2 HOUR RATED SLABS

ONE HOUR RATED ASSEMBLIES:

1 HR RATED FIRE BARRIER
1FB

UL U-305 1-HR FIRE BARRIER ADJACENT TO ENCLOSED GARAGE HALLS

1 HOUR RATED FIRE PARTITION
1FP

UL U-341 1-HR TENANT SEPARATION WALLS

UL U-305 1-HR CORRIDOR HALLS - BUILT TO ACHIEVE STC50 RATING PER REGS. LISTED IN UL INCL. FURNISH CHANNELS/CLIPS ON CORRIDOR SIDE OF ASSEMBLY. CBS PANELS TO BE PLACED BETWEEN GRID BEAMS AND CLIPS AT BEARING WALL LOCATIONS. COORDINATE WITH THE STRUCTURAL

1 HOUR RATED STRUCTURAL AND NON-STRUCTURAL ELEMENTS
1HR

UL U-306 1-HR RATED EXTERIOR BEARING WALL

UL U-305 1-HR RATED UNIT INTERIOR BEARING WALL AND ELEVATOR LOBBIES

1-HR RATED ROOF/CEILING ASSEMBLY, SEE A011 8795.0M ASSOCIATION FILE NO. RC 2603

UL L-528 1-HR RATED FLOOR/CEILING ASSEMBLY

WLA
WATTS LEAF ARCHITECTS, PA
101 North McDowell Street, Suite 112
Charlotte, North Carolina 28204
PH 704 376 1200 FX 704 376 5114

CRABTREE NORTH APTS.
2251 Charles Drive
Raleigh, North Carolina
EYC COMPANIES

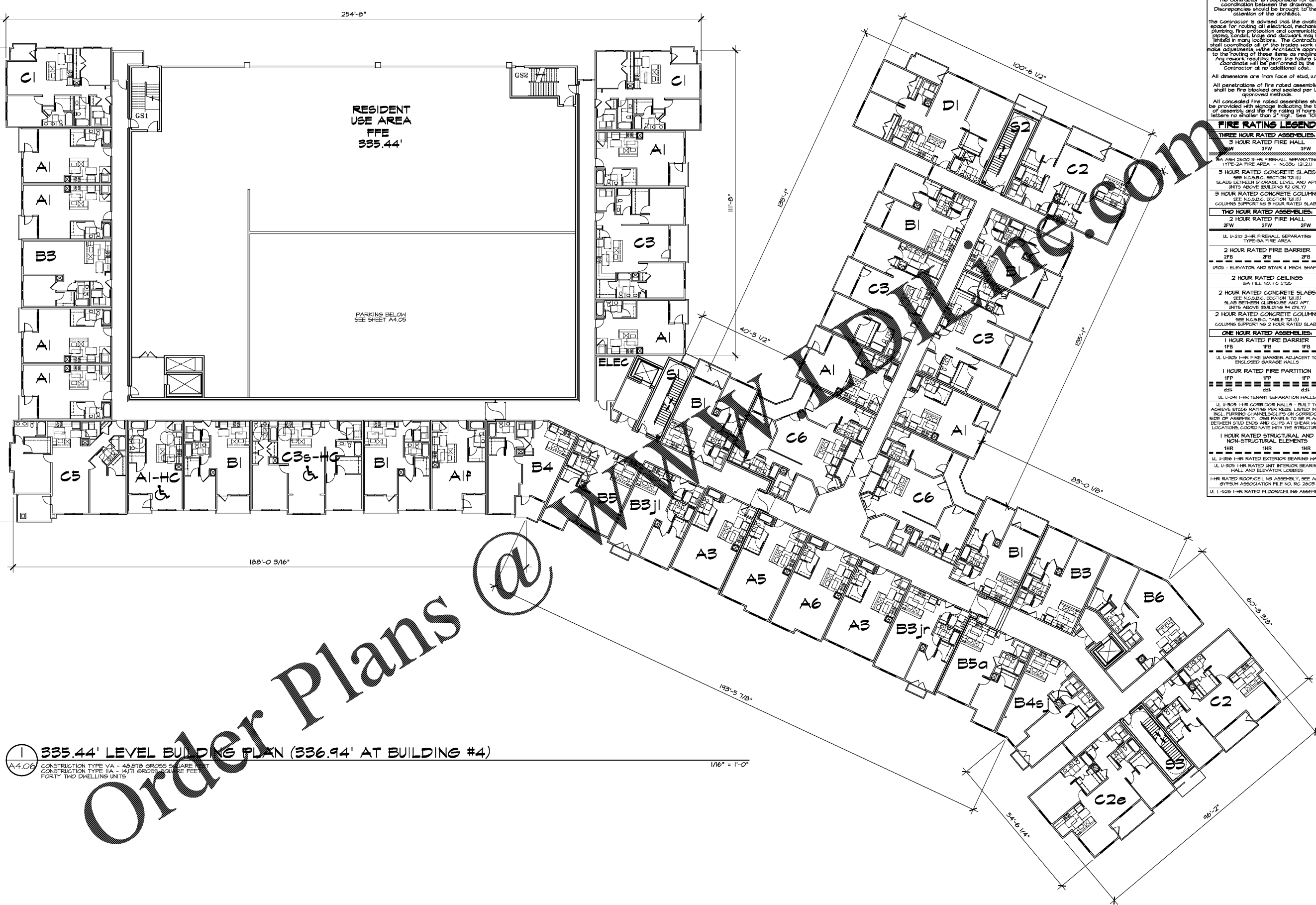

1 335.44' LEVEL BUILDING PLAN (336.94' AT BUILDING #4)
A4.06 CONSTRUCTION TYPE VA - 49,870 GROSS SQUARE FEET
CONSTRUCTION TYPE IIA - 14,171 GROSS SQUARE FEET
FORTY TWO DWELLING UNITS

Order Plans @

PROJECT	1915
DATE	29DEC19
DRAWN BY	WJP
CHECKED BY	CMW

335.44' LEVEL BUILDING PLAN

A4.06