

WLA
 WATTS LEAF ARCHITECTS, PA
 101 North McDowell Street Suite 112
 Charlotte, North Carolina 28204
 PH 704 376 1200 FX 704 376 5111

GENERAL NOTES

The Architectural drawings must be used in conjunction with the Civil Structural, MEP, Fire Protection drawings and specifications. The Contractor is responsible for all coordination between the drawings. Discrepancies should be brought to the attention of the architect.

The Contractor is advised that the available space for routing all electrical, mechanical, plumbing, fire protection and communications piping, conduit, trays and ductwork may be limited in many locations. The Contractor shall coordinate all of the trades work and make adjustments, where the Architect's approval to the routing of these items as required. Any remarks resulting from the routing to coordinate shall be performed by the Contractor at no additional cost.

All dimensions are from face of stud, U.D.O.

All penetrations of fire rated assemblies shall be fire blocked and sealed per UL approved methods.

All concealed fire rated assemblies shall be provided with signage indicating the type of assembly and the fire rating in hours in letters no smaller than 2" high. See 101.2.

FIRE RATINGS LEGEND

THREE HOUR RATED ASSEMBLIES:

- 3HW - 3HR RATED FIRE WALL
- 3FW - 3HR RATED FIRE WALL
- 3FV - 3HR RATED FIRE WALL
- 3A - 3HR RATED FIRE WALL
- 3B - 3HR RATED FIRE WALL
- 3C - 3HR RATED FIRE WALL
- 3D - 3HR RATED FIRE WALL
- 3E - 3HR RATED FIRE WALL
- 3F - 3HR RATED FIRE WALL
- 3G - 3HR RATED FIRE WALL
- 3H - 3HR RATED FIRE WALL
- 3I - 3HR RATED FIRE WALL
- 3J - 3HR RATED FIRE WALL
- 3K - 3HR RATED FIRE WALL
- 3L - 3HR RATED FIRE WALL
- 3M - 3HR RATED FIRE WALL
- 3N - 3HR RATED FIRE WALL
- 3O - 3HR RATED FIRE WALL
- 3P - 3HR RATED FIRE WALL
- 3Q - 3HR RATED FIRE WALL
- 3R - 3HR RATED FIRE WALL
- 3S - 3HR RATED FIRE WALL
- 3T - 3HR RATED FIRE WALL
- 3U - 3HR RATED FIRE WALL
- 3V - 3HR RATED FIRE WALL
- 3W - 3HR RATED FIRE WALL
- 3X - 3HR RATED FIRE WALL
- 3Y - 3HR RATED FIRE WALL
- 3Z - 3HR RATED FIRE WALL

TWO HOUR RATED ASSEMBLIES:

- 2HW - 2HR RATED FIRE WALL
- 2FW - 2HR RATED FIRE WALL
- 2FV - 2HR RATED FIRE WALL
- 2A - 2HR RATED FIRE WALL
- 2B - 2HR RATED FIRE WALL
- 2C - 2HR RATED FIRE WALL
- 2D - 2HR RATED FIRE WALL
- 2E - 2HR RATED FIRE WALL
- 2F - 2HR RATED FIRE WALL
- 2G - 2HR RATED FIRE WALL
- 2H - 2HR RATED FIRE WALL
- 2I - 2HR RATED FIRE WALL
- 2J - 2HR RATED FIRE WALL
- 2K - 2HR RATED FIRE WALL
- 2L - 2HR RATED FIRE WALL
- 2M - 2HR RATED FIRE WALL
- 2N - 2HR RATED FIRE WALL
- 2O - 2HR RATED FIRE WALL
- 2P - 2HR RATED FIRE WALL
- 2Q - 2HR RATED FIRE WALL
- 2R - 2HR RATED FIRE WALL
- 2S - 2HR RATED FIRE WALL
- 2T - 2HR RATED FIRE WALL
- 2U - 2HR RATED FIRE WALL
- 2V - 2HR RATED FIRE WALL
- 2W - 2HR RATED FIRE WALL
- 2X - 2HR RATED FIRE WALL
- 2Y - 2HR RATED FIRE WALL
- 2Z - 2HR RATED FIRE WALL

ONE HOUR RATED ASSEMBLIES:

- 1HW - 1HR RATED FIRE WALL
- 1FW - 1HR RATED FIRE WALL
- 1FV - 1HR RATED FIRE WALL
- 1A - 1HR RATED FIRE WALL
- 1B - 1HR RATED FIRE WALL
- 1C - 1HR RATED FIRE WALL
- 1D - 1HR RATED FIRE WALL
- 1E - 1HR RATED FIRE WALL
- 1F - 1HR RATED FIRE WALL
- 1G - 1HR RATED FIRE WALL
- 1H - 1HR RATED FIRE WALL
- 1I - 1HR RATED FIRE WALL
- 1J - 1HR RATED FIRE WALL
- 1K - 1HR RATED FIRE WALL
- 1L - 1HR RATED FIRE WALL
- 1M - 1HR RATED FIRE WALL
- 1N - 1HR RATED FIRE WALL
- 1O - 1HR RATED FIRE WALL
- 1P - 1HR RATED FIRE WALL
- 1Q - 1HR RATED FIRE WALL
- 1R - 1HR RATED FIRE WALL
- 1S - 1HR RATED FIRE WALL
- 1T - 1HR RATED FIRE WALL
- 1U - 1HR RATED FIRE WALL
- 1V - 1HR RATED FIRE WALL
- 1W - 1HR RATED FIRE WALL
- 1X - 1HR RATED FIRE WALL
- 1Y - 1HR RATED FIRE WALL
- 1Z - 1HR RATED FIRE WALL

1 HR RATED ROOF/CEILING ASSEMBLY: SEE A011 (SPRINK ASSOCIATION FILE NO. RC 2603)

1 HR RATED ROOF/CEILING ASSEMBLY: SEE A011 (SPRINK ASSOCIATION FILE NO. RC 2603)

1 HR RATED ROOF/CEILING ASSEMBLY: SEE A011 (SPRINK ASSOCIATION FILE NO. RC 2603)

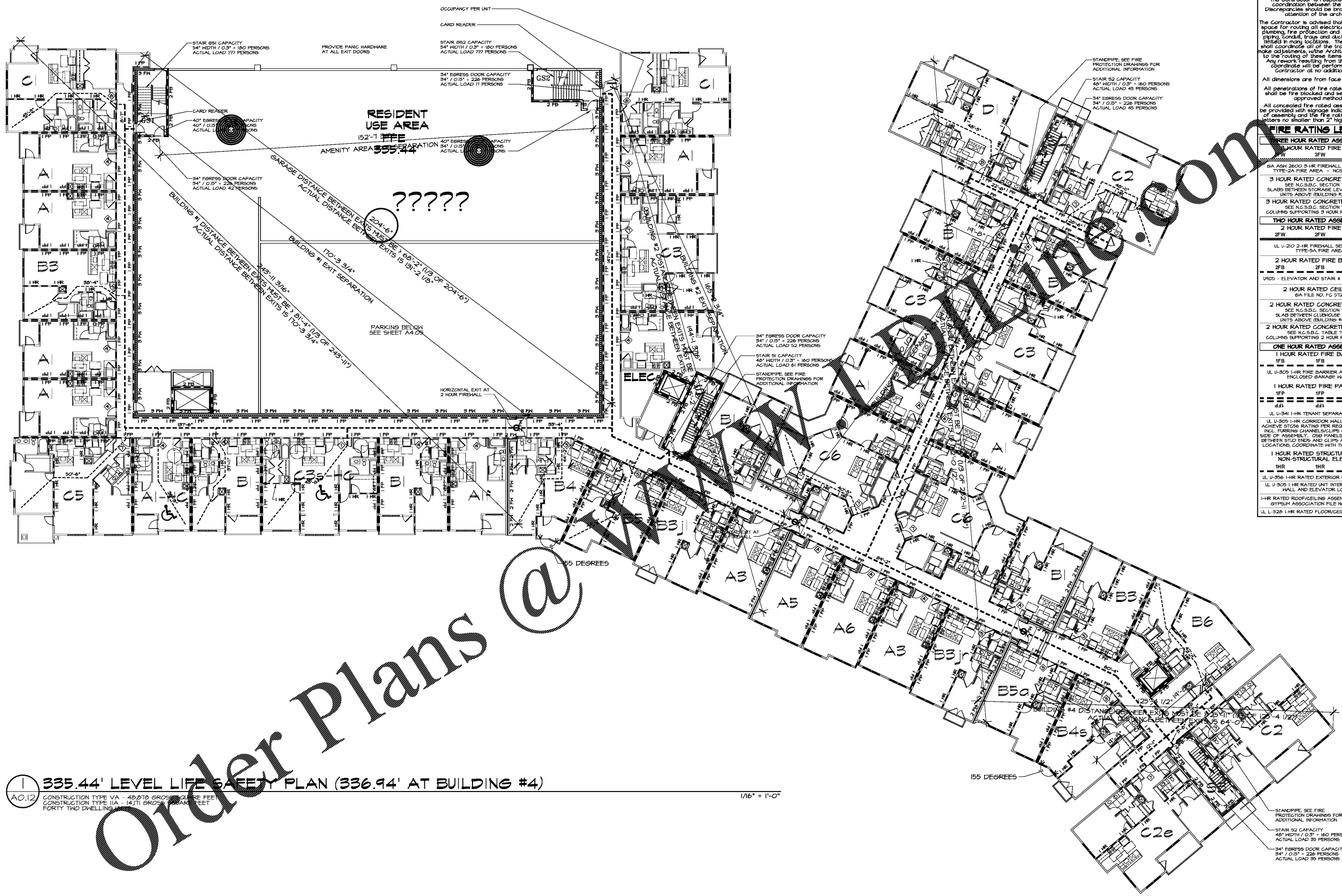

1 335.44' LEVEL LIFE SAFETY PLAN (336.94' AT BUILDING #4)

AO.12 CONSTRUCTION TYPE VA - 48,879 GROSS SQUARE FEET
 CONSTRUCTION TYPE IIA - 14,711 GROSS SQUARE FEET
 FORTY TWO DWELLING UNITS

1/16" = 1'-0"

Order Plans @

CRABTREE NORTH APTS.
 2251 Charles Drive
 Raleigh, North Carolina
 EYC COMPANIES

PROJECT	1915
DATE	03FEB20
DRAWN BY	WJP
CHECKED BY	CMW

335.44' LEVEL
 LIFE SAFETY
 PLAN

A0.12