

1 FLOOR PLAN - AREA B  
1/8" = 1'-0"

**FLOOR PLAN LEGEND**

**GENERAL NOTES**  
 A. SEE PLUMBING PLANS FOR IN SLAB PLUMBING ROUGH-IN LOCATIONS.  
 B. SEE REFLECTED CEILING PLAN FOR SOFFIT DESIGN EXTENTS.  
 C. SEE EXTERIOR ELEVATIONS FOR ADDITIONAL STOREFRONT LOCATIONS.  
 D. ALL DOORS TO BE LOCATED 8" OFF ADJACENT WALL UNLESS DIMENSIONED OTHERWISE.

**INTERIOR PARTITION NOTES**  
 FP-1. ALL WALLS SHOWN TO BE 8" CMU BLOCK INSTALLED TO A MINIMUM OF 2" ABOVE FINISHED CEILING (A MAXIMUM OF 8" ABOVE FINISHED CEILING, UNLESS NOTED OTHERWISE. REFER TO INTERIOR PARTITION WALL TYPE AND CONSTRUCTION LEGEND FOR ADDITIONAL WALL TYPES.  
 FP-2. REFER TO STRUCT DWGS FOR LOCATIONS & EXTENT OF REINFORCED CMU WALLS AND BRACING TO STRUCTURE.  
 FP-3. FOR 1 HOUR FIRE RATED WALLS WITH EXPOSED STRUCTURES ON ANY SIDE, START GYPSUM BOARD A MIN. OF 6" ABOVE HIGHEST ADJACENT CEILING, UNLESS NOTED OTHERWISE.  
 FIRE AND SMOKE PARTITIONS  
 FP-4. PROVIDE A SMOKE TIGHT BARRIER AT ALL CORRIDORS, GANG TOILET ROOMS, JANITOR'S CLOSETS AND STORAGE/UTILITY ROOMS, UNLESS A HIGHER FIRE/SMOKE RATING IS DEFINED ON THESE DRAWINGS. SEE REFLECTED CEILING PLAN FOR ADDITION REQUIREMENTS FOR THESE AREAS.

**INTERIOR PARTITION WALL CONSTRUCTION LEGEND**

1	STANDARD PARTITION, 8" CMU (8) TO 2" MIN ABOVE FINISHED CEILING
2	CMU PARTITION, 6" CMU (6) TO 2" MIN ABOVE FINISHED CEILING
3a/3b	ADJACENT PARTITION, 8" CMU (3a) OR 12" CMU (3b) UP TO 8" ABOVE FINISHED CEILING
4a/4b	1 HOUR FIRE RATED PARTITION & SMOKE PARTITION, 8" GYP (4a) OR 12" CMU (4b) TO 8" ABOVE CEILING; 5/8" GYPSUM BOARD ON EA SIDE OF 6" 22 GA METAL STUDS @ 24" O.C. TO DECK, SEAL TIGHT TO DECK. SEE SCHEDULE NOTE #2 BELOW, UL DESIGN #9095 & #9105.
5	2 HOUR FIRE RATED PARTITION @ FIREWALL, 8" CMU FLUSH TO ROOF DECK UL DESIGN #10905
6	12" CMU PARTITION, 12" CMU UP TO 2" MIN ABOVE FINISHED CEILING
7	9 1/4" STUD PARTITION, 5/8" GYP BOARD (BOTH SIDES) ON 6" 22 GA METAL STUDS @ 24" O.C. TO 6" MIN ABOVE CEILING WITH SOUND BATT INSULATION BRACE TO STRUCTURE AT 48" O.C. MAX.
8	4 7/8" STUD PARTITION, 5/8" GYP BOARD (BOTH SIDES) ON 3 5/8" 22 GA METAL STUDS @ 24" O.C. TO 6" MIN ABOVE CEILING WITH 1 1/2" SOUND BATT INSULATION BRACE TO STRUCTURE AT 48" O.C. MAX.
9A	CMU PARTIAL HEIGHT WALL, 8" CMU (8A) OR 8" CMU (8B) UP TO HEIGHT AS INDICATED ON PLAN OR SECTION, USE INVERTED CMU BOARD BEAM ON TOP COURSE.
10	4" CMU FURRING WALL, 4" CMU UP TO 2" MIN ABOVE FINISHED CEILING
11A	SOUND AND SMOKE PARTITION, 6" CMU (11A) OR 12" CMU (11B) FLUSH TO ROOF DECK, SEAL TIGHT TO DECK, FILL ALL VOID CELLS WITH FOAM IN PLACE MASONRY INSULATION, SOUND SEAL ALL PENETRATIONS, UL DESIGN #1905
12	4" BRICK VENEER, 4" BRICK VENEER UP TO 2" MIN ABOVE FINISHED CEILING
13	8" CMU BLOCK, 8" CMU WALL EXTEND TO UNDERSIDE OF ROOF
14	FURRING, 5/8" GYP BOARD ON 1 1/2" METAL FURRING AT 24" O.C.

**SCHEDULE NOTES:**  
 1. PARTITION TYPES NOT SHOWN ALONG INTERIOR DOOR AND WINDOW HEADERS FOR CLARITY, WHERE APPLICABLE, PARTITION TYPE DEFINED ADJACENT TO HEADERS SHALL CONTINUE OVER SUCH HEADERS, UNLESS NOTED OTHERWISE FOR 1 HOUR FIRE RATED WALLS WITH EXPOSED STRUCTURES ON ANY SIDE, START GYPSUM BOARD A MIN. OF 6" ABOVE HIGHEST ADJACENT CEILING, UNLESS NOTED OTHERWISE.  
 2. WALLS NOT TAGGED WILL BE SAME TYPE AS ADJACENT WALLS UNLESS NOTED OTHERWISE.

**FLOOR PLAN SYMBOL LEGEND**

AD1	ROOM NAME	▲	EXTERIOR STOREFRONT WINDOW NUMBER, SEE SHEET A6.2
AXX	ROOM DESIGNATION	○	INTERIOR HOLLOW METAL WINDOW NUMBER, SEE SHEET A6.3
AXX	ELEVATION INDICATOR	Ⓝ	DOOR NUMBER, SEE DOOR AND SIGN SCHEDULE
AXX	SECTION CUT INDICATOR	▲	SIGN TYPE, SEE DOOR AND SIGN SCHEDULE
AXX	ENLARGED FLOOR PLAN	■	2" SLAB RECESS AT KITCHEN AND SERVING AREAS FOR QUARRY/PORCELAIN TILE
		■	6" SLAB RECESS AT COOLER/FREEZER COORD. WITH MANUFACTURER.
FE-1	FIRE EXTINGUISHER TYPE 1: ABC - DRY CHEMICAL SEMI-RECESSED CABINET SEE DETAIL		
FE-2	FIRE EXTINGUISHER TYPE 2: K - WET CHEMICAL SURFACE MOUNT		
FP-1	DRAWING NOTE REFERENCE SEE BELOW		

**FLOOR PLAN DRAWING NOTES**

FP 2. 1 HR. FIRE RATED EXTERIOR WALL ASSEMBLY EXTEND 4'-0" FROM ADJACENT 2 HR. WALL ASSEMBLY UNLESS NOTED OTHERWISE.

FP 3. 6" CMU WALL TO 12'-0" A.F.F. AND 6" 22 GA. METAL STUD WITH 5/8" GYP. BOARD ON GYM SIDE UP TO UNDERSIDE OF STRUCTURE.

FP 4. 48" HIGH CMU WALL W/ STAINLESS CAP. REF. FOOD SERVICE.

FP 5. SHEAR WALL: EXTEND WALL TO UNDERSIDE OF ROOF STRUCTURE (SEE STRUCTURAL DWGS)

**KEY PLAN**

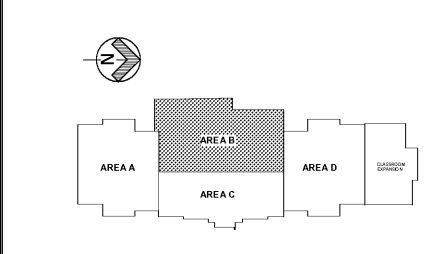

**ROBERTSON LOIA ROOF ARCHITECTS & ENGINEERS**  
 3460 Preston Ridge Road, Suite 275, Alpharetta, GA, 30005  
 770.674.2800 / www.rlra.com

STATE OF GEORGIA  
 PROFESSIONAL ARCHITECT  
 02/03/2020

Facility No. 765-0108

**CALHOUN EARLY LEARNING ACADEMY**  
 FOR Calhoun City Schools  
 Overall square footage: 81,706 s.f.  
 P.T.E. # 550

REVISIONS  
 01/20/2020 Health Dep Comments

**FLOOR PLAN - AREA B**

DATE: 01/15/2020  
 PROJECT NUMBER: 19-186  
 SHEET NUMBER: A1.3a

Order Plans @ WWW.LDILINE.COM

**AREA A**  
 SEE SHEETS A1.2a, A1.2b AND A1.2c

**AREA D**  
 SEE SHEETS A1.5a, A1.5b AND A1.5c