

Order Plans @

FLOOR PLAN - AREA A
1/8" = 1'-0"

SEE SHEETS A1.2a, A1.2b AND A1.2c

SEE SHEETS A1.3a, A1.3b AND A1.3c

AREA B

SEE SHEETS A1.4a, A1.4b AND A1.4c

AREA C

AREA A

2 HOUR FIRE WALL SEPARATION

FLOOR PLAN LEGEND

- GENERAL NOTES**
- A. SEE PLUMBING PLANS FOR IN-SLAB PLUMBING ROUGH-IN LOCATIONS.
 - B. SEE REFLECTED CEILING PLAN FOR SOFFIT DESIGN EXTENTS.
 - C. SEE EXTERIOR ELEVATIONS FOR ADDITIONAL STOREFRONT LOCATIONS.
 - D. ALL DOORS TO BE LOCATED 8" OFF ADJACENT WALL UNLESS DIMENSIONED OTHERWISE.
- INTERIOR PARTITION NOTES**
- FP-1. ALL WALLS SHOWN TO BE 8" CMU BLOCK INSTALLED TO A MINIMUM OF 7" ABOVE FINISHED CEILING (A MAXIMUM OF 8" ABOVE FINISHED CEILING), UNLESS NOTED OTHERWISE. REFER TO INTERIOR PARTITION WALL TYPE AND CONSTRUCTION LEGEND FOR ADDITIONAL WALL TYPES.
 - FP-2. REFER TO STRUCT DWGS FOR LOCATIONS & EXTENT OF REINFORCED CMU WALLS AND BRACING TO STRUCTURE.
 - FP-3. FOR 1 HOUR FIRE RATED WALLS WITH EXPOSED STRUCTURES ON ANY SIDE, START GYPSUM BOARD A MIN. OF 6" ABOVE HIGHEST ADJACENT CEILING, UNLESS NOTED OTHERWISE.
- FIRE AND SMOKE PARTITIONS**
- FP-4. PROVIDE A SMOKE TIGHT BARRIER AT ALL CORRIDORS, GANG TOILET ROOMS, JANITOR'S CLOSETS AND STORAGE/UTILITY ROOMS, UNLESS A HIGHER FIRE-SMOKE RATING IS DEFINED ON THESE DRAWINGS. SEE REFLECTED CEILING PLAN FOR ADDITION REQUIREMENTS FOR THESE AREA.

INTERIOR PARTITION SCHEDULE

NO.	DESCRIPTION
1	STANDARD PARTITION, 8" CMU (3a) UP TO 2' MIN ABOVE FINISHED CEILING
2	8" CMU PARTITION, 6" UP TO 2' MIN ABOVE FINISHED CEILING
3a/3b	8" CMU PARTITION, 8" CMU (3a) OR 12" CMU (3b) UP TO 8' ABOVE FINISHED CEILING
4a/4b	1 HOUR FIRE RATED PARTITION & SMOKE PARTITION, 8" CMU (4a) OR 12" CMU (4b) TO 8' ABOVE CEILING, 5/8" GYPSUM BOARD ON EA SIDE OF 6" 22 GA METAL STUDS @ 24" O.C. TO DECK, SEAL TIGHT TO DECK. SEE SCHEDULE NOTE #2 BELOW. UL DESIGN #9095 & #4065.
5	2 HOUR FIRE RATED PARTITION @ FIRE WALL, 8" CMU FLUSH TO ROOF DECK, UL DESIGN #9095
6	12" CMU PARTITION, 12" CMU UP TO 2' MIN ABOVE FINISHED CEILING
7	9 1/4" STUD PARTITION, 5/8" GYP BOARD (BOTH SIDES) ON 8" 22 GA METAL STUDS @ 24" O.C. TO 8' MIN ABOVE CEILING WITH SOUND BATT INSULATION. BRACE TO STRUCTURE AT 48" O.C. MAX.
8	4 7/8" STUD PARTITION, 5/8" GYP BOARD (BOTH SIDES) ON 3 5/8" 22 GA METAL STUDS @ 24" O.C. TO 8' MIN ABOVE CEILING WITH 3 1/2" SOUND BATT INSULATION. BRACE TO STRUCTURE AT 48" O.C. MAX.
9A	CMU PARTIAL HEIGHT WALL, 8" CMU (9A), OR 8" CMU (9B) UP TO HEIGHT AS INDICATED ON PLAN OR SECTION, USE INVERTED CMU BOARD BEAM ON TOP COURSE.
9B	8" CMU PARTIAL HEIGHT WALL, 8" CMU UP TO 2' MIN ABOVE FINISHED CEILING
10	SOUND AND SMOKE PARTITION, 8" CMU (10A) OR 12" CMU (10B) FLUSH TO ROOF DECK, SEAL TIGHT TO DECK, FILL ALL VOID CELLS WITH FOAM IN PLACE MASONRY INSULATION, SOUND SEAL ALL PENETRATIONS, UL DESIGN #9095
11A	8" BRICK VENEER, 4" BRICK VENEER UP TO 2' MIN ABOVE FINISHED CEILING
11B	8" CMU BLOCK, 8" CMU WALL EXTEND TO UNDERSIDE OF ROOF
12	FURRING, 5/8" GYP BOARD ON 1 1/2" METAL FURRING AT 24" O.C.

- SCHEDULE NOTES:**
- 1. PARTITION TYPES NOT SHOWN ALONG INTERIOR DOOR AND WINDOW HEADERS FOR CLARITY WHERE APPLICABLE, PARTITION TYPE DEFINED ADJACENT TO HEADERS SHALL CONTINUE OVER SUCH HEADERS UNLESS NOTED OTHERWISE.
 - 2. FOR 1 HOUR FIRE RATED WALLS WITH EXPOSED STRUCTURES ON ANY SIDE, START GYPSUM BOARD A MIN. OF 6" ABOVE HIGHEST ADJACENT CEILING, UNLESS NOTED OTHERWISE.
 - 3. WALLS NOT TAGGED WILL BE SAME TYPE AS ADJACENT WALLS UNLESS NOTED OTHERWISE.

FLOOR PLAN SYMBOL LEGEND

	SUITE DESIGNATION		EXTERIOR STOREFRONT WINDOW NUMBER, SEE SHEET A6.2
	ROOM NAME		INTERIOR HOLLOW METAL WINDOW NUMBER, SEE SHEET A6.3
	ROOM DESIGNATION		DOOR NUMBER, SEE DOOR AND SIGN SCHEDULE
	ELEVATION INDICATOR		SIGN TYPE, SEE DOOR AND SIGN SCHEDULE
	SECTION CUT INDICATOR		SLAB RECESS, AT KITCHEN AND SERVING AREAS FOR QUARRY/PORCELAIN TILE
	ENLARGED FLOOR PLAN		SLAB RECESS, AT COOLER/FREEZER COORD WITH MANUFACTURER.
	DRAWING NOTE REFERENCE SEE BELOW		FIRE EXTINGUISHER TYPE 1: ABC - DRY CHEMICAL SEMI-RECESSED CABINET SEE DETAIL
			FIRE EXTINGUISHER TYPE 2: K - WET CHEMICAL SURFACE MOUNT

FLOOR PLAN DRAWING NOTES

- FP 2. 1 HR. FIRE RATED EXTERIOR WALL ASSEMBLY EXTEND 4'-0" FROM ADJACENT 2 HR. WALL ASSEMBLY UNLESS NOTED OTHERWISE.
- FP 3. 8" CMU WALL TO 12'-0" A.F.F. AND 6" 22 GA. METAL STUD WITH 5/8" GYP. BOARD ON GYM SIDE UP TO UNDERSIDE OF STRUCTURE.
- FP 4. 48" HIGH CMU WALL W/ STAINLESS CAP. REF. FOOD SERVICE.
- FP 5. SHEAR WALL: EXTEND WALL TO UNDERSIDE OF ROOF STRUCTURE (SEE STRUCTURAL DWGS).

KEY PLAN

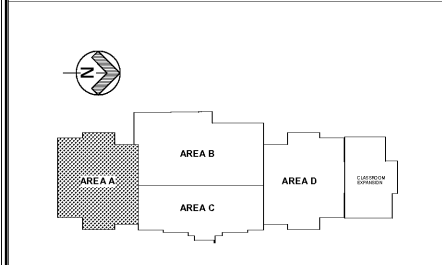

ROBERTSON LOIA ROOF ARCHITECTS & ENGINEERS
3460 Preston Ridge Road, Suite 275, Alpharetta, GA, 30005
770.674.2600 / www.rlprc.com



Facility No. 765-0108

CALHOUN EARLY LEARNING ACADEMY
FOR Calhoun City Schools
Overall square footage: 81,706 s.f.
10/18/21

NO.	REVISIONS

FLOOR PLAN-AREA A
DATE: 01/15/2020
PROJECT NUMBER: 19-186
SHEET NUMBER: A1.2a