

IRRIGATION NOTES

1. THE IRRIGATION CONTRACTOR IS RESPONSIBLE FOR OBTAINING A COPY OF THE PROJECT SPECIFICATIONS PRIOR TO BIDDING. THE PROJECT SPECIFICATIONS ARE A PART OF THESE PLANS AND SHALL BE CONSULTED BY THE IRRIGATION CONTRACTOR. THE CONTRACTOR IS RESPONSIBLE FOR IMPLEMENTING WORK AS SPECIFIED IN THE PROJECT SPECIFICATIONS AND ON THE PLANS.
2. THE CONTRACTOR SHALL BE RESPONSIBLE FOR ALL MATERIALS AND LABOR TO FULLY EXECUTE, GUARANTEE, AND MAINTAIN THE SYSTEM AS REQUIRED. THE TOTAL WORK SHOWN ON THIS PLAN SHALL BE DONE IN ACCORDANCE WITH SPECIFICATIONS, AND ALSO AS PER INSTRUCTIONS OF THE CONTRACTING OFFICER.
3. CONTRACTOR SHALL VERIFY ALL DIMENSIONS, ELEVATIONS, EQUIPMENT QUANTITIES, AND UTILITY LOCATIONS PRIOR TO BEGINNING WORK.
4. CONTRACTOR SHALL NOTIFY LANDSCAPE ARCHITECT OF ANY DISCREPANCIES IN PLANS OR SPECIFICATIONS PRIOR TO BEGINNING OR CONTINUING WORK.
5. ALL CONSTRUCTION SHALL CONFORM TO CITY, COUNTY, STATE, AND FEDERAL REQUIREMENTS. IT SHALL BE THE RESPONSIBILITY OF THE IRRIGATION CONTRACTOR TO ENSURE THAT ALL IRRIGATION EQUIPMENT MEETS GOVERNMENT REGULATIONS. CONTRACTOR SHALL ALSO BE RESPONSIBLE FOR OBTAINING ANY NECESSARY PERMITS OR APPROVALS.
6. PRIOR TO CONSTRUCTION, THE CONTRACTOR SHALL BE RESPONSIBLE FOR VERIFYING AND LOCATING ALL UNDERGROUND UTILITIES AND SHALL AVOID DAMAGE TO ALL UTILITIES DURING THE COURSE OF THE WORK. THE CONTRACTOR IS RESPONSIBLE FOR REPAIRING ANY AND ALL DAMAGE TO UTILITIES, STRUCTURES, SITE APPURTENANCES, ETC. WHICH OCCURS AS A RESULT OF THE IRRIGATION CONSTRUCTION TO OWNER'S SATISFACTION, AT NO ADDITIONAL COST.
7. NO PART OF THE IRRIGATION SYSTEM SHALL BE INSTALLED IN CONFLICT WITH UTILITIES. THE CONTRACTOR SHALL MAKE ANY NECESSARY ADJUSTMENTS IN THE PROPOSED IRRIGATION SYSTEM TO AVOID CONFLICTS WITH EXISTING STRUCTURES, PAVING, AND UTILITIES.
8. ALL CALCULATIONS INDICATED ON THIS SHEET ARE SAMPLE CALCULATIONS AND SHOULD NOT BE CONSTRUED AS ACCURATE.
9. 88.2 PSI STATIC WATER PRESSURE IS REQUIRED FOR THE EFFICIENT OPERATION OF THE IRRIGATION SYSTEM AS DESIGNED. VERIFY 88.0 PSI STATIC WATER PRESSURE IS AVAILABLE AT THE PROJECT SITE PRIOR TO BEGINNING THE IRRIGATION INSTALLATION. NOTIFY THE LANDSCAPE ARCHITECT IF THE MINIMUM WATER PRESSURE IS NOT AVAILABLE.
10. IRRIGATION CONTRACTOR TO VERIFY ACTUAL AVAILABLE WATER PRESSURE BEFORE BEGINNING INSTALLATION. CONTRACTOR SHALL NOTIFY LANDSCAPE ARCHITECT IF AVAILABLE WATER PRESSURE EXCEEDS 5 PSI HIGHER OR LOWER THAN MINIMUM REQUIRED WATER PRESSURE.
11. IF STATIC WATER PRESSURES ARE NOT ADEQUATE TO OPERATE IRRIGATION SYSTEM, A PUMP SYSTEM IS TO BE DESIGNED BY AN IRRIGATION SYSTEM DESIGNER. IRRIGATION PUMP INSTALLATION MUST BE COORDINATED WITH THE ELECTRICAL CONTRACTOR. PUMP MUST BE INSTALLED WITHIN A TAMPER PROOF ENCLOSURE.
12. IF STATIC WATER PRESSURES EXCEEDS 75 PSI, PRESSURE COMPENSATING HEADS MUST BE USED.
13. IRRIGATION SYSTEMS CONNECTED TO POTABLE WATER SUPPLY SHALL HAVE A WAFFS, FEBCO, OR WILKINS REDUCED PRESSURE BACKFLOW PREVENTER (ASSE# 1013) INSTALLED, OR AS REQUIRED BY LOCAL CODES.
14. ELECTRICAL SERVICE TO ALL EQUIPMENT SHALL BE PROVIDED TO A JUNCTION BOX AT THE EQUIPMENT LOCATION.
15. THE LOCATION OF THE AUTOMATIC CONTROL CLOCK IS GENERALLY INDICATED ON THE DRAWING AND WILL BE SPECIFICALLY LOCATED ON-SITE BY THE CONTRACTING OFFICER. THE IRRIGATION CONTRACTOR SHALL BE RESPONSIBLE FOR ALL ELECTRICAL CONNECTIONS FROM CONTROL VALVES TO THE CONTROL CLOCK.
16. EACH CONTROL CLOCK HAS STATIONS THAT ARE NOT BEING UTILIZED. THERE IS TO BE A FIELD WIRE INSTALLED TO THE FURTHEST CONTROL VALVE IN ANY ONE DIRECTION FROM THE CONTROL CLOCK FOR EVERY VACANT STATION PLUS ONE SPARE WIRE IS TO BE INSTALLED IN CASE OF A FAULTY WIRE.
17. VALVE WIRE SHALL BE #14 GAUGE UL-LIF SINGLE STRAND DIRECT BURIAL COPPER RUN IN A BURIED CONDUIT. ALL SPICES WITH MANUFACTURER'S FRAGILE KIT CONSISTING OF INSULATING, SPRING-TYPE CONNECTOR OR CRAMPED JOINT AND EPOXY RESIN MOISTURE SEAL; SUITABLE FOR DIRECT BURIAL. COIL WIRE EVERY 100' FOR EXPANSION AND CONTRACTION PURPOSES.
18. IT IS THE RESPONSIBILITY OF THE IRRIGATION CONTRACTOR TO HAVE ALL PLANTING AREAS FLAGGED BY THE LANDSCAPE CONTRACTOR PRIOR TO INSTALLATION. REFER TO THE PLANTING PLANS WHEN TRENCHING TO AVOID TREES AND SHRUBS.
19. EXISTING TREES TO REMAIN ARE TO BE PROTECTED FROM DAMAGE. DO NOT TRENCH OR EXCAVATE WITHIN THE CRITICAL ROOT ZONE OF ANY TREE.
20. THE CONTRACTOR SHALL PROTECT ALL EXISTING LANDSCAPE IMPROVEMENTS DURING THE EXECUTION OF THIS WORK. NO SOIL SHALL BE PLACED DIRECTLY UPON EXISTING LANDSCAPING. ANY MATERIALS WHICH, IN THE OPINION OF THE LANDSCAPE ARCHITECT, ARE DAMAGED DURING THE EXECUTION OF THIS WORK SHALL BE IMMEDIATELY REPLACED BY THE IRRIGATION CONTRACTOR AT HIS EXPENSE.
21. LINE LOCATIONS AS INDICATED ON THE PLAN ARE SCHEMATIC. THE CONTRACTOR SHALL LOCATE ALL LINES IN SUCH A WAY AS TO CAUSE THE LEAST CONFLICT WITH THE LOCATION OF OTHER SITE AMENITIES. LINES MAY BE SHOWN OFFSET IN SOME HARDSCAPE AREAS AND OUTSIDE OF PROPERTY LINES FOR GRAPHIC CLARITY ONLY. ADJUST HEADS AND LINE LOCATIONS ON SITE TO ACCOMMODATE EXISTING AND ACHIEVE COMPLETE COVERAGE. PIPE LINES DRAWN SIDE BY SIDE MAY BE LAD IN THE SAME TRENCH, BUT THEY MUST MAINTAIN A MINIMUM OF 3" HORIZONTAL AND VERTICAL CLEARANCE FROM ALL OTHER PIPES.
22. ALL HEADS, VALVES, AND ACCESSORIES SHALL BE NELSON, HUNTER, RAIN BIRD, OR APPROVED EQUAL.
23. ALL CONTROL VALVES, GATE VALVES, AND QUICK COUPLERS SHALL BE INSTALLED IN LOCKING VALVE BOXES.
24. ALL VALVE BOXES ARE TO BE LOCATED IN PLANT BED OR NATURAL AREAS WHENEVER POSSIBLE.
25. ALL MAIN LINES AND SLEEVES SHALL BE SCHEDULE 40 PVC. ALL LATERAL LINES SHALL BE 125 PSI, STANDARD INSIDE DIMENSION RATIO (SIDR) 11.5 POLYETHYLENE PIPE.
26. POLYETHYLENE (PE) PIPE SHALL BE CONNECTED WITH BARBED FITTINGS AND CLAMPED WITH STAINLESS STEEL CLAMPS. THE CLAMP SHOULD BE PLACED OVER THE BARBED PORTION. FOR PIPES 1-1/2" AND LARGER, TWO STAINLESS STEEL CLAMPS PER BARB SHALL BE USED.
27. ALL MAIN LINES SHALL BE INSTALLED A MAXIMUM OF 2" FROM THE BACK OF CURB WHERE POSSIBLE. LATERAL LINES SHALL BE INSTALLED LIKEWISE WHERE POSSIBLE.
28. ALL LINES LOCATED BENEATH WALKS, CURBS, OR CONCRETE PAVING SHALL BE LOCATED WITHIN SLEEVES. ALL IRRIGATION SLEEVING TO BE THE RESPONSIBILITY OF THE CONTRACTOR. ALL UNDER PAVING SLEEVING IS TO BE ACCESSIBLE AND FREE OF OBSTRUCTION. SLEEVE SIZES ARE TO BE ACCORDING TO THE ATTACHED SLEEVE SCHEDULE. ELECTRICAL WIRES FOR IRRIGATION VALVES AND IRRIGATION LINES ARE TO BE PLACED IN SEPARATE SLEEVES. SEE SLEEVING DETAIL.
29. UNSIZED PIPE BETWEEN TWO (2) GIVEN SIZES IS ASSUMED TO BE THE LARGER SIZE.
30. ALL SPRINKLER HEADS SHALL BE SET PERPENDICULAR AND WITHIN 1/2" OF FINISHED GRADES. ALL SPRINKLER HEADS SHALL BE INSTALLED A MINIMUM OF EIGHTEEN INCHES FROM THE BACK OF CURBS AND A MINIMUM OF TWO INCHES FROM SIDEWALKS.
31. ALL IRRIGATION HEADS AT THE LOWER ELEVATIONS OF EACH CONTROL VALVE ZONE SHALL HAVE POP-UP BODIES WITH BUILT-IN CHECK VALVES TO PREVENT LOW HEAD DRAINAGE.
32. EACH CONTROL VALVE ZONE SHALL HAVE AN AUTOMATIC DRAIN VALVE AND A 12" x 24" GRAVEL SUMP INSTALLED AT THE LOWEST POINT WITHIN THE ZONE.
33. ALL RISERS SHALL BE INSTALLED 18" FROM ANY WALL AND A MINIMUM OF 12" FROM ANY SIDEWALK OR ROAD AND SHALL HAVE 2 COATS OF SEMI-FLAT BLACK ENAMEL PAINT.
34. THE CONTRACTOR SHALL ADJUST THE RADIUS AND ARC OF EACH HEAD TO PROVIDE 100% COVERAGE OF ALL PLANTED OR GRASSSED ISLANDS, TO MINIMIZE "OVERTHROW", AND TO ELIMINATE DRY SPOTS.
35. THE CONTRACTOR SHALL BE RESPONSIBLE FOR THE SUPPLY AND INSTALLATION OF ADDITIONAL HEADS TO COVER "DRY SPOTS" OR SLIGHT VARIATIONS FROM THE PLAN TO THE SITE. THE IRRIGATION CONTRACTOR SHALL CONTACT THE LANDSCAPE ARCHITECT PRIOR TO MAKING ANY SUBSTITUTIONS, DELETIONS, OR ADDITIONS TO THIS PLAN FOR APPROVAL.
36. THROTTLE ALL IRRIGATION CONTROL VALVES AS REQUIRED TO PREVENT FOGGING.
37. FINAL ADJUSTMENTS TO IRRIGATION SYSTEM & SPRAY PATTERNS ARE TO BE MADE PRIOR TO FINAL INSPECTION.
38. ALL BACKFILLED TRENCHES SHALL BE THOROUGHLY COMPACTED. SEE SPECIFICATIONS FOR BACKFILL MATERIAL AND COMPACTION REQUIREMENTS.
39. THE CONTRACTOR SHALL SET THE IRRIGATION CONTROL SYSTEM TO OPERATE BETWEEN THE HOURS OF 2:00 am AND 6:00 am OR AS DIRECTED BY STORE MANAGER.
40. IRRIGATION CONTRACTOR SHALL OPTIMIZE WATER USAGE AND WATER CONSERVATION TIME ALLOTTED FOR INDIVIDUAL ZONE OPERATION SHALL ALLOW FOR WATER PENETRATION TO A MINIMUM DEPTH OF 8" IN SHRUB BEDS AND 6" IN TURF AREAS.
41. IRRIGATION CONTRACTOR SHALL REVIEW WINTERIZATION PROCEDURES FOR IRRIGATION SYSTEM WITH THE OWNER'S REPRESENTATIVE.
42. THE CONTRACTOR SHALL BE RESPONSIBLE AT TIME OF COMPLETION FOR PROVIDING "AS BUILT" DRAWINGS TO INCLUDE THE EXACT LOCATION OF ALL CONTROL VALVES (AUTOMATIC AND MANUAL), QUICK COUPLER VALVES, BACKFLOW DEVICES, AND CONTROLLER, WITH TRIANGULATED MEASUREMENTS TO EACH, AS WELL AS ANY DEVIATIONS IN LOCATION OF PIPING AND HEADS REPRESENTED AS REPRESENTED BY THE CONTRACT DOCUMENTS.
43. ALL WORK, ADJUSTMENTS, AND INSPECTIONS SHALL BE SUBJECT TO THE APPROVAL OF THE LANDSCAPE ARCHITECT.
44. REFER TO SITWORK SPECIFICATIONS FOR ADDITIONAL INFORMATION NEEDED FOR IMPLEMENTATION OF IRRIGATION PLANS.

IRRIGATION NOTES

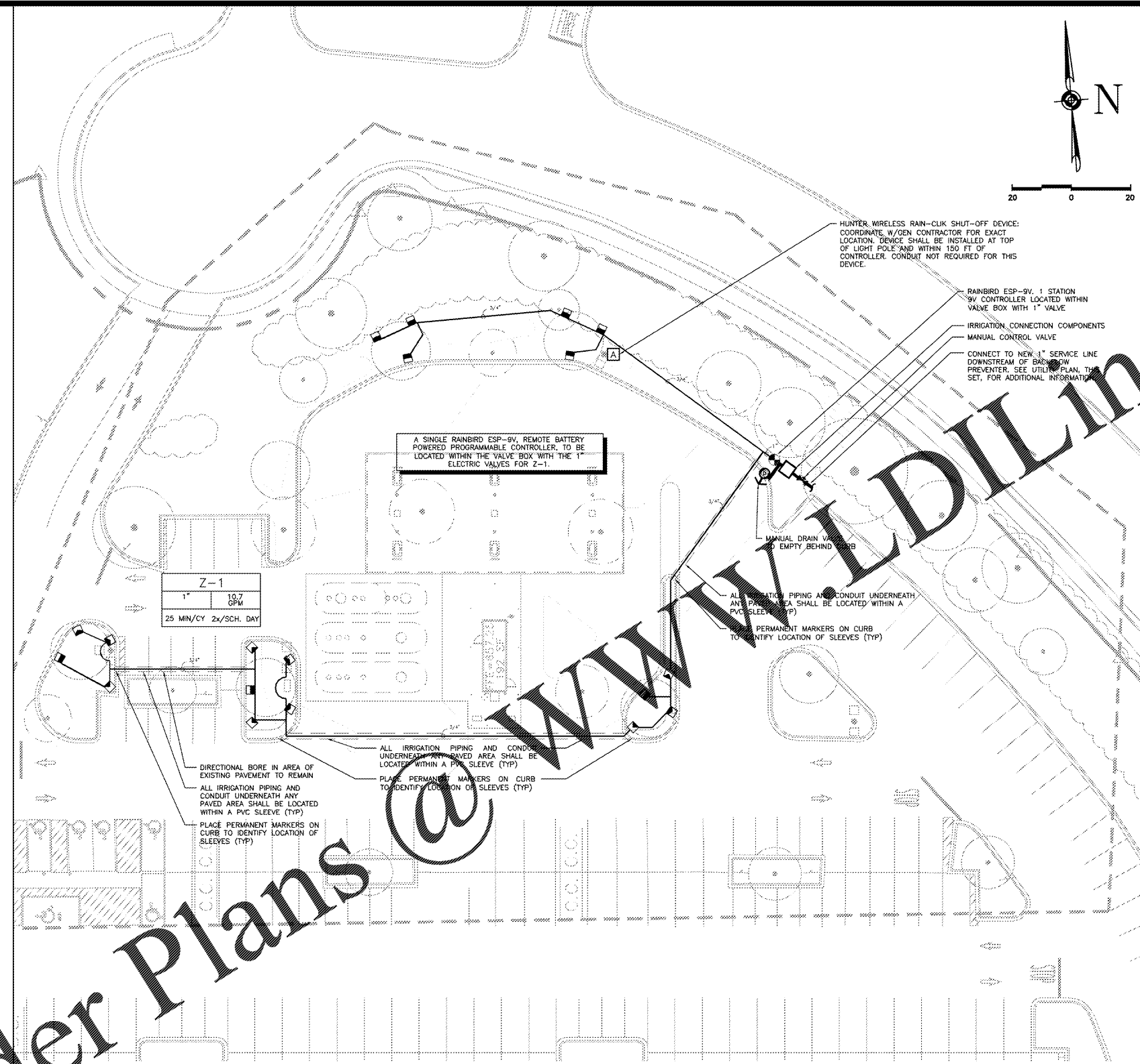

Z-1	
1"	10.7 GPM
25 MIN/CY 2x/SCH. DAY	

STATIC WATER PRESSURE FROM CITY .222 PSI + BOOSTER PUMP .222 PSI TOTAL AVAILABLE WATER PRESSURE FOR IRRIGATION .222 PSI PRESSURE DEMAND ON SYSTEM .58.4 PSI	ALL IRRIGATION HEADS SHALL BE LOCATED SO THAT OTHER SITE FEATURES DO NOT OBSTRUCT SPRAY OF IRRIGATION HEADS.
MAINLINE FOR IRRIGATION SYSTEM SHALL BE BEDDED WITHIN TRENCH AS PER WATERLINE SPECIFICATIONS. LATERAL LINES MAY BE AND SHALL BE BACKFILLED AS PER SPECIFICATIONS IN A COMMON TRENCH WITH THE MAIN LINE PROVIDED MINIMUM SEPARATION IS PROVIDED	GENERAL CONTRACTOR SHALL ENSURE THAT SLEEVES INSTALLED ARE LARGE ENOUGH TO ACCOMMODATE ALL NECESSARY PIPING, AS PER SPECIFICATIONS.
MAINLINE FOR IRRIGATION SYSTEM SHALL NOT ENCRUST UPON R.O.W. OR OTHER LOTS. ALL COMPONENTS OF THE IRRIGATION SYSTEM SHALL REMAIN ON CVS PROPERTY.	PERMANENT MARKERS SHALL BE PLACED ON CURBS TO IDENTIFY LOCATIONS OF ALL IRRIGATION SLEEVES.
	CONTRACTOR SHALL CONTACT 811 FOR LOCATION OF ALL UTILITIES AT LEAST 72 HOURS PRIOR TO BEGINNING CONSTRUCTION

CONTROLLER (RAINBIRD ESP-9V CONTROLLER)			
PROGRAMMING SCHEDULE			
IRRIGATION INTERVAL	EVERY OTHER DAY		
# OF START TIMES/SCHEDULED DAY	2		
SCHEDULED START TIMES FOR PROGRAM	12:00 AM 1:00 AM		
ZONE	ZONE DESCRIPTION	RUN TIME	TOTAL RUN TIME/SCHEDULED DAY
Z-1	NEW TREES	25 MIN/CYCLE	50 MIN
RUN TIME TOTALS		25 MIN PER CYCLE	50 MIN PER SCHEDULED DAY
CONTROLLER PROGRAMMING SCHEDULE IS BASED UPON THE BEST KNOWLEDGE OF THE ANTICIPATED POST CONSTRUCTION SITE CONDITIONS. THE CONTRACTOR IS RESPONSIBLE FOR MONITORING SITE CONDITIONS AND ADJUSTING IRRIGATION WATERING SCHEDULE AS NECESSARY TO MAINTAIN PLANT HEALTH.			
PLANT WATER REQUIREMENTS			
TREES	Etc = 0.14"/DAY	0.98"/WEEK	
SHRUB PLANTER	Etc = 0.14"/DAY	0.98"/WEEK	
TURFGRASS	Etc = 0.20"/DAY	1.40"/WEEK	

IRRIGATION LEGEND

CONTRACTOR PROVIDED COMPONENTS	
C	1-STATION IRRIGATION CONTROLLER, LOCATED IN VALVE BOX RAINBIRD ESP-9V
A	WIRELESS RAIN/FREEZE SENSOR - HUNTER MINI-CLIK
IRRIGATION CONNECTION COMPONENTS	
W	IRRIGATION WATER TAP AND CITY WATER METER ON POTABLE WATER UTILITY LINE WITH BACKFLOW PREVENTER. PROVIDED BY CONTRACTOR. COORDINATE SOURCE LOCATION WITH GENERAL CONTRACTOR. SEE UTILITY PLAN FOR SIZE.
X	REDUCED PRESSURE BACKFLOW DEVICE (LINE SIZE), PER LOCAL CODES. PROVIDE GREEN FIBERGLASS INSULATED ENCLOSURE, VERIFY EXACT LOCATION IN FIELD. FEBCO 8257, OR EQUAL
Y	ISOLATION VALVE (LINE SIZE) MOUNT IN 15" VALVE BOX WITH EXTENSIONS. BRONZE THREADED ON ONE WITH STEEL HANDLE.
Z	BRONZE QUICK COUPLER VALVE (LINE SIZE), MOUNT ON SPEARS PVC OR RAINBIRD SYSTEM. PROVIDE ONE (SIZE APPROPRIATE) OC KEY PER FOUR QUICK COUPLER VALVES. RAINBIRD 4 RC.
D	MANUAL DRAIN VALVE: MAIN LINE SIZE
E	ELECTRIC IRRIGATION VALVE. PLASTIC BODY WITH FLOW CONTROL MOUNTED IN 15" STANDARD PLASTIC VALVE BOX. SIZE INDICATED ON RAINBIRD PEB SERIES. "X" IS ZONE DESIGNATION. FOR USE IN ZONES.
F	UNDERGROUND FEEDER WIRE NO. 14 AWG DIRECT BURIAL RUN IN CONDUIT.
G	PVC SLEEVE SCHEDULE 40 PVC UNDER ALL PAVED SURFACES. SEE SCHEDULE FOR SIZE. PLACE PERMANENT MARKERS ON CURB TO IDENTIFY LOCATION.
H	PVC MAINLINE PIPE SCHEDULE 40, PVC PIPE 2.5" AND SMALLER-SOLVENT WELD PIPE AND PVC SOLVENT WELD FITTINGS. PVC SLEEVES SHALL BE REQUIRED UNDER SIDEWALKS, CURBS, OR ANY PAVED SURFACES. REFER TO SPECIFICATIONS FOR SIZES OF SLEEVES.
I	PVC LATERAL PIPE, CLASS 200, SOLVENT WELD, PVC PIPE FOR PIPE OF 5 FEET PER SECOND OR LESS. SIZE LATERAL PIPE AS SHOWN AT VELOCITIES OF 5 FEET PER SECOND OR LESS. PVC SLEEVES SHALL BE REQUIRED UNDER SIDEWALKS, CURBS, OR ANY PAVED SURFACES. REFER TO SPECIFICATIONS FOR SIZES OF SLEEVES.
J	PVC LATERAL PIPE, CLASS 315, SOLVENT WELD, PVC PIPE FOR PIPE 1" IN DIAMETER OR LESS. SIZE LATERAL PIPE AS SHOWN AT VELOCITIES OF 5 FEET PER SECOND OR LESS. PVC SLEEVES SHALL BE REQUIRED UNDER SIDEWALKS, CURBS, OR ANY PAVED SURFACES. REFER TO SPECIFICATIONS FOR SIZES OF SLEEVES.
K	RAINBIRD 1/2" POLYETHYLENE TUBING TO BE EITHER: • PRESSURE COMPENSATING INLINE EMITTER TUBING WITH 0.9 GAL/HOUR EMISSIONS AT 1.0 BAR (1.45 G.P.G.) OR • XBS 1/2" BLANK TUBING, AS LABELED ON PLANS.
L	PIPE SIZE - UNLABELED PIPE BETWEEN 2 SIZES SHALL BE THE LARGER SIZE.
M	PIPE JOINT
N	PIPES CROSS, DO NOT INTERSECT
O	CONTROLLER STATION NUMBER GALLONS PER MINUTE SIZE OF VALVE FREQUENCY AND DURATION OF ZONE RUN TIME
P	1. THE POINT OF CONNECTION IS A WATERLINE STUBBED AT THE NORTHEAST CORNER OF THE SITE. SERVICE COMES FROM METER AND BACKFLOW PREVENTER. 2. REFER TO UTILITY PLAN, THIS SET, FOR ADDITIONAL INFORMATION.

MP ROTATOR INFORMATION

SYM	MANUFAC.	HEAD	NOZZLE	PSI	GPM	ARC	RADIUS
■	HUNTER	PR540	MP1000-90°	35	0.18	90°	13'
■	HUNTER	PR540	MP1000-180°	35	0.35	180°	13'
■	HUNTER	PR540	MP1000-210°	35	0.41	210°	13'
■	HUNTER	PR540	MP1000-270°	35	0.54	270°	13'
■	HUNTER	PR540	MP1000-360°	35	0.71	360°	13'

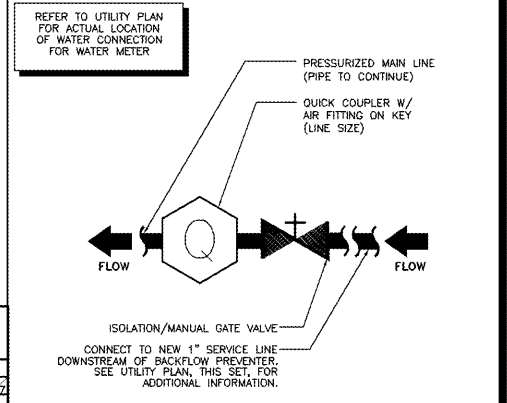

IRRIGATION CONNECTION DETAIL



REVISIONS	BY

CARLSON CONSULTING ENGINEERS, INC.
 7088 LEDGESTONE COMMONS
 BARTLETT, TENNESSEE 38133
 PH. (901) 384-0404 • FX. (901) 384-0710
 NORTH CAROLINA CORPORATION # C-3504

SAM'S CLUB #6540-209
 CHARLOTTE, NORTH CAROLINA
 SAM'S REAL ESTATE BUSINESS TRUST
 2101 SE SIMPLE SAVINGS DRIVE
 BENTONVILLE, AR 72716

DRAWN	TGH
CHECKED	BKM
DATE	12/17/2019
SCALE	1"=20'
JOB No.	6540-209
SHEET	15 OF 21

IRRIGATION PLAN