

| REVISIONS | BY |
|-----------|----|
| | |
| | |
| | |
| | |
| | |
| | |
| | |
| | |
| | |

CARLSON CONSULTING ENGINEERS, INC.
 7088 LEDGESTONE COMMONS
 BARTLETT, TENNESSEE 38133
 PH. (901) 384-0404 • FX. (901) 384-0710
 NORTH CAROLINA CORPORATION# C-3504



SAM'S CLUB #6540-209
 CHARLOTTE, NORTH CAROLINA
 SAM'S REAL ESTATE BUSINESS TRUST
 2101 SE SIMPLE SAVINGS DRIVE
 BENTONVILLE, AR 72716



| | |
|---------|------------|
| DRAWN | TGH |
| CHECKED | BKM |
| DATE | 12/17/2019 |
| SCALE | 1"=20' |
| JOB No. | 6540-209 |
| SHEET | 13 OF 21 |

CONTRACTOR IS RESPONSIBLE FOR PROVIDING A WARRANTY ON ALL MATERIAL AND WORKMANSHIP FOR A PERIOD OF ONE YEAR FROM FINAL ACCEPTANCE.

ALL UNSURFACED AREAS SHALL RECEIVE A 4" LAYER OF SUITABLE TOPSOIL AND HYDRO-SEED AND/OR SOD (WHERE SHOWN). WATER UNTIL A HEALTHY STAND OF GRASS IS OBTAINED.

ALL LANDSCAPE AREAS SHALL BE FULLY IRRIGATED. SEE IRRIGATION PLAN, THIS SET, FOR ADDITIONAL INFORMATION.

SOD SHALL BE PEGGED ON ALL SLOPES IN ORDER TO HOLD SOD IN PLACE. SEE SITEWORK SPECIFICATIONS FOR OTHER REQUIREMENTS.

UNLESS SHOWN OTHERWISE, ALL LARGE CANOPY TREES SHALL MAINTAIN HORIZONTAL CLEARANCE FROM ALL OVERHEAD UTILITY LINES AND 10' HORIZONTAL CLEARANCE FROM ALL UNDERGROUND UTILITY LINES.

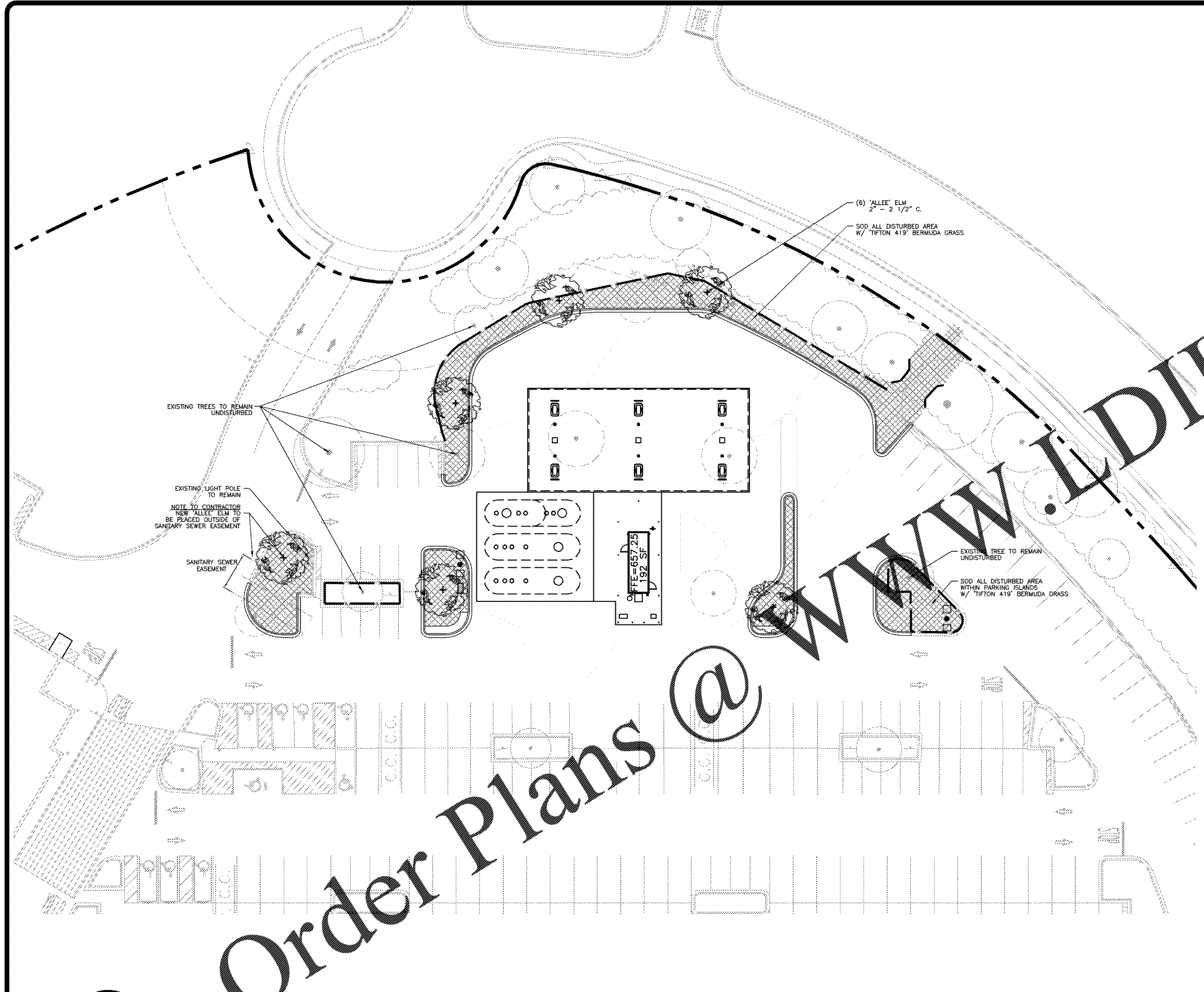

Order Plans @

| PLANT SCHEDULE | | NOTE: ALL SIZES AND CONDITION OF NURSERY STOCK SHALL MEET THE STANDARDS ESTABLISHED IN THE LATEST EDITION OF "AMERICAN STANDARD FOR NURSERY STOCK" PUBLISHED BY THE AMERICAN ASSOCIATION OF NURSEYMEN. | | | | | |
|---|-----|--|--------------------------|--|----------|-----------|---------------------------------------|
| QTY | SYM | BOTANICAL NAME | COMMON NAME | SIZE (BOTH MIN'S TO BE MET) | SPACING | CONDITION | REMARKS |
| TREES: | | | | | | | |
| 6 | | ULMUS PARVIFOLIA 'EMER II' | 'ALLEE' CHINESE ELM | 2" - 2-1/2" C. / 8' - 10' HT | AS SHOWN | B&B/CONT | FULL HEAD w/UNIF. GROWTH, 5' CLR. HT. |
| GROUNDCOVERS: | | | | | | | |
| | | CYNODON DACTYLON 'TIFTON 419' | 'TIFTON 419' BERMUDA SOD | SLAB / ROLL | SOLID | SOD | WEED FREE & ACTIVELY GROWING |
| NOTE: SYMBOLS SHOWN IN TABLE ABOVE ARE FOR SPECIES IDENTIFICATION ONLY. PLANT SIZE SHOWN IN THE TABLE IS NOT INTENDED TO BE REPRESENTATIVE OF THE PLANT AT EITHER INSTALLATION OR MATURITY. SIZE OF SYMBOL SHOWN IN TABLE ABOVE MAY VARY FROM THOSE SHOWN ON PLANS. | | | | NOTE: NO SUBSTITUTIONS OF PLANT MATERIALS ARE ALLOWED WITHOUT THE PRIOR APPROVAL OF THE LANDSCAPE ARCHITECT. | | | |



TREE INVENTORY PREPARED BY:
 CHARLES R. WALKER
 ISA CERTIFIED ARBORIST
 SO-6611A
 EXPIRATION DATE: DEC. 31, 2020

PLANTING PLAN