

REVISIONS	BY

**CARLSON CONSULTING ENGINEERS, INC.**  
 7088 LEDGESTONE COMMONS  
 BARTLETT, TENNESSEE 38133  
 PH. (901) 384-0404 • FX. (901) 384-0710  
 NORTH CAROLINA CORPORATION # C-3504



SAM'S CLUB #6540-209  
 CHARLOTTE, NORTH CAROLINA  
 SAM'S REAL ESTATE BUSINESS TRUST  
 2101 SE SIMPLE SAVINGS DRIVE  
 BENTONVILLE, AR 72716



DRAWN	TGH
CHECKED	BKM
DATE	12/17/2019
SCALE	1"=20'
JOB No.	6540-209
SHEET	11 OF 21

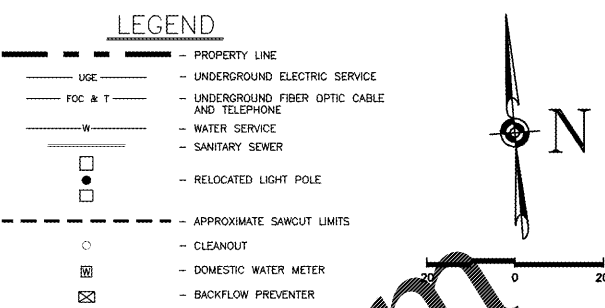

- NOTES:**
- ALL UTILITIES SHALL BE INSTALLED IN A TRENCH CONDITION IN ACCORDANCE WITH THE UTILITY TRENCHING DETAIL, THIS SET.
  - CONTRACTOR SHALL NOTIFY THE UTILITY AUTHORITIES INSPECTORS A MINIMUM OF 72 HOURS BEFORE CONNECTING TO ANY EXISTING LINE. CONSTRUCTION SHALL NOT START ON ANY PUBLIC UTILITY SYSTEM UNTIL WRITTEN APPROVAL HAS BEEN RECEIVED FROM APPROPRIATE UTILITY COMPANIES AND CONTRACTOR HAS BEEN NOTICED.
  - UTILITY SEWER MATERIAL SHALL BE IN CONFORMANCE WITH THE PROJECT SPECIFICATIONS.
  - WATER LINE MATERIAL SHALL BE IN CONFORMANCE WITH THE PROJECT SPECIFICATIONS. MINIMUM TRENCH WIDTH SHALL BE 2 FEET.
  - ALL UTILITIES SHALL BE KEPT TEN (10') APART (PARALLEL) OR, WHEN CROSSING, 18" VERTICAL CLEARANCE (OUTSIDE EDGE OF PIPE TO OUTSIDE EDGE OF PIPE).
  - CONTRACTOR SHALL MAINTAIN MINIMUM BURIAL DEPTHS AS REQUIRED BY THE UTILITY PROVIDER AND THE PROJECT SPECIFICATIONS.
  - IN THE EVENT OF A VERTICAL CONFLICT BETWEEN WATER LINES, SANITARY LINES, STORM LINES AND GAS LINES (EXISTING AND PROPOSED), THE SANITARY LINE SHALL BE DUCTILE IRON PIPE WITH MECHANICAL JOINTS AT LEAST 10 FEET ON BOTH SIDES OF CROSSING. THE WATER LINE SHALL HAVE MECHANICAL JOINTS WITH APPROPRIATE THRUST BLOCKING AS REQUIRED TO PROVIDE A MINIMUM OF 18" CLEARANCE. MEETING REQUIREMENTS OF ANSI A21.10 OR ANSI 21.11 (AWWA C-151) (CLASS 50).
  - LINES UNDERGROUND SHALL BE INSTALLED, INSPECTED AND APPROVED BEFORE BACKFILLING.
  - TOPS OF EXISTING MANHOLES SHALL BE ADJUSTED AS NECESSARY TO BE FLUSH WITH FINAL GRADE.
  - THE GENERAL CONTRACTOR SHALL COORDINATE PROJECT PHASING AND STORAGE OF MATERIALS WITH THE FUELING STATION CONSTRUCTION MANAGER.
  - EXISTING UTILITIES SHALL BE VERIFIED IN FIELD PRIOR TO INSTALLATION OF ANY NEW LINES.
  - REFER TO ARCHITECTURAL PLANS FOR ADDITIONAL INFORMATION ON UTILITY ENTRIES.
  - CONTRACTOR IS RESPONSIBLE FOR COMPLYING TO THE SPECIFICATIONS OF THE LOCAL AUTHORITIES WITH REGARDS TO MATERIALS AND INSTALLATION OF THE WATER AND SEWER LINES.
  - THE CONTRACTOR IS SPECIFICALLY CAUTIONED THAT THE LOCATION AND/OR ELEVATION OF EXISTING UTILITIES AS SHOWN ON THESE PLANS IS BASED ON RECORDS OF THE VARIOUS UTILITY COMPANIES, AND WHERE POSSIBLE, MEASUREMENTS TAKEN IN THE FIELD. THE INFORMATION IS NOT TO BE RELIED ON AS BEING EXACT OR COMPLETE. THE CONTRACTOR SHALL BE RESPONSIBLE FOR NOTIFYING ANY UTILITY COMPANY WHICH MAINTAINS A UTILITY LINE WITHIN THE BOUNDARIES OF THE PROJECT PRIOR TO THE START OF CONSTRUCTION. IT SHALL BE THE RESPONSIBILITY OF THE CONTRACTOR TO RELOCATE ALL EXISTING UTILITIES WHICH CONFLICT WITH THE PROPOSED IMPROVEMENTS SHOWN ON THESE PLANS. THE CONTRACTOR SHALL ASSUME THE RESPONSIBILITY FOR ANY DAMAGE, INCURRED BY ANY UTILITY COMPANY, TO THEIR LINES AS A RESULT OF HIS ACTIVITIES, WHETHER THESE LINES ARE SHOWN ON THE CONSTRUCTION PLANS OR NOT.
  - CONTRACTOR IS RESPONSIBLE FOR ALL NECESSARY INSPECTIONS AND/OR CERTIFICATIONS REQUIRED BY CODES AND/OR UTILITY SERVICE COMPANIES. THIS AND THE FINAL CONNECTIONS OF THE SERVICE SHALL BE COMPLETED 30 DAYS PRIOR TO STORE POSSESSION.
  - CONTRACTOR SHALL COORDINATE WITH ALL UTILITY COMPANIES FOR INSTALLATION REQUIREMENTS AND SPECIFICATIONS. ALL UTILITY CONSTRUCTION SHALL CONFORM WITH THE MOST STRINGENT REQUIREMENTS OF THE UTILITY COMPANY OR THE SAM'S CLUB SPECIFICATIONS.
  - 1" DOMESTIC WATER ENTRY.
  - CONTRACTOR SHALL VERIFY AS-BUILT INVERT ELEVATION AND ADVISE ENGINEER OF ANY DISCREPANCIES.
  - CONTRACTOR SHALL NOT OPEN, TURN OFF, INTERFERE WITH, OR ATTACH ANY PIPE OR HOSE TO OR TAP ANY WATER MAIN BELONGING TO THE CITY UNLESS DULY AUTHORIZED TO DO SO BY THE CITY. ANY ADVERSE CONSEQUENCES OF ANY SCHEDULED OR UNSCHEDULED DISRUPTIONS OF SERVICE TO THE PUBLIC ARE TO BE THE LIABILITY OF THE CONTRACTOR.
  - CONTRACTOR SHALL BE RESPONSIBLE FOR INSTALLING CONDUIT FOR UNDERGROUND UTILITIES AS PER THE UTILITY COMPANY REQUIREMENTS.
  - CONTRACTOR SHALL BE RESPONSIBLE FOR INSTALLING PIPE BOLLARD PROTECTION AROUND UTILITY ENTRIES AND METER LOCATIONS. CONTRACTOR SHALL COORDINATE WITH UTILITY COMPANY FOR EXACT REQUIREMENTS.
  - UNDERGROUND VENT PIPING FROM UNDERGROUND STORAGE TANKS. REFER TO ARCHITECTURAL PLANS FOR ADDITIONAL INFORMATION.
  - SEE SURVEY FOR DESCRIPTION OF EXISTING EASEMENTS.
  - 4" SANITARY SEWER SERVICE ENTRY.
  - EXISTING PEDESTALS, VALVE BOXES, VAULTS, UTILITY MARKERS, PULLBOXES, ETC TO REMAIN SHALL BE RAISED/LOWERED TO MATCH PROPOSED GRADES. COORDINATE ACTIVITIES WITH RESPECTIVE UTILITY PROVIDERS WHERE APPLICABLE.
  - ELECTRIC TRANSFORMER. REFER TO MEP PLANS FOR ADDITIONAL INFORMATION.
  - REFER TO UTILITY ENTRY DETAIL, THIS SET, FOR ADDITIONAL INFORMATION.
  - H-20 LOAD RATED FIBER OPTIC PULL BOX. REFER TO ARCHITECTURAL PLANS FOR CONTINUATION OF FIBER OPTICS AND TELEPHONE CONDUITS/CABLES.
  - REMOVE EXISTING UNDERGROUND SITE LIGHTING ELECTRICAL LINES AND RELOCATE AS NECESSARY. CONTRACTOR SHALL LOCATE THE SITE LIGHTING ELECTRICAL LINES IN THE FIELD PRIOR TO THE START OF ANY RELOCATION ACTIVITIES. CONTRACTOR SHALL COORDINATE, RELOCATION TO ENSURE LIGHTING SYSTEM IS OPERATIONAL FROM DUSK TILL DAWN AT ALL TIMES DURING CONSTRUCTION.
  - EACH CWTWATER-REQUIRED BACKFLOW PREVENTION ASSEMBLY (BPA) IS REQUIRED TO BE TESTED BY A CWTWATER-APPROVED CERTIFIED TESTER PRIOR TO PLACING THE WATER SYSTEM IN SERVICE.
  - THERE SHALL BE NO TAPS, PIPING BRANCHES, UNAPPROVED BYPASS PIPING, HYDRANTS, FIRE DEPARTMENT CONNECTION POINTS, OR OTHER WATER-USING APPURTENANCES CONNECTED TO THE SUPPLY LINE BETWEEN ANY WATER METER AND ITS CWTWATER-REQUIRED BACKFLOW PREVENTER.
  - BACKFLOW PREVENTER HEATER POWER SUPPLY ENTRY.
  - CONTRACTOR SHALL INSTALL NEW CONDUITS AND WIRING TO EXISTING AND RELOCATED LIGHT POLES AS NEEDED TO PROVIDE POWER TO ALL LIGHT POLES ON SITE. NEW WIRE AND CONDUITS SHALL MATCH SIZE OF THE ORIGINAL LINES, UNLESS LOCAL CODE HAS A MORE STRINGENT REQUIREMENT. NEW ADDITIONAL CONDUIT, WIRING, REROUTING OF EXISTING ELECTRICAL LINES, BENDS, PULL BOXES, PULL CABLES, ETC., BEYOND THAT SHOWN ON THESE PLANS REQUIRED TO PROVIDE POWER TO ALL SITE LIGHTING SHALL BE PROVIDED AND INSTALLED BY THE CONTRACTOR AND INCLUDED IN THE LUMP SUM PRICE.

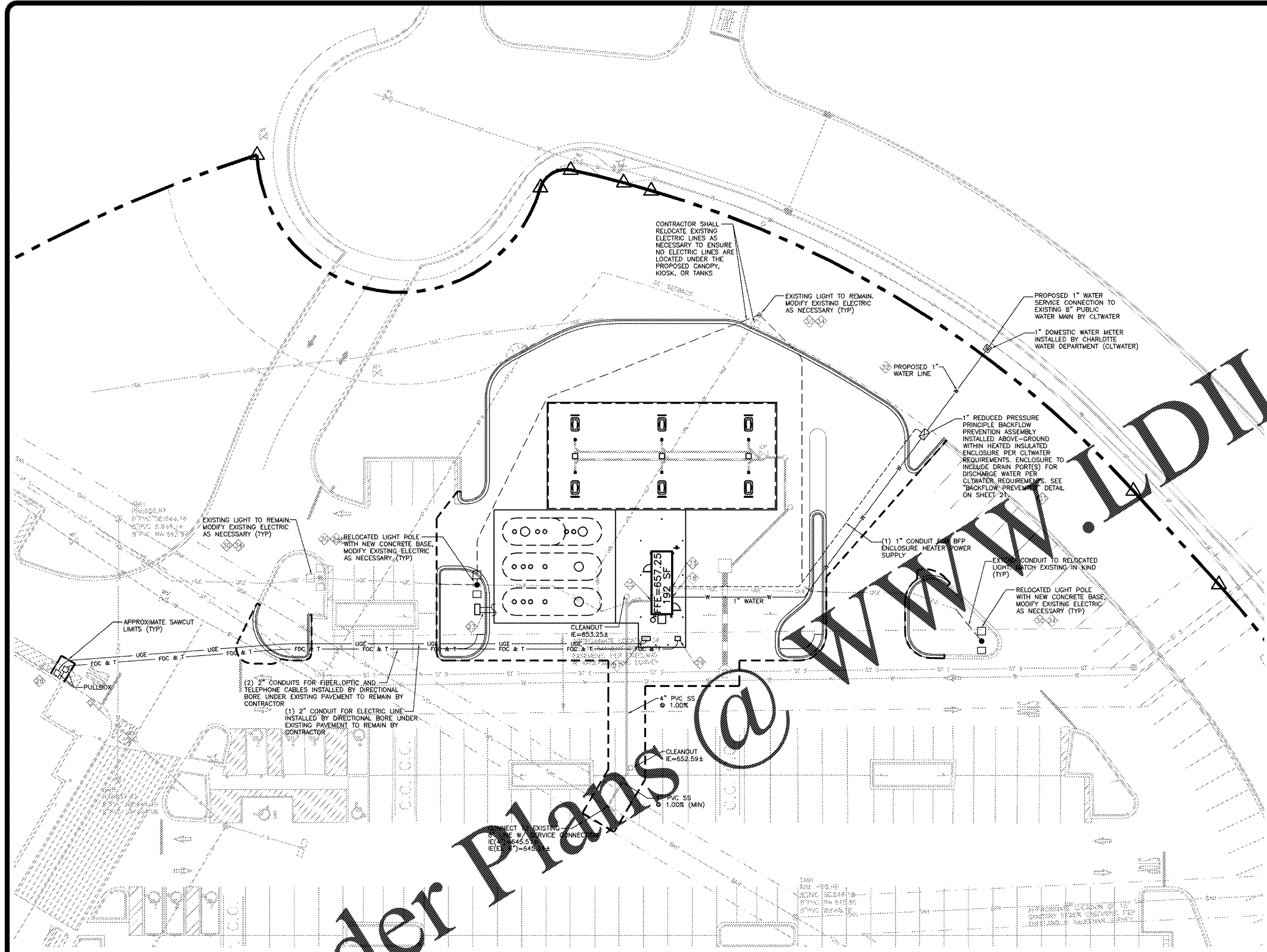

**CAUTION - NOTICE TO CONTRACTOR REGARDING EXISTING UTILITIES**

THE CONTRACTOR IS SPECIFICALLY CAUTIONED THAT THE LOCATION AND/OR ELEVATION OF EXISTING UTILITIES AS SHOWN ON THESE PLANS IS BASED ON ORIGINAL CONSTRUCTION DOCUMENTS PREPARED FOR THE SUPERCENTER DEVELOPMENT AND LIMITED FIELD INFORMATION. THE INFORMATION IS NOT TO BE RELIED UPON AS BEING EXACT OR COMPLETE. THE CONTRACTOR MUST CONTACT THE APPROPRIATE UTILITY COMPANIES AT LEAST 72 HOURS BEFORE PERFORMING ANY CONSTRUCTION ACTIVITIES TO REQUEST EXACT FIELD LOCATIONS OF THEIR UTILITIES. THE CONTRACTOR MUST BE AWARE THAT SOME EXISTING UTILITIES, SUCH AS UNDERGROUND ELECTRIC LINES SERVING PARKING LOT LIGHTING, STORM SEWER LINES, CABLES FOR SECURITY CAMERAS, ETC. MAY NOT BE LOCATED BY LOCAL OR STATE UTILITY COMPANIES. IT SHALL BE THE CONTRACTOR'S RESPONSIBILITY TO MAKE NECESSARY ACCOMMODATIONS TO ACCURATELY LOCATE ALL EXISTING UTILITIES.

ALL EXISTING UTILITIES SERVING THE SUPERCENTER, SUPERCENTER PROPERTY, OR ADJACENT DEVELOPMENTS SHALL REMAIN IN PLACE AND OPERATIONAL AT ALL TIMES DURING CONSTRUCTION. IT SHALL BE THE RESPONSIBILITY OF THE CONTRACTOR TO RELOCATE EXISTING UTILITIES WHEN NECESSARY TO FACILITATE THE REQUIRED IMPROVEMENTS SHOWN BY THESE PLANS. THE CONTRACTOR MUST COORDINATE ANY RELOCATIONS OR MODIFICATIONS TO THE EXISTING UTILITIES WITH THE APPROPRIATE UTILITY COMPANY, WALMART STORE MANAGER, AND WALMART CONSTRUCTION MANAGER.



**FIBER OPTIC CABLE AND TELEPHONE LINE CONDUIT REQUIREMENTS**

**CONDUIT**  
 THE CONDUIT DIAMETER SHALL BE AS FOLLOWS:  
**FIBER OPTIC CABLE AND TELEPHONE LINE CONDUIT** - ALL LOCATIONS - TWO (2) 2" CONDUITS. THE CONDUITS SHALL BE 2" DIAMETER CARLON TYPE "DB" DIRECT BURIAL TELEPHONE DUCT OR 2" SCHEDULE 40 PVC. INSTALL GALVANIZED PULL WIRE OR PROPYLENE POLYETHYLENE ROPE WITH A MINIMUM PULLING TENSION OF 100 POUNDS IN EACH CONDUIT. THE MINIMUM BURIAL DEPTH SHALL BE 24". INSTALL AN ORANGE DETECTABLE HAZARD TAPE WITH INTEGRAL "BURIED FIBER OPTIC CABLE" WORDING, 12" ABOVE THE TRENCHED CONDUITS.

**BENDS**  
 ALL CHANGES IN DIRECTION OF THE FIBER OPTIC CONDUIT WILL REQUIRE LONG FACTORY SWEEPS (NOT STANDARD SWEEPS) WITH RADIUS NOT LESS THAN 10 TIMES THE DIAMETER OF THE CONDUIT. NO MORE THAN TWO (2) 90 DEGREE BENDS WILL BE ALLOWED BETWEEN PULLING POINTS, OR A TOTAL OF 180 DEGREES COMBINED IN SEVERAL BENDS. BOXES SHALL BE LOCATED EVERY 450' FOR FIBER OPTIC CONDUIT UNLESS THE COMBINED TOTAL OF BENDS REQUIRES ADDITIONAL BOXES. CONDUIT SHOULD ENTER AND EXIT THE PULL BOXES 180 DEGREES APART.

**PULL BOXES**  
 ALL PULL BOXES LOCATED IN PAVED AREAS SUBJECT TO TRUCK TRAFFIC SHALL BE "H-20" LOAD RATED. THE TYPICAL PULL BOX SIZE FOR FIBER OPTIC CONDUIT SHALL BE 18"x24"x24". DEEPER BOXES MAY BE REQUIRED WHEN THE CONDUIT ALIGNMENT IS AFFECTED BY OTHER UTILITIES. THE PULL BOX SHALL BE INSTALLED PER THE MANUFACTURER'S SPECIFICATIONS WITH A CONCRETE COLLAR AND A MINIMUM OF 8" OF GRAVEL COMPACTED PER THE PROJECT SPECIFICATIONS. IF USING A PULL BOX TO CHANGE DIRECTION FOR THE FIBER OPTIC CONDUIT, THE MINIMUM BOX SIZE SHALL BE 48"x48"x24" PRE-CAST CONCRETE WITH A SEPARATE MANHOLE AND LID COLLAR.

**CAUTION - NOTICE TO CONTRACTOR**  
 THE CONTRACTOR IS SPECIFICALLY CAUTIONED THAT THE LOCATION AND/OR ELEVATION OF EXISTING UTILITIES AS SHOWN ON THESE PLANS IS BASED ON RECORDS OF THE VARIOUS UTILITY COMPANIES AND, WHERE POSSIBLE, MEASUREMENTS TAKEN IN THE FIELD. THE INFORMATION IS NOT TO BE RELIED UPON AS BEING EXACT OR COMPLETE. THE CONTRACTOR MUST CALL THE APPROPRIATE UTILITY COMPANY AT LEAST 72 HOURS BEFORE ANY EXCAVATION TO REQUEST EXACT FIELD LOCATION OF UTILITIES. IT SHALL BE THE RESPONSIBILITY OF THE CONTRACTOR TO RELOCATE ALL EXISTING UTILITIES WHICH CONFLICT WITH THE IMPROVEMENTS SHOWN BY THESE PLANS.

Order Plans @

WalmartBuilding.com

**UTILITY PLAN**