

# SITE DEVELOPMENT PLANS

## SAM'S FUELING STATION #6540-209

8909 JW CLAY BOULEVARD  
 CHARLOTTE, NORTH CAROLINA 28262

| ADDRESS INFORMATION:   |  |
|--|--|
| SAM'S CLUB #6540<br>8909 JW CLAY BLVD<br>CHARLOTTE, NC 28262 | FUELING STATION<br>605 DOUG MAYES PLACE<br>CHARLOTTE, NC 28262 |

**CONSTRUCTION PHASING NOTICE**

THE SAM'S CLUB WILL REMAIN OPERATIONAL THROUGHOUT THE DURATION OF THIS PROJECT. CONSTRUCTION SEQUENCING AND CLOSE COORDINATION WITH THE CONSTRUCTION MANAGER AND SAM'S CLUB MANAGER ARE REQUIRED TO HELP MINIMIZE DISRUPTIONS TO THE SAM'S CLUB NORMAL OPERATIONS (INCLUDING DELIVERIES, TMA SERVICES, OUTDOOR SALES AND STORAGE, ETC.) AND THEIR CUSTOMERS AND ASSOCIATES. BY SUBMITTING A BID, THE CONTRACTOR ACKNOWLEDGES THAT HE/SHE HAS EXAMINED THE PROJECT TO THE DEGREE NECESSARY TO PROVIDE A LUMP SUM PRICE FOR THE WORK AND THAT HE/SHE HAS INCLUDED NECESSARY FUNDS FOR ANY ADDITIONAL TEMPORARY PROTECTION, TRAFFIC CONTROL, LOW IMPACT CONSTRUCTION EQUIPMENT, AND/OR WORK REQUIRED DURING NON-PEAK BUSINESS HOURS THAT MAY BE REQUIRED TO MINIMIZE DISRUPTIONS AND/OR INCONVENIENCE TO THE SAM'S CLUB OPERATIONS AND ITS CUSTOMERS AND ASSOCIATES.

PRIOR TO MOBILIZATION BY THE CONTRACTOR, A PRECONSTRUCTION MEETING SHALL BE CONDUCTED BETWEEN THE CONTRACTOR, CONSTRUCTION MANAGER, SAM'S CLUB MANAGER, AND SAM'S CLUB REGIONAL AND/OR MARKET MANAGER TO DISCUSS PROJECT SCHEDULING AND TEMPORARY TRAFFIC CONTROL.

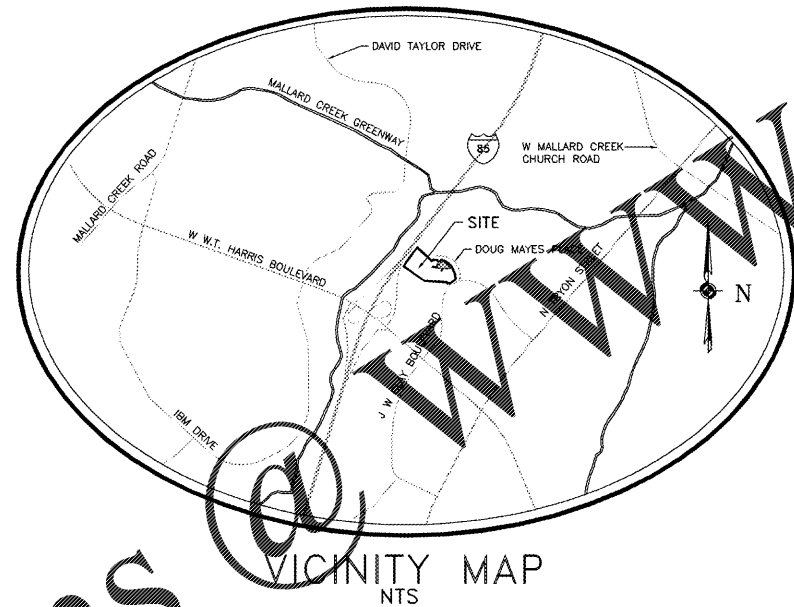

VICINITY MAP  
 NTS

DEVELOPED BY:



SAM'S REAL ESTATE BUSINESS TRUST  
 2101 SE SIMPLE SAVINGS DRIVE  
 BENTONVILLE, AR 72716  
 (479) 273-4000

ENGINEER:



7068 Ledgestone Commons, Bartlett, TN 38133  
 Phone (901) 384-0404 Fax (901) 384-0710

### INDEX OF SHEETS

|          |                                     |
|----------|-------------------------------------|
| SHEET 1  | TITLE SHEET                         |
| SHEET 2  | EXISTING CONDITIONS SURVEY          |
| SHEET 3  | OVERALL SITE PLAN                   |
| SHEET 4  | EROSION CONTROL PLAN                |
| SHEET 5  | SWPPP DETAILS                       |
| SHEET 6  | SWPPP DETAILS                       |
| SHEET 7  | SWPPP DETAILS                       |
| SHEET 8  | DEMOLITION AND TRAFFIC CONTROL PLAN |
| SHEET 9  | SITE PLAN                           |
| SHEET 10 | GRADING PLAN                        |
| SHEET 11 | UTILITY PLAN                        |
| SHEET 12 | TREE INVENTORY AND PROTECTION PLAN  |
| SHEET 13 | PLANTING PLAN                       |
| SHEET 14 | PLANTING DETAILS                    |
| SHEET 15 | IRRIGATION PLAN                     |
| SHEET 16 | IRRIGATION DETAILS                  |
| SHEET 17 | DETAILS                             |
| SHEET 18 | DETAILS                             |
| SHEET 19 | DETAILS                             |
| SHEET 20 | DETAILS                             |
| SHEET 21 | DETAILS                             |

ALL SITEWORK FOR THIS PROJECT SHALL MEET OR EXCEED THE "SITE SPECIFIC SPECIFICATIONS."

ALL NECESSARY INSPECTIONS, AND/OR CERTIFICATIONS REQUIRED BY CODES AND/OR UTILITY SERVICE COMPANIES SHALL BE PERFORMED PRIOR TO CONTRACT COMPLETION AND THE FINAL CONNECTION OF SERVICES.

CONTRACTOR SHALL CONTACT 811 FOR LOCATION OF ALL UTILITIES, AT LEAST 72 HOURS PRIOR TO BEGINNING CONSTRUCTION.

Order Plans

WWW.LDILLMAN.COM