

**KEYNOTES**

- 15.406 PLUMBING CONTRACTOR TO MAKE ALL NECESSARY DISCONNECTS AND RECONNECTS OF PLUMBING FIXTURES BEING RELOCATED OR NEW.
- 15.408 ROUTE WATER HEATER T&P DISCHARGE TO FLOOR DRAIN WITH AHU APPROVED AIR GAP.

STIPULATION FOR REUSE  
THIS DRAWING IS THE PROPERTY OF  
LDI CONSULTANTS. IT IS TO BE USED ONLY  
FOR THE PROJECT AND SITE SPECIFIC  
WORK. IT IS NOT TO BE REPRODUCED,  
COPIED, OR TRANSMITTED IN ANY FORM  
OR BY ANY MEANS, ELECTRONIC OR  
MECHANICAL, INCLUDING PHOTOCOPYING,  
RECORDING, OR BY ANY INFORMATION  
SYSTEMS TECHNOLOGY, WITHOUT THE  
WRITTEN PERMISSION OF LDI CONSULTANTS.  
DATE: 10/25/19



**Walmart\***  
CAMDEN, SC  
STORE NO. 06834-236  
JOB NUMBER: 1923111 | PHOTO: T7 PHOTO SC  
2020 GENERAL REMODEL

ISSUE BLOCK	

CHECKED BY: JEE  
DRAWN BY: NEB  
PROTO CYCLE: 10/25/19  
DOCUMENT DATE: 12/18/19

**NOT FOR  
CONSTRUCTION**

**ENLARGED  
PLUMBING  
PLANS**

SHEET:  
**P1**

Order Plans @ www.LDILine.com

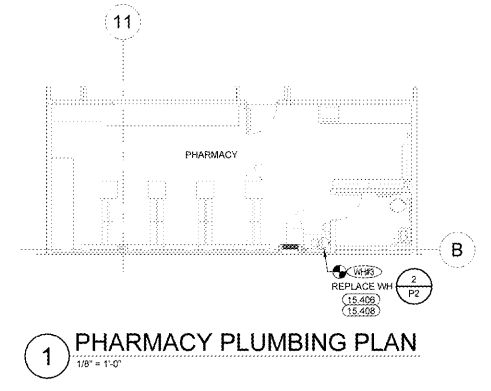
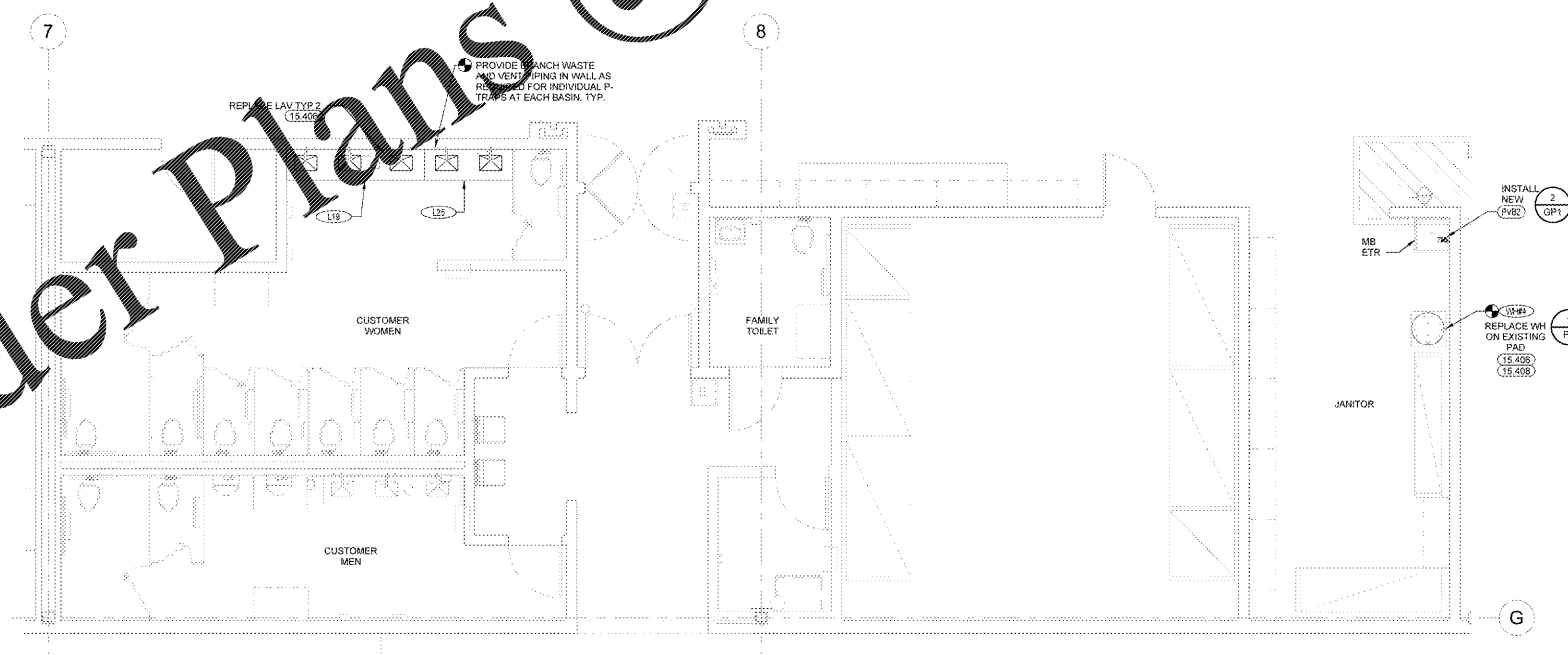

**2 REAR RESTROOM AREA PLUMBING PLAN**  
1/4" = 1'-0"

**1 PHARMACY PLUMBING PLAN**  
1/8" = 1'-0"

EXISTING CONDITIONS WERE TAKEN FROM ORIGINAL DRAWINGS AND MAY NOT REFLECT EXACT "AS-BUILT" CONDITIONS. CONTRACTOR SHALL FIELD VERIFY ALL EXISTING CONDITIONS PRIOR TO SUBMITTING FINAL BIDS. CONTRACTOR SHALL CAREFULLY COORDINATE NEW WORK AND DEMOLITION WITH ALL OTHER DISCIPLINES AND EXISTING CONDITIONS.

EACH SUBCONTRACTOR IS RESPONSIBLE FOR HAVING A THOROUGH KNOWLEDGE OF ALL DRAWINGS AND SPECIFICATIONS IN THEIR RELATED FIELD. THE FAILURE TO ACCUANT THEMSELVES WITH THIS KNOWLEDGE DOES NOT RELIEVE THE RESPONSIBILITY OF PERFORMING THE WORK PROPERLY. NO ADDITIONAL COMPENSATION SHALL BE ALLOWED BECAUSE OF CONDITIONS THAT OCCUR DUE TO FAILURE TO FAMILIARIZE WORKERS WITH THIS KNOWLEDGE.