

STORE LAYOUT FLOOR FINISH LEGEND		SALES FLOOR SQ. FT.	
AREA OF PVC	TOTAL SQ. FT. OF PVC	TOTAL SQ. FT. PVC REMOVED FROM STORE HAS EXISTING PVC	REMOVE REMOVE
A	REDUCE	TEXTURED SURFACE TILE SQ. FT.	REMOVE
B	CHANGE	FIELD TILE VCT SQ. FT.	REMOVE
C	CHANGE	ENTRY TILE SQ. FT.	0
D	0	ENTRY TILE SQ. YDS.	0
E	0	ENTRY TILE TRANS. STRIP LN. FT.	0
F	0	ENTRY CARPET SQ. FT.	0
G	0	ENTRY CARPET SQ. YDS.	0
H	0	PHARMACY SQ. FT.	614
I	0	PHARMACY SQ. YDS.	69
J	0	WOOD TRANSITION STRIP LN. FT.	1038
K	0	VCT TO BE REMOVED SQ. FT.	107,387
L	0	RUBBER FLOORING SQ. FT.	0

FLOOR FINISH RESPONSIBILITY MATRIX				
VCT CONVERSION				
REMODEL PROJECT: 0634 CAMDEN, SC				
PROJECT SCOPE: PVC(BLOCK INITIATIVE RPL); LT GRIND AND COAT/VCT CONVERSION				
PREFERRED FLOORING CONTRACTOR: RM				
SCOPE OF WORK		CONTRACTOR RESPONSIBLE FOR WORK LISTED		
REMOVAL OF EXISTING AND INSTALLATION OF NEW	PREFERRED FLOORING CONTRACTOR	GENERAL CONTRACTOR	REFRIGERATION CONTRACTOR	FLOORING VENDOR
PIECE REPLACEMENT IN BACK ROOM	X			
TENANT SPACES THRESHOLD	X			
APPAREL PADS - BLOCK	X			
VESTIBULE - PORCELAIN THRESHOLD	X			
RESILIENT TILE - SPOT	X			
PORCELAIN AT ENTRY TILE THRESHOLD	X			
PHARMACY CARPET TILE	X			
FLOOR FINISHES IN GROCERY PREP AREAS (INCLUDING THRESHOLDS (NON PUBLIC))		X		
RESTROOMS		X		
REMOVAL AND INSTALLATION OF REFRIG. CASE KICK PLATE			X	
FLOOR JOINT REPAIR (WHERE VCT IS REMOVED)	X			
FLOOR JOINT REPAIR (NON CUSTOMER)		X		
GARDEN CENTER/SEASONAL	X			
GARDEN CENTER/ SEASONAL JOINT REPAIR	X			
LOWER CLEAN-OUTS TO MATCH NEW ELEVATION OF EXPOSED FLOOR			X	
REMOVAL AND REPLACEMENT OF REFRIGERATED CASE PROTECTION			X	

- OWNER FURNISHED FLOORING**
- 2025 SF OF VCT AND ADHESIVE WILL BE FURNISHED BY THE OWNER TO SPOT REPLACE VCT THROUGHOUT THE STORE.
 - 533 SF OF PVC AND ADHESIVE WILL BE FURNISHED BY THE OWNER TO SPOT REPLACE PVC THROUGHOUT THE STORE IN ADDITION TO THE QUANTITIES IDENTIFIED IN THE STORE LAYOUT FLOOR FINISH LEGEND.

- SHEET NOTES**
- REF A8 FOR FINISH KEY
 - SEAL BASE OF ALL COLUMNS ON PVC PLANK FLOORING BROWN SEALANT.
 - SEAL BASE OF ALL COLUMNS ON VCT FLOORING W/ WHITE SEALANT. OC TO REMOVE AND REPLACE DAMAGED TRANSITION STRIPS TO MATCH EXISTING IN AREAS OF GC RESPONSIBILITY.
 - FILL ALL BOLT HOLES AND SPALLS IN NON CUSTOMER ACCESSIBLE AREAS RESULTING FROM FIXTURE AND/OR STORAGE RACK REMOVAL OR RELOCATION WITH NON SHRINK GROUT. INCLUDE BID ALLOWANCE OF 90 SPALL HOLES IN SEISMIC ZONES A-B AND 120 SPALL HOLES IN SEISMIC ZONES C-E.

LEGEND

	CERAMIC TILE		CARPET
	REMOVE EXISTING VCT AND TEXTURED VCT - POLISH EC - REF SPECS		PVC

SGA Design Group, c.
 1437 South Boulder, Suite 650
 Tulsa, Oklahoma 74119-3809
 T. 918.582.8901
 www.sga-designgroup.com

NOTES:
 (ADD NOTES)

PVC VCT QUANTITIES AND LOCATIONS ARE PRELIMINARY. PENDING FINAL CARPET AND TILE PLAN ISSUES BY WALMART.

REV. NAME DATE:

1. REFER TO PLUMBING PLANS FOR LOCATIONS OF ANY CLEANOUTS WHERE LEVELING REPAIR IS NEEDED.

2. MAKE REPAIR PRIOR TO REFINISHING CONCRETE.

3. MAKE REPAIR PRIOR TO REFINISHING CONCRETE.

4. MAKE REPAIR PRIOR TO REFINISHING CONCRETE.

5. MAKE REPAIR PRIOR TO REFINISHING CONCRETE.

6. MAKE REPAIR PRIOR TO REFINISHING CONCRETE.

7. MAKE REPAIR PRIOR TO REFINISHING CONCRETE.

8. MAKE REPAIR PRIOR TO REFINISHING CONCRETE.

9. MAKE REPAIR PRIOR TO REFINISHING CONCRETE.

10. MAKE REPAIR PRIOR TO REFINISHING CONCRETE.

11. MAKE REPAIR PRIOR TO REFINISHING CONCRETE.

12. MAKE REPAIR PRIOR TO REFINISHING CONCRETE.

13. MAKE REPAIR PRIOR TO REFINISHING CONCRETE.

14. MAKE REPAIR PRIOR TO REFINISHING CONCRETE.

15. MAKE REPAIR PRIOR TO REFINISHING CONCRETE.

16. MAKE REPAIR PRIOR TO REFINISHING CONCRETE.

17. MAKE REPAIR PRIOR TO REFINISHING CONCRETE.

18. MAKE REPAIR PRIOR TO REFINISHING CONCRETE.

19. MAKE REPAIR PRIOR TO REFINISHING CONCRETE.

20. MAKE REPAIR PRIOR TO REFINISHING CONCRETE.

21. MAKE REPAIR PRIOR TO REFINISHING CONCRETE.

22. MAKE REPAIR PRIOR TO REFINISHING CONCRETE.

23. MAKE REPAIR PRIOR TO REFINISHING CONCRETE.

24. MAKE REPAIR PRIOR TO REFINISHING CONCRETE.

25. MAKE REPAIR PRIOR TO REFINISHING CONCRETE.

26. MAKE REPAIR PRIOR TO REFINISHING CONCRETE.

27. MAKE REPAIR PRIOR TO REFINISHING CONCRETE.

28. MAKE REPAIR PRIOR TO REFINISHING CONCRETE.

29. MAKE REPAIR PRIOR TO REFINISHING CONCRETE.

30. MAKE REPAIR PRIOR TO REFINISHING CONCRETE.

31. MAKE REPAIR PRIOR TO REFINISHING CONCRETE.

32. MAKE REPAIR PRIOR TO REFINISHING CONCRETE.

33. MAKE REPAIR PRIOR TO REFINISHING CONCRETE.

34. MAKE REPAIR PRIOR TO REFINISHING CONCRETE.

35. MAKE REPAIR PRIOR TO REFINISHING CONCRETE.

36. MAKE REPAIR PRIOR TO REFINISHING CONCRETE.

37. MAKE REPAIR PRIOR TO REFINISHING CONCRETE.

38. MAKE REPAIR PRIOR TO REFINISHING CONCRETE.

39. MAKE REPAIR PRIOR TO REFINISHING CONCRETE.

40. MAKE REPAIR PRIOR TO REFINISHING CONCRETE.

41. MAKE REPAIR PRIOR TO REFINISHING CONCRETE.

42. MAKE REPAIR PRIOR TO REFINISHING CONCRETE.

43. MAKE REPAIR PRIOR TO REFINISHING CONCRETE.

44. MAKE REPAIR PRIOR TO REFINISHING CONCRETE.

45. MAKE REPAIR PRIOR TO REFINISHING CONCRETE.

46. MAKE REPAIR PRIOR TO REFINISHING CONCRETE.

47. MAKE REPAIR PRIOR TO REFINISHING CONCRETE.

48. MAKE REPAIR PRIOR TO REFINISHING CONCRETE.

49. MAKE REPAIR PRIOR TO REFINISHING CONCRETE.

50. MAKE REPAIR PRIOR TO REFINISHING CONCRETE.

51. MAKE REPAIR PRIOR TO REFINISHING CONCRETE.

52. MAKE REPAIR PRIOR TO REFINISHING CONCRETE.

53. MAKE REPAIR PRIOR TO REFINISHING CONCRETE.

54. MAKE REPAIR PRIOR TO REFINISHING CONCRETE.

55. MAKE REPAIR PRIOR TO REFINISHING CONCRETE.

56. MAKE REPAIR PRIOR TO REFINISHING CONCRETE.

57. MAKE REPAIR PRIOR TO REFINISHING CONCRETE.

58. MAKE REPAIR PRIOR TO REFINISHING CONCRETE.

59. MAKE REPAIR PRIOR TO REFINISHING CONCRETE.

60. MAKE REPAIR PRIOR TO REFINISHING CONCRETE.

61. MAKE REPAIR PRIOR TO REFINISHING CONCRETE.

62. MAKE REPAIR PRIOR TO REFINISHING CONCRETE.

63. MAKE REPAIR PRIOR TO REFINISHING CONCRETE.

64. MAKE REPAIR PRIOR TO REFINISHING CONCRETE.

65. MAKE REPAIR PRIOR TO REFINISHING CONCRETE.

66. MAKE REPAIR PRIOR TO REFINISHING CONCRETE.

67. MAKE REPAIR PRIOR TO REFINISHING CONCRETE.

68. MAKE REPAIR PRIOR TO REFINISHING CONCRETE.

69. MAKE REPAIR PRIOR TO REFINISHING CONCRETE.

70. MAKE REPAIR PRIOR TO REFINISHING CONCRETE.

71. MAKE REPAIR PRIOR TO REFINISHING CONCRETE.

72. MAKE REPAIR PRIOR TO REFINISHING CONCRETE.

73. MAKE REPAIR PRIOR TO REFINISHING CONCRETE.

74. MAKE REPAIR PRIOR TO REFINISHING CONCRETE.

75. MAKE REPAIR PRIOR TO REFINISHING CONCRETE.

76. MAKE REPAIR PRIOR TO REFINISHING CONCRETE.

77. MAKE REPAIR PRIOR TO REFINISHING CONCRETE.

78. MAKE REPAIR PRIOR TO REFINISHING CONCRETE.

79. MAKE REPAIR PRIOR TO REFINISHING CONCRETE.

80. MAKE REPAIR PRIOR TO REFINISHING CONCRETE.

81. MAKE REPAIR PRIOR TO REFINISHING CONCRETE.

82. MAKE REPAIR PRIOR TO REFINISHING CONCRETE.

83. MAKE REPAIR PRIOR TO REFINISHING CONCRETE.

84. MAKE REPAIR PRIOR TO REFINISHING CONCRETE.

85. MAKE REPAIR PRIOR TO REFINISHING CONCRETE.

86. MAKE REPAIR PRIOR TO REFINISHING CONCRETE.

87. MAKE REPAIR PRIOR TO REFINISHING CONCRETE.

88. MAKE REPAIR PRIOR TO REFINISHING CONCRETE.

89. MAKE REPAIR PRIOR TO REFINISHING CONCRETE.

90. MAKE REPAIR PRIOR TO REFINISHING CONCRETE.

91. MAKE REPAIR PRIOR TO REFINISHING CONCRETE.

92. MAKE REPAIR PRIOR TO REFINISHING CONCRETE.

93. MAKE REPAIR PRIOR TO REFINISHING CONCRETE.

94. MAKE REPAIR PRIOR TO REFINISHING CONCRETE.

95. MAKE REPAIR PRIOR TO REFINISHING CONCRETE.

96. MAKE REPAIR PRIOR TO REFINISHING CONCRETE.

97. MAKE REPAIR PRIOR TO REFINISHING CONCRETE.

98. MAKE REPAIR PRIOR TO REFINISHING CONCRETE.

99. MAKE REPAIR PRIOR TO REFINISHING CONCRETE.

100. MAKE REPAIR PRIOR TO REFINISHING CONCRETE.

101. MAKE REPAIR PRIOR TO REFINISHING CONCRETE.

102. MAKE REPAIR PRIOR TO REFINISHING CONCRETE.

103. MAKE REPAIR PRIOR TO REFINISHING CONCRETE.

104. MAKE REPAIR PRIOR TO REFINISHING CONCRETE.

105. MAKE REPAIR PRIOR TO REFINISHING CONCRETE.

106. MAKE REPAIR PRIOR TO REFINISHING CONCRETE.

107. MAKE REPAIR PRIOR TO REFINISHING CONCRETE.

108. MAKE REPAIR PRIOR TO REFINISHING CONCRETE.

109. MAKE REPAIR PRIOR TO REFINISHING CONCRETE.

110. MAKE REPAIR PRIOR TO REFINISHING CONCRETE.

111. MAKE REPAIR PRIOR TO REFINISHING CONCRETE.

112. MAKE REPAIR PRIOR TO REFINISHING CONCRETE.

113. MAKE REPAIR PRIOR TO REFINISHING CONCRETE.

114. MAKE REPAIR PRIOR TO REFINISHING CONCRETE.

115. MAKE REPAIR PRIOR TO REFINISHING CONCRETE.

116. MAKE REPAIR PRIOR TO REFINISHING CONCRETE.

117. MAKE REPAIR PRIOR TO REFINISHING CONCRETE.

118. MAKE REPAIR PRIOR TO REFINISHING CONCRETE.

119. MAKE REPAIR PRIOR TO REFINISHING CONCRETE.

120. MAKE REPAIR PRIOR TO REFINISHING CONCRETE.

121. MAKE REPAIR PRIOR TO REFINISHING CONCRETE.

122. MAKE REPAIR PRIOR TO REFINISHING CONCRETE.

123. MAKE REPAIR PRIOR TO REFINISHING CONCRETE.

124. MAKE REPAIR PRIOR TO REFINISHING CONCRETE.

125. MAKE REPAIR PRIOR TO REFINISHING CONCRETE.

126. MAKE REPAIR PRIOR TO REFINISHING CONCRETE.

127. MAKE REPAIR PRIOR TO REFINISHING CONCRETE.

128. MAKE REPAIR PRIOR TO REFINISHING CONCRETE.

129. MAKE REPAIR PRIOR TO REFINISHING CONCRETE.

130. MAKE REPAIR PRIOR TO REFINISHING CONCRETE.

131. MAKE REPAIR PRIOR TO REFINISHING CONCRETE.

132. MAKE REPAIR PRIOR TO REFINISHING CONCRETE.

133. MAKE REPAIR PRIOR TO REFINISHING CONCRETE.

134. MAKE REPAIR PRIOR TO REFINISHING CONCRETE.

135. MAKE REPAIR PRIOR TO REFINISHING CONCRETE.

136. MAKE REPAIR PRIOR TO REFINISHING CONCRETE.

137. MAKE REPAIR PRIOR TO REFINISHING CONCRETE.

138. MAKE REPAIR PRIOR TO REFINISHING CONCRETE.

139. MAKE REPAIR PRIOR TO REFINISHING CONCRETE.

140. MAKE REPAIR PRIOR TO REFINISHING CONCRETE.

141. MAKE REPAIR PRIOR TO REFINISHING CONCRETE.

142. MAKE REPAIR PRIOR TO REFINISHING CONCRETE.

143. MAKE REPAIR PRIOR TO REFINISHING CONCRETE.

144. MAKE REPAIR PRIOR TO REFINISHING CONCRETE.

145. MAKE REPAIR PRIOR TO REFINISHING CONCRETE.

146. MAKE REPAIR PRIOR TO REFINISHING CONCRETE.

147. MAKE REPAIR PRIOR TO REFINISHING CONCRETE.

148. MAKE REPAIR PRIOR TO REFINISHING CONCRETE.

149. MAKE REPAIR PRIOR TO REFINISHING CONCRETE.

150. MAKE REPAIR PRIOR TO REFINISHING CONCRETE.

151. MAKE REPAIR PRIOR TO REFINISHING CONCRETE.

152. MAKE REPAIR PRIOR TO REFINISHING CONCRETE.

153. MAKE REPAIR PRIOR TO REFINISHING CONCRETE.

154. MAKE REPAIR PRIOR TO REFINISHING CONCRETE.

155. MAKE REPAIR PRIOR TO REFINISHING CONCRETE.

NOTE: ALL TEXTURED TILE SHOWN OR NOT SHOWN ON PLAN IS TO BE REPLACED WITH TEXTURED TILE. DETERMINE QUANTITY BASED ON EXISTING CONDITIONS TO BE INCLUDED AS PART OF THE BASE BID. IF QUANTITY VARIES FROM STORE LAYOUT FLOOR FINISH LEGEND COORDINATE WITH CONSTRUCTION MANAGER AT PRE-CONSTRUCTION MEETING FOR ADDITIONAL TEXTURED TILE AND ADHESIVE TO BE ORDERED. NO ADDITIONAL COMPENSATION WILL BE PAID DUE TO THE CONTRACTOR'S FAILURE TO ACQUAINT THEMSELVES WITH THE EXISTING CONDITIONS.

NOTE: UNLESS NOTED OTHERWISE THE PREFERRED FLOORING CONTRACTOR WILL BE RESPONSIBLE FOR REMOVAL OF EXISTING AND INSTALLATION OF NEW (INCLUDING ALL PIECE REPLACEMENTS IN BACK OF HOUSE, FRONT SPACE, ENTRY, ETC.) RESILIENT FLOORING, PORCELAIN, TRANSITION STRIP, PHARMACY CARPET TILE, CARPET ENTRY, AND VESTIBULE AND RECYCLING CENTER PORCELAIN FLOOR FINISHES IN GROCERY PREP AREAS (NON PUBLIC) AND RESTROOMS TO BE FURNISHED BY THE CONTRACTOR.

NOTE: PATTERN USES FOR IDENTIFICATION DIFFERENT MATERIALS ONLY. REFER TO SPECIFICATIONS FOR PROPER INSTALLATION METHOD.

VCT UNDER CASES THAT ARE EXISTING TO REMAIN WILL NOT BE REMOVED. REMOVE KICKPLATES AND REMOVE VCT PAST KICK PLATES AS FAR AS POSSIBLE. REINSTALL KICK PLATES AFTER VCT IS REMOVED.

REMOVE AND REINSTALL BASE IN SPACES SCHEDULED FOR VCT CONVERSION IF THE SPACE IS NOT NOTED TO RECEIVE NEW BASE.



8 CLEANOUT LEVELING DETAIL
 3/4" = 1'-0" RM SC: A1.3 RM VMM: --

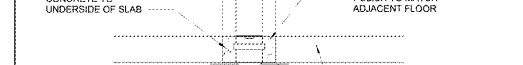

4 TRANSITION STRIP AT PVC (OR VCT) FLOORING
 1/2" = 1'-0" RM SC: A1.1 RM VMM: --

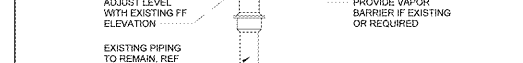

3 TRANSITION AT EXPOSED EDGE OF TILE
 1/2" = 1'-0"



2 PVC TRANSITION
 1/8" = 1'-0" RM SC: A1.1 RM VMM: --

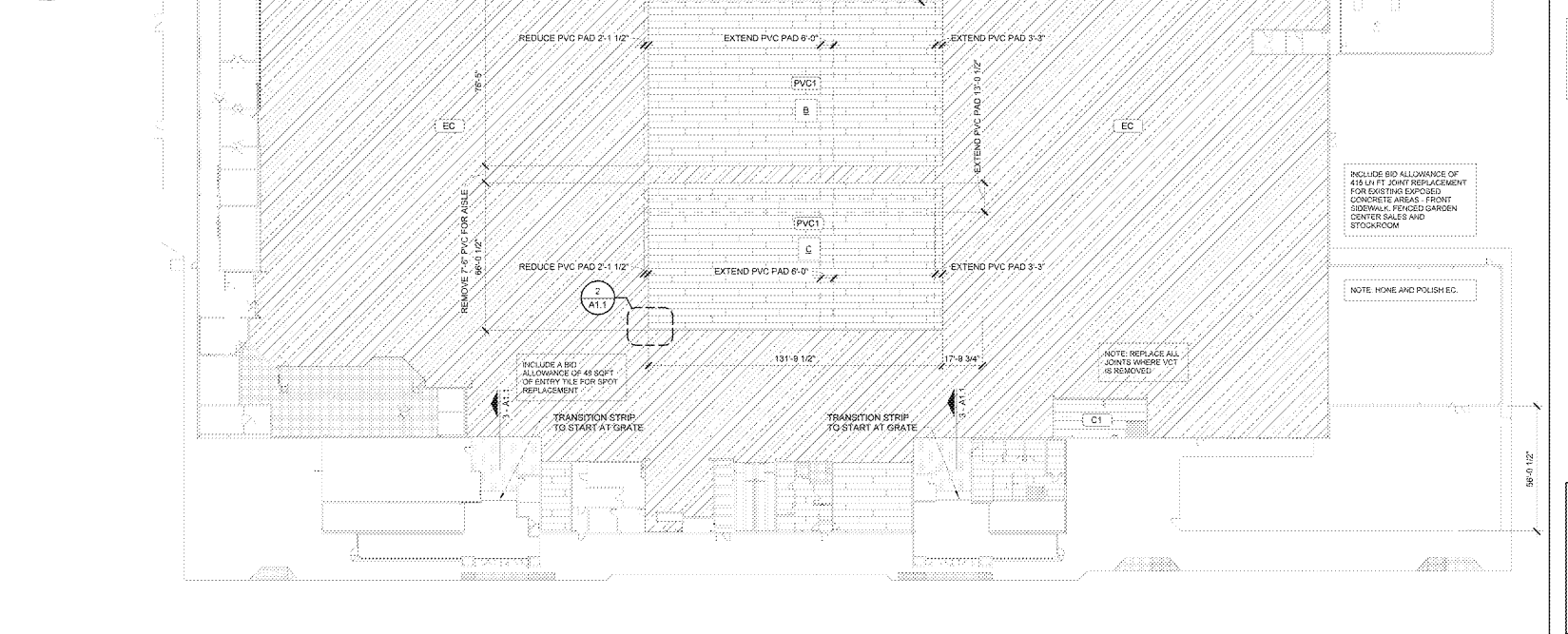

1 FLOOR FINISH PLAN
 1" = 30'-0"

SGA Design Group, c.
 1437 South Boulder, Suite 650
 Tulsa, Oklahoma 74119-3809
 T. 918.582.8901
 www.sga-designgroup.com

STIPULATION FOR REUSE:
 THIS DRAWING AND ALL INFORMATION CONTAINED HEREIN IS THE PROPERTY OF SGA DESIGN GROUP, C. IT IS TO BE USED ONLY FOR THE PROJECT AND SITE SPECIFICALLY IDENTIFIED HEREIN. IT IS NOT TO BE REPRODUCED, COPIED, OR TRANSMITTED IN ANY FORM OR BY ANY MEANS, ELECTRONIC OR MECHANICAL, INCLUDING PHOTOCOPYING, RECORDING, OR BY ANY INFORMATION STORAGE AND RETRIEVAL SYSTEM, WITHOUT THE WRITTEN PERMISSION OF SGA DESIGN GROUP, C.

CONSULTANTS:
 (List of consultants and their roles)

Walmart
CAMDEN, SC
 STORE NO: 0634-226
 182011 - PHOTO: 172 PHOTO 5C
 2020 GENERAL REMODEL