

U.S. HIGHWAY NO. #41 (S.R. NO. 45)  
(TAMIAMI TRAIL)

(200' PUBLIC R/W)

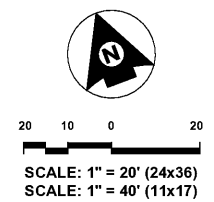

**NOTE:**  
Maximum impervious area for lots 1E AND 2E = 36237sf and 15986 respectively. Per SWFWMD permit # 44027461.002  
Maximum impervious area for LOT 3E = 9835 Per SWFWMD permit # 44027461.006  
Calculated impervious area for lots 1E AND 2E = 29660.09SF & 11260.86SF respectively.  
Calculated impervious area for Lot 3E = 9682 SF

**LEGEND:**

- PROPOSED ASPHALT PAVEMENT
- PROPOSED CONCRETE
- PROPOSED SWALE
- PROPOSED CATCH BASIN
- PROPOSED STORM PIPE
- EXISTING ELEVATION, NAVD 88
- PROPOSED ELEVATION
- PROPOSED ROOF MANIFOLD

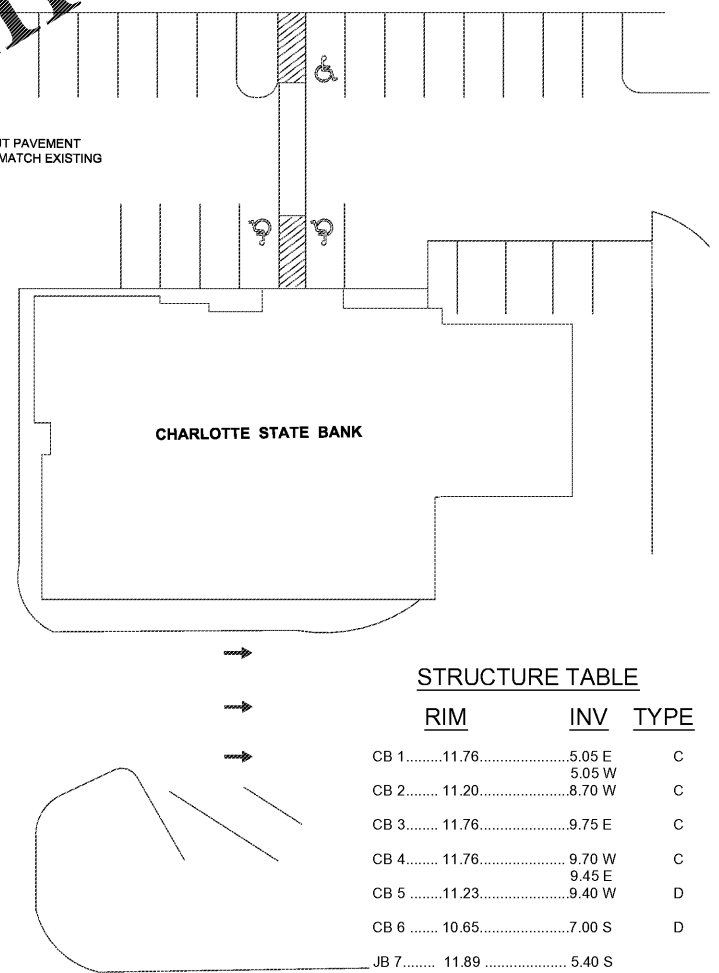
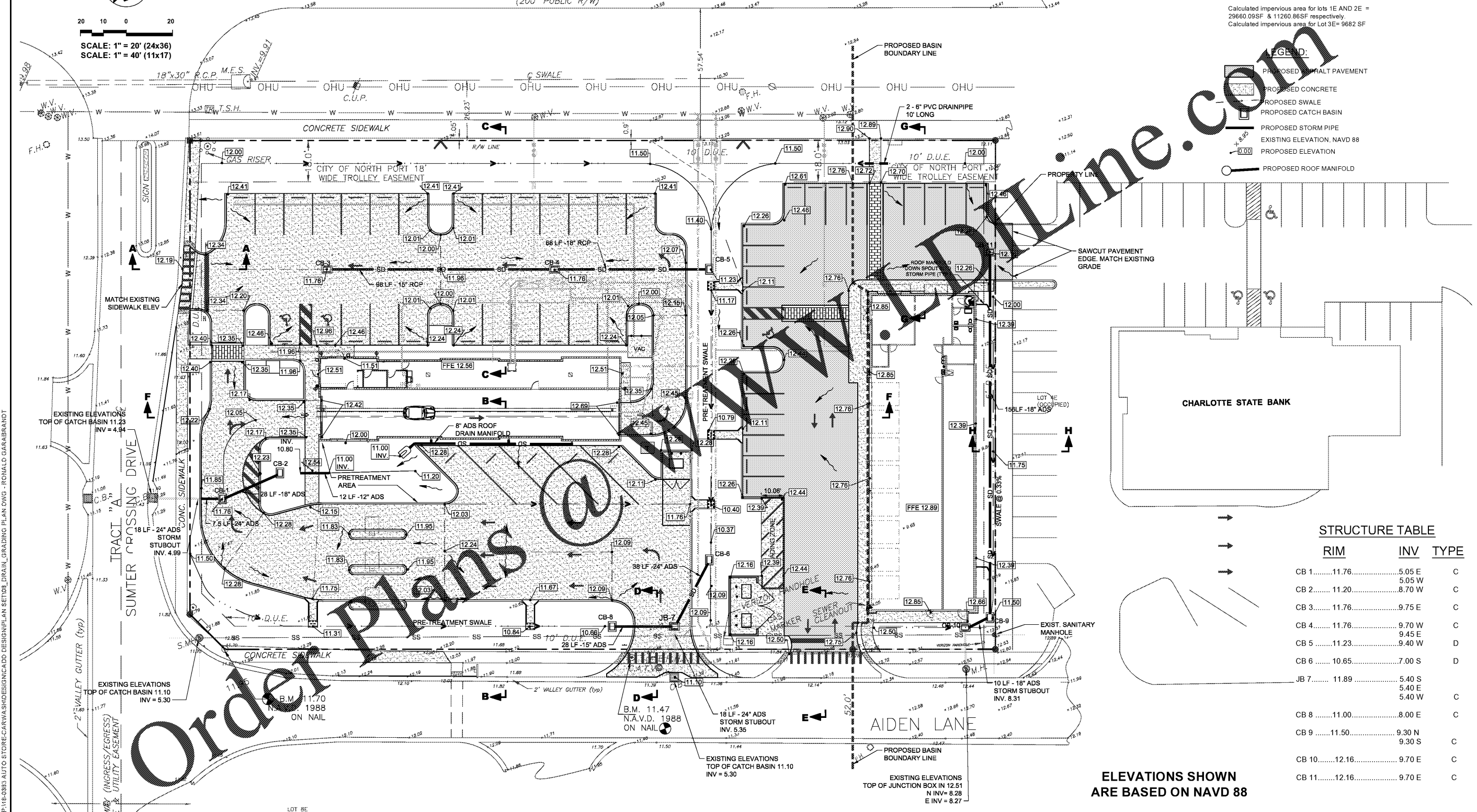

**STRUCTURE TABLE**

	RIM	INV	TYPE
CB 1.....	11.76.....	5.05 E	C
CB 2.....	11.20.....	8.70 W	C
CB 3.....	11.76.....	9.75 E	C
CB 4.....	11.76.....	9.70 W	C
CB 5.....	11.23.....	9.40 W	D
CB 6.....	10.65.....	7.00 S	D
JB 7.....	11.89.....	5.40 S	
		5.40 E	C
CB 8.....	11.00.....	8.00 E	C
CB 9.....	11.50.....	9.30 N	C
		9.30 S	C
CB 10.....	12.16.....	9.70 E	C
CB 11.....	12.16.....	9.70 E	C

ELEVATIONS SHOWN  
ARE BASED ON NAVD 88

**SED** Southwest Engineering & Design  
660 Charlotte Street, Suite 8  
Punta Gorda, Florida 33950  
Tel. (941) 637-9655 | Fax (941) 637-1149  
www.sedfl.com  
Certificate of Authorization No. 26551

REV.	DATE	BY	CK'D	DESCRIPTION

Project No.: 18-0383  
Project Manager: K H R  
Project Engineer: E D L  
Project Designer: S E G  
Checked By: E D L  
Approved By: E D L

**TIRE KINGDOM / COASTAL CARWASH  
DRAINAGE AND GRADING PLAN**

NORTH PORT, FL SECTION 33 TOWNSHIP 39 SOUTH, RANGE 21 EAST FLORIDA

DATE: 12/4/18 SCALE: AS NOTED  
SHEET 8 of 11  
PROJECT No.: 18-0383  
EDWARD P. LOMSKI JR., P.E.  
FLORIDA REG No. 62507

9/10/2018 2:16:32 PM - P:18-0383 AUTO STORE-CARWASH-DESIGN-CADD DESIGNER:PLAN SETJOB\_DRAIN\_GRADING PLAN DWG - RICHARD GARABANDI