

**EQUIPMENT SCHEDULE**

TAG	DESCRIPTION	QTY	AIR	GAS	WATER	ELEC	DATA	REMARKS
1	ALIGNMENT LIFT	1	A					
2	TWO-POST LIFT -- 10,000K	0	A					SURFACE MOUNTED
3	TWO-POST LIFT -- 12,000K	0	A					SURFACE MOUNTED
4	ALIGNMENT MACHINE	1						
5	AIR COMPRESSOR	2	A					
6	AIR DRYER	1	A					
7	TIRE CHANGER	2	A					
8	WHEEL BALANCER	2						
9	WHEEL BALANCER ADAPTER	2						PORTABLE
10	WHEEL WEIGHT RACK	2						PORTABLE
11	SHOCK/STRUT PRESS	1						ANCHORED TO WALL OR POST
12	BEARING PRESS	1						
13	WORK BENCH							
14	VICE	1						ANCHORED TO WORK BENCH
15	GRINDER	1						ANCHORED TO WORK BENCH
16	BRAKE LATHE							
17	ON CAR BRAKE LATHE	1						
18	BRAKE PARTS WASHER	2		W	E			PORTABLE CART
19	AUTOMATIC PARTS CLEANER	0		W	E			
20	NEW OIL TANK	1	A					12 GA / UL 142
21	WASTE OIL TANK	1	A					12 GA / UL 142
22	WASTE OIL PUMP	1	A					FLOAT & STRING GAUGE W/ ALARM
23	WASTE OIL DRAINS	2	A					PORTABLE CART
24	OVERHEAD SHOP REELS	2	A	G				CEILING MTD ON STL. PLATE
25	OIL NOZZLE / METER	2						CONNECT TO ITEM 24
26	55 GALLON DRUMS	4						
27	SPILL DECK	2						
28	OILY RAG CAN	3						PORTABLE
29	COOLANT FLUSH	1				E		PORTABLE CART
30	AUTOMATIC TRANSMISSION FLUSH	1				E		PORTABLE CART
31	REFRIGERANT RECOVER	1				E		PORTABLE CART
32	FLUID EXCHANGER	1				E		PORTABLE CART
33	BATTERY CHARGER	1				E		PORTABLE CART
34	TIRE AND PARTS RACKING	TBD						RACKING UNDER SEPARATE PERMIT
35	ROLLING STEP LADDER	2						PORTABLE CART
36	TIRE TESTER (DUNK TANK)	1						PORTABLE
37	TOOL KADDY	3	A					ANCHORED TO FLOOR
38	FLAT REPAIR STATION	1						ANCHORED TO FLOOR
39	3 TIER DISPENSER RACK	1						
40	WALL MOUNTED FANS	4						
41	SERVICE CART	1						PORTABLE CART
42	MECHANICS TOOL BOX	4						PORTABLE CART
43	SERVICE MANAGER DESK	1	A			E	D	PROVIDED W/ MILLWORK
44A	TWO-POST LIFT -- 10,000K	1	A			E		IN-GROUND MOUNT - NO PADS
44B	TWO-POST LIFT -- 10,000K	2	A			E		IN-GROUND MOUNT - WITH PADS
45	TWO-POST LIFT -- 12,000K	1	A			E		IN-GROUND MOUNT - NO PADS
46	SCISSOR LIFT	0	A			E		
47	SHORT-RISE LIFT	2	A			E		
48	QUICK CHECK SYSTEM	1	A			E		

**FIXTURES SCHEDULE**

TAG	DESCRIPTION	QTY	WATER	ELEC	DATA	REMARKS
50	LOCKERS - EMPLOYEE	1				
51	LOCKERS - SOIL DROP	1				
52	KITCHEN CABINETRY	0				CABINETRY SHALL COMPLY WITH 2017 FBC 6TH ED. ACCESSIBILITY.
53	SALES COUNTER - ACCESSIBLE	1	E	D		CABINET COMPLIES WITH 2017 FBC 6TH ED. ACCESSIBILITY. 904.4.1 FOR PARALLEL APPROACH.
54	SALES KIOSK	2	E	D		
55	COUNTER TOP	3				INSTALL 28-34" AFF TO TOP OF COUNTER AS NOTED. COMPLY WITH 2017 FBC 6TH ED. ACCESSIBILITY. 902.
56	REFRESHMENT COUNTER	1	E			CABINET COMPLIES WITH 2017 FBC 6TH ED. ACCESSIBILITY. 308.3.2 FOR SIDE REACH APPROACH.
57	SIDE TABLE W/ CHARGING PORT	2		E		
58	END TABLE	1				
59	COFFEE TABLE	1				
60	GUEST CHAIR	6				
61	LOUNGE CHAIR	2				
62	STOOL	6				
63	DESK CHAIR	1				
64	REFRIGERATOR	1	W	E		
65	MICROWAVE	1		E		
66	WORK TABLE W/ CHARGING PORT	1		E		
67	TV WALL	1		E		
68	U/C REFRIGERATOR	1	-	E		
69	COFFEE MAKER	1	W	E		
70	FLAT SCREEN TV	7		E	D	VERIFY SIZES WITH OWNER
71	TV WALL SURROUND	0				SEE DETAIL 2/A2
72	WALL SURROUND	2				SEE DETAIL 2/A2
73	CEILING RACEWAY	1				SEE DETAIL 2/A2
74	LIGHTED BRAND LOGO	0		E		
75	BRAND NAME	TBD				
76	WORK ORDER BOARD	TBD				
77	WALL PLACARDS	TBD				
78	WINDOW DECALS	TBD				

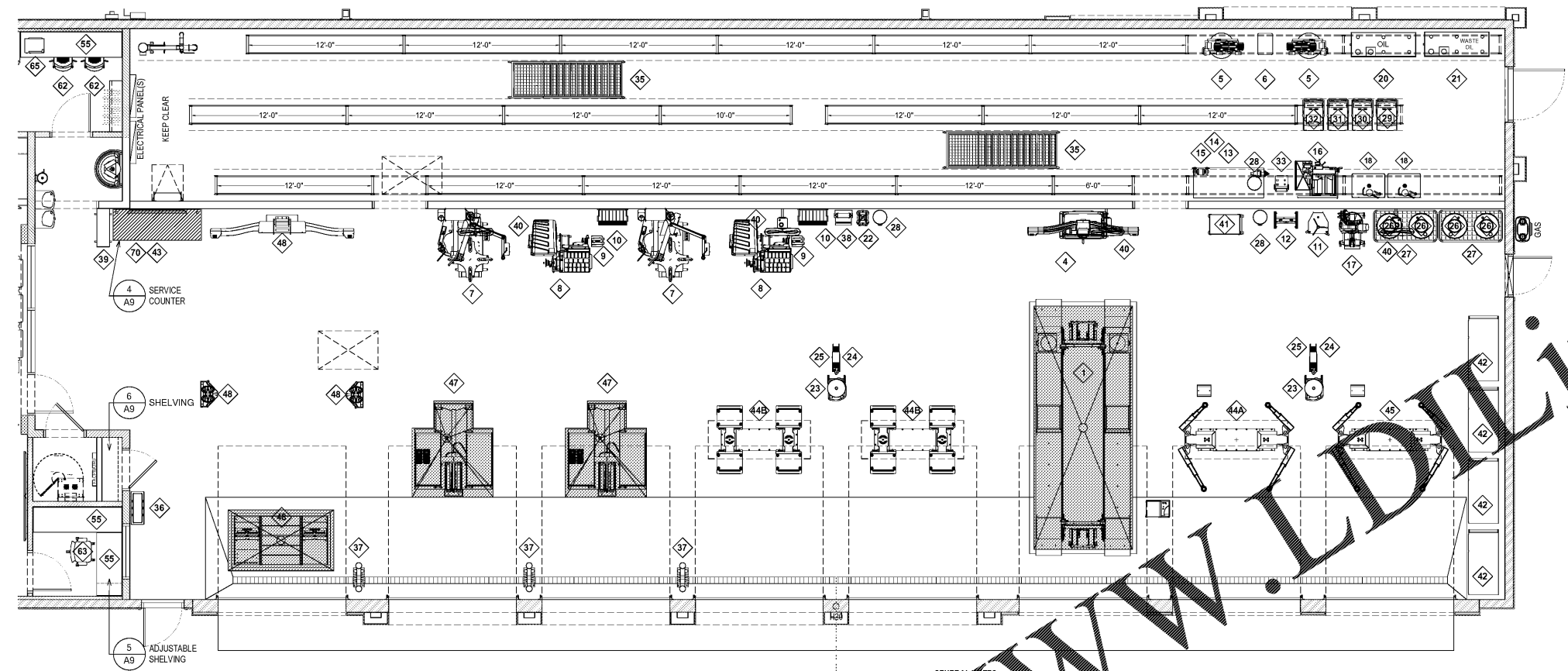

- GENERAL NOTES**
1. FIXTURES, FURNITURE, AND EQUIPMENT PROVIDED BY OWNER UNLESS NOTED OTHERWISE. GC TO COORDINATE DELIVERY AND INSTALL.
  2. GC SHALL RECEIPT, COUNT, AND VERIFY ALL SHIPMENTS OF OWNER SUPPLIED ITEMS.
  3. GC IS RESPONSIBLE FOR PROTECTING ALL OWNER SUPPLIED FIXTURES, FURNITURE, AND EQUIPMENT THROUGHOUT THE DURATION OF CONSTRUCTION UNTIL THE BUILDING IS TURNED OVER TO THE OWNER/TENANT. GC IS REQUIRED TO REPAIR OR REPLACE AS A RESULT OF ANY DAMAGE THAT MAY OCCUR.
  4. GC SHALL PREP AND PROVIDE FOR REQUIRED POWER AS SHOWN WITHIN THE DOCUMENTS.

**1 EQUIPMENT PLAN**  
 3/16" = 1'-0"  
 NORTH

Order Plans @

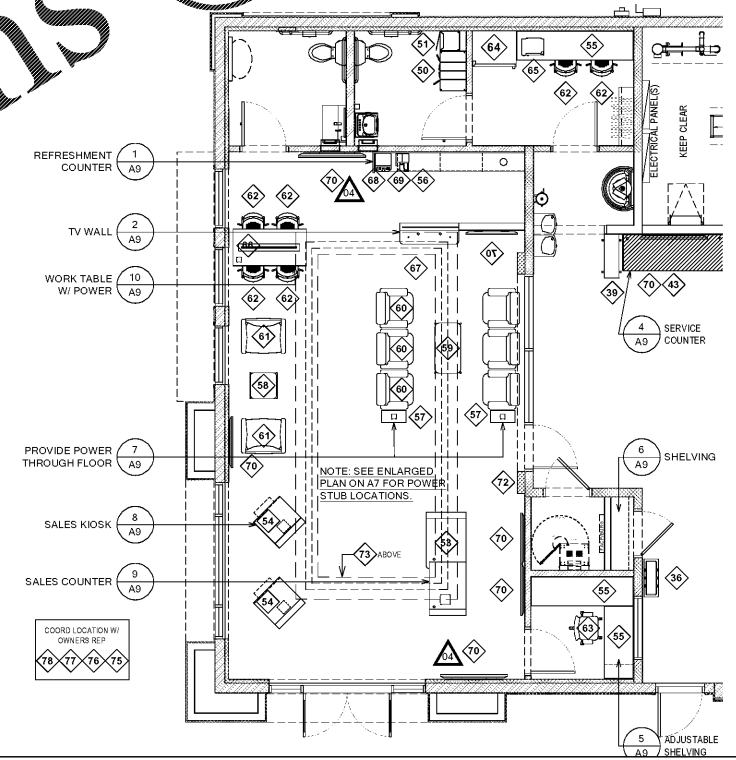

- GENERAL NOTES**
1. FIXTURES, FURNITURE, AND EQUIPMENT PROVIDED BY OWNER UNLESS NOTED OTHERWISE. GC TO COORDINATE DELIVERY AND INSTALL.
  2. GC SHALL RECEIPT, COUNT, AND VERIFY ALL SHIPMENTS OF OWNER SUPPLIED ITEMS.
  3. GC IS RESPONSIBLE FOR PROTECTING ALL OWNER SUPPLIED FIXTURES, FURNITURE, AND EQUIPMENT THROUGHOUT THE DURATION OF CONSTRUCTION UNTIL THE BUILDING IS TURNED OVER TO THE OWNER/TENANT. GC IS REQUIRED TO REPAIR OR REPLACE AS A RESULT OF ANY DAMAGE THAT MAY OCCUR.
  4. GC SHALL PREP AND PROVIDE FOR REQUIRED POWER AS SHOWN WITHIN THE DOCUMENTS.
  5. ALL FIXTURES AND WORK SURFACES MUST BE INSTALLED TO COMPLY WITH LOCAL ACCESSIBILITY CODES. GC TO ADJUST AS REQUIRED BY AHJ.

**2 FIXTURES & FURNITURE**  
 NORTH