

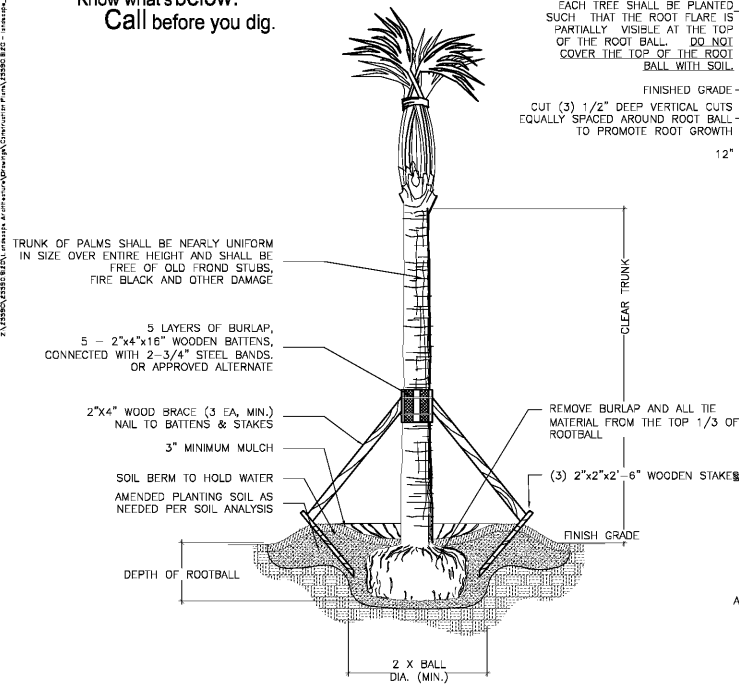

Know what's below.
Call before you dig.



- NOTES: 1) SEE LANDSCAPE NOTES FOR THE TYPE OF MULCH MATERIAL TO USE. 2) PLANT ROOT BALL FLUSH WITH FINISHED GRADE UNLESS AREA HAS POOR DRAINAGE, IN WHICH CASE PLANT ROOTBALL 2" ABOVE GRADE. 3) SABAL PALMETTOS SHALL BE DEFOLIATED, PROTECT CABBAGE HEAD FROM DAMAGE. ALL OTHER PALM SPECIES MUST HAVE FRONDS TIED W/BIODEGRADABLE STRAP OR TWINE. 4) FINAL TREE STAKING AND PLACEMENT TO BE APPROVED BY OWNER'S REP. 5) CONTRACTOR SHALL ASSURE PERCOLATION OF ALL PLANTING PITS PRIOR TO INSTALLATION.

PALM TREE PLANTING
NOT TO SCALE

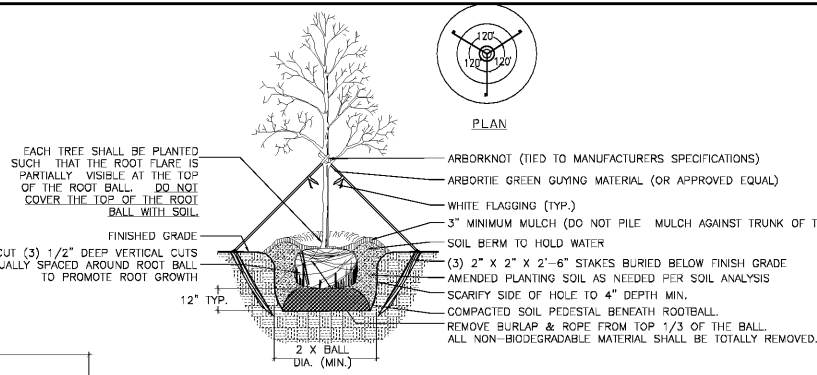

- NOTES: 1) SEE LANDSCAPE NOTES FOR THE TYPE OF MULCH MATERIAL TO USE. 2) ONLY GUY TREES WHEN SITE CONDITIONS REQUIRE IT. 3) PLANT ROOT BALL FLUSH WITH FINISHED GRADE UNLESS AREA HAS POOR DRAINAGE, IN WHICH CASE PLANT ROOTBALL 2" ABOVE GRADE. 4) REMOVE ALL BRANCHES THAT ARE DAMAGED, RUBBING, OR CROSSING OTHER BRANCHES. 5) NEVER CUT A CENTRAL LEADER. 6) FINAL TREE STAKING AND PLACEMENT TO BE APPROVED BY OWNER'S REP. 7) CONTRACTOR SHALL ASSURE PERCOLATION OF ALL PLANTING PITS PRIOR TO INSTALLATION.

TREE PLANTING
NOT TO SCALE

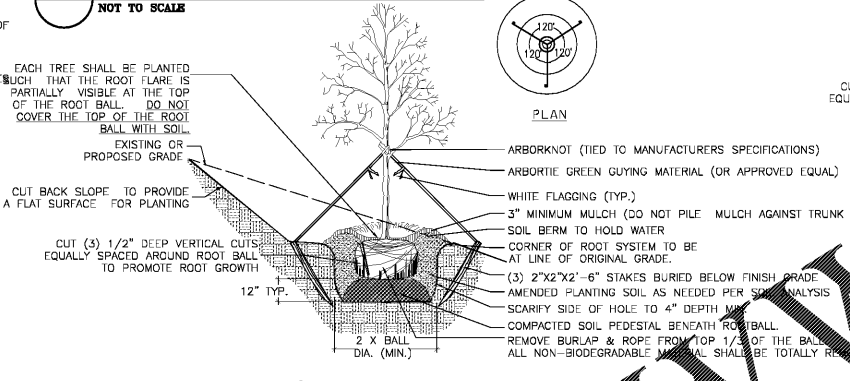

- NOTES: 1) SEE LANDSCAPE NOTES FOR THE TYPE OF MULCH MATERIAL TO USE. 2) ONLY GUY TREES WHEN SITE CONDITIONS REQUIRE IT. 3) PLANT ROOT BALL FLUSH WITH FINISHED GRADE UNLESS AREA HAS POOR DRAINAGE, IN WHICH CASE PLANT ROOTBALL 2" ABOVE GRADE. 4) REMOVE ALL BRANCHES THAT ARE DAMAGED, RUBBING, OR CROSSING OTHER BRANCHES. 5) NEVER CUT A CENTRAL LEADER. 6) FINAL TREE STAKING AND PLACEMENT TO BE APPROVED BY OWNER'S REP. 7) CONTRACTOR SHALL ASSURE PERCOLATION OF ALL PLANTING PITS PRIOR TO INSTALLATION.

TREE PLANTING ON A SLOPE
NOT TO SCALE

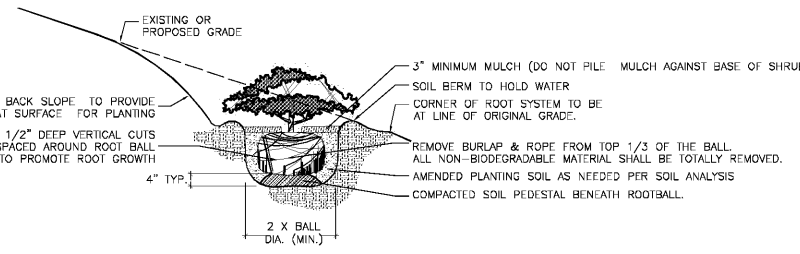

- NOTES: 1) SEE LANDSCAPE NOTES FOR THE TYPE OF MULCH MATERIAL TO USE. 2) WHEN GROUNDCOVER AND SHRUBS ARE USED IN MASSES, DO NOT FORM SOIL BERMS ON INDIVIDUAL PLANTS AND ENTIRE PLANTING BED SHALL BE EXCAVATED TO RECEIVE PLANTING SOIL AND PLANT MATERIAL. 3) PLANT ROOT BALL FLUSH WITH FINISHED GRADE UNLESS AREA HAS POOR DRAINAGE, IN WHICH CASE PLANT ROOTBALL 2" ABOVE GRADE. COORDINATE WITH OWNER'S REP. PRIOR TO SETTING ROOTBALL ELEVATIONS. 4) CONTRACTOR SHALL ASSURE PERCOLATION OF ALL PLANTING PITS PRIOR TO INSTALLATION.

SHRUB PLANTING ON A SLOPE
NOT TO SCALE

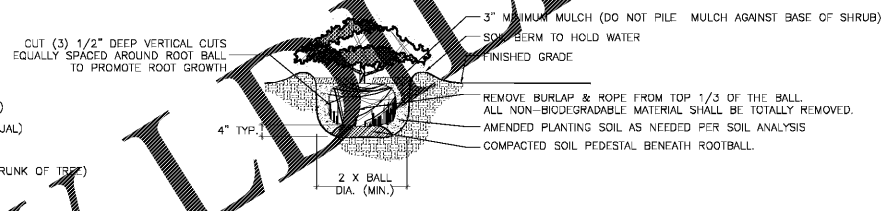

- NOTES: 1) SEE LANDSCAPE NOTES FOR THE TYPE OF MULCH MATERIAL TO USE. 2) WHEN GROUNDCOVER AND SHRUBS ARE USED IN MASSES, DO NOT FORM SOIL BERMS ON INDIVIDUAL PLANTS AND ENTIRE PLANTING BED SHALL BE EXCAVATED TO RECEIVE PLANTING SOIL AND PLANT MATERIAL. 3) PLANT ROOT BALL FLUSH WITH FINISHED GRADE UNLESS AREA HAS POOR DRAINAGE, IN WHICH CASE PLANT ROOTBALL 2" ABOVE GRADE. COORDINATE WITH OWNER'S REP. PRIOR TO SETTING ROOTBALL ELEVATIONS. 4) CONTRACTOR SHALL ASSURE PERCOLATION OF ALL PLANTING PITS PRIOR TO INSTALLATION.

SHRUB PLANTING
NOT TO SCALE

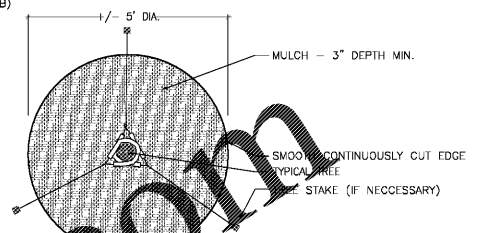

- NOTES: 1) SEE LANDSCAPE NOTES FOR THE TYPE OF MULCH MATERIAL TO USE. 2) A MULCH IN A +/- 5' DIAMETER WHERE PROPOSED TREE PLANTINGS OCCUR IN SOD OR SEEDED AREA.

TREE RING
NOT TO SCALE

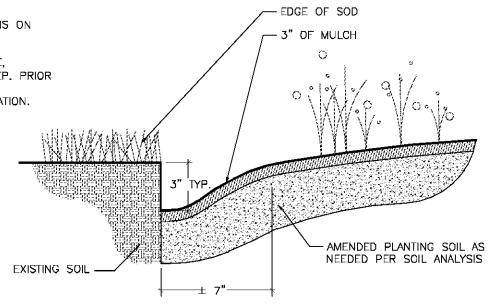

- NOTES: 1) TRENCH EDGE TO BE LOCATED BETWEEN PLANTING BEDS AND ALL LAWN AREAS.

SOD TO PLANT BED EDGE
NOT TO SCALE

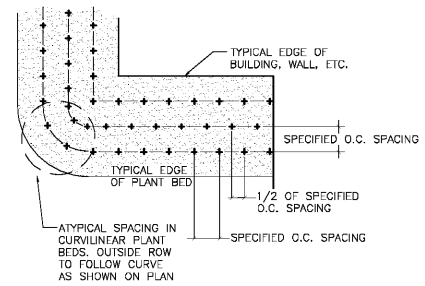

- NOTES: 1) EXCAVATE ENTIRE BED SPECIFIED FOR GROUNDCOVER PLANTING TO A DEPTH OF 12".

PLANT SPACING DETAIL
NOT TO SCALE

GENERAL PLANTING / IRRIGATION NOTES:

- 1. REQUIREMENTS FOR THE MEASUREMENTS, BRANCHING, GRADING, QUALITY, BALLING AND BURLAPPING OF PLANTS IN THE PLANT LIST SHOULD FOLLOW OR EXCEED THE STANDARDS CURRENTLY RECOMMENDED BY THE AMERICAN ASSOCIATION OF NURSERYMEN, INC. IN THE AMERICAN STANDARD FOR NURSERY STOCKS (ANSI). UNLESS OTHERWISE SPECIFIED, ANY SIZE SPECIFIED SHALL BE CONSIDERED MINIMUM. MINIMUMS FOR HEIGHT, SPREAD, CALIPER, ETC. SHALL TAKE PRECEDENCE OVER A SPECIFIED CONTAINER SIZE. (I.E. - IF 7 GALLON IS REQUIRED, TO PROVIDE A SPECIFIED HEIGHT OR SPREAD THAT IS SPECIFIED AS A 3 GALLON, THEN THE 7 GALLON SHALL BE REQUIRED AND INCLUDED IN THE BASE BID AND SHALL NOT BE CONSIDERED A CHANGE ORDER.)
- 2. ALL PLANTS SHALL HAVE A WELL FORMED HEAD WITH MINIMUM CALIPER, HEIGHT AND SPREAD OF THE SIDE BRANCHES AS SHOWN ON THE PLANT LIST. TRUNKS SHALL BE UNMAYED AND SHAPE SHALL BE TYPICAL OF THE SPECIES.
- 3. MEASUREMENT OF CONIFER HEIGHT SHALL INCLUDE NOT MORE THAN FIFTY (50) PER CENT OF THIS YEARS' VERTICAL GROWTH (TOP CANOPY).
- 4. THE LANDSCAPE CONTRACTOR IS HEREBY NOTIFIED OF THE EXISTENCE OF UNDERGROUND UTILITIES WITHIN THE LIMITS OF THE PROJECT AREA. THE CONTRACTOR SHOULD VERIFY THE EXACT LOCATION OF ALL UTILITY LINES PRIOR TO COMMENCEMENT OF DIGGING OPERATIONS. CONTRACTOR IS RESPONSIBLE FOR LOCATING, PROTECTING, AND REPAIRING ALL DAMAGE TO BUILDINGS, UTILITIES, PAVEMENT, AND CURB & GUTTER. REPAIRS SHALL BE DONE PROMPTLY AT CONTRACTOR'S EXPENSE.
- 5. THE CONTRACTOR WILL BE RESPONSIBLE FOR STAKING AND LAYOUT OF PLANTINGS ON THIS PROJECT. THE LANDSCAPE ARCHITECT OR OWNER SHALL BE ADVISED WHEN STAKES ARE READY FOR INSPECTION ON VARIOUS PLANTING AREAS. ALL LAYOUT WORK SHALL BE INSPECTED AND APPROVED BY THE LANDSCAPE ARCHITECT AND OWNER PRIOR TO OPENING ANY PLANTING PITS.
- 6. IT IS THE RESPONSIBILITY OF THE LANDSCAPE CONTRACTOR TO VERIFY THAT EACH EXCAVATED TREE OR SHRUB PIT WILL PERCOLATE (DRAIN) PRIOR TO ADDING TOPSOIL AND INSTALLING TREES OR SHRUBS. THE CONTRACTOR SHALL FILL THE BOTTOM OF HOLES WITH SIX (6) INCHES OF WATER. THIS WATER SHOULD PERCOLATE WITHIN A TWENTY-FOUR (24) HOUR PERIOD. IF WATER DOESN'T PERCOLATE, CONTRACTOR SHALL NOTIFY THE OWNER'S REP PRIOR TO INSTALLING PLANTS.
- 7. SHOULD THE LANDSCAPE CONTRACTOR ENCOUNTER UNSATISFACTORY SURFACE OR SUBSURFACE DRAINAGE CONDITIONS, SOIL DEPTH, LATENT SOILS, HARD PANS, STEAM OR OTHER UTILITY LINES OR OTHER CONDITIONS THAT WILL JEOPARDIZE THE HEALTH AND VIGOR OF THE PLANTS, HE MUST ADVISE THE LANDSCAPE ARCHITECT IN WRITING OF THE CONDITIONS PRIOR TO INSTALLING THE PLANTS. OTHERWISE, THE LANDSCAPE CONTRACTOR WARRANTS THAT THE PLANTING AREAS ARE SUITABLE FOR PROPER GROWTH AND DEVELOPMENT OF PLANTS TO BE INSTALLED.
- 8. THE LANDSCAPE CONTRACTOR SHALL BE RESPONSIBLE FOR CLEANING UP THE SITE AT THE COMPLETION OF THE PROJECT AND SHALL MAINTAIN THE SITE IN A REASONABLY NEAT AND CLEAN STATE THROUGHOUT THE INSTALLATION PROCESS. STREETS AND PAVED AREAS SHALL BE CLEANED REGULARLY TO REMOVE CONSTRUCTION MATERIALS AND OTHER DEBRIS RESULTING FROM WORK OF THE PROJECT.
- 9. REPLACEMENTS OF DEAD OR UNSATISFACTORY MATERIALS SHALL BE MADE AS SPECIFIED IN THE PLANT LIST. THE OWNER OR LANDSCAPE ARCHITECT SHALL INSPECT REPLACED PLANTS WHEN ALL REPLACEMENTS HAVE BEEN MADE. REPLACEMENTS ARE TO BE ALIVE AND IN A HEALTHY CONDITION WHEN THE REPLACEMENTS ARE COMPLETE. REPLACEMENTS ARE NOT SUBJECT TO AN ADDITIONAL GUARANTEE, BUT THE LANDSCAPE CONTRACTOR SHALL CONSULT WITH THE LANDSCAPE ARCHITECT FOR REASON FOR PLANT DECLINE/DEATH AND HOW TO AVOID FUTURE INSTANCES.
- 10. SHOULD THE CONTRACTOR NOT MAKE REPLACEMENTS IN A SATISFACTORY AND TIMELY FASHION IN ACCORD WITH THE PLANTING NOTES, THE OWNER, AFTER PROPER NOTIFICATION TO THE CONTRACTOR, MAY UTILIZE THE FUNDS OF THE RETAINAGE TO HAVE THE REPLACEMENTS MADE IN ACCORDANCE WITH THE SPECIFICATIONS BY ANOTHER CONTRACTOR.
- 11. NO EXCAVATION OR PLANTING PIT SHALL BE LEFT UNATTENDED OVERNIGHT.
- 12. PLANT MATERIAL QUANTITIES PROVIDED IN THE PLANT LIST ARE FOR REFERENCE ONLY AND THE CONTRACTOR IS RESPONSIBLE FOR THE ACTUAL PLANT MATERIAL COUNTS. DISCREPANCIES BETWEEN QUANTITIES SHOWN ON THE PLANTING PLAN AND THOSE IN THE PLANT LIST SHALL BE BROUGHT TO THE ATTENTION OF THE LANDSCAPE ARCHITECT FOR CLARIFICATION. IF CLARIFICATION OF DISCREPANCIES FROM THE LANDSCAPE ARCHITECT IS NOT POSSIBLE, THEN QUANTITIES SHOWN ON THE PLANTING PLAN SHALL TAKE PRECEDENCE.
- 13. REMOVE BURLAP/STRAPPING AND WIRE BASKET FROM TOP 1/3 OF ROOT BALL ON TREES.
- 14. REMOVE PAPER, PLASTIC OR METAL AROUND ROOT BALLS OF SHRUBS.

- 15. DO NOT WRAP TREES.
 - 16. WATER ALL PLANT MATERIAL IMMEDIATELY AFTER PLANTING.
 - 17. TREE GUYING MATERIAL SHALL BE 'ARBOR-TIE' OR EQUIVALENT.
 - 18. ALL PLANT BEDS TO BE MULCHED WITH 3" DEPTH OF PINE STRAW MULCH.
 - 19. ALL AREAS OF PLANTING, INCLUDING AREAS OF GRASS SEEDING AND SOD, SHALL BE GRADED TO PROVIDE POSITIVE DRAINAGE AND SHALL BE PROVIDED APPROPRIATE SOIL FOR THE PROPOSED PLANTINGS. THE LANDSCAPE CONTRACTOR SHALL ADJUST PH AND / OR SOIL FERTILITY BY UNIFORMLY INCORPORATING REQUIRED SOIL CONDITIONING MATERIALS AT THE RATE AND DEPTH DETERMINED BY THE ANALYSIS OF THE SOIL TEST (AS REQUIRED IN 3.02 AND 3.15 OF THE LANDSCAPING SPECIFICATIONS). EACH SOIL TEST SHALL BE SPECIFIC TO THE PROPOSED PLANT MATERIAL TO BE INSTALLED IN A GIVEN AREA.
 - 20. ALL EXISTING VEGETATION WITHIN AREAS TO BE PLANTED / SODDED / SEEDDED SHALL BE REMOVED PRIOR TO PLANTING / SODDING / SEEDING. ALL AREAS INDICATED TO BE GRASS SEED SHALL BE SEEDDED PER GRASSING SPECIFICATIONS FOR PERMANENT STABILIZATION.
 - 21. CONTRACTOR TO SUPPLY AUTOMATIC IRRIGATION SYSTEMS, COMPLETE AND INSTALLED. SYSTEM TO INCLUDE ALL VALVES, PIPES, HEADS, FITTINGS, RAIN SENSOR, AND CLOCK AND TO PROVIDE 100% COVERAGE OF ALL NEW SODDED AND IMPROVED EXISTING GRASS AREAS, TREES, SHRUBS AND PLANTING BEDS. COORDINATE IRRIGATION WITH OWNER'S REPRESENTATIVE. (CONTRACTOR SHALL PROVIDE SHOP DRAWINGS OF PROPOSED IRRIGATION SYSTEM FOR OWNER ACCEPTANCE)
 - 22. CONTRACTOR SHALL OBTAIN ALL NECESSARY PERMITS FOR AUTOMATIC IRRIGATION SYSTEMS. CONTRACTOR SHALL PROVIDE ELECTRIC METER AND SERVICE IN ACCORDANCE WITH STATE AND LOCAL CODES FOR IRRIGATION SYSTEM. LOCATION OF METERS AND CONTROL PANELS FOR IRRIGATION SHALL BE APPROVED BY OWNER'S REP. PRIOR TO INSTALLATION.
 - 23. WHERE IRRIGATION SYSTEM WILL BE INSTALLED WITH ANY WATER SOURCE OTHER THAN DOMESTIC POTABLE WATER, LANDSCAPE CONTRACTOR SHALL BE RESPONSIBLE FOR IRRIGATION WATER TESTING. IRRIGATION WATER SHALL BE TESTED FOR LEVELS OF PH, ALKALINITY AND SOLUBLE SALTS. SUBMIT TEST RESULTS TO OWNER'S REPRESENTATIVE FOR REVIEW PRIOR TO INSTALLATION OR ORDERING OF IRRIGATION EQUIPMENT, PUMPS OR WELL DIGGING.
 - 24. ALL TREES SHALL BE INSTALLED PER THE REQUIREMENTS OF THE BERKELEY COUNTY, SOUTH CAROLINA APPLICABLE ORDINANCES.
 - 25. ALL PLANT BEDS TO RECEIVE WEED INHIBITOR OF PREEN OR ACCEPTED ALTERNATE.
 - 26. FOR SUMMERTIME PLANTINGS, CONTRACTOR TO USE EITHER CONTAINERIZED OR PRE-DUG B & B PLANT MATERIAL.
 - 27. AS AN ADD ALTERNATE BID, THE CONTRACTOR SHALL PROVIDE "SOIL MOIST TRANSPLANT" (OR ACCEPTED EQUIVALENT) AT THE APPLICATION RATES SHOWN BELOW FOR ALL NEWLY INSTALLED PLANTINGS.
- | Container Size/Amount | Caliper Size/Amount |
|-----------------------|---------------------|
| 1 Gallon/.75 oz. | 1"/3.0 oz. |
| 2 Gallon/1.5 oz. | 2"/6.0 oz. |
| 3 Gallon/1.5 oz. | 3"/9.0 oz. |
| 5 Gallon/2.0 oz. | 4"/12.0 oz. |
| 7 Gallon/3.0 oz. | 5"/15.0 oz. |
| 10 Gallon/3.0 oz. | 6"/18.0 oz. |
| 15 Gallon/5.0 oz. | 7"/21.0 oz. |
| 20 Gallon/7.0 oz. | 8"/24.0 oz. |
| Plant Height/Amount | Box Size/Amount |
| 2'/1.5 oz. | 18"/5.0 oz. |
| 3'/2.0 oz. | 20"/6.0 oz. |
| 4'/3.0 oz. | 24"/9.0 oz. |
| 5'/4.0 oz. | 30"/12.0 oz. |
| 6'/5.0 oz. | 36"/18.0 oz. |
| 7'/6.0 oz. | 42"/27.0 oz. |
| 7'/6.0 oz. | 60"/30.0 oz. |

PRELIMINARY

THOMAS & HUTTON
682 Johnnie Dodds Blvd. • Suite 100
Mt. Pleasant, SC 29464 • 843.849.0200
www.thomasandhutton.com

PAVILION DEVELOPMENT COMPANY
BERKELEY COUNTY, SOUTH CAROLINA

FIRESTONE SITE DEVELOPMENT
PLANTING DETAILS

JOB NO: J-23390.8120
DATE: 10/04/19
DRAWN: LNS
DESIGNED: LNS
REVIEWED: CAE
APPROVED: SCG
SCALE: AS SHOWN

L1.1