

NOTES:
 1. ALL FITTINGS SHALL BE SOIL TIGHT.
 2. CONNECTION TO GUTTER DOWNSPOUT SHALL BE LOOSE TO ALLOW FOR OVERFLOW.

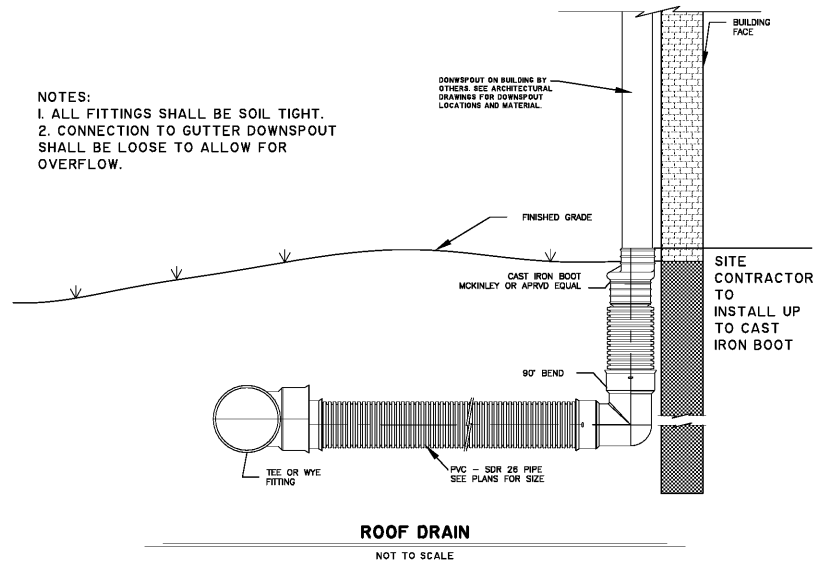

ROOF DRAIN
 NOT TO SCALE

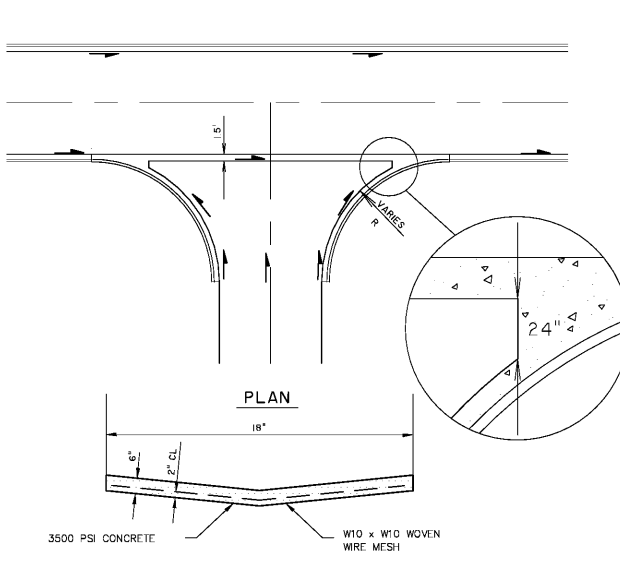

18" CONCRETE VALLEY GUTTER DETAIL
 NOT TO SCALE

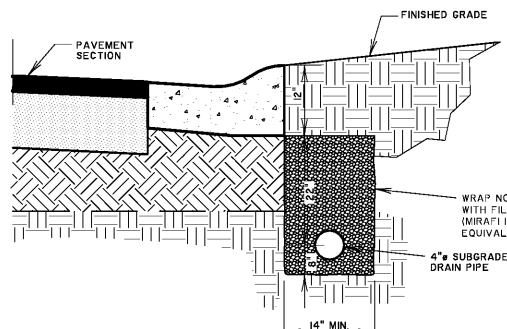

NOTES:
 1. 4" PIPE SHALL BE ADS 4" PERFORATED TUBING OR APPROVED EQUIVALENT WITH SOCK.
 2. GRANULAR BACKFILL SHALL BE NO. 57 GRANITE STONE OR ALTERNATE APPROVED BY OWNER SELECTED GEOTECHNICAL ENGINEER. IT SHALL BE PLACED DIRECTLY AGAINST THE CURB.
 3. SUBGRADE SHALL BE INSTALLED CONTINUOUSLY ALONG THE BACK OF CURB.

SUBGRADE DRAIN DETAIL
 NOT TO SCALE

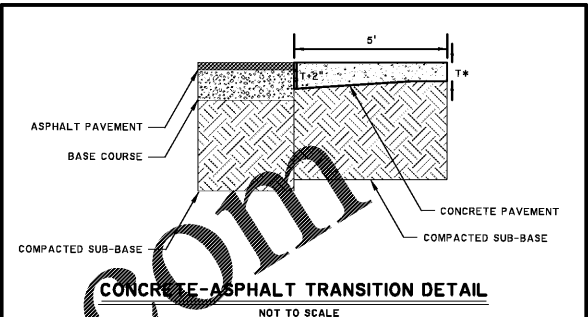

CONCRETE-ASPHALT TRANSITION DETAIL
 NOT TO SCALE

P26
 OCT. 2008
 THOMAS & HUTTON
 ENGINEERING CO.

NOTE:
 REFER TO PAVEMENT SECTION DETAIL FOR THICKNESS (T*) OF CONCRETE PAVEMENT

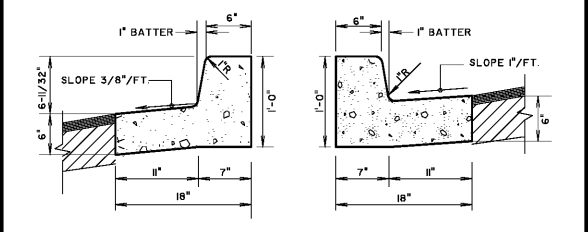

PITCH CURB **NORMAL CURB**

NOTES:
 1. ALL CONCRETE SHALL BE 3,000 PSI.
 2. PROVIDE CONTROL JOINTS EVERY TEN FEET (10').
 3. PROVIDE EXPANSION JOINTS EVERY FIFTY FEET (50').
 4. PROVIDE EXPANSION JOINT WHERE CURB ABUTS SIDEWALKS, OR OTHER STRUCTURES.
 5. PROVIDE LIGHT BROOM FINISH.

P17
 OCT. 2008
 THOMAS & HUTTON
 ENGINEERING CO.

18" STANDARD CURB & GUTTER
 NOT TO SCALE

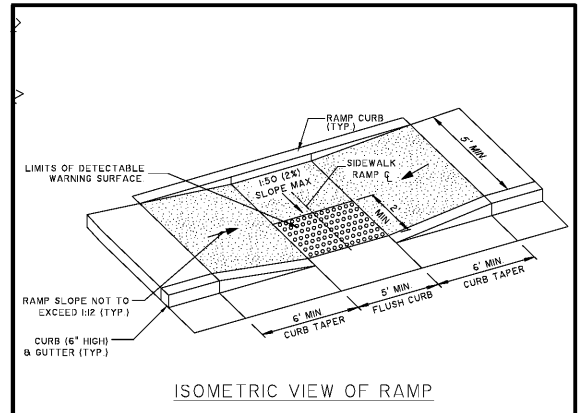

ISOMETRIC VIEW OF RAMP

NOTES:
 1. CONSTRUCTION OF ACCESSIBLE CURB RAMP SHALL CONFORM TO ALL APPLICABLE FEDERAL, STATE AND LOCAL CODES AND ORDINANCES.
 2. TRANSITIONS FROM RAMPS TO WALKS, CUTTERS, OR STREETS SHALL BE FLUSH AND FREE OF ABRUPT CHANGES. MAXIMUM SLOPES OF ADJOINING GUTTERS, ROAD SURFACE IMMEDIATELY ADJACENT TO THE CURB RAMP, OR ACCESSIBLE ROUTE SHALL NOT EXCEED 1:20 (5%).
 3. CURB RAMP SHALL HAVE A DETECTABLE WARNING THAT EXTENDS THE FULL WIDTH OF CURB RAMP. SEE DETECTABLE WARNING DETAIL.

CURB RAMP "TYPE B"
 NOT TO SCALE

A1.2
 FEB. 2009
 THOMAS & HUTTON
 ENGINEERING CO.

REFERENCES
 NATIONAL DOCUMENTS
 REVISED DRAFT SPECIFICATIONS FOR PAVEMENTS FOR AIRPORTS - NOVEMBER, 2005
 UNIFORM CODES
 SCDOT DOCUMENTS
 SCDOT STANDARD PLAN
 SCDOT-91
 RELATED DRAWINGS & REFERENCES
 THIS DRAWING IS ONLY VALID FOR CONSTRUCTION WHEN SEALS AND SIGNED BY A PROFESSIONAL ENGINEER REGISTERED IN THE STATE OF SOUTH CAROLINA. CHECK WWW.SCDOT.ORG FOR LATEST UPDATE.

SCDOT
 SOUTH CAROLINA DEPARTMENT OF TRANSPORTATION
 DESIGN STANDARDS OFFICE
 1005 PARK STREET
 COLUMBIA, SC 29901

STANDARD DRAWING
 PEDESTRIAN RAMP
 CONDENSED
 TERMINAL
 (PARALLEL RAMP)

720-952-11
 REVISIONS: SEE SHEET 2012

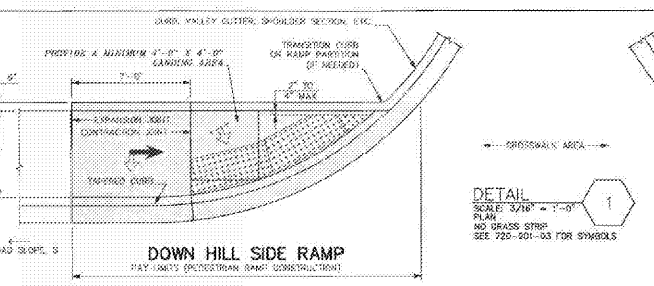

DOWN HILL SIDE RAMP
 (SEE TABLE 720-952-11 FOR SYMBOLS)

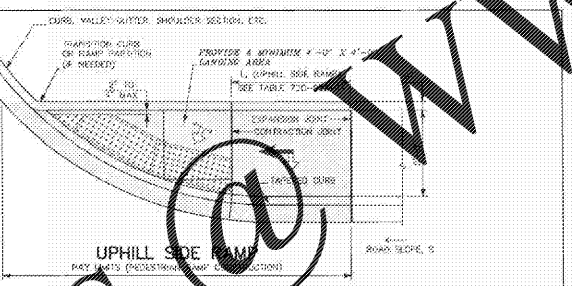

UPHILL SIDE RAMP
 (SEE TABLE 720-952-11 FOR SYMBOLS)

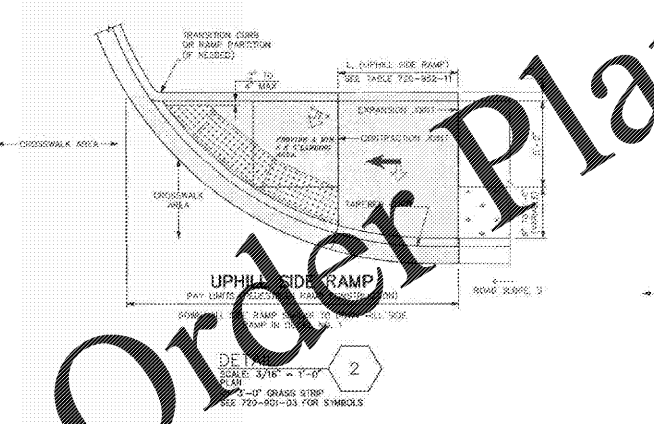

UPHILL SIDE RAMP
 (SEE TABLE 720-952-11 FOR SYMBOLS)

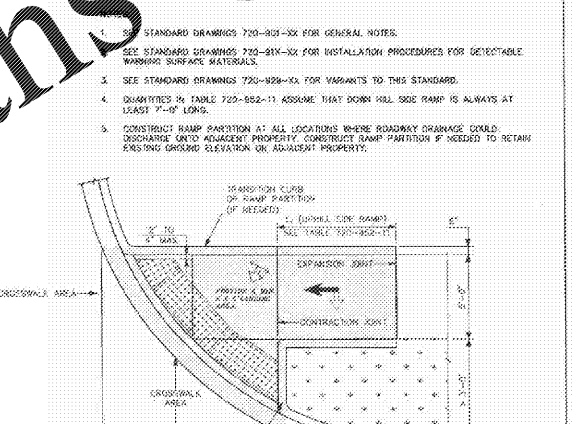

UPHILL SIDE RAMP
 (SEE TABLE 720-952-11 FOR SYMBOLS)

ROAD SLOPE, S (%)	ELEVATION, [ft]	L, (UPHILL SIDE RAMP), [ft]	QTY. STANDARD SYMBOLS
0 - 1%	[8-A] ≤ 26"	7'-0"	32
1% - 5% < 3%	[9-A] ≤ 48"	10'-0"	36
5 - 3%	[9-A] > 48"	15'-0"	41

DETAIL
 SCALE: 3/16" = 1'-0"
 PLAN
 3'-0" GRASS STRIP
 SEE 720-901-03 FOR SYMBOLS

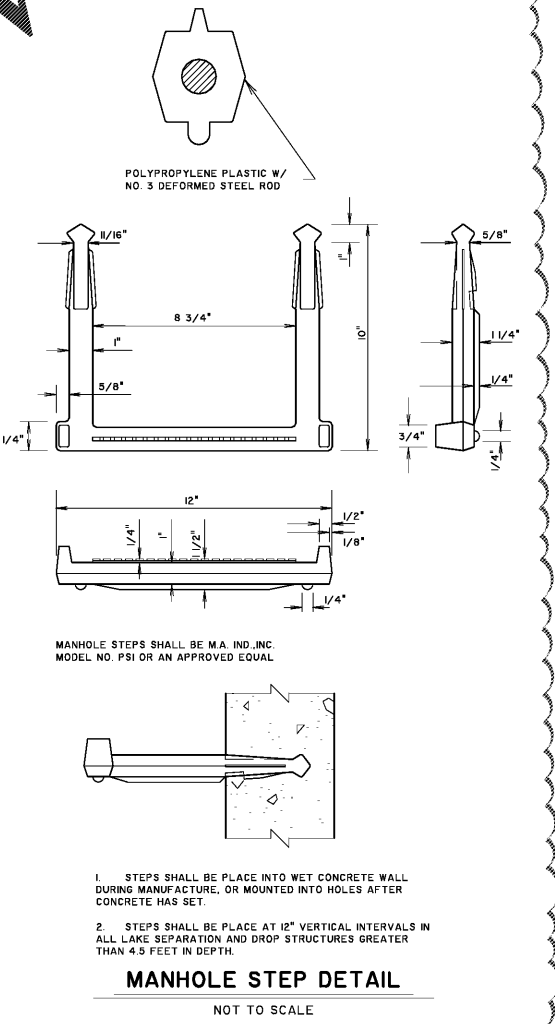

MANHOLE STEPS SHALL BE M.A. INC. MODEL NO. PSI OR AN APPROVED EQUAL

MANHOLE STEP DETAIL
 NOT TO SCALE

1. STEPS SHALL BE PLACED INTO WET CONCRETE WALL DURING MANUFACTURE, OR MOUNTED INTO HOLES AFTER CONCRETE HAS SET.
 2. STEPS SHALL BE PLACED AT 12" VERTICAL INTERVALS IN ALL LAKE SEPARATION AND DROP STRUCTURES GREATER THAN 4.5 FEET IN DEPTH.

Order Plans @ WWW.LDILine.com

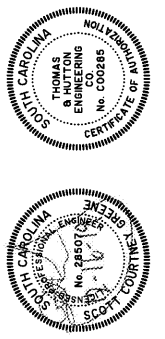

NO.	REVISED PER BERKELEY COUNTY COMMENTS	CAE	DATE

THOMAS & HUTTON
 682 Johnnie Dodds Boulevard • Suite 100
 Mt. Pleasant, SC 29464 • 843.849.0200
 www.thomasandhutton.com

PAVILION DEVELOPMENT COMPANY
 BERKELEY COUNTY, SOUTH CAROLINA

FIRESTONE SITE DEVELOPMENT
 PAVING, GRADING, AND DRAINAGE DETAILS

JOB NO:	J-23390.8120
DATE:	10/04/19
DRAWN:	JEA
DESIGNED:	CAE
REVIEWED:	SCG
APPROVED:	SCG
SCALE:	1" = 1'

C3.5

PERMIT SET - FOR REVIEW PURPOSES ONLY