

RENOVATION AND  
ADDITION FOR  
**ABERDEEN  
POLICE  
DEPARTMENT**



FIRST FLOOR  
SYSTEMS PLAN -  
NEW CONSTRUCTION

DATE: 10/25/2019  
PROJECT NO: 18062

REVISIONS

NO.	DATE	DESCRIPTION

THIS DRAWING IS THE PROPERTY OF ADW ARCHITECTS, P.A. AND SHALL NOT BE REPRODUCED OR COPIED IN WHOLE OR PART. IT SHALL NOT BE USED ON ANY OTHER PROJECT OR GIVEN TO ANY OTHER COMPANY OR AGENCY WITHOUT THE CONSENT OF ADW ARCHITECTS, P.A.

SHEET NUMBER

**E301**

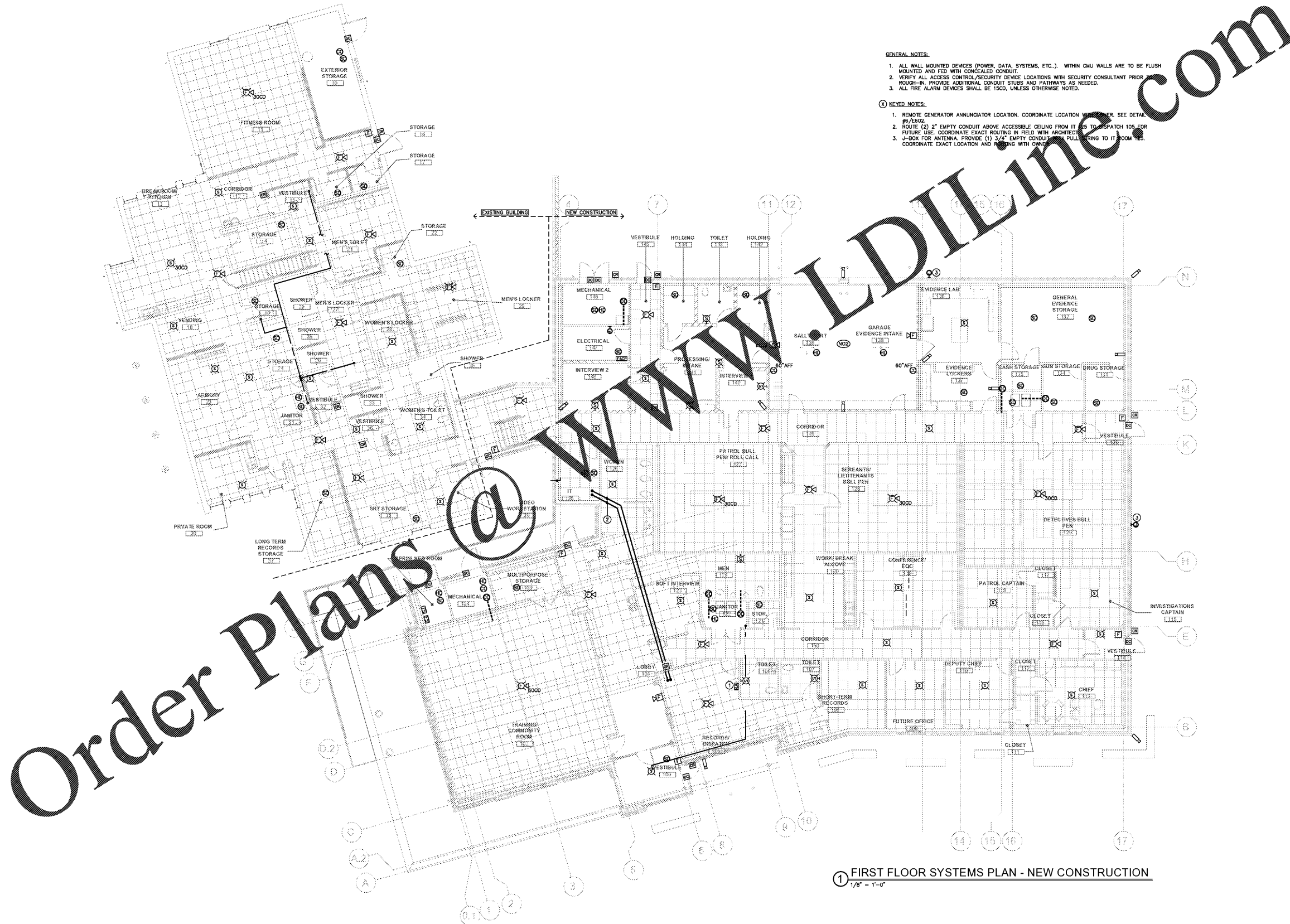

- GENERAL NOTES:**
1. ALL WALL MOUNTED DEVICES (POWER, DATA, SYSTEMS, ETC.) WITHIN CMU WALLS ARE TO BE FLUSH MOUNTED AND FED WITH CONCEALED CONDUIT.
  2. VERIFY ALL ACCESS CONTROL/SECURITY DEVICE LOCATIONS WITH SECURITY CONSULTANT PRIOR TO CONSTRUCTION. PROVIDE ADDITIONAL CONDUIT STUBS AND PATHWAYS AS NEEDED.
  3. ALL FIRE ALARM DEVICES SHALL BE 15CD, UNLESS OTHERWISE NOTED.
- KEYED NOTES:**
1. REMOVE GENERATOR ANNUNCIATOR LOCATION. COORDINATE LOCATION WITH OWNER. SEE DETAIL #10/1002.
  2. ROUTE (2) 2" EMPTY CONDUIT ABOVE ACCESSIBLE CEILING FROM IT 25 TO DISPATCH 105 FOR FUTURE USE. COORDINATE EXACT ROUTING IN FIELD WITH ARCHITECT.
  3. J-BOX FOR ANTENNA. PROVIDE (1) 3/4" EMPTY CONDUIT FROM HALLWAY TO IT 25 ROOM YES. COORDINATE EXACT LOCATION AND ROUTING WITH OWNER.

**1 FIRST FLOOR SYSTEMS PLAN - NEW CONSTRUCTION**  
1/8" = 1'-0"