

RENOVATION AND
ADDITION FOR
**ABERDEEN
POLICE
DEPARTMENT**

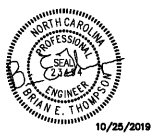

**MEZZANINE
POWER PLAN –
NEW CONSTRUCTION**

DATE: 10/25/2019
PROJECT NO: 18062

REVISIONS

NO.	DATE	DESCRIPTION

THIS DRAWING IS THE PROPERTY OF ADW ARCHITECTS, P.A. AND SHALL NOT BE REPRODUCED OR COPIED IN WHOLE OR PART. IT SHALL NOT BE USED ON ANY OTHER PROJECT OR GIVEN TO ANY OTHER COMPANY OR AGENCY WITHOUT THE CONSENT OF ADW ARCHITECTS, P.A.

SHEET NUMBER
E202
7 OF 18
OPT/MA # 18-0292

Order Plans @ www.LDOnline.com

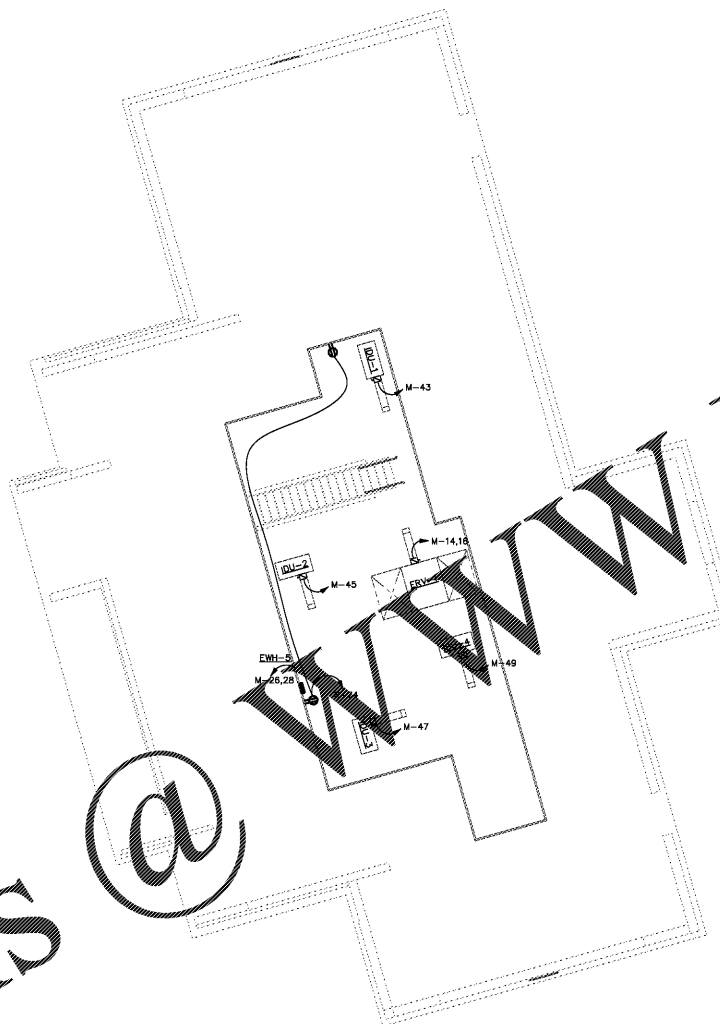

- GENERAL NOTES:**
1. ALL WALL MOUNTED DEVICES (PHONE, DATA, SYSTEMS, ETC.) WITHIN OFF WALLS ARE TO BE FLUSH MOUNTED AND FED WITH CONCEALED CONDUIT.
 2. J-BOXES IN SPACES WITH GYP. BOARD CEILING SHOULD HAVE AN ACCESS PANEL PROVIDED OR BE LOCATED IN ACCESS SPACE WITH LAY-IN CEILING.
 3. REFER TO MECHANICAL CONNECTION SCHEDULES FOR EQUIPMENT CONNECTION DETAILS. COORDINATE EXACT LOCATION OF MECHANICAL EQUIPMENT WITH MECHANICAL DRAWINGS.

① **MEZZANINE POWER PLAN - NEW CONSTRUCTION**
1/8" = 1'-0"