

UTILITY XFMR CLEARANCES FROM BUILDINGS AND BUILDING OPENINGS			
TYPE OF CONSTRUCTION	CLEARANCE EXTENDING OUT FROM BUILDING	SIDE CLEARANCE	HEIGHT CLEARANCE
COMBUSTIBLE	12 FT	--	--
NON-COMBUSTIBLE	6 FT	--	--
DOORS	20 FT	10 FT	--
WINDOWS	10 FT	8 FT	10 FT
AIR VENTS	20 FT	10 FT	25 FT

- NOTE:
- DISTANCES ARE FROM THE PAD OR TRANSFORMER WHICHEVER IS CLOSER TO THE BUILDING OR OPENING.
 - A MINIMUM CLEAR WORKING SPACE OF 3 FT. MUST BE MAINTAINED FROM EACH SIDE OF THE TRANSFORMER AND A MINIMUM OF 10 FT. FROM THE FRONT.

UTILITY XFMR CLEARANCES FROM EQUIPMENT	
TYPE OF EQUIPMENT	MINIMUM DISTANCE
FUEL OR GAS DISPENSERS	20 FT
CONTAINERS OF FLAMMABLE LIQUIDS OR GAS, (OXYGEN, LP, GASOLINE, ETC.)	10 FT
GENERATORS OR CUSTOMER OWNED TRANSFORMERS	10 FT
FIRE HYDRANTS, SPRINKLER VALVES, STANDPIPES, ETC.	4 FT
NATURAL GAS METERS	3 FT

- NOTE:
- DISTANCES ARE FROM THE PAD OR TRANSFORMER WHICHEVER IS CLOSER TO THE BUILDING OR OPENING.
 - A MINIMUM CLEAR WORKING SPACE OF 3 FT. MUST BE MAINTAINED FROM EACH SIDE OF THE TRANSFORMER AND A MINIMUM OF 10 FT. FROM THE FRONT.

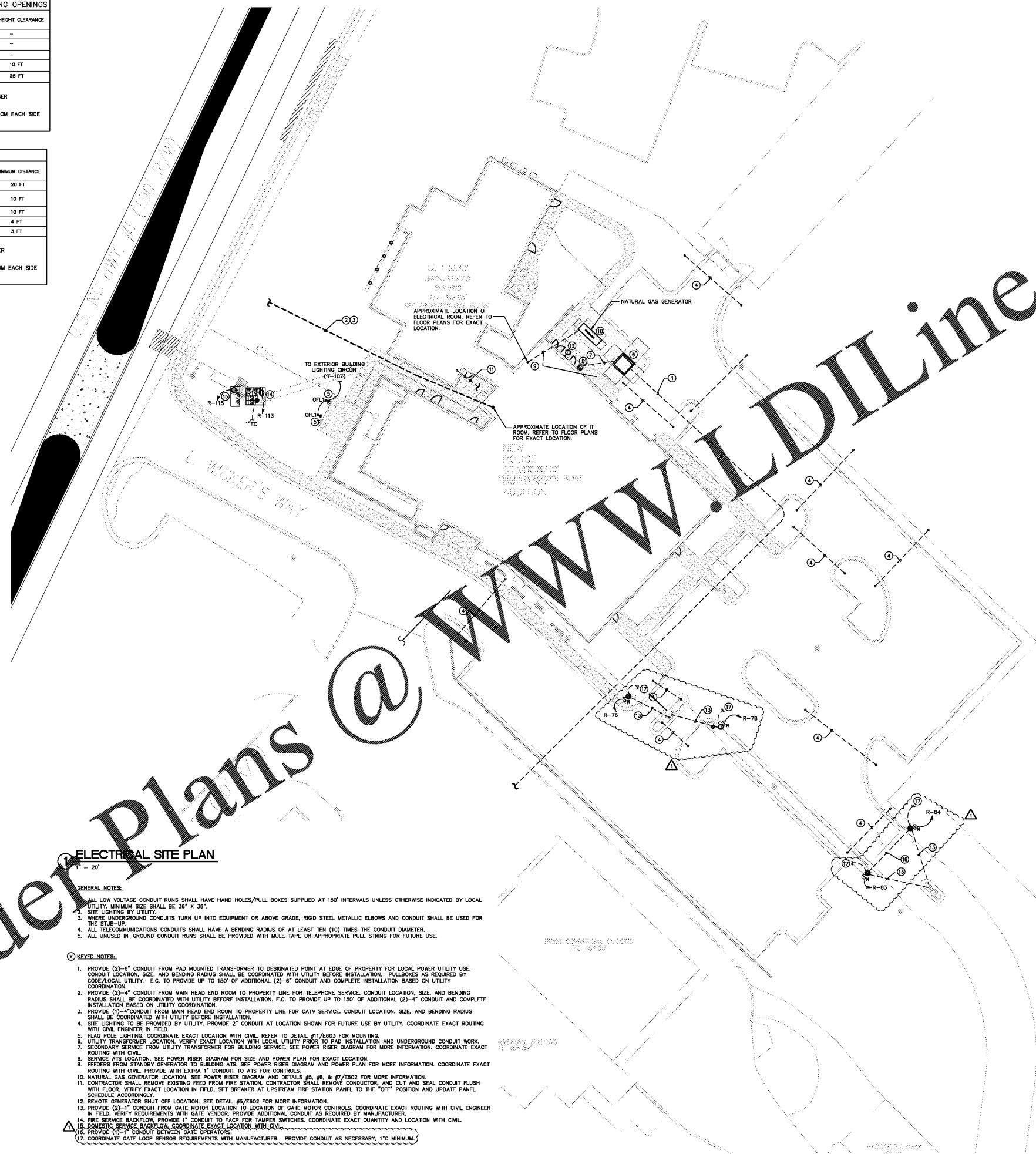

ELECTRICAL SITE PLAN
1" = 20'

- GENERAL NOTES:
- ALL LOW VOLTAGE CONDUIT RUNS SHALL HAVE HAND HOLES/PULL BOXES SUPPLIED AT 150' INTERVALS UNLESS OTHERWISE INDICATED BY LOCAL UTILITY. MINIMUM SIZE SHALL BE 3/8" X 3/8".
 - SITE LIGHTING BY UTILITY.
 - WHERE UNDERGROUND CONDUITS TURN UP INTO EQUIPMENT OR ABOVE GRADE, RIGID STEEL METALLIC ELBOWS AND CONDUIT SHALL BE USED FOR THE STUB-UP.
 - ALL TELECOMMUNICATIONS CONDUITS SHALL HAVE A BENDING RADIUS OF AT LEAST TEN (10) TIMES THE CONDUIT DIAMETER.
 - ALL UNUSED IN-GROUND CONDUIT RUNS SHALL BE PROVIDED WITH MULE TAPE OR APPROPRIATE PULL STRING FOR FUTURE USE.
- KEYED NOTES:
- PROVIDE (2)-6" CONDUIT FROM PAD MOUNTED TRANSFORMER TO DESIGNATED POINT AT EDGE OF PROPERTY FOR LOCAL POWER UTILITY USE. CONDUIT LOCATION, SIZE, AND BENDING RADIUS SHALL BE COORDINATED WITH UTILITY BEFORE INSTALLATION. PULLBOXES AS REQUIRED BY CODE/LOCAL UTILITY. E.C. TO PROVIDE UP TO 150' OF ADDITIONAL (2)-6" CONDUIT AND COMPLETE INSTALLATION BASED ON UTILITY COORDINATION.
 - PROVIDE (2)-4" CONDUIT FROM MAIN HEAD END ROOM TO PROPERTY LINE FOR TELEPHONE SERVICE. CONDUIT LOCATION, SIZE, AND BENDING RADIUS SHALL BE COORDINATED WITH UTILITY BEFORE INSTALLATION. E.C. TO PROVIDE UP TO 150' OF ADDITIONAL (2)-4" CONDUIT AND COMPLETE INSTALLATION BASED ON UTILITY COORDINATION.
 - PROVIDE (1)-4" CONDUIT FROM MAIN HEAD END ROOM TO PROPERTY LINE FOR CATV SERVICE. CONDUIT LOCATION, SIZE, AND BENDING RADIUS SHALL BE COORDINATED WITH UTILITY BEFORE INSTALLATION.
 - SITE LIGHTING TO BE PROVIDED BY UTILITY. PROVIDE 2" CONDUIT AT LOCATION SHOWN FOR FUTURE USE BY UTILITY. COORDINATE EXACT ROUTING WITH CIVIL ENGINEER IN FIELD.
 - FLAG POLE LIGHTING. COORDINATE EXACT LOCATION WITH CIVIL. REFER TO DETAIL #11/E603 FOR MOUNTING.
 - UTILITY TRANSFORMER LOCATION. VERIFY EXACT LOCATION WITH LOCAL UTILITY PRIOR TO PAD INSTALLATION AND UNDERGROUND CONDUIT WORK.
 - SECONDARY SERVICE FROM UTILITY TRANSFORMER FOR BUILDING SERVICE. SEE POWER RISER DIAGRAM FOR MORE INFORMATION. COORDINATE EXACT ROUTING WITH CIVIL.
 - SERVICE ATS LOCATION. SEE POWER RISER DIAGRAM FOR SIZE AND POWER PLAN FOR EXACT LOCATION.
 - FEEDERS FROM STANDBY GENERATOR TO BUILDING ATS. SEE POWER RISER DIAGRAM AND POWER PLAN FOR MORE INFORMATION. COORDINATE EXACT ROUTING WITH CIVIL. PROVIDE WITH EXTRA 1" CONDUIT TO ATS FOR CONTROLS.
 - NATURAL GAS GENERATOR LOCATION. SEE POWER RISER DIAGRAM AND DETAILS #5, #6, & #7/E602 FOR MORE INFORMATION.
 - CONTRACTOR SHALL REMOVE EXISTING FEED FROM FIRE STATION. CONTRACTOR SHALL REMOVE CONDUCTOR, AND CUT AND SEAL CONDUIT FLUSH WITH FLOOR. VERIFY EXACT LOCATION IN FIELD. SET BREAKER AT UPSTREAM FIRE STATION PANEL TO THE "OFF" POSITION AND UPDATE PANEL SCHEDULE ACCORDINGLY.
 - REMOTE GENERATOR SHUT OFF LOCATION. SEE DETAIL #5/E602 FOR MORE INFORMATION.
 - PROVIDE (2)-1" CONDUIT FROM GATE MOTOR LOCATION TO LOCATION OF GATE MOTOR CONTROLS. COORDINATE EXACT ROUTING WITH CIVIL ENGINEER IN FIELD. VERIFY REQUIREMENTS WITH GATE VENDOR. PROVIDE ADDITIONAL CONDUIT AS REQUIRED BY MANUFACTURER.
 - FIRE SERVICE BACKFLOW. PROVIDE 1" CONDUIT TO FACP FOR TAMPER SWITCHES. COORDINATE EXACT QUANTITY AND LOCATION WITH CIVIL.
 - DOMESTIC SERVICE BACKFLOW. COORDINATE EXACT LOCATION WITH CIVIL.
 - PROVIDE (1)-1" CONDUIT BETWEEN GATE OPERATORS.
 - COORDINATE GATE LOOP SENSOR REQUIREMENTS WITH MANUFACTURER. PROVIDE CONDUIT AS NECESSARY. 1" C MINIMUM.

Order Plans @ WWW.DILine.com



1927 South Tryon St., Suite 300, Charlotte, NC 28203
150 Fayetteville St., Suite 520, Raleigh, NC 27601
North Carolina License Number: C-0914

adwarchitects
environments for life
architecture planning interiors
2815 COLISEUM CENTRE DRIVE
SUITE 500
CHARLOTTE, NORTH CAROLINA 28211
P 704.379.1919
F 704.379.1920
www.adwarchitects.com

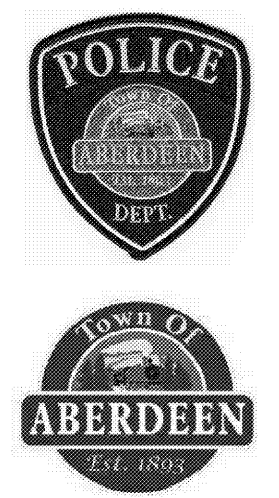

RENOVATION AND
ADDITION FOR
**ABERDEEN
POLICE
DEPARTMENT**



ELECTRICAL
SITE PLAN

DATE: 10/25/2019
PROJECT NO: 18062

REVISIONS		
NO.	DATE	DESCRIPTION
1	12/20/19	COORDINATION

THIS DRAWING IS THE PROPERTY OF ADW ARCHITECTS, P.A. AN
SHALL NOT BE REPRODUCED OR COPIED IN WHOLE OR PART. IT
SHALL NOT BE USED ON ANY OTHER PROJECT OR GIVEN TO ANY
OTHER COMPANY OR AGENCY WITHOUT THE CONSENT OF ADW
ARCHITECTS, P.A.

SHEET NUMBER
E010
2 OF 18
OPTIMA # 18-0262