

GENERAL SHEET NOTES

- ALL ARCHITECTURAL COMPONENTS ARE TO BE ATTACHED AS REQUIRED BY ASCE 7-05 CHAPTER 13 SEISMIC DESIGN FOR NONSTRUCTURAL COMPONENTS. EACH INDIVIDUAL CONTRACTOR RESPONSIBLE FOR THE COMPONENT MUST PROVIDE PROJECT SPECIFIC DESIGN AND DOCUMENTATION PREPARED BY A LICENSED ENGINEER. CHAPTER 13 DEFINES THE FORCE REQUIRED TO SUPPORT THE COMPONENT FOR THE ANCHORAGE AND BRACING. THE COST OF PREPARING THIS INFORMATION AND DESIGN SHALL BE INCLUDED IN EACH CONTRACTOR'S BID PROVIDING THE COMPONENT.
- FIELD VERIFY ALL CONDITIONS. GENERAL CONTRACTOR MUST NOTIFY ARCHITECT OF ANY DISCREPANCIES PRIOR TO START OF WORK AFFECTED BY SUCH DISCREPANCY.
- DO NOT SCALE DRAWINGS. IF DIMENSIONS ARE IN QUESTION, OBTAIN CLARIFICATION FROM ARCHITECT.
- PROVIDE ADDITIONAL BLOCKING WITHIN STUD WALLS AS REQUIRED FOR SUPPORT OF CABINETS, SHELVING, WALL STOPS, COUNTERTOPS, MARKERBOARDS, TACKBOARDS, AV EQUIPMENT AND SIMILAR.
- PLACE CONTROL JOINTS IN SIDEWALK AND PAVING PER MINIMUM REQUIREMENTS STATED IN CIVIL DOCUMENTS. GENERAL LAYOUT TO BE COORDINATED BY G.C.
- ALL INTERIOR DIMENSIONS ARE TO FACE OF STUD U.O. "CLEAR" DIMENSIONS ARE FROM FINISH FACE TO FINISH FACE.
- SEE SHEET A003 AND A101 FOR WALL TYPES, INTERIOR DIMENSIONS, AND OTHER INFORMATION NOT SHOWN ON THIS PLAN.
- CAREFULLY REVIEW PLANS AND COORDINATE ALL ELECTRICAL AND PLUMBING WORK WITH CMU WALLS. ALL CONDUIT WHERE CMU IS VISIBLE SHALL BE WITHIN THE CMU WALLS. SURFACE MOUNTED CONDUIT WILL BE ACCEPTED ONLY WHERE NOT VISIBLE AND COVERED UP BY OTHER FINISHES, OR SPECIFICALLY WHERE NOTED TO BE SURFACE MOUNTED.
- SEE SPECIFICATIONS FOR TACKBOARD AND STORAGE UNITS.
- PROVIDE 48" WIDE X 96" HIGH SANITARY WALL FINISH ON BOTH SIDES OF MCP SNK. INSTALL PER MANUFACTURER'S RECOMMENDATIONS.
- DURING CONSTRUCTION ALL REQUIREMENTS OF CHAPTER 14 OF THE NCCPC MUST BE MET.
- PORTABLE FIRE EXTINGUISHERS ARE REQUIRED ON SITE DURING CONSTRUCTION.
- COORDINATE WITH THE CITY OF ABERDEEN FIRE MARSHAL ON THE REQUIRED SIGNAGE REQUIREMENTS FOR ADDRESS NUMBERS. FIRE EXTINGUISHERS, SPRINKLER RISER, ELECTRICAL ROOM, SPRINKLER SYSTEM VALVE IDENTIFICATION, AND REQUIRED NFPA 704 PLACECARDS.
- FEC INDICATED SEMI-RECESSED FIRE EXTINGUISHER CABINET AND FIRE EXTINGUISHER. FE INDICATES BRACKER MOUNTED FIRE EXTINGUISHER. SEE SPECIFICATION 10.44.00. EXTINGUISHERS MUST BE TAGGED BY A LICENSED NORTH CAROLINA FIRE EXTINGUISHING COMPANY. FIRE EXTINGUISHERS MUST BE POSTED IN A VISIBLE, INCONSPICUOUS, UNOBSERVED, AND UNOBSURED LOCATION. MOUNTING HEIGHTS AND TRAVEL DISTANCES MUST COMPLY WITH REQUIREMENTS OF 2010 NCCPC SECTION 905. COORDINATE/VERIFY WITH AUTHORITY HAVING JURISDICTION.
- ALL NOTES ARE TYPICAL UNLESS NOTED OTHERWISE.
- ACCESS CONTROL LOCATION (AC), SEE A600 AND ELECTRICAL DRAWINGS FOR ADDITIONAL INFORMATION.
- COORDINATE AND ALIGN ALL FINISH FACES OF WALLS SO THAT THEY ALIGN - CONTRACTOR SHOULD ACCOUNT FOR EXTRA LAYERS OF GWB, STUD SIZE, AND FURRING.
- SEE A602 FOR WINDOW TYPES.
- CONTRACTOR TO PROVIDE AND COORDINATE INSTALLATION OF RECESSED KNOX BOX W/ ABERDEEN FIRE DEPARTMENT. LOCATE ON EXTERIOR WHERE INDICATED. COLOR SELECTED BY ARCHITECT.
- RECESSED TROPHY CASE - PROVIDE CLARIDGE 300 SERIES (BOD; CASE 395) - LARGE DOOR RECESSED DISPLAY CASE WITH 4" ANODIZED FRAME, 1/4" TEMPERED GLAZING, 12" GLASS SHELVING & INTEGRAL LIGHTING OR APPROVED SUBSTITUTE. SUBMIT FULL COLOR RANGE OF TACKABLE BACK PANEL FOR ARCHITECT'S SELECTION.
- PROVIDE 12" X 48" LOCKER BENCH.
- PROVIDE 20" X 42" H.C. ACCESSIBLE LOCKER BENCH.
- 18"W X 24"D X 72"H PERSONNEL LOCKERS, SINGLE TIER WITH 4" 2" BASE CLOSURE.

WALL TYPE LEGEND:

	NEW STUD WALLS
	NEW CMU WALLS
	EXISTING STUD WALLS
	EXISTING CMU WALLS

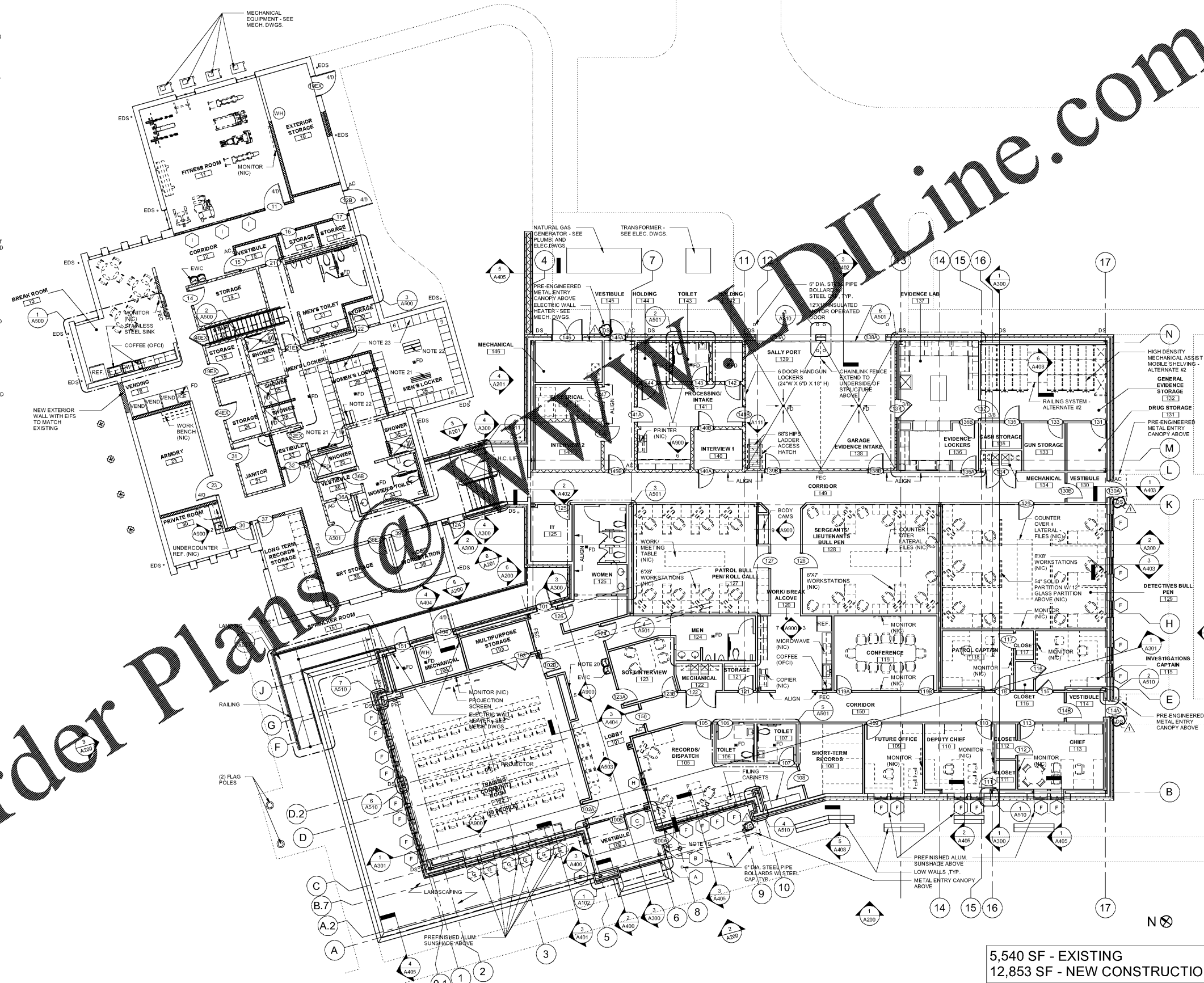

5,540 SF - EXISTING
12,853 SF - NEW CONSTRUCTION

FIRST FLOOR PLAN 1/8" = 1'-0" 1

adwarchitects
environments for life

architecture planning interiors

2815 COLISEUM CENTRE DRIVE
SUITE 500
CHARLOTTE, NORTH CAROLINA 28217
P 704.379.1919
F 704.379.1920
www.adwarchitects.com



A NEW POLICE FACILITY FOR
ABERDEEN POLICE DEPARTMENT

804 N. Sandhills Blvd.
Aberdeen, NC 28315

FLOOR PLAN - NEW CONSTRUCTION

DATE: 11-22-2019
PROJECT NO: 18062

REVISIONS

NO.	DATE	DESCRIPTION
1	12.20.19	COORDINATION

THIS DRAWING IS THE PROPERTY OF ADW ARCHITECTS, P.A. AND SHALL NOT BE REPRODUCED OR COPIED IN WHOLE OR PART. IT SHALL NOT BE USED ON ANY OTHER PROJECT OR GIVEN TO ANY OTHER COMPANY OR AGENCY WITHOUT THE CONSENT OF ADW ARCHITECTS, P.A.

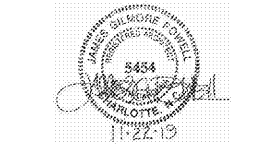

SHEET NUMBER

A100