

PLUMBING FIXTURE COUNT:	
TOTAL OCCUPANTS: 383 PER PLAN	
PER NC STATE BUILDING CODE TABLE 201.1 A.3.1.8. and S-2 OCCUPANCY	
A-3 - ASSEMBLY:	
WC (MALES) = 1 PER 125	
WC (FEMALES) = 1 PER 65	
LAV (MALES) = 1 PER 200	
LAV (FEMALES) = 1 PER 200	
DRINKING FOUNTAIN = 1 PER 500	
1 SERVICE SINK	
S - BUSINESS:	
WC (MALES) = 1 PER 25	
WC (FEMALES) = 1 PER 25	
LAV (MALES) = 1 PER 40	
LAV (FEMALES) = 1 PER 40	
DRINKING FOUNTAIN = 1 PER 100	
1 SERVICE SINK	
S-2 - STORAGE:	
WC (MALES) = 1 PER 100	
WC (FEMALES) = 1 PER 100	
LAV (MALES) = 1 PER 100	
LAV (FEMALES) = 1 PER 100	
DRINKING FOUNTAIN = 1 PER 1,000	
1 SERVICE SINK	
PROVIDED:	
WC (MALES) = 3	
WC (FEMALES) = 5	
WC (UNISEX) = 3	
LAV (MALES) = 4	
LAV (FEMALES) = 4	
LAV (UNISEX) = 3	
DRINKING FOUNTAINS = 2 REG./2 ACC.	

LIFE SAFETY PLAN LEGEND:	
--->	REQUIRED DISTANCE BETWEEN DOORS
○	n = MAXIMUM NUMBER OF OCCUPANTS, CALCULATED PER TABLE 1004.1.2
[Diagonal Hatching]	ASSEMBLY (A-3) OCCUPANCY
[Cross-hatching]	BUSINESS (B) OCCUPANCY
[Vertical Hatching]	STORAGE (S-2) OCCUPANCY

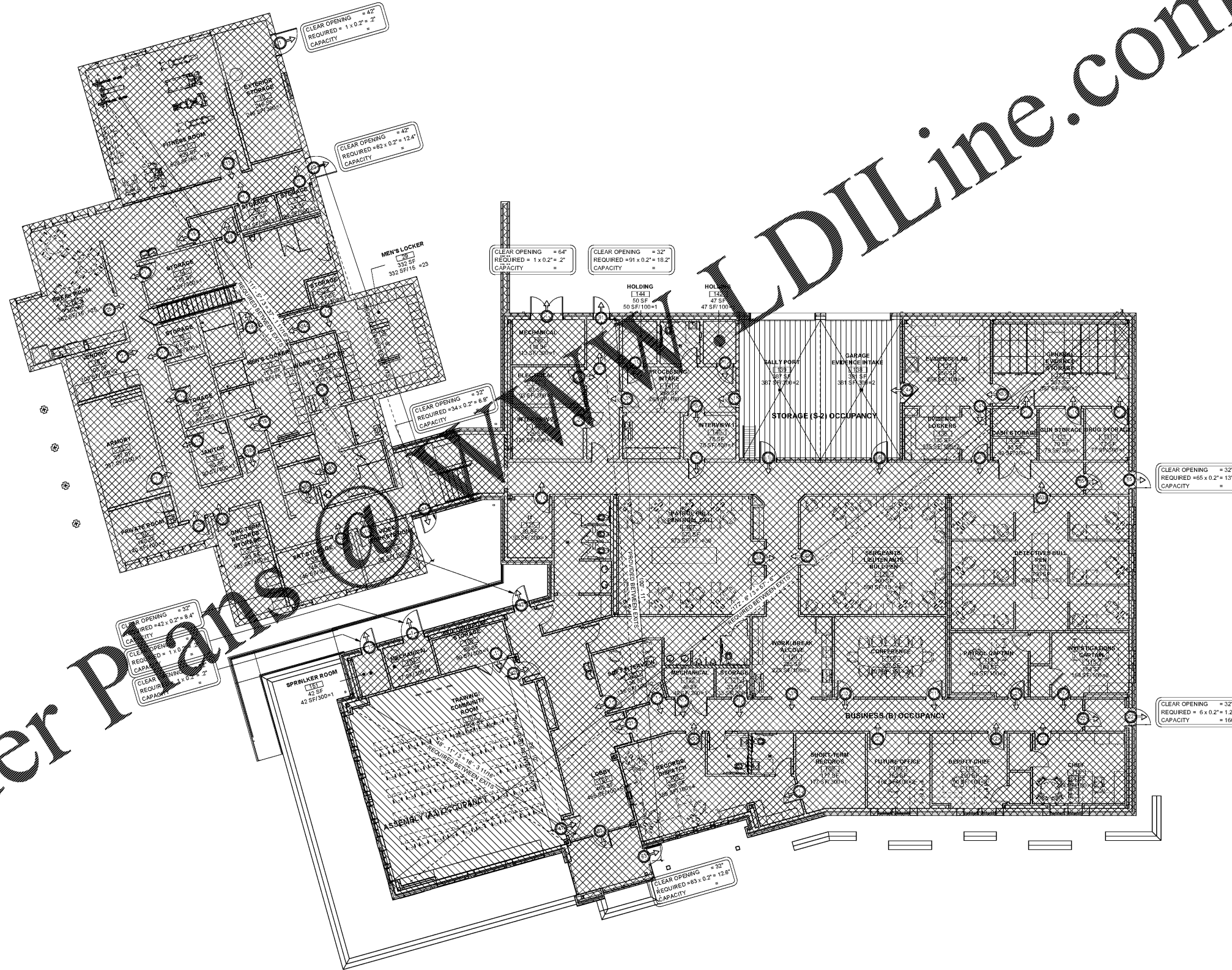

Order Plans @ WWW.LDILine.com

5,540 SF - EXISTING  
12,853 SF - NEW CONSTRUCTION

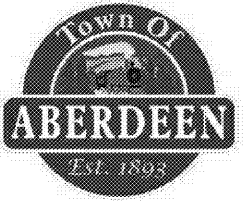

A NEW POLICE FACILITY FOR  
**ABERDEEN POLICE DEPARTMENT**

804 N. Sandhills Blvd.  
Aberdeen, NC 28315

LIFE SAFETY PLAN

DATE: 11-22-2019  
PROJECT NO: 18062

REVISIONS		
NO.	DATE	DESCRIPTION

THIS DRAWING IS THE PROPERTY OF ADW ARCHITECTS, P.A. AND SHALL NOT BE REPRODUCED OR COPIED IN WHOLE OR PART. IT SHALL NOT BE USED ON ANY OTHER PROJECT OR GIVEN TO ANY OTHER COMPANY OR AGENCY WITHOUT THE CONSENT OF ADW ARCHITECTS, P.A.

