

These drawings are instruments of service and as such remain the property of the architect. No copies or reproductions of these drawings are permitted without the consent of the architect. Upon completion of the work all the drawings (except the contract copies) are to be returned to the architect.
Copyright © 2019



1920 Hwy. 54, Suite 700, Durham, NC 27713
Ph. 919-544-1936 - Fax 919-544-2540 - License: C-1813

PLUMBING GENERAL NOTES:

1. ALL WATER AND VENT PIPING SHALL BE INSTALLED ABOVE CEILING OR IN CHASE WALLS U.N.O.
2. ALL WASTE PIPING SHALL BE INSTALLED BELOW FLOOR OR SLAB U.N.O.
3. COORDINATE ALL WASTE, VENT, AND WATER PIPING WITH OTHER TRADES PRIOR TO INSTALLATION.
4. SET FLOOR DRAINS 1/2" LOWER THAN FINISHED FLOOR ELEVATION.
5. PROVIDE ALL OFFSETS IN PIPING AS REQUIRED TO AVOID STRUCTURE AND MECHANICAL EQUIPMENT ABOVE CEILING.
6. ALL ABOVE CEILING PLUMBING PIPING SHALL BE INSTALLED TIGHT TO STRUCTURE WHERE POSSIBLE. ALL NEG. CHANGES IN ELEVATIONS OF PIPING NOT SHOWN SHALL BE PROVIDED AS PART OF THE CONTRACT DUE TO FIELD COORDINATION WITH OTHER TRADES.
7. THE LOCATION OF BALL VALVES SHALL BE COORDINATED WITH OTHER TRADES. VALVES SHALL BE INSTALLED IN AN ACCESSIBLE LOCATION WITHIN 12" ABOVE CEILING.
8. ALL PLUMBING PIPING SHALL REMAIN CAPPED DURING ROUGH-IN INSTALLATIONS.
9. ALL WORK SHALL CONFORM TO THE REQUIREMENTS OF THE NORTH CAROLINA STATE BUILDING CODE AND LOCAL CODES. THIS WORK SHALL INCLUDE CLEANOUTS, AND VACUUM BREAKERS REQUIRED FOR A COMPLETE OPERATIONAL PLUMBING SYSTEM. PROVISION OF THESE ITEMS SHALL BE PROVIDED IN THIS CONTRACT AT NO ADDITIONAL COST TO THE OWNER.
10. ALL PIPING PENETRATIONS THROUGH RATED FLOOR AND PARTITIONS/WALLS SHALL BE SEALED IN ACCORDANCE WITH THE PROPER UL LISTED SYSTEMS. ALL PENETRATIONS THROUGH NON-RATED WALLS SHALL BE SEALED TO PREVENT SOUND TRANSFER USING GULK OF SHEETROCK MUD.
11. ALL PLUMBING WATER PIPING INSTALLED IN OR PENETRATING BLOCK WALLS SHALL BE INSULATED WITH MINIMUM 1/2" ARMAFLEX INSULATION WITH ALL JOINTS SEALED BY PROPER ADHESIVE.
12. THIS CONTRACTOR SHALL BE RESPONSIBLE FOR CORE DRILLING, CONCRETE CUTTING, AND REMOVAL. FIELD VERIFY EXISTING BELOW SLAB PIPING PRIOR TO CUTTING CONCRETE FOR DEMOLITION AND NEW WORK INSTALLATION. SEE DEMOLITION PLANS FOR APPROXIMATE LOCATION OF CONCRETE CUTTING.

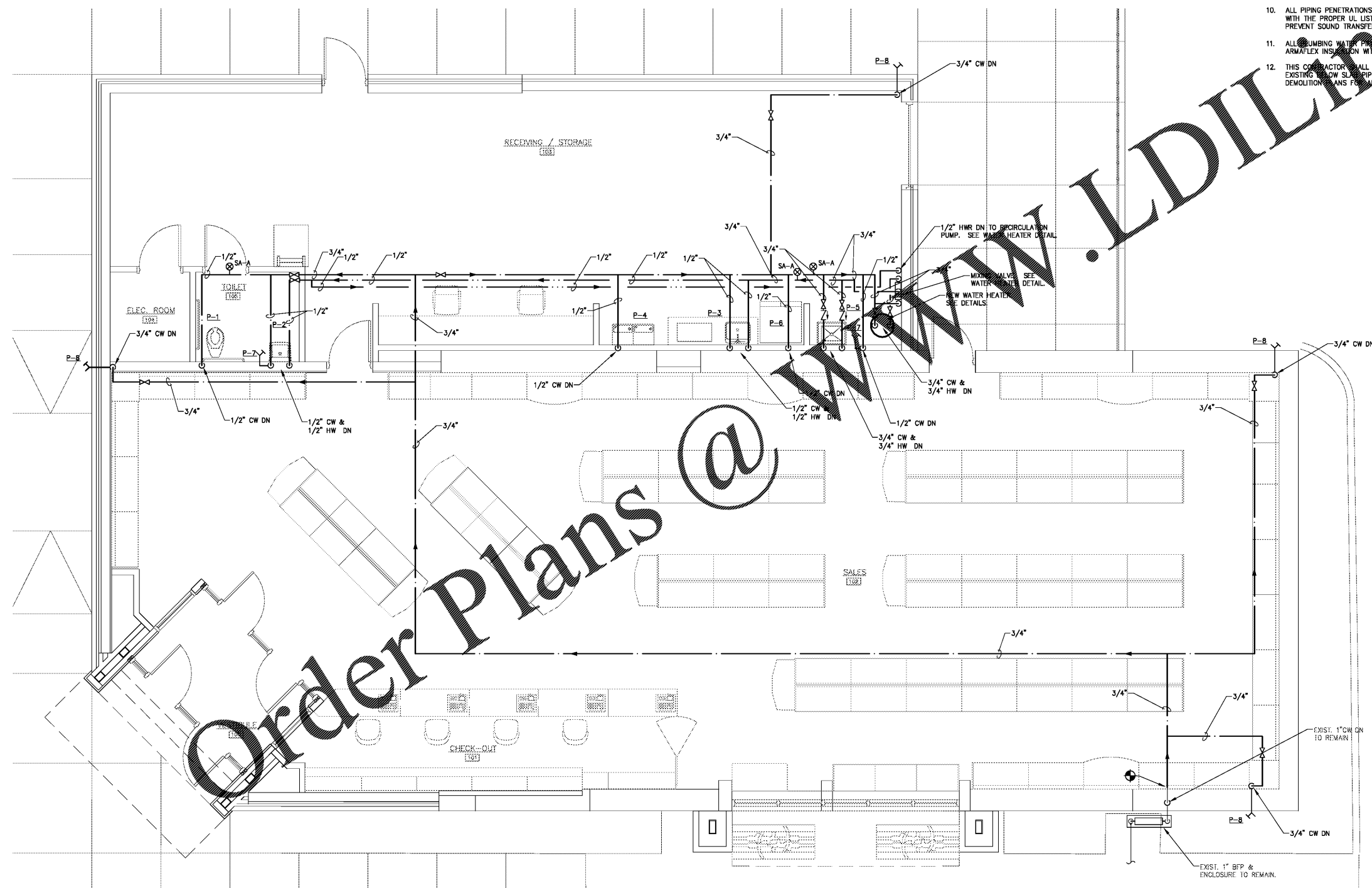

Order Plans @

1 Plumbing Renovation Plan
P2.2 SCALE: 1/4" = 1'-0" Water

RENOVATIONS TO:

ABC STORE

HOLLOWAY ST. DURHAM, NC

PROJECT NUMBER 19-063

Plumbing Renovation Plan

DTW
Architects & Planners, Ltd.
229 North Gregson Street
Durham, NC 27701
919.317.4020

CONSTRUCTION DOCUMENTS

Revisions

Drawn LDH
Checked CTC
Date 12/18/2019
Sheet

P2.2



P:\PROJECTS\19-063 ABC STORE - HOLLOWAY ST. DTW ARCHITECTS & PLANNERS, LTD. DATE PLOTTED: 12/18/2019 2:02 PM BY: BARBARA HESTER