

These drawings are instruments of service and as such remain the property of the architect. No copies or reproductions of these drawings are permitted without the consent of the architect. Upon completion of the work all the drawings (except the contract copies) are to be returned to the architect.
Copyright © 2019

GENERAL ROOF NOTES:

- EQUIPMENT SIZE AND LOCATION SHOWN FOR REFERENCE ONLY. CONTRACTOR TO VERIFY SIZE, LOCATION AND QUANTITY OF ALL PENETRATIONS.
- PROVIDE CRICKETS AT ALL ROOFTOP EQUIPMENT AND PENETRATIONS OTHER THAN PIPES, MINIMUM SLOPE 1" PER FT
- CONTRACTOR TO COORDINATE ALL CURB PLACEMENT. PROVIDE ALL STEEL REQUIRED AND COORDINATE ALL PENETRATIONS. ALL CURBS SHALL HAVE A MINIMUM OF 8" FLASHING HEIGHT ABOVE THE ROOF.
- ALL NEW FASTENERS INTO TREATED WOOD TO BE GALVANIZED OR STAINLESS STEEL. SEE SPECIFICATIONS
- COORDINATE ROOF DRAIN INSTALL WITH STRUCTURE AND PLUMBING CONTRACTOR. ROOF DRAINS SHALL BE SUPPLIED BY ROOFING CONTRACTOR.
- ALL HOLES IN ROOF DECKING CREATED FOR REMOVAL OF OLD EQUIPMENT, PIPES AND DRAINS TO BE PATCH WITH METAL DECKING EQUAL TO EXISTING BY GC AS PART OF BASE BID.
- PROVIDE WALKWAY PAD AT TOP OF ROOFING HATCH AND AROUND ALL ROOFTOP MECHANICAL UNITS.
- PROVIDE WALKWAY PAD AT TOP OF ROOF HATCH AND AROUND ROOF TOP MECHANICAL UNITS.

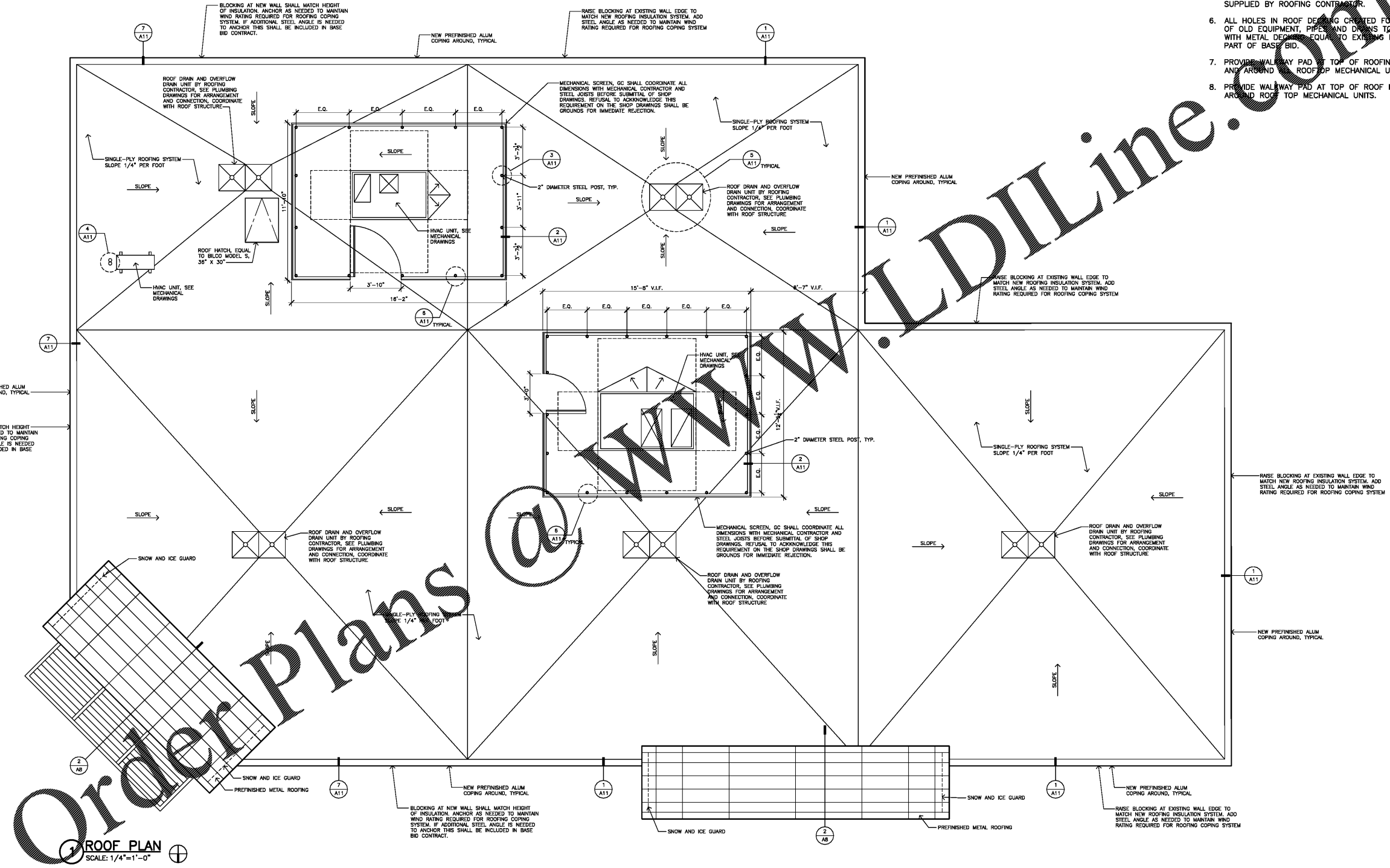

Order Plans
 ROOF PLAN
 SCALE: 1/4"=1'-0"

ROOF PLAN

RENOVATIONS AND ADDITIONS TO:

HOLLOWAY STREET ABC STORE

1928 HOLLOWAY ST. DURHAM, NC

PROJECT NUMBER 19002

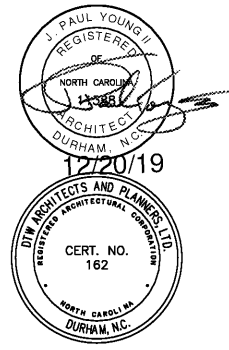

DTW
 Architects & Planners, Ltd.
 229 North Gregson Street
 Durham, NC 27701
 919.317.4020

BID DOCUMENTS FOR PERMIT
 Revisions

Drawn I.L.V.
 Checked J.P.Y.
 Date 12/22/19
 Sheet

A3
 of