

BRIDGE #2 PLAN VIEW  
STA. 71+06 TO 71+46 SCALE: 1"= 20'

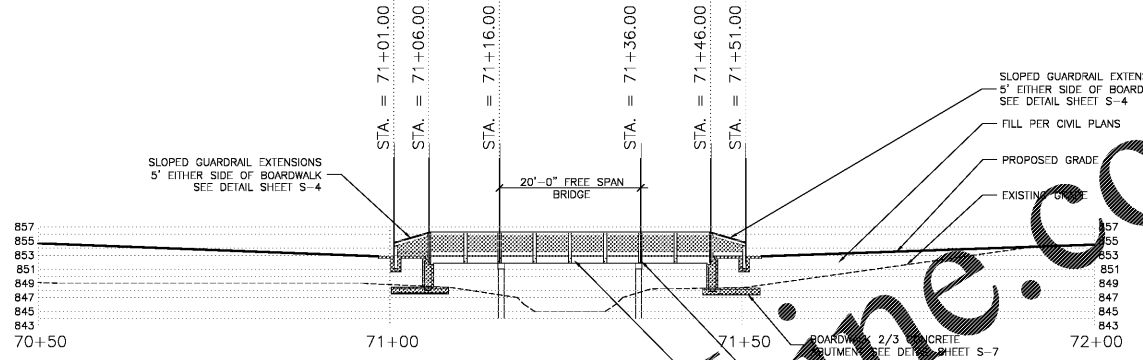

BOARDWALK #2 PROFILE  
SCALE: 1"=10'

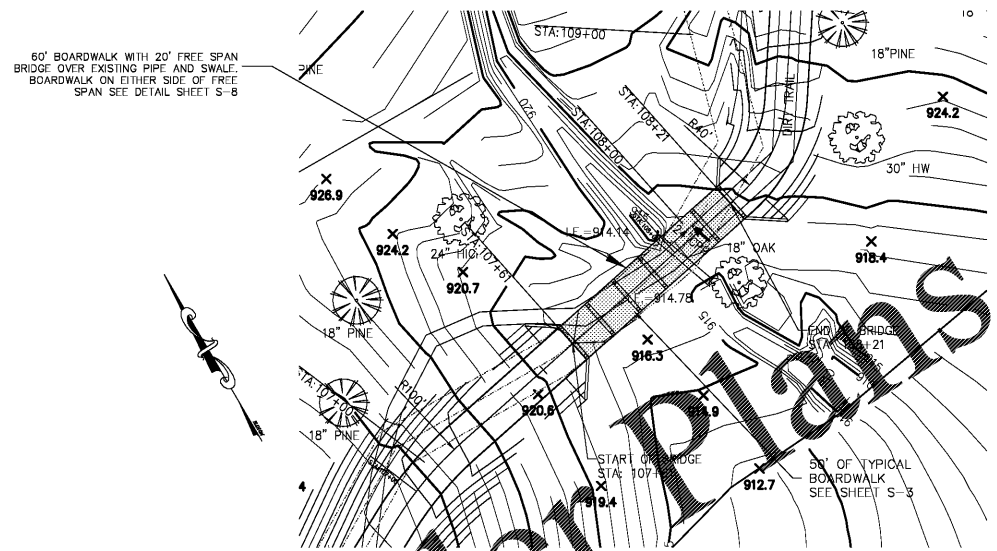

BOARDWALK #3 PLAN VIEW  
STA. 107+61 TO 108+21 SCALE: 1"= 20'

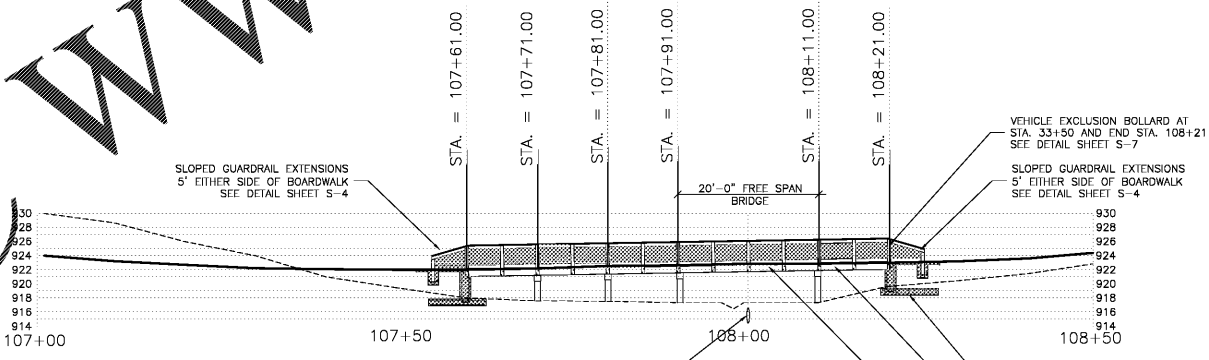

BOARDWALK #3 PROFILE  
SCALE: 1"=10'

Order Plans

@

WWW.LDILINE.COM

GWINNETT COUNTY APPROVAL

**GWINNETT COUNTY**  
Department of Planning and Development

These project documents have been reviewed by applicable County Departments and have been found to be in substantial compliance with the applicable codes and regulations.

Oct 08, 2019  
AUTHORIZED



BRIDGE AND BOARDWALK PLAN VIEW

**PARKER**  
CONSULTING SERVICES, INC.  
CIVIL ENGINEERS  
8809 B. BELLEAIR CENTER CT.  
TALLAHASSEE, FL 32305 PHONE (850) 877-8400  
MATTHEW PARKER, P.E. 58724 C.A.P. 9603

Project Title  
LLOYD N. HARRIS TRAIL @ HARBINS PARK  
2995 LUKE EDWARDS ROAD  
BY: GWINNETT COUNTY DEPT. OF COMMUNITY SERVICES  
LAWRENCEVILLE, GEORGIA

REVISIONS	BY

DRAWN BY LMF  
CHECKED BY MP  
DATE: 10/03/19  
SCALE: 1"= 40'  
JOB No. 18-LD-068  
SHEET NUMBER

S-3