

Order Plans

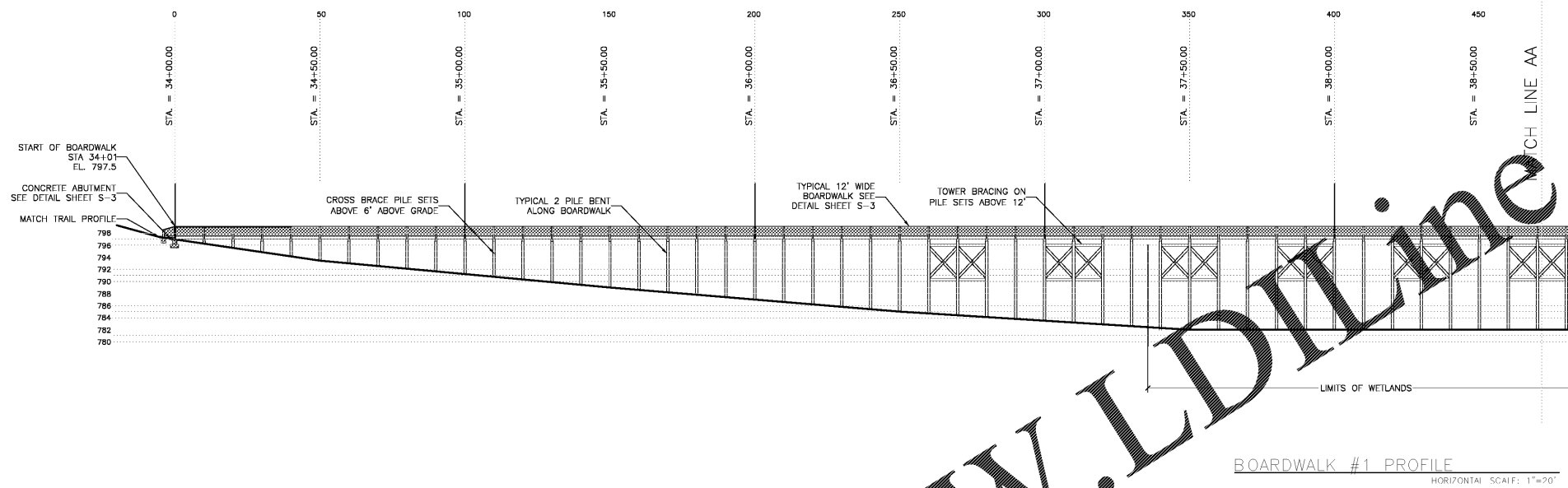

BOARDWALK #1 PROFILE
HORIZONTAL SCALE: 1"=20'

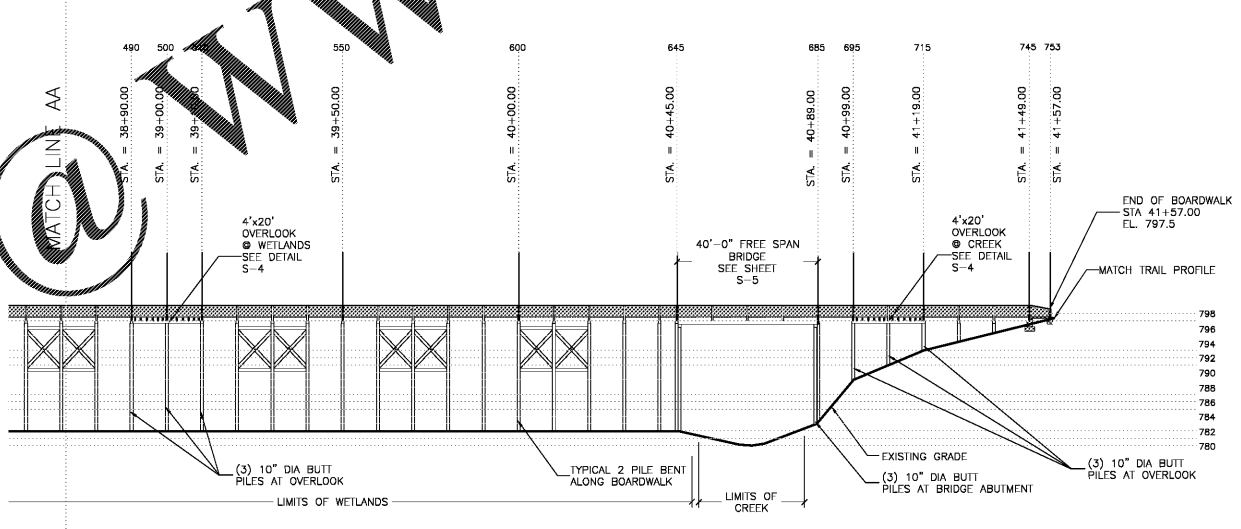

BOARDWALK #1 AND 40' FREE SPAN BRIDGE PROFILE
HORIZONTAL SCALE: 1"=20'

GWINNETT COUNTY APPROVAL

GWINNETT COUNTY
Department of Planning and Development

These project documents have been reviewed by applicable County Departments and have been found to be in substantial compliance with the applicable codes and regulations.

Oct 08, 2019
AUTHORIZED



BRIDGE AND BOARDWALK PROFILE

PARKER
CONSULTING SERVICES, INC.
CIVIL ENGINEERS
840 B KILLAM CENTER CT
TALLAHASSEE, FL 32305 PHONE: (904) 877-8400
MATTHEW PARKER, P.E. # 5874 CA # 9603

Project Title
LLOYD N. HARRIS TRAIL @ HARBINS PARK
2995 LUKE EDWARDS ROAD
BY: GWINNETT COUNTY DEPT. OF COMMUNITY SERVICES
LAWRENCEVILLE, GEORGIA

REVISIONS	BY

DRAWN BY: LMF
CHECKED BY: MP
DATE: 10/03/19
SCALE: 1" = 20'
JOB No. 18-LD-068
SHEET NUMBER

S-2