

RADIUS	STARTING STATION	ENDING STATION	RADIUS
R1	0+60.00'	1+10.00'	50'
R2	5+23.00'	5+68.00'	94'

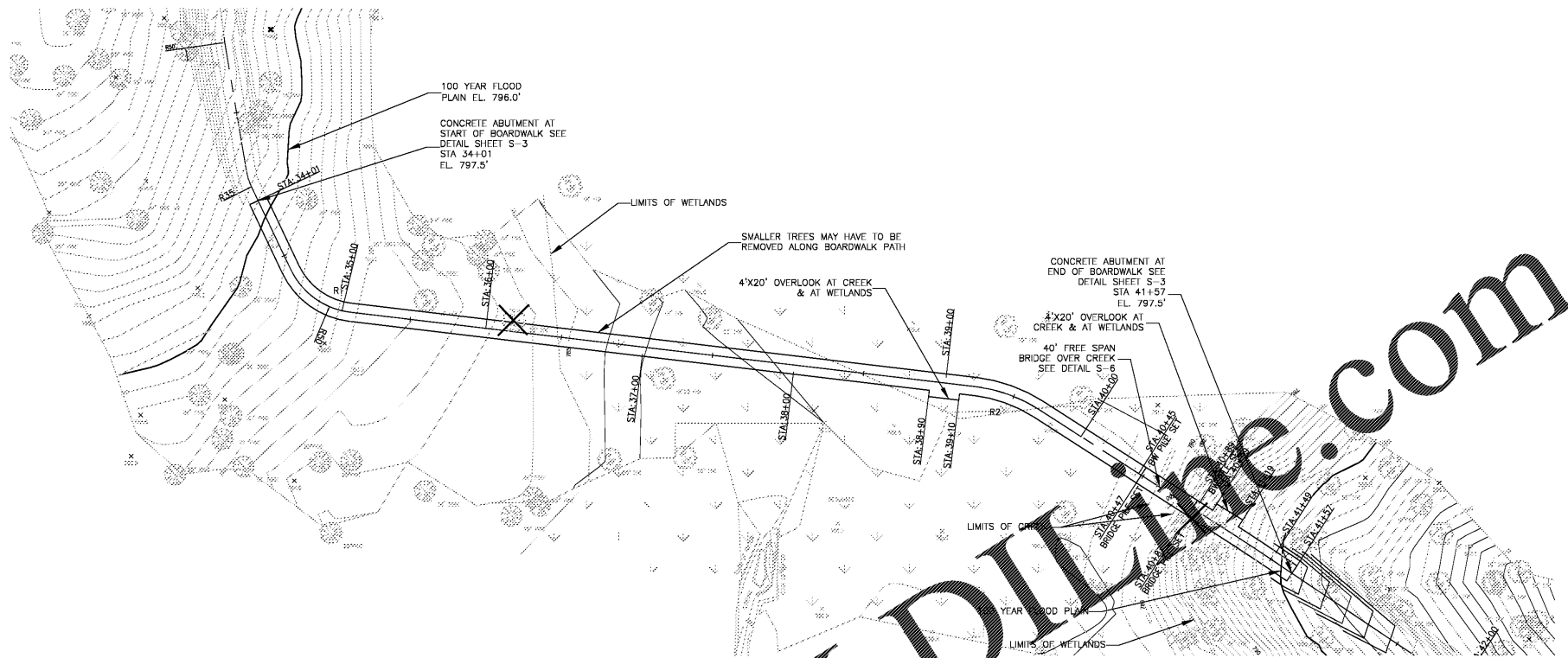

BOARDWALK #1 PLAN VIEW  
STA. 33+50 TO 41+06  
SCALE: 1" = 40'

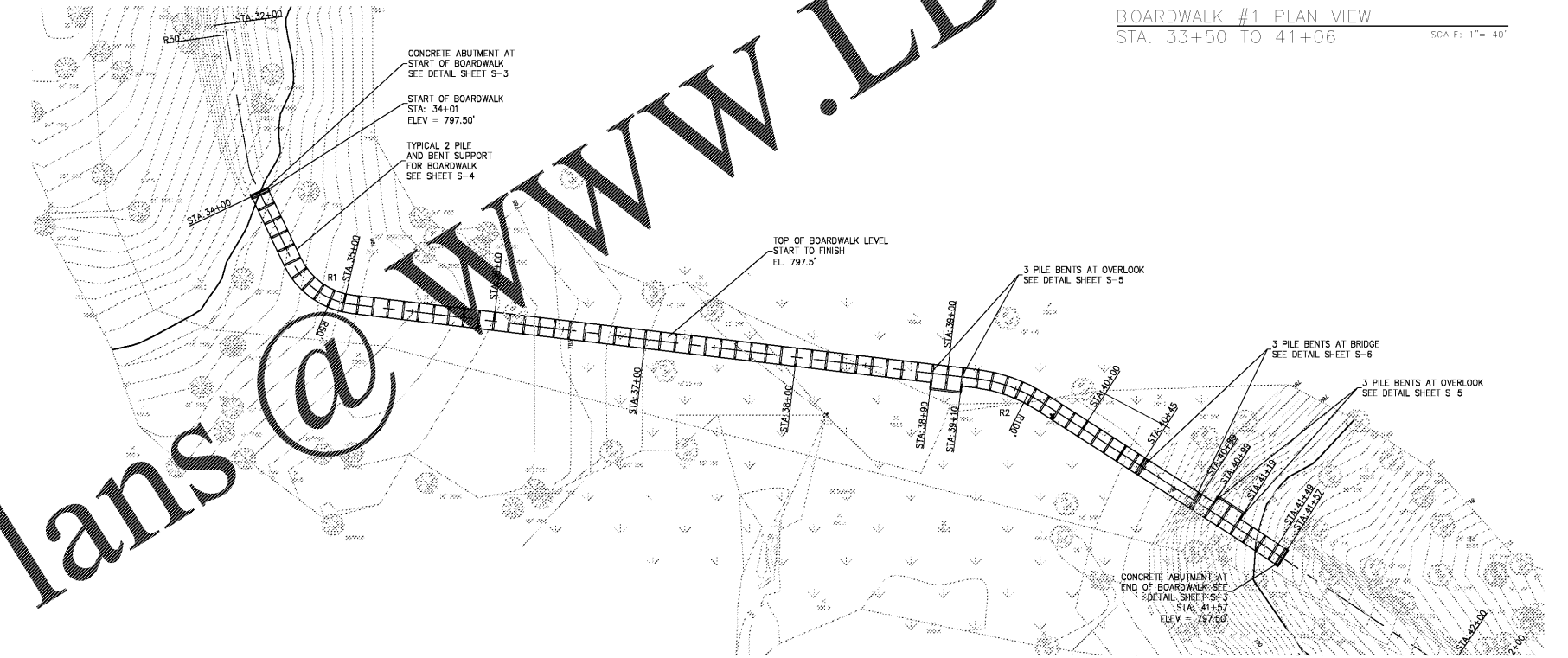

BOARDWALK #1 DIMENSIONAL/GRADING PLAN  
SCALE: 1" = 40'

GWINNETT COUNTY APPROVAL

**GWINNETT COUNTY**  
Department of Planning and Development  
These project documents have been reviewed by applicable County Departments and have been found to be in substantial compliance with the applicable codes and regulations.  
01/08, 2019  
AUTHORIZED



BRIDGE AND BOARDWALK PLAN VIEW

Order Plans @

WWW.LDLINE.COM

**PARKER**  
CONSULTING SERVICES, INC.  
CIVIL ENGINEERS  
TALLAHASSEE, FLORIDA  
MATTHEW PARKER, P.E. #5724 - CA# 9603

Project Title  
LLOYD N. HARRIS TRAIL @ HARBINS PARK  
2995 LUKE EDWARDS ROAD  
BY: GWINNETT COUNTY DEPT. OF COMMUNITY SERVICES  
LAWRENCEVILLE, GEORGIA

REVISIONS	BY

DRAWN BY LMF  
CHECKED BY MP  
DATE: 10/03/19  
SCALE: 1" = 40'  
JOB No. 18-LD-068  
SHEET NUMBER

S-1