

LDI drawn - Oct 05, 2018 - 4:28pm
 Z:\proj\2018\18-LD-088\18-LD-088.mxd
 2: full project - 18-LD-088.mxd
 3: full project - 18-LD-088.mxd
 4: full project - 18-LD-088.mxd
 5: full project - 18-LD-088.mxd
 6: full project - 18-LD-088.mxd
 7: full project - 18-LD-088.mxd
 8: full project - 18-LD-088.mxd
 9: full project - 18-LD-088.mxd
 10: full project - 18-LD-088.mxd
 11: full project - 18-LD-088.mxd
 12: full project - 18-LD-088.mxd
 13: full project - 18-LD-088.mxd
 14: full project - 18-LD-088.mxd
 15: full project - 18-LD-088.mxd
 16: full project - 18-LD-088.mxd
 17: full project - 18-LD-088.mxd
 18: full project - 18-LD-088.mxd
 19: full project - 18-LD-088.mxd
 20: full project - 18-LD-088.mxd
 21: full project - 18-LD-088.mxd
 22: full project - 18-LD-088.mxd
 23: full project - 18-LD-088.mxd
 24: full project - 18-LD-088.mxd
 25: full project - 18-LD-088.mxd
 26: full project - 18-LD-088.mxd
 27: full project - 18-LD-088.mxd
 28: full project - 18-LD-088.mxd
 29: full project - 18-LD-088.mxd
 30: full project - 18-LD-088.mxd
 31: full project - 18-LD-088.mxd
 32: full project - 18-LD-088.mxd
 33: full project - 18-LD-088.mxd
 34: full project - 18-LD-088.mxd
 35: full project - 18-LD-088.mxd
 36: full project - 18-LD-088.mxd
 37: full project - 18-LD-088.mxd
 38: full project - 18-LD-088.mxd
 39: full project - 18-LD-088.mxd
 40: full project - 18-LD-088.mxd
 41: full project - 18-LD-088.mxd
 42: full project - 18-LD-088.mxd
 43: full project - 18-LD-088.mxd
 44: full project - 18-LD-088.mxd
 45: full project - 18-LD-088.mxd
 46: full project - 18-LD-088.mxd
 47: full project - 18-LD-088.mxd
 48: full project - 18-LD-088.mxd
 49: full project - 18-LD-088.mxd
 50: full project - 18-LD-088.mxd
 51: full project - 18-LD-088.mxd
 52: full project - 18-LD-088.mxd
 53: full project - 18-LD-088.mxd
 54: full project - 18-LD-088.mxd
 55: full project - 18-LD-088.mxd
 56: full project - 18-LD-088.mxd
 57: full project - 18-LD-088.mxd
 58: full project - 18-LD-088.mxd
 59: full project - 18-LD-088.mxd
 60: full project - 18-LD-088.mxd
 61: full project - 18-LD-088.mxd
 62: full project - 18-LD-088.mxd
 63: full project - 18-LD-088.mxd
 64: full project - 18-LD-088.mxd
 65: full project - 18-LD-088.mxd
 66: full project - 18-LD-088.mxd
 67: full project - 18-LD-088.mxd
 68: full project - 18-LD-088.mxd
 69: full project - 18-LD-088.mxd
 70: full project - 18-LD-088.mxd
 71: full project - 18-LD-088.mxd
 72: full project - 18-LD-088.mxd
 73: full project - 18-LD-088.mxd
 74: full project - 18-LD-088.mxd
 75: full project - 18-LD-088.mxd
 76: full project - 18-LD-088.mxd
 77: full project - 18-LD-088.mxd
 78: full project - 18-LD-088.mxd
 79: full project - 18-LD-088.mxd
 80: full project - 18-LD-088.mxd
 81: full project - 18-LD-088.mxd
 82: full project - 18-LD-088.mxd
 83: full project - 18-LD-088.mxd
 84: full project - 18-LD-088.mxd
 85: full project - 18-LD-088.mxd
 86: full project - 18-LD-088.mxd
 87: full project - 18-LD-088.mxd
 88: full project - 18-LD-088.mxd
 89: full project - 18-LD-088.mxd
 90: full project - 18-LD-088.mxd
 91: full project - 18-LD-088.mxd
 92: full project - 18-LD-088.mxd
 93: full project - 18-LD-088.mxd
 94: full project - 18-LD-088.mxd
 95: full project - 18-LD-088.mxd
 96: full project - 18-LD-088.mxd
 97: full project - 18-LD-088.mxd
 98: full project - 18-LD-088.mxd
 99: full project - 18-LD-088.mxd
 100: full project - 18-LD-088.mxd



MATCHLINE (SEE E SHEETS)
 MATCHLINE (SEE E SHEETS)

Order Plans @

WWW.LDLINE.COM

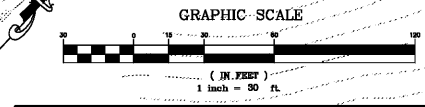
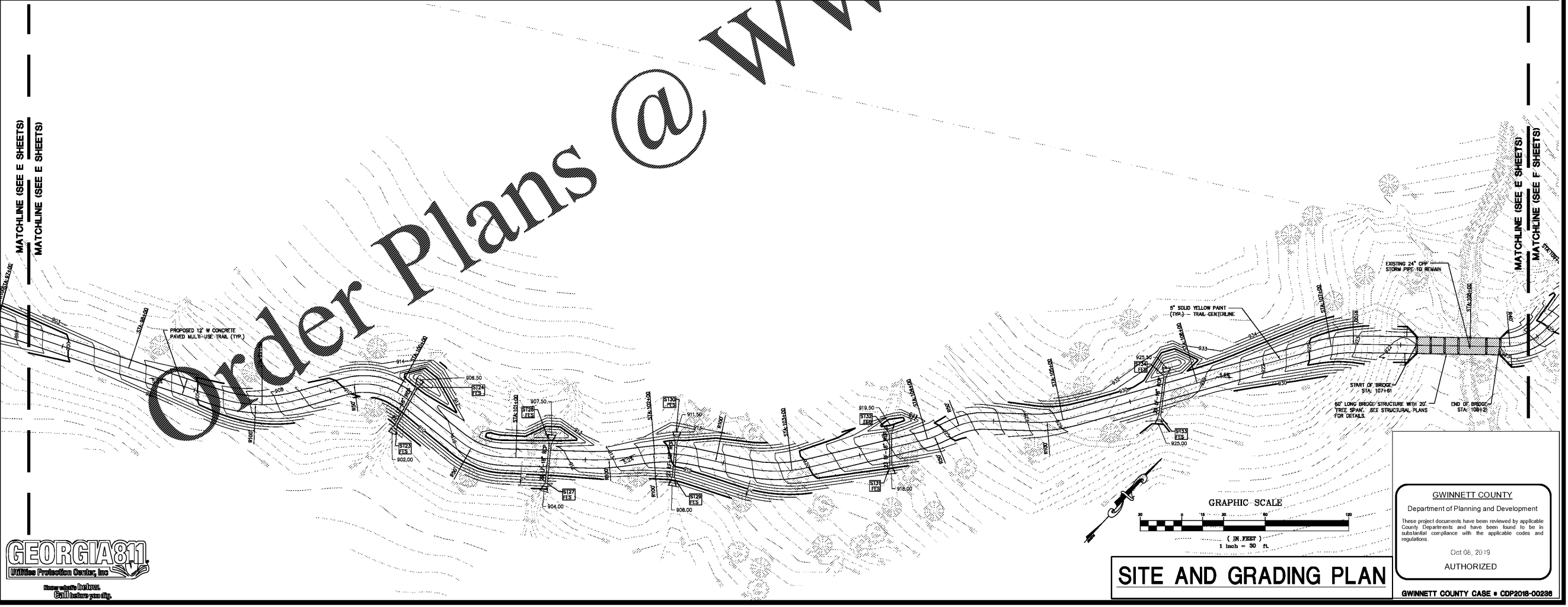
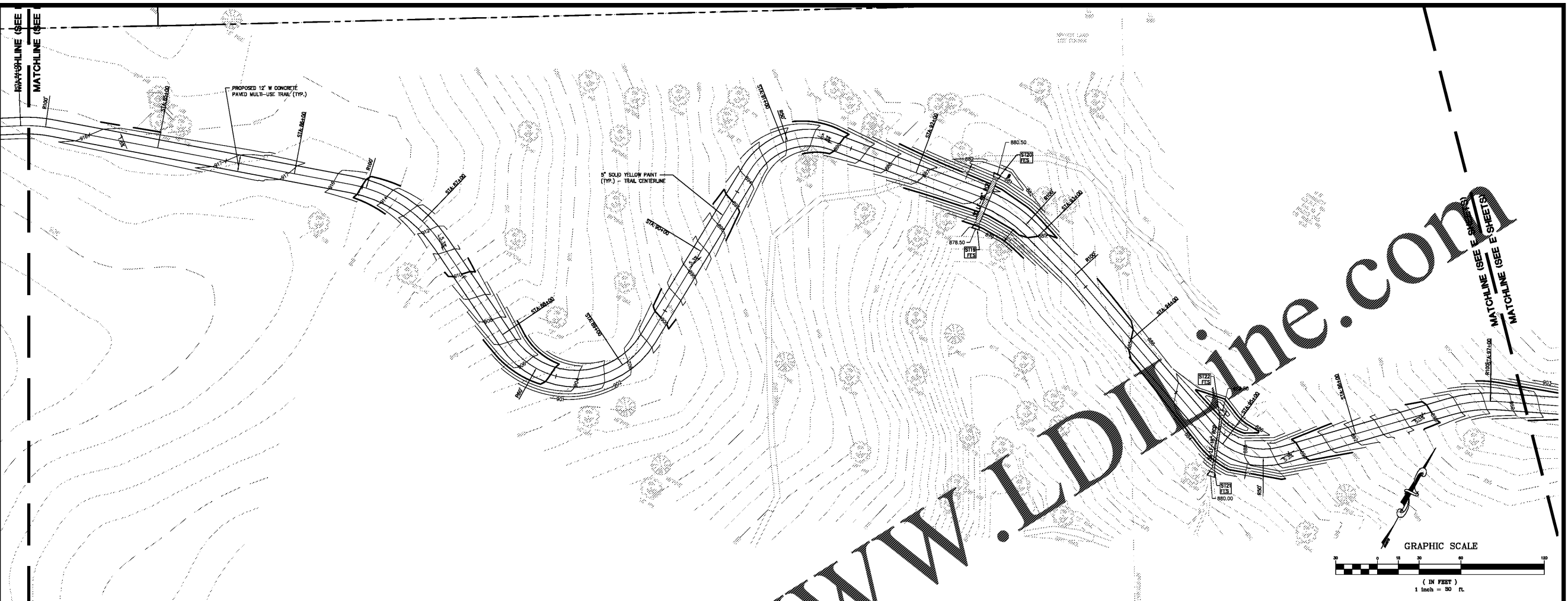

SITE AND GRADING PLAN

WINNETT COUNTY
 Department of Planning and Development
 These project documents have been reviewed by applicable County Departments and have been found to be in substantial compliance with the applicable codes and regulations.
 Oct 08, 2019
 AUTHORIZED

WINNETT COUNTY CASE # CDP2018-00288

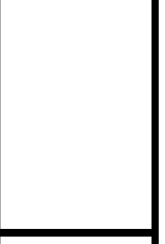

GSWCC# 22364
 ISS. 05/16/2018
 EXP. 05/16/2021

Project Title
 LLOYD N. HARRIS TRAIL @ HARBINS PARK
 2995 LUKE EDWARDS ROAD
 BY: GWINNETT COUNTY DEPT. OF COMMUNITY SERVICES
 LAWRENCEVILLE, GEORGIA
 5TH DISTRICT, LAND LOT 251, PARCEL ID# R5262 003

REVISIONS	BY

FOR PERMIT ONLY
 DRAWN BY: DMN
 CHECKED BY: THH
 DATE: 09/25/2019
 SCALE: 1" = 30'
 JOB No.: 18-LD-088
 SHEET NUMBER: C-1E