

Drawn: Oct 05, 2018 - 4:12pm  
2 full project area (Project) V:\Projects\18-008\main.dwg - 18-008 MAIN.dwg - 18-008 ES-2A

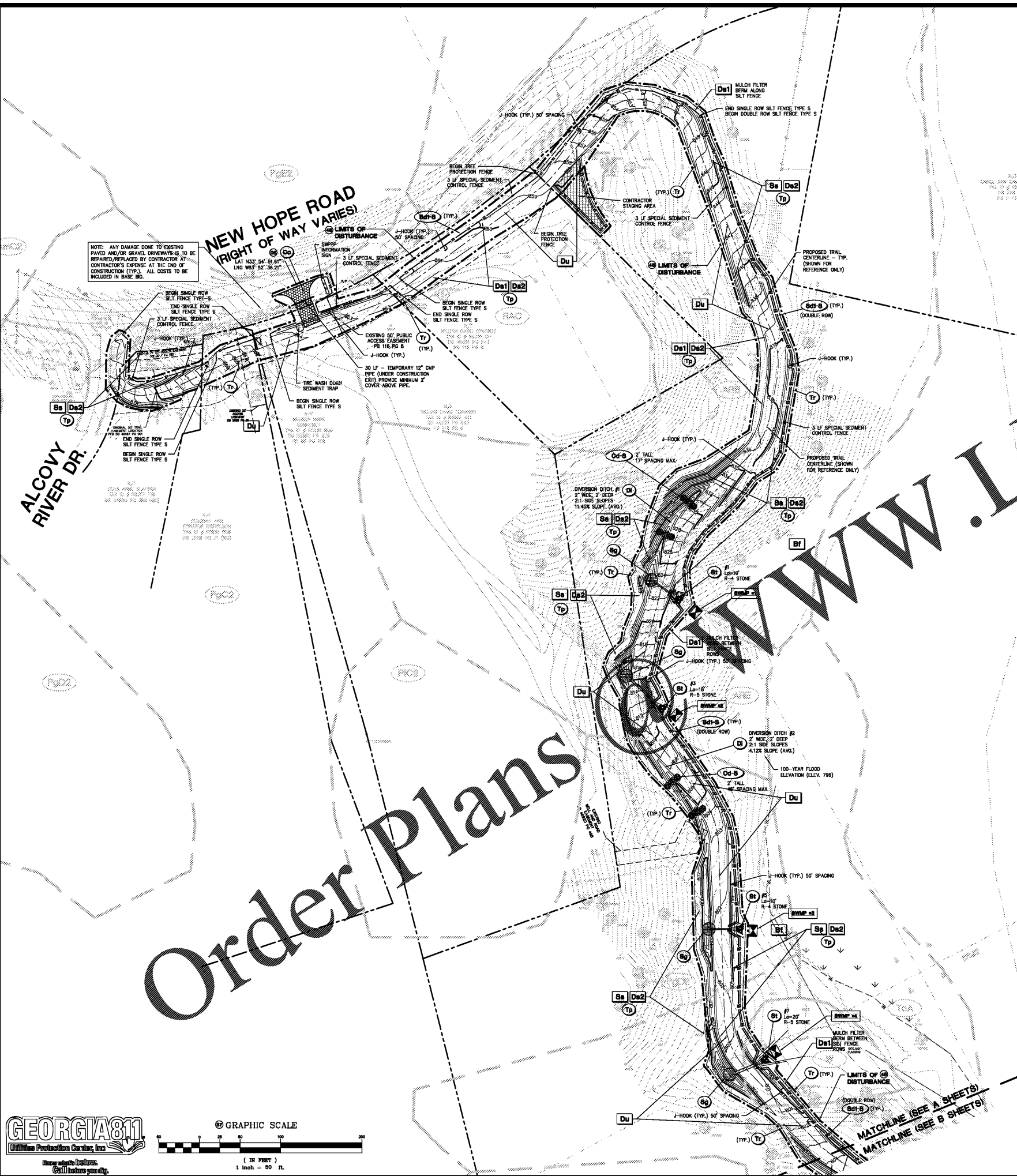

NOTE: ANY DAMAGE DONE TO EXISTING PAVED AND/OR GRAVEL DRIVEWAYS IS TO BE REPAIRED/REPLACED BY CONTRACTOR AT CONTRACTOR'S EXPENSE AT THE END OF CONSTRUCTION (TYP.). ALL COSTS TO BE INCLUDED IN BASE BID.

NEW HOPE ROAD (RIGHT OF WAY VARIES)  
LAT 33° 54' 41.61"  
LONG 83° 52' 38.21"

# Order Plans

**GEORGIA811**  
UNIFORM Production Control, Inc.

GRAPHIC SCALE  
1 inch = 50 feet

**MULCHING SCHEDULE**

MULCHING MATERIAL	RATE/ACRE
DRY STRAW OR HAY	2.5 TONS (8 TO 10" DEEP)
WOOD WASTE, CHIPS, SANDUST, OR BARK	6 TO 10 TONS (2 TO 3" DEEP)

**TEMPORARY SEEDING SCHEDULE**

SPECIES (MIXTURE OF)	RATE/ACRE	PLANTING DATES
SUDAN (SWEET OR TIFT)	60 LBS	APRIL- AUG 31
ANNUAL RYE GRASS	28 LBS	AUG 15- DEC 31

NOTE: APPLY LIME AT THE RATE OF 1 TON/ACRE REFER TO ES-7 FOR FERTILIZER REQUIREMENTS

**PERMANENT SEEDING SCHEDULE**

SPECIES	RATE/ACRE	PLANTING DATES
COMMON BERMUDA (MULLED) (CYNODON DACTYLON)	10 LBS	MARCH - JUNE 30
COMMON BERMUDA (UNMULLED) (CYNODON DACTYLON)	10 LBS	MARCH 1-FEB
BAMIA PENSACOLA (PASPALUM STATIUM)	60 LBS	JAN 1-DEC 31

NOTE: APPLY LIME AT THE RATE OF 1 TON/ACRE REFER TO ES-7 FOR FERTILIZER REQUIREMENTS

**24 HR LOCAL EMERGENCY CONTACT**  
THOMAS HUNTER HYDE  
WOLVERTON ASSOC. (770)447-8999

CONTRACTOR'S NAME: \_\_\_\_\_ PHONE NUMBER: \_\_\_\_\_  
NOTE: CONTRACTOR TO PROVIDE UPDATED INFORMATION ONCE CONTRACT IS AWARDED.

**ACREAGE SUMMARY** (IN ACRES)

SITE AREA	637.67 ACRE
ON-SITE DISTURBED AREA	15.00 ACRE
OFF-SITE DISTURBED AREA	00.00 ACRE
TOTAL DISTURBED AREA (MUST MATCH NO.)	15.00 ACRE
IMPERVIOUS AREA AT COMPLETION	3.16 ACRE
PERVIOUS AREA AT COMPLETION	11.84 ACRE

**CONSERVATION COMMISSION NOTES**  
EROSION CONTROL MEASURES WILL BE MAINTAINED AT ALL TIMES. IF FULL IMPLEMENTATION OF THE APPROVED PLAN DOES NOT PROVIDE FOR EFFECTIVE EROSION CONTROL, ADDITIONAL EROSION AND SEDIMENT CONTROL MEASURES SHALL BE IMPLEMENTED TO CONTROL OR TREAT THE SEDIMENT SOURCE.  
THE ESCAPE OF SEDIMENT FROM THE SITE SHALL BE PREVENTED BY THE INSTALLATION OF SEDIMENT CONTROL MEASURES AND PRACTICES PRIOR TO LAND-DISTURBANCE ACTIVITIES.  
ALL EROSION & SEDIMENT CONTROL MEASURES WILL BE CHECKED DAILY AND ANY DEFICIENCIES NOTED WILL BE CORRECTED BY THE END OF EACH DAY. ADDITIONAL EROSION AND SEDIMENT CONTROL MEASURES WILL BE INSTALLED IF DEEMED NECESSARY AFTER ON-SITE INSPECTION BY THE ISSUING AUTHORITY.  
ANY DISTURBED AREA LEFT EXPOSED FOR A PERIOD GREATER THAN 14 DAYS SHALL BE STABILIZED WITH MULCH OR TEMPORARY SEEDING.  
NOTE: CONCRETE WASH DOWN SHALL BE LOCATED ON-SITE IN A PLACE AGREED UPON BY CONTRACTOR AND DEVELOPER. CONCRETE WASH DOWN LOCATION AND PLACE CHANGES BELIEVED.

**EROSION CONTROL LEGEND**

	APB	APPLYING-HARD LABOR COMPLEX, 2-8% SLOPES, HSG: B
	ARE	ASHLAR, IRON, AND WATERED SOILS, 10-25% SLOPES, HSG: B
	Cfs	CHEWACLA SILT LOAM, 0-25% SLOPES, FREQUENTLY FLOODED, HSG: B/D
	PfB2	PACOLET SANDY LOAM, 2-8% SLOPES, MODERATELY ERODED, HSG: B
	PfC2	PACOLET SANDY LOAM, 6-10% SLOPES, MODERATELY ERODED, HSG: B
	PfD2	PACOLET SANDY LOAM, 10-15% SLOPES, MODERATELY ERODED, HSG: B
	PfE2	PACOLET SANDY LOAM, 15-25% SLOPES, MODERATELY ERODED, HSG: B
	RAC	RANKLINS AND IRON SOILS, 2-10% SLOPES, HSG: B
	ToA	TOCOOA FINE SANDY LOAM, 0-4% SLOPES, FREQUENTLY FLOODED, HSG: A
	W	WATER
	Wed	MEHAKKE SOILS, 0-2% SLOPES, FREQUENTLY FLOODED, HSG: B/D
	WrE2	MEADOWE SANDY LOAM, 10-25% SLOPES, ERODED, HSG: B

NOTE: ALL TREES WITHIN THE LIMITS OF TRAIL GRADING ARE TO BE REMOVED, UNLESS OTHERWISE NOTED TO BE PROTECTED. CONTRACTOR TO MARK/FLAG ALL TREES OUTSIDE THE GRADING LIMITS BUT WITHIN THE OVERALL LIMITS OF CONSTRUCTION FOR THE COUNTY'S REPRESENTATIVE(S) TO DETERMINE IF THESE TREES ARE TO BE REMOVED OR PROTECTED.

NOTE: SEE SURVEY FOR EXISTING LEGEND SYMBOLS

REFER TO PLAN SHEETS ES-4 AND ES-6 FOR GENERAL NOTES, MAINTENANCE NOTES, SITE DATA & QUAD MAP

PROVIDE TEMPORARY IRRIGATION OR WATERING, VIA WATER TROCK, AS NEEDED TO ESTABLISH TEMPORARY AND PERMANENT VEGETATION UNTIL THE NOT IS SUCCED. ALL DISTURBED AREAS TO BE VEGETATED SHALL BE IRRIGATED OR WATERED UNTIL THE NOT HAS BEEN SUBMITTED AND ACCEPTED.

REPRESENTS NOTE/FEATURE WHICH CORRESPONDS WITH THE ES/SPC PLAN CHECKLIST. SEE SHEET ES-4 FOR ES/SPC CHECKLIST.

BMP# POINTS  
FLOW DISCHARGES OVERLAND INTO PALM CREEK AND THE ALCOVY RIVER. RECEIVING WATER IS LISTED ON THE 303d LIST HOWEVER THE IMPAIRMENT IS CAUSED BY FISCAL COLIFORM. THIS PROJECT WILL NOT NEGATIVELY IMPACT THE RECEIVING WATER FOR THE LISTED IMPAIRMENT CAUSE.

## PHASE II EROSION SEDIMENTATION & POLLUTION CONTROL PLAN

GWINNETT COUNTY  
Department of Planning and Development  
These project documents have been reviewed by applicable County Departments and have been found to be in substantial compliance with the applicable codes and regulations.  
Oct 08, 2019  
AUTHORIZED

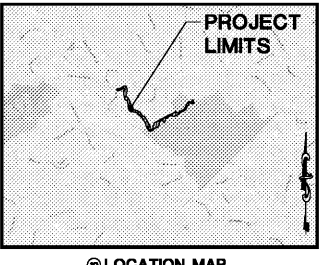

**STRUCTURAL PRACTICES**

CODE	PRACTICE	DETAIL	MAP SYMBOL	DESCRIPTION
Co	CONCRETE CURB			A curb to prevent runoff from leaving the construction site or area of disturbance.
Co	CONCRETE CURB			A curb to prevent runoff from leaving the construction site or area of disturbance.
Co	CONCRETE CURB			A curb to prevent runoff from leaving the construction site or area of disturbance.
Co	CONCRETE CURB			A curb to prevent runoff from leaving the construction site or area of disturbance.
Co	CONCRETE CURB			A curb to prevent runoff from leaving the construction site or area of disturbance.
Co	CONCRETE CURB			A curb to prevent runoff from leaving the construction site or area of disturbance.
Co	CONCRETE CURB			A curb to prevent runoff from leaving the construction site or area of disturbance.
Co	CONCRETE CURB			A curb to prevent runoff from leaving the construction site or area of disturbance.
Co	CONCRETE CURB			A curb to prevent runoff from leaving the construction site or area of disturbance.
Co	CONCRETE CURB			A curb to prevent runoff from leaving the construction site or area of disturbance.

**VEGETATIVE PRACTICES**

CODE	PRACTICE	DETAIL	MAP SYMBOL	DESCRIPTION
B1	BARRIER DITCH			Ditch of undisturbed riparian vegetation, adjacent or related riparian vegetation or the establishment of riparian vegetation in an area of disturbance or barrier stream.
De1	DEVELOPED AREA PROTECTION			Establish a temporary protection for the existing developed area or riparian area to prevent erosion.
De2	DEVELOPED AREA PROTECTION			Establish a temporary protective cover with best growing practice in riparian area.
De3	DEVELOPED AREA PROTECTION			Establish a permanent vegetative cover to riparian area.
Du	DUPLICATE			Control the surface soil and movement of soil in construction site, roadway and other areas.
Se	SEEDING			A protective covering used to prevent erosion and stabilize temporary or permanent vegetation on steep slopes, down slopes, or ditches.

**TEMPORARY SILT FENCE QUALIFICATIONS (BAM 2)**  
DRAINAGE AREA = 18.34 AC  
DISTURBED AREA = 18.00 AC  
SILT FENCE REQUIRED = 7,336 LF (100 LF/0.25 AC)  
SILT FENCE PROVIDED = 11,455 LF

NOTE: SINCE THIS DEVELOPMENT IS A LINEAR PROJECT, SILT FENCE IS BEING USED TO CONTAIN SEDIMENT.

**EROSION CONTROL LEGEND**

	PROPERTY LINE
	LIMITS OF DISTURBANCE
	GRADE BREAK
	CONTOUR ELEVATIONS
	STORM DRAIN
	DIRECTION OF OVERLAND FLOW
	SOIL SERIES BOUNDARY
	SILT FENCE
	SPECIAL SEDIMENT CONTROL FENCE
	TREE PROTECTION FENCE
	TEMPORARY BARRICADE
	SWPPP INFORMATION SIGN

REFER TO PLAN SHEETS ES-4 AND ES-6 FOR GENERAL NOTES, MAINTENANCE NOTES, SITE DATA & QUAD MAP

PROVIDE TEMPORARY IRRIGATION OR WATERING, VIA WATER TROCK, AS NEEDED TO ESTABLISH TEMPORARY AND PERMANENT VEGETATION UNTIL THE NOT IS SUCCED. ALL DISTURBED AREAS TO BE VEGETATED SHALL BE IRRIGATED OR WATERED UNTIL THE NOT HAS BEEN SUBMITTED AND ACCEPTED.

REPRESENTS NOTE/FEATURE WHICH CORRESPONDS WITH THE ES/SPC PLAN CHECKLIST. SEE SHEET ES-4 FOR ES/SPC CHECKLIST.

BMP# POINTS  
FLOW DISCHARGES OVERLAND INTO PALM CREEK AND THE ALCOVY RIVER. RECEIVING WATER IS LISTED ON THE 303d LIST HOWEVER THE IMPAIRMENT IS CAUSED BY FISCAL COLIFORM. THIS PROJECT WILL NOT NEGATIVELY IMPACT THE RECEIVING WATER FOR THE LISTED IMPAIRMENT CAUSE.

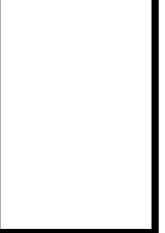

GSWCC# 22364  
ISS. 05/16/2018  
EXP. 05/16/2021

Project Title  
**LLOYD N. HARRIS TRAIL @ HARBINS PARK  
2995 LUKE EDWARDS ROAD  
BY: GWINNETT COUNTY DEPT. OF COMMUNITY SERVICES  
LAWRENCEVILLE, GEORGIA  
5TH DISTRICT, LAND LOT 251, PARCEL ID# R5262 003**

**REVISIONS**

NO.	DATE	DESCRIPTION	BY

FOR PERMIT ONLY

DRAWN BY: DMN  
CHECKED BY: THH  
DATE: 09/25/2019  
SCALE: 1" = 50'  
JOB NO: 18-LD-068  
SHEET NUMBER: **ES-2A**