

DATE: 09/25/2019 10:58 AM  
 PROJECT: 18-LD-088 MAIN/DWG  
 DRAWING: 18-LD-088 MAIN/DWG  
 LAYOUT: ES-1D

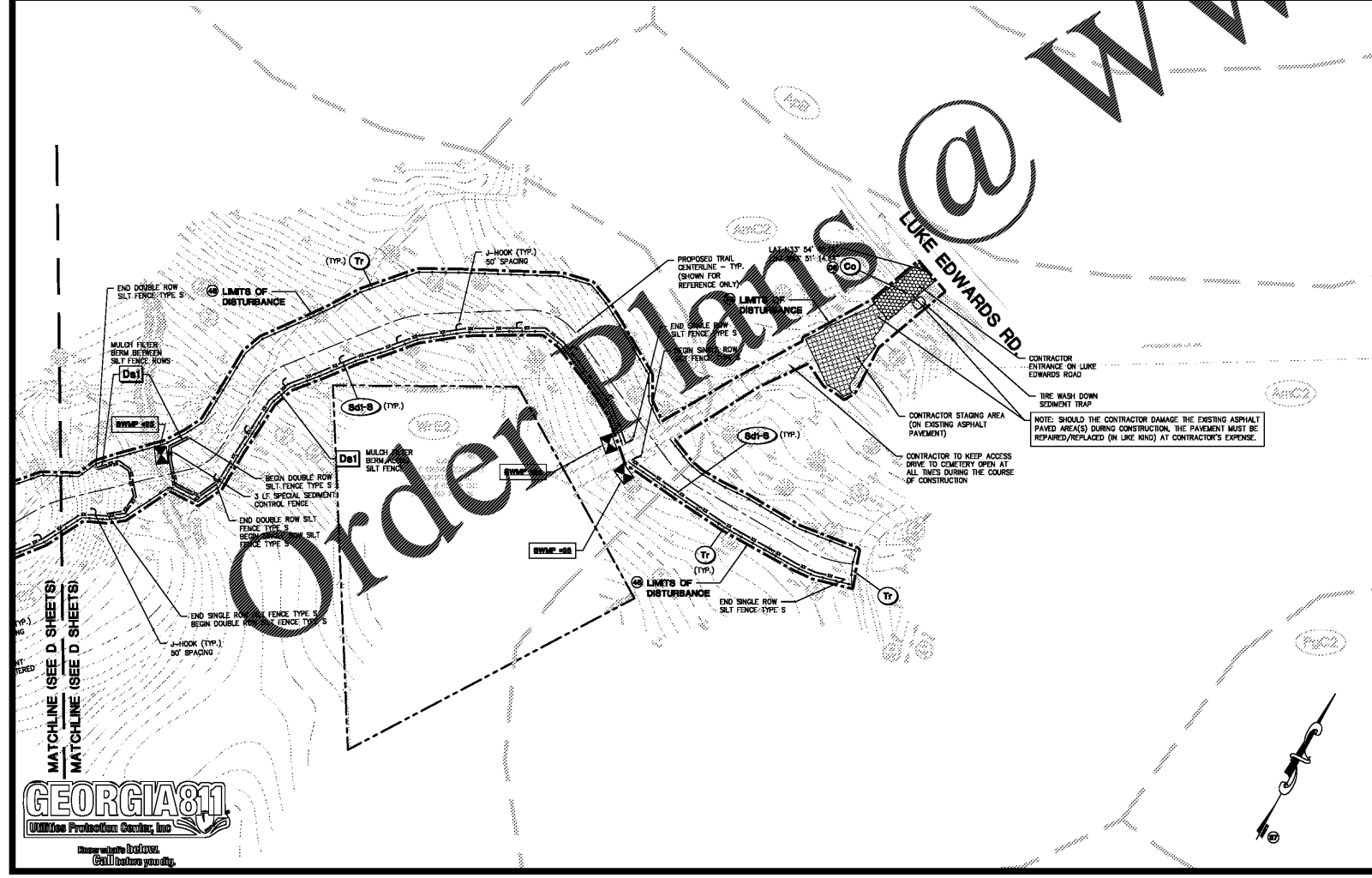
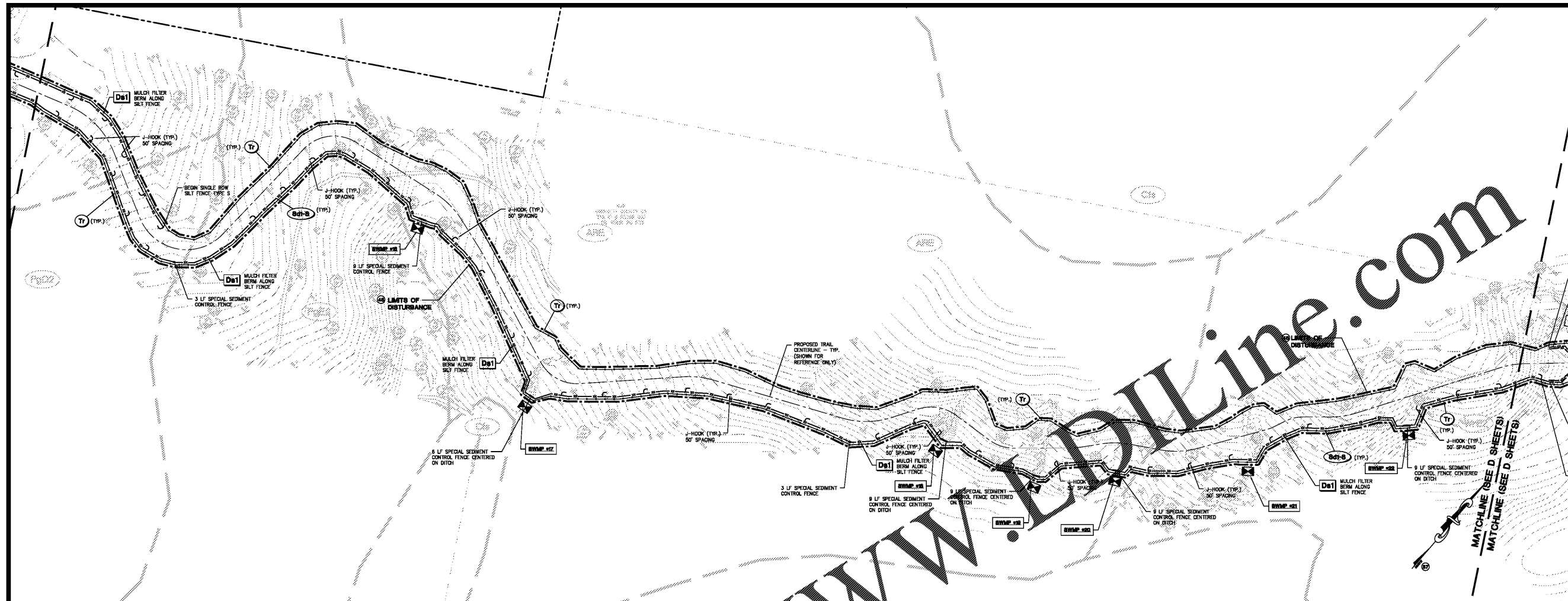

WWW.WOLVERTON.com

**EROSION CONTROL LEGEND**

- PROPERTY LINE
- - - LIMITS OF DISTURBANCE
- - - GRADE BREAK
- CONTOUR ELEVATIONS
- STORM DRAIN
- X.X.X.X. DIRECTION OF OVERLAND FLOW
- SOIL SERIES BOUNDARY
- SILT FENCE
- SPECIAL SEDIMENT CONTROL FENCE
- TREE PROTECTION FENCE
- TEMPORARY BARRICADE
- SWPPP INFORMATION SIGN

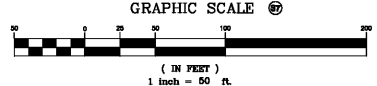

NOTE: ALL TREES WITHIN THE LIMITS OF TRAIL GRADING ARE TO BE REMOVED, UNLESS OTHERWISE NOTED TO BE PROTECTED. CONTRACTOR TO MARK/FLAG ALL TREES OUTSIDE THE GRADING LIMITS BUT WITHIN THE OVERALL LIMITS OF CONSTRUCTION FOR THE COUNTY'S REPRESENTATIVE(S) TO DETERMINE IF THESE TREES ARE TO BE REMOVED OR PROTECTED.

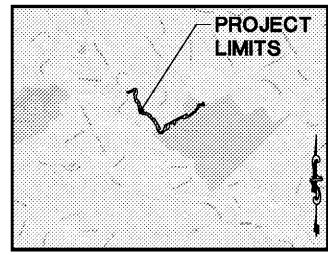

LOCATION MAP NOT TO SCALE

PHASE I EROSION  
 SEDIMENTATION &  
 POLLUTION CONTROL PLAN

**GWINNETT COUNTY**  
 Department of Planning and Development  
 These project documents have been reviewed by applicable County Departments and have been found to be in substantial compliance with the applicable codes and regulations.  
 Oct 08, 2019  
 AUTHORIZED

GWINNETT COUNTY CASE # CDP2018-00238



GSWCC# 22364  
 ISS: 05/16/2018  
 EXP: 05/16/2021

**Project Title**  
 LLOYD N. HARRIS TRAIL @ HARBINS PARK  
 2995 LUKE EDWARDS ROAD  
 BY: GWINNETT COUNTY DEPT. OF COMMUNITY SERVICES  
 LAWRENCEVILLE, GEORGIA  
 5TH DISTRICT, LAND LOT 251, PARCEL ID# R5262 003

REVISIONS	BY

**FOR PERMIT ONLY**  
 DRAWN BY: DMN  
 CHECKED BY: THH  
 DATE: 09/25/2019  
 SCALE: 1" = 50'  
 JOB No: 18-LD-088  
 SHEET NUMBER: ES-1D