

Order Plans @ www.LDOnline.com

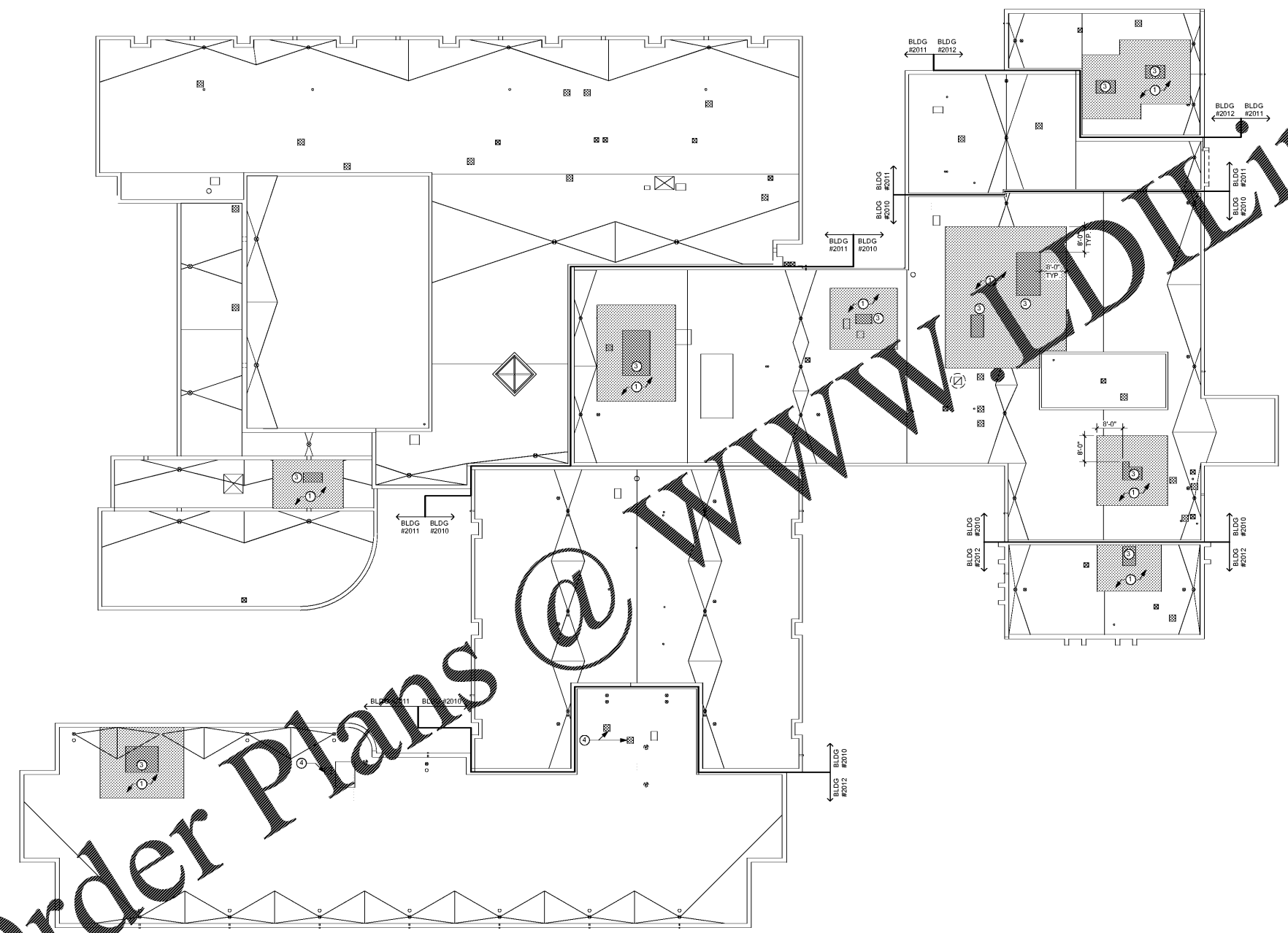

ROOF PLAN NOTES	
1	EXISTING SBS MODIFIED BITUMEN ROOFING SHALL REMAIN. PROVIDE NEW MODIFIED BITUMEN CAP SHEET 3'-0" OUT FROM ALL NEW ROOF TOP UNIT CURBS IN ALL DIRECTIONS. NEW CAP SHEET SHALL EXTEND 2'-0" OUT FROM OTHER ROOF TOP EQUIPMENT.
2	ALL EXISTING ROOF MOUNTED EQUIPMENT SHALL REMAIN UNLESS NOTED OTHERWISE. COORDINATE WITH MECHANICAL, ELECTRICAL, AND PLUMBING DRAWINGS FOR ADDITIONAL ROOF EQUIPMENT REPAIR/REPLACEMENT SCOPE.
3	SELECTED MECHANICAL EQUIPMENT TO BE REPLACED. REFER TO MECHANICAL, ELECTRICAL, AND PLUMBING DRAWINGS FOR ADDITIONAL INFORMATION.
4	NOT USED.

- ROOF PLAN NOTES
- A. THE PURPOSE OF THIS ROOF PLAN IS TO GRAPHICALLY REPRESENT THE INTENT OF ROOF DRAINAGE. ALL ROOF DRAIN SLOPES TO BE LOCATED AT THE LOW POINT OF SLOPED STRUCTURAL ELEMENTS. ROOFING & PLUMBING SUB-CONTRACTORS TO COORDINATE LOCATIONS OF ALL TAPERED INSULATION AND ROOF DRAINAGE COMPONENTS WITH INSTALLED FIELD CONDITIONS OF ALL STRUCTURAL ELEMENTS TO INSURE POSITIVE DRAINAGE OF ALL ROOFS SURFACES.
 - B. REMOVE ALL EXISTING MODIFIED BITUMEN ROOFING FROM ALL LOW SLOPE ROOFS INCLUDING THE ONE INCH PERLITE BOARD. ALL EXISTING STANDING SEAM METAL ROOFING SHALL REMAIN. EXISTING INSULATION SHALL REMAIN UNLESS NOTED OTHERWISE (SEE ALLOWANCES FOR REPLACEMENT OF DAMAGED INSULATION).
 - C. REPLACE GUTTERS AND DOWNSPOUTS WHERE INDICATED.
 - D. ALL EXISTING ROOF MOUNTED EQUIPMENT SHALL REMAIN UNLESS NOTED OTHERWISE. COORDINATE WITH MECHANICAL AND PLUMBING DRAWINGS FOR PROPOSED WORK RELATING TO ROOF MOUNTED EQUIPMENT. THE ROOF PLAN DOES NOT SHOW THE FULL EXTENT OF EXISTING ROOF MOUNTED EQUIPMENT. CONTRACTORS SHALL VISIT THE SITE AND BE FAMILIAR WITH THE EXISTING CONDITIONS PRIOR TO BID.
 - E. REPLACE LOW SLOPE ROOFING WITH A FULLY ADHERED TPO MEMBRANE SYSTEM INCLUDING COVER BOARD AND NEW LAYER OF RIGID INSULATION TO ACHIEVE DESIRED R-VALUE.
 - F. REPLACE ALL ROOF ACCESSORIES INCLUDING BUT NOT LIMITED TO ROOF DRAINS, OVERFLOW DRAINS, SPLASH BLOCKS, AND ROOF PENETRATION FLASHINGS.
 - G. PROVIDE NEW CRICKETS FOR ALL EXISTING AND NEW EQUIPMENT TO MAINTAIN POSITIVE DRAINAGE (TYPICAL).
 - H. PROVIDE WALK PADS AROUND ALL NEW AND EXISTING ROOF EQUIPMENT REQUIRING REGULAR MAINTENANCE. PROVIDE CONTINUOUS ROOF PADS FROM THE ROOF HATCH TO ALL SUCH EQUIPMENT.
 - I. SEE SPECIFICATIONS FOR PIPING AND DUCT SUPPORTS ON ROOF.
 - J. ALL EXISTING COPINGS SHALL BE REPLACED WHERE INDICATED. COLOR SHALL MATCH EXISTING METAL TRIM.
 - K. PROVIDE EXTRA LAYER OF TPO MEMBRANE (SPLASH PAD) AT ALL SPLASH BLOCK LOCATIONS WHERE EXISTING DOWNSPOUTS DISCHARGE ONTO LOW SLOPE ROOF.
 - L. SHIM NEW ROOF CURBS AS REQUIRED TO COORDINATE WITH EXISTING ROOF SLOPES (TYPICAL).
 - M. SEE SPECIFICATIONS FOR PIPING AND DUCT SUPPORTS ON ROOF.
 - N. PROVIDE EXTRA LAYER OF TPO MEMBRANE AT ALL DUCT SUPPORT LOCATIONS (TYPICAL).



FULTON COUNTY SCHOOL SYSTEM
EVOLINE C. WEST ELEMENTARY SCHOOL - RENOVATIONS
7040 RIVERTOWN RD., FAIRBURN, GA 30213

PROJECT NO:	19048.00
50% CD	08/07/2019
75% CD Resubmit	1/20/2018
90% CD	10/04/2019
PERMIT SET	11/15/2019
BID SET	12/20/2019



CONTRACT DOCUMENT ISSUED FOR CONSTRUCTION	

SHEET TITLE
ROOF PLAN

SHEET NUMBER
A151