

1 2 3 4 5 6 7 8 9 10 11 12 13 14 15 16 17

P
N
M
L
K
J
H
G
F
E
D
C
B
A

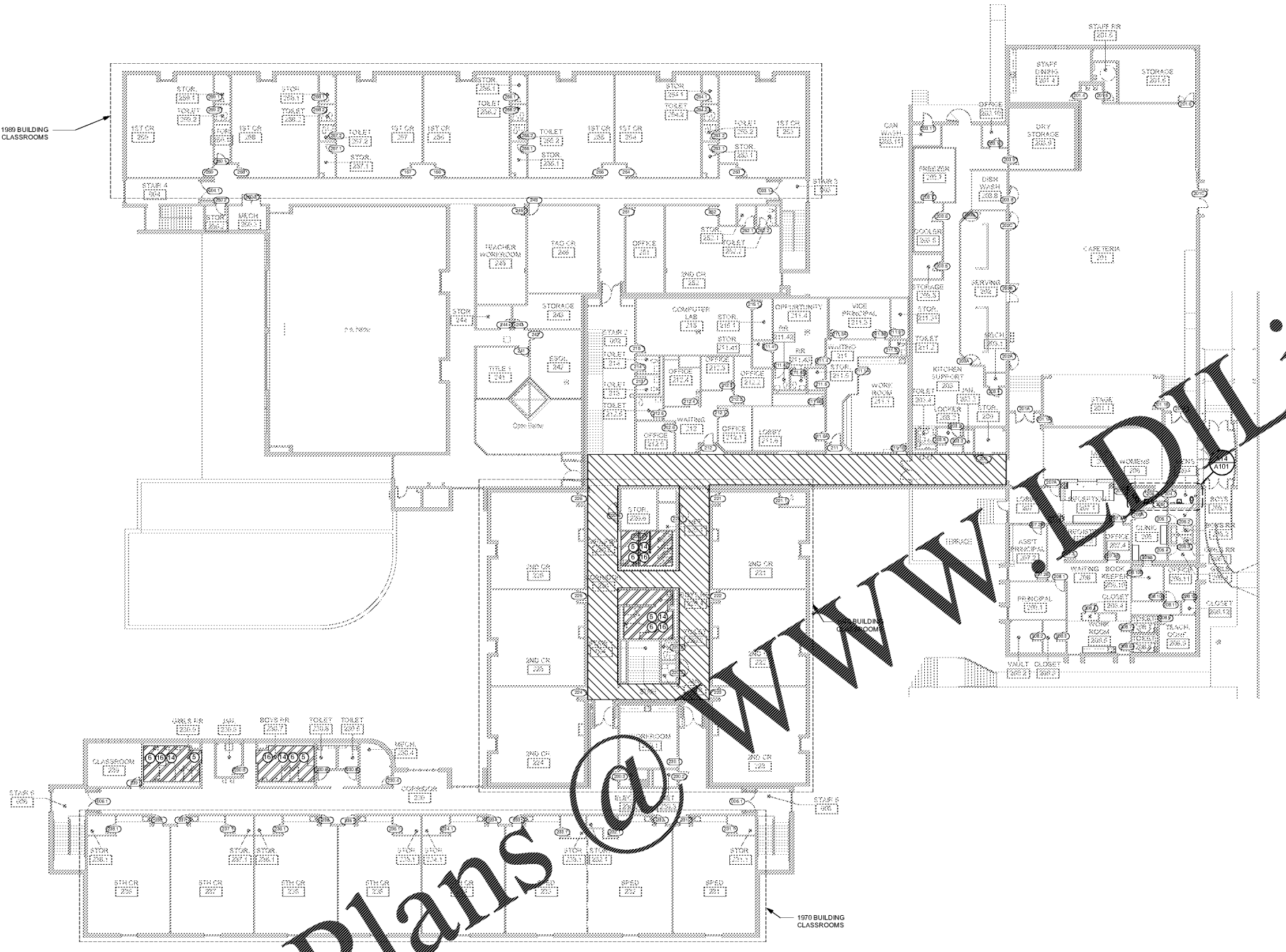

Order Plans @ WWW.WILDLINE.COM

FLOOR PLAN NOTES	
1	NOT USED
2	NOT USED
3	NOT USED
4	NOT USED
5	PREP WALL AND PAINT TO MATCH EXISTING PATCH AND PAINT EXISTING GYPSUM CEILING AS REQUIRED.
6	INSTALL NEW EPOXY FLOORING AND BASE IN AREAS SHOWN BY HATCH PATTERN ON THE PLAN. SEE SPEC SECTION 09 6723
7	NOT USED
8	INSTALL NEW DOOR HARDWARE WHERE INDICATED ON THE DOOR HARDWARE SCHEDULE, SHEET A041
9	NOT USED
10	NOT USED
11	NOT USED
12	NOT USED
13	NOT USED
14	INSTALL MIRROR SCREENS IN THE BOYS RESTROOMS AND REPLACE ALL TOILET PARTITION PANELS. SEE SPEC SECTION 10 2113.17
15	INSTALL NEW PLUMBING FIXTURES AS INDICATED ON THE FLOOR PLAN
16	REMOVE EXISTING PLUMBING FIXTURES AND REINSTALL AT THE SAME LOCATION AFTER FLOORING HAS BEEN INSTALLED.
17	NOT USED
18	NOT USED
19	NOT USED
20	NEW CONCRETE PAD AND NEW FENCE AROUND EQUIPMENT

GENERAL NOTES	
A.	CONTRACTOR SHALL COORDINATE WITH OTHER TRADES AND PROVIDE NECESSARY PATCHING AND PAINTING REQUIRED TO RESULT IN A SEAMLESS FINISH (TYPICAL).
B.	TOUCH-UP WALL PAINT AS REQUIRED TO MATCH EXISTING PAINT COLOR OR SHEEN WHERE WALL BASE IS REMOVED. AT CEILING TRACK, CASEWORK REPLACEMENT, DISPLAY BOARD REPLACEMENT, AND WHERE REQUIRED FOR OTHER SCOPE (TYPICAL). PROVIDE WALL BASE WHERE BASE IS DAMAGED OR MISSING.
C.	ALL GYPSUM BOARD SHALL HAVE A LEVEL 4 FINISH UNLESS NOTED OTHERWISE. UTILIZE FINE RATED GYPSUM BOARD AS REQUIRED. VERIFY IN FIELD. UTILIZE MOLD-RESISTANT GYPSUM BOARD AT ALL HIGH MOISTURE AREAS AND PLUMBING WALLS. SEE SPEC SECTION 09 2500.

- PROJECT NO: 19049.00
- | | |
|-----------------|------------|
| 50% CD | 08/07/2019 |
| 50% CD Resubmit | 1/20/2018 |
| 90% CD | 10/04/2019 |
| PERMIT SET | 11/15/2019 |
| BD SET | 12/20/2019 |
- CONTRACT DOCUMENT ISSUED FOR CONSTRUCTION

CDH
ARCHITECTURE
675 Tower Road
Marietta, GA 30060-6958
770.423.0016
www.cdpartners.com
COPYRIGHT © 2019 by CDH PARTNERS INC.
All rights reserved.

FULTON COUNTY SCHOOL SYSTEM
EVOLINE C. WEST ELEMENTARY SCHOOL - RENOVATIONS
7040 RIVERTOWN RD., FAIRBURN, GA 30213

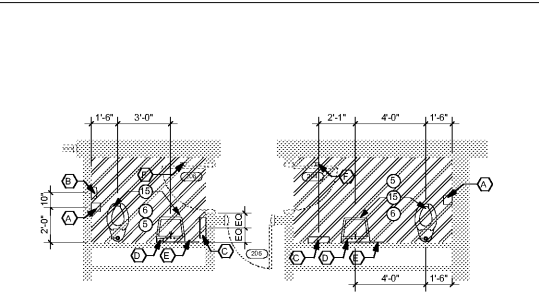

A1 FLOOR PLAN - MAIN LEVEL
A101 1/16" = 1'-0"

A14 VISITOR RESTROOM RENOVATION
A101 1/4" = 1'-0" A17 A101

SHEET TITLE
FLOOR PLAN - MAIN LEVEL
SHEET NUMBER
A101