



675 Tower Road  
Marietta, GA 30060-6958  
770.423.0016  
www.cdpartners.com  
COPYRIGHT © 2019 BY CDH PARTNERS INC.  
ALL RIGHTS RESERVED

FLOOR PLAN NOTES	
1	NOT USED
2	NOT USED
3	NOT USED
4	NOT USED
5	PREP WALL AND PAINT TO MATCH EXISTING. PATCH AND PAINT EXISTING GYPSUM CEILING AS REQUIRED.
6	INSTALL NEW EPOXY FLOORING AND BASE IN AREAS SHOWN BY HATCH PATTERN ON THE PLAN. SEE SPEC SECTION 09 6723
7	NOT USED
8	INSTALL NEW DOOR HARDWARE WHERE INDICATED ON THE DOOR HARDWARE SCHEDULE. SHEET A041
9	NOT USED
10	NOT USED
11	NOT USED
12	NOT USED
13	NOT USED
14	INSTALL MIRROR SCREENS IN THE BOYS RESTROOM AND REPLACE ALL TOILET ATTENTION TO THE GIRLS AND BOYS RESTROOMS. SEE SPEC SECTION 10 2113.17
15	INSTALL NEW LAMING FIXTURE AS INDICATED ON THE FLOOR PLAN
16	REMOVE EXISTING PLUMBING FIXTURES AND INSTALL AT THE SAME LOCATION AFTER FLOORING HAS BEEN INSTALLED.
17	NOT USED
18	NOT USED
19	NOT USED
20	NEW CONCRETE PAD AND NEW FENCE AROUND EQUIPMENT.

FULTON COUNTY SCHOOL SYSTEM  
**EVOLINE C. WEST ELEMENTARY SCHOOL - RENOVATIONS**  
7040 RIVERTOWN RD, FAIRBURN, GA 30213

PROJECT NO: 19048.00	
50% CD	08/07/2018
50% CD Resubmit	1/20/2018
90% CD	10/04/2019
PERMIT SET	11/15/2019
BID SET	12/20/2019



CONTRACT DOCUMENT ISSUED FOR CONSTRUCTION

- GENERAL NOTES**
- A. CONTRACTOR SHALL COORDINATE WITH OTHER TRADES AND PROVIDE NECESSARY PATCHING AND PAINTING REQUIRED TO RESULT IN A SEAMLESS FINISH (TYPICAL).
  - B. TOUCH-UP WALL PAINT AS REQUIRED TO MATCH EXISTING PAINT COLOR/SHEEN WHERE WALL BASE IS REMOVED, AT CEILING TRACK, CASEWORK REPLACEMENT, DISPLAY BOARD REPLACEMENT, AND WHERE REQUIRED FOR OTHER SCOPE (TYPICAL). PROVIDE WALL BASE WHERE BASE IS DAMAGED OR MISSING.
  - C. PROVIDE NEW VCT FLOORING AROUND ALL LOCATIONS WHERE NEW BASE CABINETS AND TEACHER STORAGE IS BEING REPLACED. SEE DETAIL M15-D100 FOR EXTENTS OF FLOORING DEMOLITION AND DETAIL M15-A100 FOR EXTENTS OF FLOORING REPLACEMENT.
  - D. ALL GYPSUM BOARD SHALL HAVE A LEVEL 4 FINISH UNLESS NOTED OTHERWISE. UTILIZE FIRE RATED GYPSUM BOARD AS REQUIRED. VERIFY IN FIELD. UTILIZE MOLD-RESISTANT GYPSUM BOARD AT ALL HIGH-MOISTURE AREAS AND PLUMBING WALLS. SEE SPEC SECTION 09 2500.
  - E. IN CLASSROOMS WHERE CASEWORK IS BEING REPLACED, ALL EQUIPMENT AT CASEWORK INCLUDING BUT NOT LIMITED TO SOAP DISPENSERS AND TOWEL DISPENSERS ARE TO BE REMOVED AND STORED. COORDINATE LOCATION OF ALL REINSTALLED EQUIPMENT WITH ARCHITECT PRIOR TO INSTALLATION.

SHEET TITLE  
**FLOOR PLAN - LOWER LEVEL**

SHEET NUMBER  
**A100**

Order Plans @ [WWW.LDILine.com](http://WWW.LDILine.com)

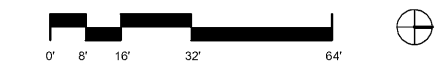
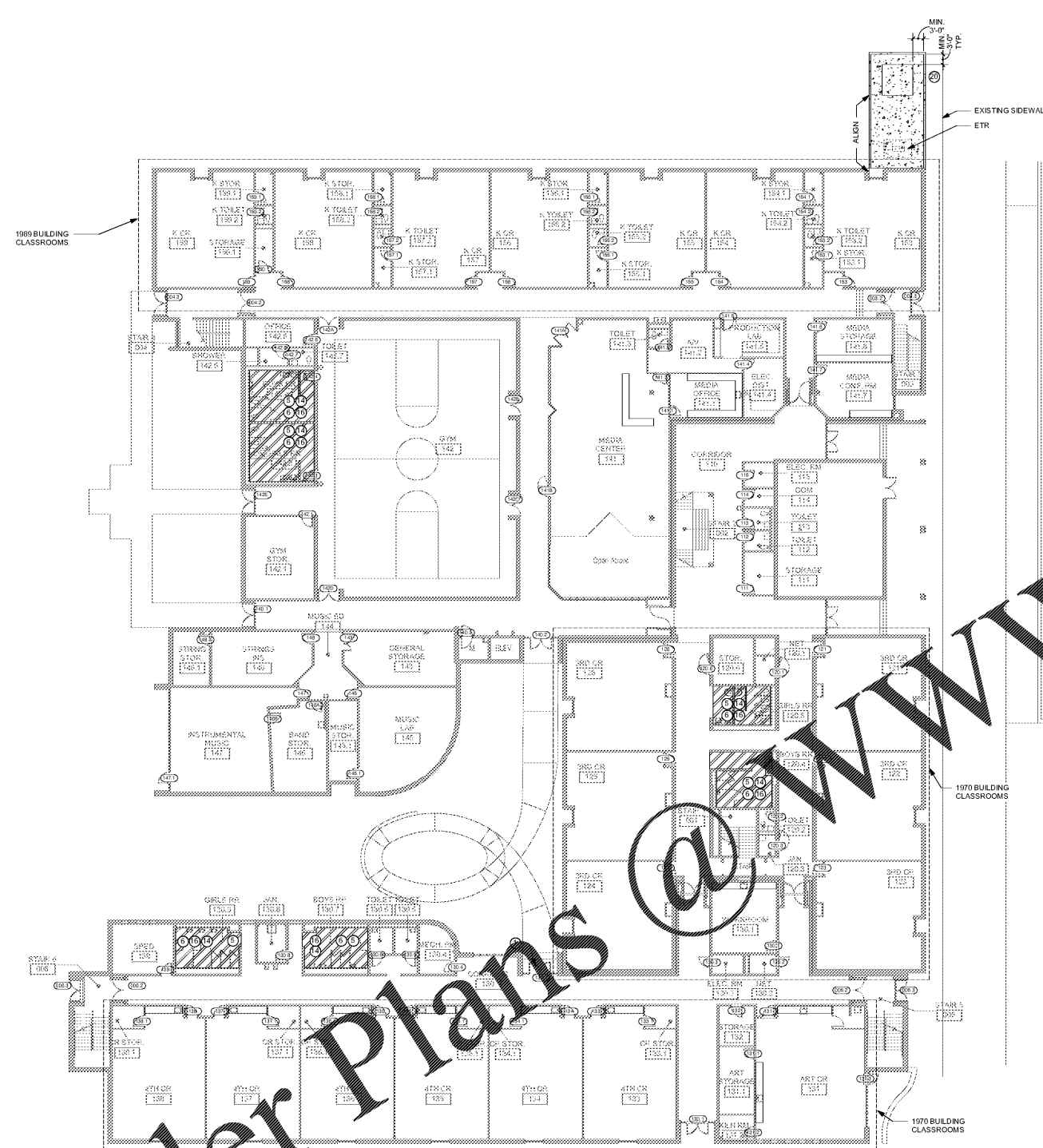

A1 FLOOR PLAN - LOWER LEVEL  
A100 1/16" = 1'-0"

DATE PLOTTED: 12/28/19 PM