

DEMOLITION NOTES	
D-1	NOT USED
D-2	NOT USED
D-3	NOT USED
D-4	NOT USED
D-5	NOT USED
D-6	REMOVE EXISTING DOOR HARDWARE WHERE SCHEDULED TO RECEIVE NEW HARDWARE OR SHEET METAL
D-7	NOT USED
D-8	NOT USED
D-9	REMOVE EXISTING QUARRY TILE FLOORING, WALL BASE AND MUD BED DOWN TO DEPRESSED SLAB AT AREAS SHOWN BY HATCH PATTERN ON THE PLAN AND PREP FOR NEW FLOORING.
D-10	REMOVE EXISTING PLUMBING FIXTURE AND STORE FOR REUSE
D-11	NOT USED
D-12	NOT USED

DEMOLITION SCOPE LEGEND	
	DEMOLISHED WALL
	EXISTING WALL TO REMAIN
	DEMOLISHED DOOR
	EXISTING DOOR TO REMAIN

- DEMOLITION GENERAL NOTES**
- ALL DEMOLITION WORK SHALL CONFORM TO THE REQUIREMENTS OF NFPA 241 STANDARD FOR SAFEGUARDING CONSTRUCTION AND DEMOLITION OPERATIONS.
 - ALL EXISTING PORTABLE EQUIPMENT AND FURNISHINGS SHALL BE REMOVED BY THE OWNER, INCLUDING PROJECTORS AND PROJECTION SCREEN.
 - ALL EXISTING PORTABLE EQUIPMENT AND FURNISHINGS WILL BE MOVED TO THE CENTER OF THE ROOM BY THE OWNER. THE CONTRACTOR SHALL PROTECT AND MOVE ITEMS AS REQUIRED TO COMPLETE THE WORK.
 - ANY EXISTING EQUIPMENT, FIXTURES, MILLWORK OR MATERIAL DEEMED SALVAGEABLE BY THE OWNER SHALL BE DISCONNECTED AND RELOCATED FOR SAFE STORAGE BY DIRECTION OF THE OWNER. ALL OTHER SHALL BECOME PROPERTY OF THE CONTRACTOR AND SHALL BE REMOVED FROM THE SITE.
 - WHEN PORTIONS OF THE DEMOLITION AND/OR RENOVATION PROCESS REQUIRE ACCESS FROM AREAS OUTSIDE THE LIMITS OF WORK (I.E. CEILING OF FLOOR BELOW), THE CONTRACTOR SHALL REPAIR OR REPLACE EXISTING CONSTRUCTION OR EQUIPMENT DAMAGED OR ALTERED TO ACHIEVE ACCESS.
 - ALL EXISTING WALLS REQUIRING REPAINTING WILL BE PATCHED, FILED AND/OR SANDED TO RECEIVE NEW PAINT AND ENTIRE WALL SHALL BE PAINTED CORNER TO CORNER TO PRESENT A NET CLEAN COMPLETE JOB. WHERE ANY WALL BASE IS FOUND TO BE MISSING OR LOOSE, IT SHALL BE RE-GLUED OR REPLACED TO MATCH EXISTING.
 - WHERE DEMOLITION OR RENOVATION HAPPENS IN A RATED WALL, THE RATING SHALL BE MAINTAINED WITH THE INSTALLATION OF NEW WORK.
 - IN CEILINGS WHERE ACOUSTICAL TILE ONLY IS REMOVED, CLEAN AND REPAINT EXISTING REMAINING SUSPENSION SYSTEM AND CLEAN ALL MECHANICAL GRILLS AND LIGHT FIXTURES TO BE REUSED. REFER TO VARIOUS ENGINEERING DISCIPLINES DRAWINGS FOR DISPOSITION OF FIXTURES. INSTALL NEW ACOUSTICAL TILE IN EXISTING SUSPENDED SYSTEM AS PER REFLECTED CEILING PLANS AND FINISH PLANS.
 - ALL EXISTING MECHANICAL AND LIGHT FIXTURES TO BE REUSED SHALL BE REPAIRED AND/OR CLEANED TO "LIKE-NEW" CONDITION.
 - CONTRACTOR SHALL SHORE UP ALL EXISTING STRUCTURES PRIOR TO DEMOLITION TO INSURE SAFETY DURING REMOVAL OF ANY LOAD/NO LOAD BEARING STRUCTURES. SHORING SHALL REMAIN INTACT DURING DEMOLITION AS OUTLINED IN DRAWINGS/SPECS. PRIOR TO DEMOLITION OF STRUCTURES TO BE SHORED, CONTRACTOR SHALL SUBMIT SHORING MEASURES AND SEQUENCING PROCEDURES TO BOTH ARCHITECT AND STRUCTURAL ENGINEER FOR REVIEW.
 - CONTRACTOR SHALL VERIFY ALL EXISTING CONDITIONS PRIOR TO DEMOLITION OF EXISTING STRUCTURES. CONTRACTOR SHALL CONTACT ARCHITECT REGARDING ANY CONDITION THAT MAY EXIST REGARDING DATA/COMPUTER CABLING, COMMUNICATIONS CABLING AND SPECIAL WIRING FOR EQUIPMENT CRITICAL TO THE OPERATION OF THE FACILITY. CONTRACTOR SHALL BE RESPONSIBLE FOR PROTECTING CRITICAL CABLING DURING DEMOLITION, RENOVATION AND RECONSTRUCTION.
 - CONTRACTOR SHALL SCHEDULE AND SEQUENCE REMOVAL OF EXISTING CONSTRUCTION AND PROVIDE TEMPORARY MEASURES SO THAT THE EXISTING BUILDING REMAINS PROTECTED FROM WEATHER UNTIL PERMANENT CONSTRUCTION IS INSTALLED.

PROJECT NO: 19048.00

50% CD	8/07/2016
50% CD Re-submittal	1/20/2018
90% CD	10/04/2019
PERMIT SET	11/15/2019
10% SET	2/20/2019



CONTRACT DOCUMENT ISSUED FOR CONSTRUCTION

REVISION	DESCRIPTION

SHEET TITLE
DEMOLITION PLAN - MAIN LEVEL

SHEET NUMBER

D101

Order Plans @

WWW.IDIline.com

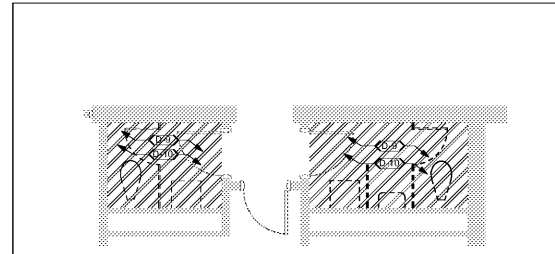
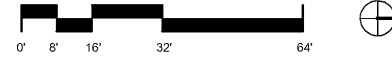
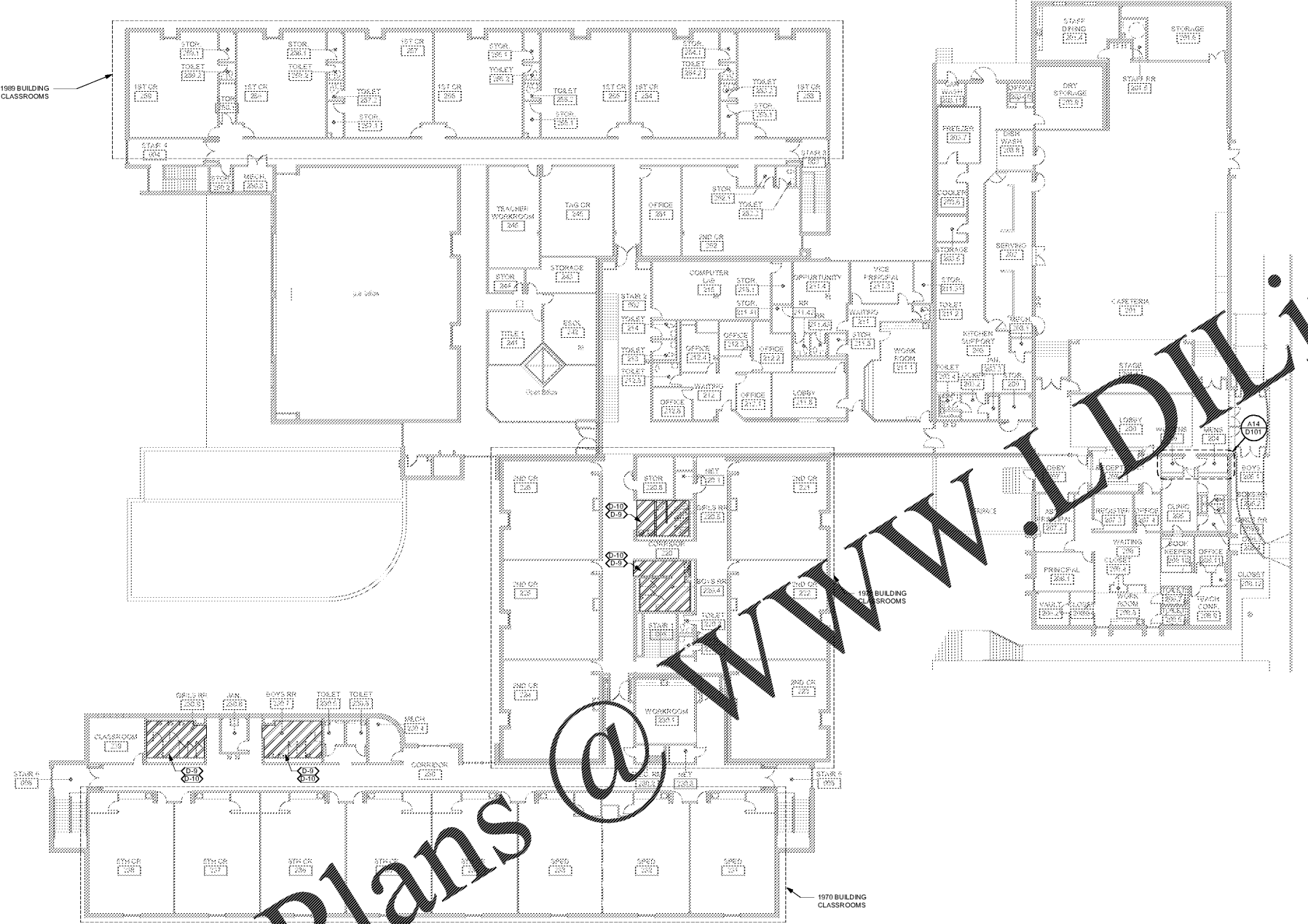

"REMOVE ALL TOILET ACCESSORIES AND DEMOLISH ALL TOILET PARTITIONS INCLUSIVE OF ANY HARDWARE AND DOORS."
**PLUMBING FIXTURES AT THIS LOCATION WILL NOT BE REUSED.

A14 VISITOR RESTROOM DEMOLITION
D101 1/4" = 1'-0" | A17/D101

A1 DEMOLITION PLAN - MAIN LEVEL
D101 1/16" = 1'-0"

DRAWN BY: CLS/PM